

KANSAS

WELL COMPLETION REPORT AND
DRILLER'S LOG

API No. 15 — 175 — 20,421.00-00
County Number

S. 23 T. 34S R. 34 W

Loc. NE SW
County Seward

Operator
Anadarko Production Company

Address
P. O. Box 351, Liberal, Kansas 67901

Well No. 2 Lease Name UNDERWOOD "A"

Footage Location
1980 feet from ~~XXX~~ (S) line 1980 feet from (E) (W) line

Principal Contractor Lohmann-Johnson Geologist Joe Blair

Spud Date 9/19/79 Date Completed 11/13/79 Total Depth 6512' P.B.T.D. 6483'

Directional Deviation 3/4 deg @ 6512' Oil/Gas Purchaser Western Crude

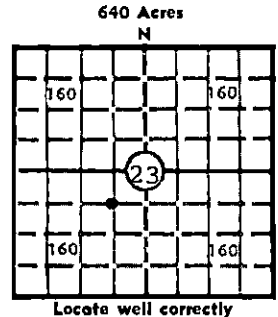

Elev.: Gr. 2911'
DF 2920' KB 2921'

CASING RECORD

Report of all strings set — surface, intermediate, production, etc.

Purpose of string	Size hole drilled	Size casing set (in O.D.)	Weight lbs/ft.	Setting depth	Type cement	Sacks	Type and percent additives
Surface	12-1/4"	8-5/8"	24#	1649'	Pozmix Common	600 200	4% gel 2% CaCl 3% CaCl
Production	7-7/8"	4-1/2"	10.5#	6510'	Lite-wate SS Pozmix	50 175	.75% D-31 18% salt .75% D-31

LINER RECORD

PERFORATION RECORD

Top, ft.	Bottom, ft.	Sacks cement	Shots per ft.	Size & type	Depth interval
			2	3/8" jet	6468-73'

TUBING RECORD

Size	Setting depth	Packer set at
2-3/8"	6468'	

ACID, FRACTURE, SHOT, CEMENT SQUEEZE RECORD

Amount and kind of material used	Depth interval treated
A/500 gal 7.5% HCl + 2 BS w/500 SCF N2	6468-73'
F/16,500 gal 40# versa gel + 17,000# 20-40 sand	6468-73'

INITIAL PRODUCTION

Date of first production 11/13/79 Producing method (flowing, pumping, gas lift, etc.) Pumping

RATE OF PRODUCTION PER 24 HOURS
Oil 18 bbls. Gas 25.5 MCF Water 50 Gas-oil ratio 1.417 CFPB

Disposition of gas (vented, used on lease or sold) Sold Producing interval (s) 6468-73'

STATE RECEIVED 11-20-79
CORPORATION COMMISSION
NOV 20 1979
CONSERVATION DIVISION
Wichita, Kansas

INSTRUCTIONS: As provided in KCC Rule 82-2-125, within 90 days after completion of a well, one completed copy of this Drillers Log shall be transmitted to the State Geological Survey of Kansas, 4150 Monroe Street, Wichita, Kansas 67209. Copies of this form are available from the Conservation Division, State Corporation Commission, 245 No. Water, Wichita, Kansas 67202. Phone AC 316-522-2206. If confidential custody is desired, please note Rule 82-2-125. Drillers Logs will be an open file in the Oil and Gas Division, State Geological Survey of Kansas, Lawrence, Kansas 66044.

Operator Anadarko Production Company		DESIGNATE TYPE OF COMP.: OIL, GAS, DRY HOLE, SWDW, ETC.:
Well No. 2	Lease Name UNDERWOOD "A"	OIL
S 23 T 34SR 34 ^{XBK} W		

WELL LOG

Show all important zones of porosity and contents thereof; cored intervals, and all drill-stem tests, including depth interval tested, cushion used, time tool open, flowing and shut-in pressures, and recoveries.

SHOW GEOLOGICAL MARKERS, LOGS RUN,
OR OTHER DESCRIPTIVE INFORMATION.

FORMATION DESCRIPTION, CONTENTS, ETC.	TOP	BOTTOM	NAME	DEPTH
Sand and Redbed	0'	1651'	LOGS: GO-Wireline CDL-CNL-GR DIL	
Redbed	1651'	2080'		
Redbed, Shale and Lime	2080'	2475'		
Lime and Shale	2475'	6512'		

USE ADDITIONAL SHEETS, IF NECESSARY, TO COMPLETE WELL RECORD.

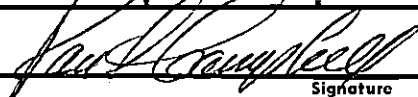
Date Received	
	Signature
	Paul Campbell, Division Production Manager
	Title
	November 16, 1979
	Date