

IMPROVED  
Kans. Geo. Survey request  
samples on this well.

ORIGINAL

S. 36 T. 34 R. 37 W.

KANSAS DRILLERS LOG

API No. 15 — 189 — 20,390-00-00  
County Number

Loc. NE NE NE

County Stevens

Operator  
Mobil Oil Corp.

Address  
Box 5444 Denver, Colo 80217

Well No. #2 Lease Name Gooch #1 Unit

Footage Location  
350 feet from (N) line 330 feet from (E) line

Principal Contractor Zenith Drilling Co. Geologist D. H. Suek

Spud Date 2/25/78 Total Depth 6850 P.B.T.D. 6355

Date Completed 6/19/78 Oil Purchaser Gas Northern Natural Gas Co.

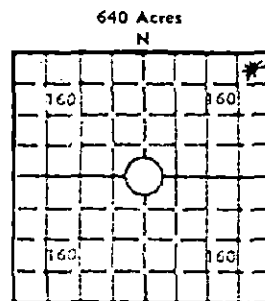

Elev.: Gr.

DF KB 3108

CASING RECORD

Report of all strings set — surface, intermediate, production, etc.

Purpose of string	Size hole drilled	Size casing set (in O.D.)	Weight lbs/ft.	Setting depth	Type cement	Sacks	Type and percent additives
Surface	17-1/2"	13-3/8"	48	665	Class H Class H	300 150	12% gel circ.
Intermediate	12-1/4"	8-5/8"	24	3150	Howco Lite Class H	300 200	18% salt 18% NaCl & .75% CFR-2
Producing	7-7/8"	5-1/2"	13	6850	Class H	300	

LINER RECORD

PERFORATION RECORD

Top, ft.	Bottom, ft.	Sacks cement	Shots per ft.	Size & type	Depth interval
			2	.48 Welex	6325-6354

TUBING RECORD

Size	Setting depth	Packer set at
2-7/8"	6335	6770 NO

ACID, FRACTURE, SHOT, CEMENT SQUEEZE RECORD

Amount and kind of material used	Depth interval treated
10,000 gals MOD 202; 20# Frac-Flo & 30# Metriseal & 25 gals. HAI 75 Corrosion Inhibitor	6325-6354

INITIAL PRODUCTION

Date of first production	Producing method (flowing, pumping, gas lift, etc.)
6-19-78	Pumping
RATE OF PRODUCTION PER 24 HOURS	Oil bbls. 2200 MCF Water bbls. Gas-oil ratio CFPB
Disposition of gas (vented, used on lease or sold)	Producing interval(s)
Sold	6325-6354

INSTRUCTIONS: As provided in KCC Rule 82-2-125, within 90 days after completion of a well, one completed copy of this Drillers Log shall be transmitted to the State Geological Survey of Kansas, 4150 Monroe Street, Wichita, Kansas 67209. Copies of this form are available from the Conservation Division, State Corporation Commission, 3830 So. Meridian (P.O. Box 17027), Wichita, Kansas 66217. Phone AC 316-522-2206. If confidential custody is desired, please note Rule 82-2-125. Drillers Logs will be on open file in the Oil and Gas Division, State Geological Survey of Kansas, Lawrence, Kansas 66044.

Operator Mobil Oil Corporation		DESIGNATE TYPE OF COMP.: OIL, GAS, DRY HOLE, SWDW, ETC.:
Well No. 2	Lease Name Gooch #1 Unit	Gas
S <u>36</u> T <u>34</u> R <u>37</u> E W		

**WELL LOG**

Show all important zones of porosity and contents thereof; cored intervals, and all drill-stem tests, including depth interval tested, cushion used, time tool open, flowing and shut-in pressures, and recoveries.

SHOW GEOLOGICAL MARKERS, LOGS RUN,  
OR OTHER DESCRIPTIVE INFORMATION.

FORMATION DESCRIPTION, CONTENTS, ETC.	TOP	BOTTOM	NAME	DEPTH
Sand and Red Bed	0	640	Cimmarron	1674
Red Bed	640	700	Chase	2642
Red Bed and Sand	700	1064	Council Grove	3009
Anhydrite	1064	1109		
Sand	1109	1385		
Shale and Anhydrite	1385	1690		
Red Bed, Anhydrite & Shale	1690	1835		
Shale	1835	2320		
Lime and Shale	2320	2490		
Lime, Shale and Dolomite	2490	2605		
Lime and Shale	2605	2645		
Shale	2645	2742		
Lime and Shale	2742	6850		

USE ADDITIONAL SHEETS, IF NECESSARY, TO COMPLETE WELL RECORD.

Date Received	<p align="center"><i>J. A. Williamson</i> 7/6/78 Signature</p> <p align="center">C. A. Park Title</p> <p align="center">Prod. Acctg. Supervisor</p> <p align="center">Title</p> <p align="center">Date</p>
---------------	--

OK