

STATE CORPORATION COMMISSION OF KANSAS
OIL & GAS CONSERVATION DIVISION
WELL COMPLETION OR RECOMPLETION FORM
ACO-1 WELL HISTORY
DESCRIPTION OF WELL AND LEASE

067-20,873-0000

API NO. 15-.....

County.....Grant.....

APPROX. C. ...NE Sec. 29 Twp. 29 Rge. 35 X East West

4030' Ft North from Southeast Corner of Section
1250' Ft West from Southeast Corner of Section
(Note: Locate well in section plat below)

Lease Name.....LIGHTY.....Well #...3-29

Field Name.....HUGOTON INFILL.....

Producing Formation.....CHASE.....

Elevation: Ground.....2958'.....KB.....2968'

Section Plat

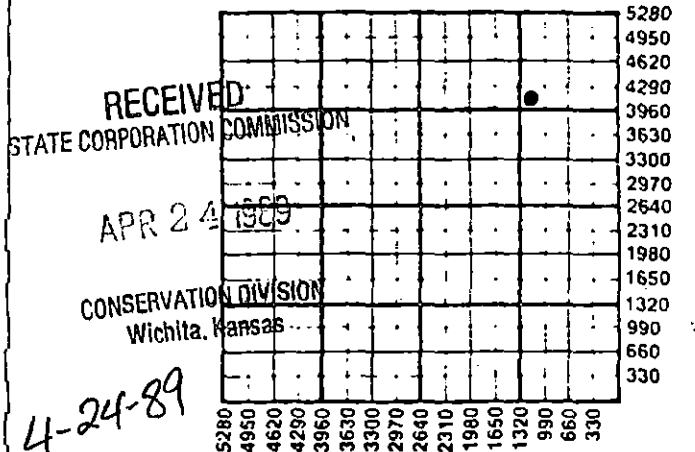

WATER SUPPLY INFORMATION

Disposition of Produced Water: _____ Disposal
Docket # NA _____ Repressuring

Questions on this portion of the ACO-1 call:
Water Resources Board (913) 296-3717

Source of Water:
Division of Water Resources Permit #.....

Groundwater.....Ft North from Southeast Corner
(Well)Ft West from Southeast Corner of
Sec Twp Rge East West

Surface Water.....Ft North from Southeast Corner
(Stream, pond etc).....Ft West from Southeast Corner
Sec Twp Rge East West

X Other (explain)....Commercial Source.....
(purchased from city, R.W.D. #)

Operator: License # 04824
Name MESA OPERATING, LTD. PARTNERSHIP
Address P.O. BOX 2009
AMARILLO, TEXAS 79189
City/State/Zip

Purchaser.....PSI, INC.....
Omaha, NE

Operator Contact Person W. RIDDLE
Phone (316) 356-3026

Contractor: License # 5382
Name Cheyenne Drilling Co.

Wellsite Geologist.....
Phone.....

Designate Type of Completion
X New Well _____ Re-Entry _____ Workover

Oil _____ SWD _____ Temp Abd
X Gas _____ Inj _____ Delayed Comp.
Dry _____ Other (Core, Water Supply etc.)

If OWN: old well info as follows:
Operator
Well Name
Comp. DateOld Total Depth.....

WELL HISTORY

Drilling Method:
X Mud Rotary _____ Air Rotary _____ Cable
3/21/89 3/24/89 4/3/89
Spud Date Date Reached TD Completion Date
2864' 2774'
Total Depth PBTD

Amount of Surface Pipe Set and Cemented at 623' feet
Multiple Stage Cementing Collar Used? _____ Yes _____ No
If yes, show depth set.....feet
If alternate 2 completion, cement circulated
from.....feet depth to.....w/.....SX cmt
Cement Company Name
Invoice #
A I J

INSTRUCTIONS: This form shall be completed in triplicate and filed with the Kansas Corporation Commission, 200 Colorado Derby Building, Wichita, Kansas 67202, within 120 days of the spud date of any well. Rule 82-3-130, 82-3-107 and 82-3-106 apply. Information on side two of this form will be held confidential for a period of 12 months if requested in writing and submitted with the form. See rule 82-3-107 for confidentiality in excess of 12 months. One copy of all wireline logs and drillers time log shall be attached with this form. Submit CP-4 form with all plugged wells. Submit CP-111 form with all temporarily abandoned wells.

All requirements of the statutes, rules and regulations promulgated to regulate the oil and gas industry have been fully complied with and the statements herein are complete and correct to the best of my knowledge.

Signature
Title Regulatory Analyst Date 4/18/89

Subscribed and sworn to before me this 18th day of April 1989
Notary Public.....

Date Commission Expires.....

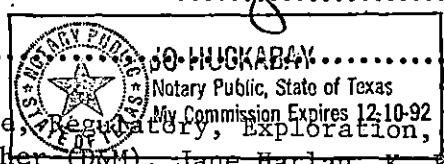

K.C.C. OFFICE USE ONLY
F Letter of Confidentiality Attached
C Wireline Log Received
C Drillers Timelog Received
Distribution
 KCC _____ SWD/Rep _____ NGPA
 KGS _____ Plug _____ Other (Specify)
4-24-89
Form ACO-1 (5-86)

xc: KCC (0+2), Well File, Regulatory, Exploration, Land, Reservoir, C. Records, N. Butcher (DGM), Jane Harlan, K. Ratliff, Accounting

Operator Name MESA OPERATING LTD PARTNERSHIP Lease Name LIGHTY # 3-29 Well #

Sec. 29 Twp. 29 Rge. 35 East West County Grant

WELL LOG

INSTRUCTIONS: Show important tops and base of formations penetrated. Detail all cores. Report all drill stem tests giving interval tested, time tool open and closed, flowing and shut-in pressures, whether shut-in pressure reached static level, hydrostatic pressures, bottom hole temperature, fluid recovery, and flow rates if gas to surface during test. Attach extra sheet if more space is needed. Attach copy of log.

Drill Stem Tests Taken Yes No
 Samples Sent to Geological Survey Yes No
 Cores Taken Yes No

Formation Description
 Log Sample

Name	Top	Bottom
Stone Corral	1680'	
Wellington	2236'	
Chase	2448'	
Council Grove	2780'	

CASING RECORD <input checked="" type="checkbox"/> New <input type="checkbox"/> Used							
Report all strings set-conductor, surface, intermediate, production, etc.							
Purpose of String	Size Hole Drilled	Size Casing Set (In O.D.)	Weight Lbs/Ft.	Setting Depth	Type of Cement	#Sacks Used	Type and Percent Additives
SURFACE	12 1/4"	8 5/8"	24#	623'	Lt	300	3% CaCl
PRODUCTION	7 7/8"	5 1/2"	15.5#	2863'	Lt	415	5% KCL
PERFORATION RECORD				Acid, Fracture, Shot, Cement Squeeze Record (Amount and Kind of Material Used)			
Shots Per Foot	Specify Footage of Each Interval Perforated			Depth			
1 JS/2'	2450'-2700'			5000 gals 15% HCL 90,000 gals x-linked gel + 250,000# 10/20 sand			2450'-2700'
TUBING RECORD		Size	Set At	Packer at	Liner Run	<input type="checkbox"/> Yes <input checked="" type="checkbox"/> No	
			NA				
Date of First Production		Producing Method					
4/11/89		<input checked="" type="checkbox"/> Flowing <input type="checkbox"/> Pumping <input type="checkbox"/> Gas Lift <input type="checkbox"/> Other (explain).....					
Estimated Production Per 24 Hours		Oil	Gas	Water	Gas-Oil Ratio	Gravity	
0 Bbls		2387 MCF	0 Bbls	CFPB	NA		

METHOD OF COMPLETION

Production Interval

Disposition of gas: Vented Sold Used on Lease
 Open Hole Perforation Other (Specify) 2450'-2700'
 Dually Completed Commingled

PLAT AND CERTIFICATION OF ACREAGE ATTRIBUTABLE TO A GAS WELL

CO-8

State Corporation Commission, Conservation Division
200 Colorado Derby Bldg. Wichita, Kansas 67202

OPERATOR MESA OPERATING LIMITED PARTNERSHIP **LOCATION OF WELL**
LEASE LIGHTY 4030 feet from the SOUTH line
1250 feet from the EAST line
WELL NUMBER 3-29 0' the _____ of Sec. 29 T. 29 S. 35
FIELD HUGOTON INFILL **COUNTY** Grant

ORDER GRANTING ALLOWABLE ENTERED IN DOCKET NO. _____

NUMBER OF ACRES ATTRIBUTABLE TO WELL 640

DESCRIPTION OF ACREAGE:

PLAT

(Show location of Well and outline attributable acreage)

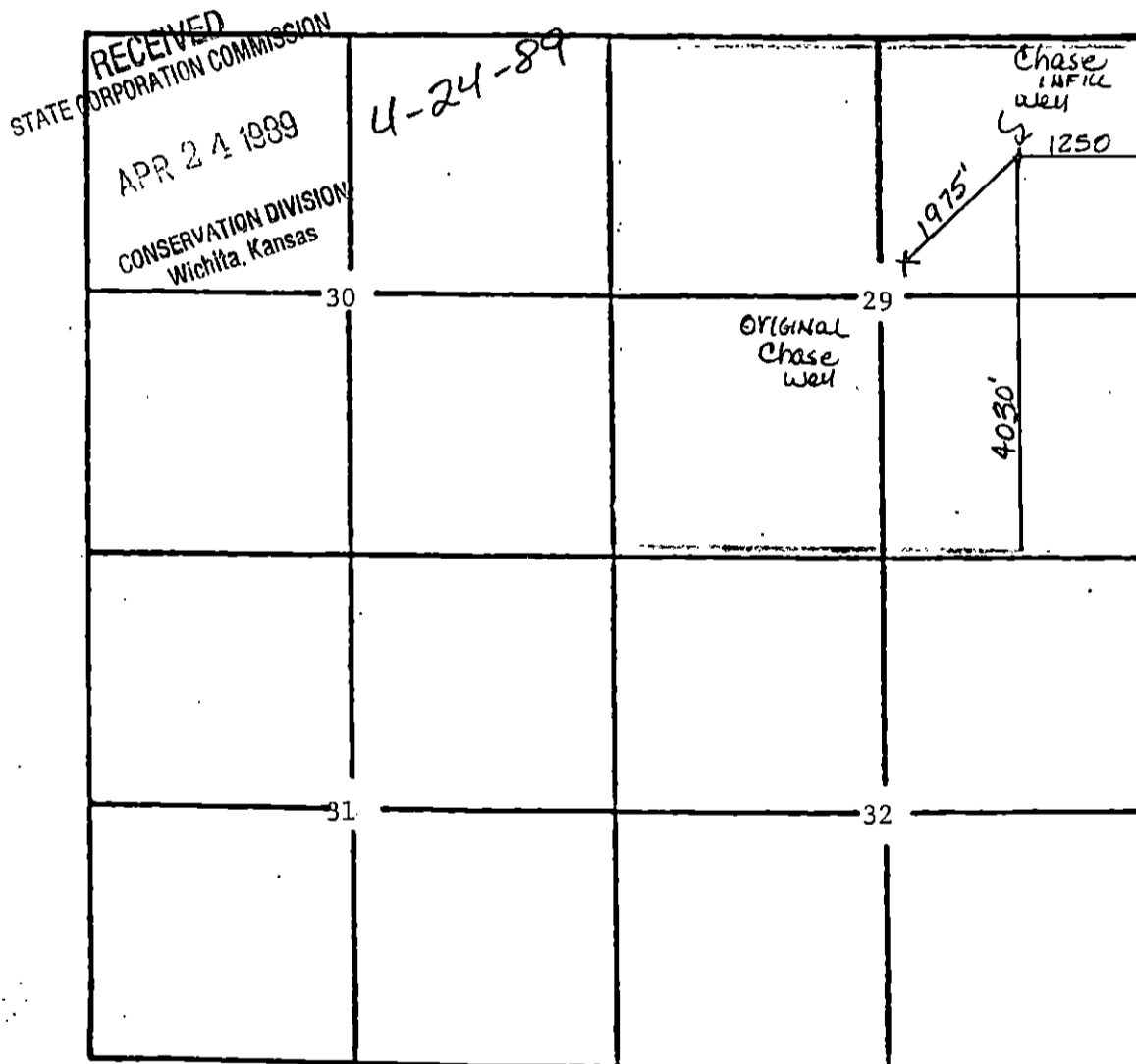

The undersigned hereby certifies that he is REGULATORY ANALYST for Mesa Operating Limited Partnership, a duly authorized agent, that all information shown hereon is true and correct to the best of his knowledge and belief, and that all acreage claimed as attributable to the well named herein is held by production from that well.

Cresley McKee

Subscribed and sworn to before me on this 3rd day of February, 1989.

 DWAINA PITTS
Notary Public, State of Texas
My Commission Expires 8-6-89

Dwaina Pitts
Notary Public

My Commission Expires _____