

STATE CORPORATION COMMISSION OF KANSAS
OIL & GAS CONSERVATION DIVISION

WELL COMPLETION OR RECOMPLETION FORM
ACO-1 WELL HISTORY

DESCRIPTION OF WELL AND LEASE

Operator: License # 5004
Name Vincent Oil Corporation
Address 125 N. Market - Suite 1110
City/State/Zip Wichita, Kansas 67202

Purchaser: Not Assigned

Operator Contact Person June K. Burnett
Phone 316-262-3573

Contractor: License # 5149
Name Wheatstate Oilfield Services, Inc.

Wellsite Geologist Larry Friend
Phone 316-265-2228

Designate Type of Completion

- New Well Re-Entry Workover
- Oil SWD Temp Abd
- Gas Inj Delayed Comp.
- Dry Other (Core, Water Supply etc.)

If OWMO: old well info as follows:
Operator
Well Name
Comp. Date Old Total Depth

WELL HISTORY

Drilling Method:
 Mud Rotary Air Rotary Cable

10-28-85 11-9-85 12-30-85
Spud Date Date Reached TD Completion Date

5200
Total Depth PBTD

Amount of Surface Pipe Set and Cemented at 650 feet
Multiple Stage Cementing Collar Used? Yes No
If yes, show depth set.....feet
If alternate 2 completion, cement circulated from.....feet depth to.....w/.....SX cmt

API NO. 15-097-21,193-0000
County Kiowa County
C...SE...SW.... Sec. 35 Twp. 29 Rge. 19 East West
.660..... Ft North from Southeast Corner of Section
.330..... Ft West from Southeast Corner of Section
(Note: Locate well in section plat below)
Lease Name Schmidt "C" Well # 2
Field Name Nichols
Producing Formation Mississippian
Elevation: Ground 2281 KB 2293

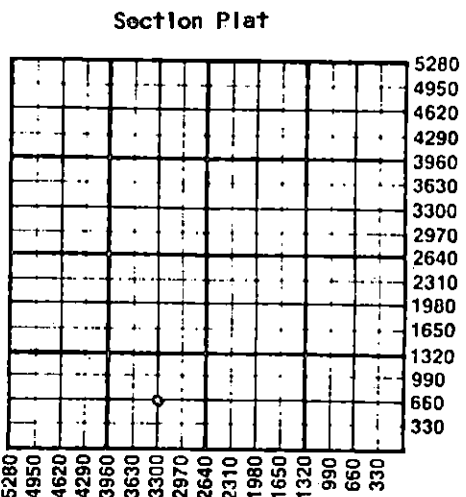

WATER SUPPLY INFORMATION
Disposition of Produced Water: Disposal Repressuring
Docket #

Questions on this portion of the ACO-1 call:
Water Resources Board (913) 296-3717
Source of Water:
Division of Water Resources Permit #
 Groundwater.....Ft North from Southeast Corner (Well)Ft West from Southeast Corner of Sec Twp Rge East West
 Surface Water.....Ft North from Southeast Corner (Stream, pond etc).....Ft West from Southeast Corner Sec Twp Rge East West
 Other (explain) Purchased from local farmer (purchased from city, R.W.D. #)

INSTRUCTIONS: This form shall be completed in duplicate and filed with the Kansas Corporation Commission, 200 Colorado Derby Building, Wichita, Kansas 67202, within 90 days after completion or recompletion of any well. Rule 82-3-130 and 82-3-107 apply.
Information on side two of this form will be held confidential for a period of 12 months if requested in writing and submitted with the form. See rule 82-3-107 for confidentiality in excess of 12 months.
One copy of all wireline logs and drillers time log shall be attached with this form. Submit CP-4 form with all plugged wells. Submit CP-111 form with all temporarily abandoned wells.

All requirements of the statutes, rules and regulations promulgated to regulate the oil and gas industry have been fully complied with and the statements herein are complete and correct to the best of my knowledge.

Signature Richard A. Hiesch
Title Vice President Date 1-23-86

K.C.C. OFFICE USE ONLY
 Letter of Confidentiality Attached
 Wireline Log Received
 Drillers Timelog Received
Distribution
 KCC SWD/Rep NGPA
 KGS Plug Other (Specify)

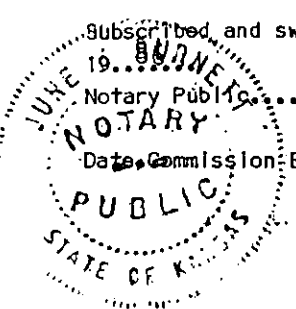

REC 3-26-86 MAR 26 1986

Sec. 35 Twp. 29 Rge. 19 W

Operator Name Vincent Oil Corporation Lease Name Schmidt "C" Well #. 2

Sec. 35 Twp. 29 Rge. 19 East West County Kiowa County Kansas

WELL LOG

INSTRUCTIONS: Show important tops and base of formations penetrated. Detail all cores. Report all drill stem tests giving interval tested, time tool open and closed, flowing and shut-in pressures, whether shut-in pressure reached static level, hydrostatic pressures, bottom hole temperature, fluid recovery, and flow rates if gas to surface during test. Attach extra sheet if more space is needed. Attach copy of log.

Table with columns for Drill Stem Tests Taken, Formation Description, Name, Top, Bottom. Includes data for DST #1: 5006'-5094'; 45-60-90-90; and various flow rates.

Recovered: 240' slightly gas cut mud IFP 135 - 167# FSIP 1306# FFP 156 - 167# FSIP 1389# BHT - 132 degrees

RELEASED

Form sections: CASING RECORD, PERFORATION RECORD, TUBING RECORD, Date of First Production, Estimated Production Per 24 Hours, METHOD OF COMPLETION, Production Interval.

Disposition of gas: Vented, Sold, Used on Lease, Open Hole, Perforation, Other (Specify), Dually Completed, Commingled.

APR 20 1987

FROM CONFIDENTIAL

flakes per sx.