

STATE CORPORATION COMMISSION OF KANSAS
OIL & GAS CONSERVATION DIVISION
WELL COMPLETION OR RECOMPLETION FORM
ACO-1 WELL HISTORY
DESCRIPTION OF WELL AND LEASE

Operator: License # 4247
Name Dolomite Resources Corporation
Address 105 S. Broadway, Suite 610
City/State/Zip Wichita, KS 67202

Purchaser.....

Operator Contact Person Loree Newby
Phone (316)265-8014

Contractor: License # 5107
Name H-30 Drilling, Inc.

Wellsite Geologist Mark Grommesh
Phone (316)265-8014

Designate Type of Completion
 New Well Re-Entry Workover
 Oil SWD Temp Abd
 Gas Inj Delayed Comp.
 Dry Other (Core, Water Supply etc.)

If OLD: old well Info as follows:
Operator.....
Well Name.....
Comp. Date.....Old Total Depth.....

WELL HISTORY

Drilling Method:
 Mud Rotary Air Rotary Cable
5-25-88 6-2-88 6-2-88
Spud Date Date Reached TD Completion Date
5600'
Total Depth PBDT

Amount of Surface Pipe Set and Cemented at 1874 feet
Multiple Stage Cementing Collar Used? Yes No
If yes, show depth set.....feet
If alternate 2 completion, cement circulated from.....feet depth to.....w/.....SX cmt
Cement Company Name.....
Invoice #.....
DIT I DED

INSTRUCTIONS: This form shall be completed in duplicate and filed with the Kansas Corporation Commission, 200 Colorado Derby Building, Wichita, Kansas 67202, within 90 days after completion or recompletion of any well. Rule 82-3-130 and 82-3-107 apply.
Information on side two of this form will be held confidential for a period of 12 months if requested in writing and submitted with the form. See rule 82-3-107 for confidentiality in excess of 12 months.
One copy of all wireline logs and driller's time log shall be attached with this form. Submit CP-4 form with all plugged wells. Submit CP-111 form with all temporarily abandoned wells.

All requirements of the statutes, rules and regulations promulgated to regulate the oil and gas industry have been fully complied with and the statements herein are complete and correct to the best of my knowledge.

Signature *Thomas G. Arnold*
Title *President* Date 28 Feb. 1989

Subscribed and sworn to before me this 28th day of February 1989
Notary Public *Loree Newby*
Loree Newby

Date Commission Expires.....



SIDE ONE

API NO. 15-081-20,482-0000
County Haskell
C NE SW Sec 14 Twp 29S Rge 33 East West

1980 Ft North from Southeast Corner of Section
3300 Ft West from Southeast Corner of Section
(Note: Locate well in section plat below)

Lease Name Ellsaesser Well # 14-1

Field Name Lemon North

Producing Formation.....

Elevation: Ground 2933' KB 2944'

Section Plat

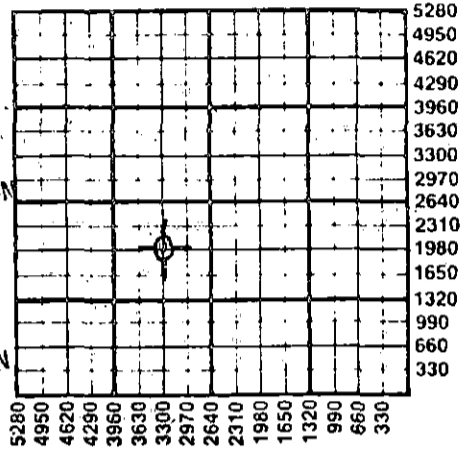

RECEIVED
STATE CORPORATION COMMISSION
3-1-89
MAR 01 1989
CONSERVATION DIVISION
Wichita, Kansas

WATER SUPPLY INFORMATION

Disposition of Produced Water: Disposal
Docket #..... Repressuring

Questions on this portion of the ACO-1 call:

Water Resources Board (913) 296-3717
Source of Water:
Division of Water Resources Permit # None required.

Groundwater.....Ft North from Southeast Corner (Well)Ft West from Southeast Corner of Sec Twp Rge East West

Surface Water.....Ft North from Southeast Corner (Stream, pond etc).....Ft West from Southeast Corner Sec Twp Rge East West

Other (explain) Purchased water from landowner's shall pond (purchased from city, R.W.D. #)

K.C.C. OFFICE USE ONLY

Letter of Confidentiality Attached
 Wireline Log Received
 Driller's Timelog Received

Distribution
 KCC SWD/Rep NGPA
 KGS Plug Other
(Specify)

3-1-89

Sec 14 Twp 29S Rge 33E

SIDE TWO

Operator Name Dolomite Resources Corporation Lease Name Ellsaesser Well # 14-1

Sec. 14 Twp. 29S Rge. 33 East West County Haskell

WELL LOG

INSTRUCTIONS: Show important tops and base of formations penetrated. Detail all cores. Report all drill stem tests giving interval tested, time tool open and closed, flowing and shut-in pressures, whether shut-in pressure reached static level, hydrostatic pressures, bottom hole temperature, fluid recovery, and flow rates if gas to surface during test. Attach extra sheet if more space is needed. Attach copy of log.

Drill Stem Tests Taken Yes No
 Samples Sent to Geological Survey Yes No
 Cores Taken Yes No

Formation Description
 Log Sample

ELECTRIC LOG TOPS

Heebner Sh 4120' (-1176) Chesteran 5458' (-2514)
 Marmaton 4815' (-1871) St. Genevieve 5500' (-2556)
 Cherokee Sh 4970' (-2026) St. Louis LS. 5583' (-2639)
 Morrow Sh 5269' (-2325) R.T.D./L.T.D. 5636'

Name	Top	Bottom
Red Bed	0	1,360'
Sand	1,360'	1,525'
Red Bed and Shale	1,525'	1,877'
Anhydrite and Red Bed	1,877'	2,005'
Red Bed and Shale	2,005'	2,275'
Shale and Lime	2,275'	2,593'
Lime and Shale	2,593'	3,090'
Shale and Lime	3,090'	3,345'
Lime and Shale	3,345'	3,645'
Shale and Lime	3,645'	4,271'
Lime and Shale	4,271'	4,530'
Shale and Lime	4,530'	4,750'
Lime and Shale	4,750'	5,070'
Shale and Lime	5,070'	5,220'
Lime and Shale	5,220'	5,557'
Shale and Lime	5,557'	5,600'
Rotary Total Depth		5,600'

DST. 1. *5179' - 5360' DST. 2. *5250' - 5636'

I.H.P. 2689 # I.H.P. 2711 #
 I.F.P. 164 - 176 # I.F.P. 176 - 187 #
 I.S.I.P. 243 # I.S.I.P. 386 #
 F.F.P. 187 - 187 # F.F.P. 243 - 254 #
 F.S.I.P. 232 # F.S.I.P. 386 #
 F.H.P. 2678 # F.H.P. 2635 #

RECOVERY: 40' Mud RECOVERY: 155' Mud
 200' Slightly gas cut mud.

CASING RECORD <input checked="" type="checkbox"/> New <input type="checkbox"/> Used							
Report all strings set-conductor, surface, intermediate, production, etc.							
Purpose of String	Size Hole Drilled	Size Casing Set (in O.D.)	Weight Lbs/Ft.	Setting Depth	Type of Cement	#Sacks Used	Type and Percent Additives
Conductor	24"	16"		40'	3 yards	grout	
Surface	12 1/4"	8 5/8"	24#	1874'	Lite Wt	485	2% cc
					Class C	150	2% cc
PERFORATION RECORD				Acid, Fracture, Shot, Cement Squeeze Record			
Shots Per Foot	Specify Footage of Each Interval Perforated			(Amount and Kind of Material Used)		Depth	
TUBING RECORD				Liner Run <input type="checkbox"/> Yes <input type="checkbox"/> No			
Date of First Production		Producing Method <input type="checkbox"/> Flowing <input type="checkbox"/> Pumping <input type="checkbox"/> Gas Lift <input type="checkbox"/> Other (explain).....					
Estimated Production Per 24 Hours		Oil Bbls	Gas MCF	Water Bbls	Gas-Oil Ratio	Gravity	

METHOD OF COMPLETION

Production Interval

Disposition of gas: Vented Open Hole Perforation
 Sold Other (Specify)
 Used on Lease Dually Completed Commingled

