

STATE OF KANSAS
STATE CORPORATION COMMISSION

WELL PLUGGING RECORD

Give All Information Completely
Make Required Affidavit
Mail or Deliver Report to
Conservation Division
State Corporation Comm.
245 North Water
Wichita, KS 67202

Kingman County. Sec. 31 Twp. 29S Rge. 6 E/W
Location as "NE/CNW $\frac{1}{4}$ SW $\frac{1}{4}$ " or footage from lines
W/2 SW

Lease Owner Pickrell Drilling Company
Lease Name Matson Estate Well No. 2
Office Address 205 Litwin Bldg., Wichita, Kansas 67202
Character of Well (Completed as Oil, Gas or Dry Hole) Dry Hole

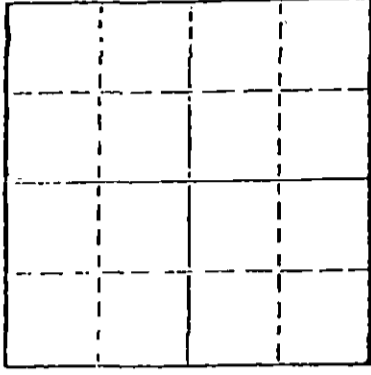

Date Well completed 11-2-81 19
Application for plugging filed 11-2-81 19
Application for plugging approved 11-2-81 19
Plugging commenced 11-2-81 19
Plugging completed 11-2-81 19

Reason for abandonment of well or producing formation Dry Hole
If a producing well is abandoned, date of last production 19

Was permission obtained from the Conservation Division or its agents before plugging was commenced? Yes

Name of Conservation Agent who supervised plugging of this well Maurcie Leslie
Producing formation _____ Depth to top _____ Bottom _____ Total Depth of Well 4212'
Show depth and thickness of all water, oil and gas formations.

OIL, GAS OR WATER RECORDS

CASING RECORD

FORMATION	CONTENT	FROM	TO	SIZE	PUT IN	PULLED OUT
				8 5/8	206	None

Describe in detail the manner in which the well was plugged, indicating where the mud fluid was placed and the method or methods used in introducing it into the hold. If cement or other plugs were used, state the character of same and depth placed, from _____ feet to _____ feet for each plug set.

50 sacks @ 300'
40 sacks @ 180'
10 sacks @ 40'
5 sacks Rathole Comp. 2:15 P.M. on 11-2-81

RECEIVED
STATE CORPORATION COMMISSION

NOV 10 1981

(If additional description is necessary, use BACK of this sheet)
Name of Plugging Contractor Pickrell Drilling Company

CONSERVATION DIVISION
Wichita Kansas

STATE OF Kansas COUNTY OF Sedgwick, ss.
C.W. Sebitts (~~owner or operator~~) or (owner or operator)

of the above-described well, being first duly sworn on oath, says: That I have knowledge of the facts, statements, and matters herein contained and the log of the above-described well as filed and that the same are true and correct. So help me God. By: C.W. Sebitts

(Signature) [Signature]
205 Litwin Bldg., Wichita, Kansas 67202
(Address)

SUBSCRIBED AND SWORN TO before me this 9 day of November, 1981

My commission expires _____

12-9-82
LEA SCHNEWEIS
STATE NOTARY PUBLIC
Sedgwick County, Kansas

Jana Lea Schneweis
Jana Lea Schneweis
Notary Public.

WELL COMPLETION REPORT AND DRILLER'S LOG

API No. 15 — 095 — 21,181
 County Number

S. 31 T. 29S R. 6 ^{XX} W
 Loc. W/2 SW
 County Kingman

Operator Pickrell Drilling Company

Address 205 Litwin Bldg., Wichita, Kansas 67202

Well No. 2 Lease Name Matson Estate

Footage Location
 feet from (N) (S) line feet from (E) (W) line

Principal Contractor Pickrell Drilling Company Geologist Bill Klaver

Spud Date 10-21-81 Date Completed 11-2-81 Total Depth 4212' P.B.T.D.

Directional Deviation Oil and/or Gas Purchaser

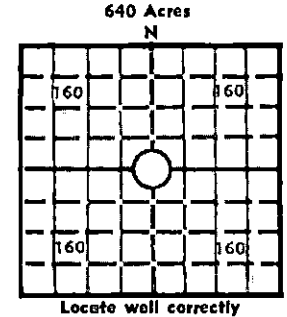

Locate well correctly
 Elev.: Gr. _____
 DF _____ KB _____

CASING RECORD

Report of all strings set — surface, intermediate, production, etc.

Purpose of string	Size hole drilled	Size casing set (in O.D.)	Weight lbs/ft.	Setting depth	Type cement	Sacks	Type and percent additives
Surf Casing	12 1/4	8 5/8		206		175	

LINER RECORD

PERFORATION RECORD

Top, ft.	Bottom, ft.	Sacks cement	Shots per ft.	Size & type	Depth interval

TUBING RECORD

Size	Setting depth	Packer set at

ACID, FRACTURE, SHOT, CEMENT SQUEEZE RECORD

Amount and kind of material used	Depth interval treated

INITIAL PRODUCTION

Date of first production	Producing method (flowing, pumping, gas lift, etc.)
RATE OF PRODUCTION PER 24 HOURS	
Oil	Gas
Water	
Disposition of gas (vented, used on lease or sold)	Producing interval (s)

RECEIVED
 STATE CORPORATION COMMISSION
 NOV 10 1981
 CONSERVATION DIVISION
 Wichita, Kansas
 CFPB

INSTRUCTIONS: As provided in KCC Rule 82-2-125, within 90 days after completion of a well, one completed copy of this Drillers Log shall be transmitted to the State Geological Survey of Kansas, 4150 Monroe Street, Wichita, Kansas 67209. Copies of this form are available from the Conservation Division, State Corporation Commission, 245 No. Water, Wichita, Kansas 67202. Phone AC 316-522-2206. If confidential custody is desired, please note Rule 82-2-125. Drillers Logs will be on open file in the Oil and Gas Division, State Geological Survey of Kansas, Lawrence, Kansas 66044.

Operator Pickrell Drilling Company		DESIGNATE TYPE OF COMP.: OIL, GAS, DRY HOLE, SWDW, ETC.: Dry Hole
Well No. 2	Lease Name Matson Estate	
S <u>31</u> T <u>29S</u> R <u>6</u> ^E _W		

WELL LOG

Show all important zones of porosity and contents thereof; cored intervals, and all drill-stem tests, including depth interval tested, cushion used, time tool open, flowing and shut-in pressures, and recoveries.

SHOW GEOLOGICAL MARKERS, LOGS RUN, OR OTHER DESCRIPTIVE INFORMATION.

FORMATION DESCRIPTION, CONTENTS, ETC.	TOP	BOTTOM	NAME	DEPTH
DST #1 4122'-4132' 30"-30"-60"-60", Rec. 90' oil spk mud, IFP 115#-150#, FFP 104#-104#, ISIP 1139#, FSIP 1590#.			Heebner Lansing Stark Base/Kansas City	3050(-1589) 3276(-1815) 3704(-2243) 3804(-2343)
DST #2 4126'-4147' 30"-60"-90"-90", strong blow Rec. 40' SI oil cut mud, 186' Oil cut gsy mud (12% oil), IFP 115#-115#, FFP 127#-127#, ISIP 959#, FSIP 959#.			Mississippian	4112(-6251)
DST #3 4145'-4162' 30"-60"-90"-90", GTS 50" 2nd open GA 5.6 MCF, Rec. 220' Oil & gas cut mud (10% oil), 120' Oil & gas cut muddy water (10% oil 40% water Chl. 50,000 PPM), IFP 185#-185#, FFP 185#-185#, ISIP 1195#, FSIP 1162#.				

USE ADDITIONAL SHEETS, IF NECESSARY, TO COMPLETE WELL RECORD.

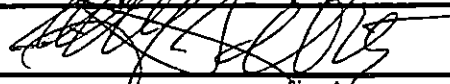
Date Received	
	C.W. Sebitts Signature Partner
	Title 11-9-81
	Date

ROTARY DRILLING LOG

COMPANY: Pickrell Drilling Company
205 Litwin Bldg.
Wichita, Kansas 67202

Rotary Drilling Commenced 10-21-81

LOCATION: Matson Estate #2
W/2 SW, Sec. 31-29S-6W
Kingman County, Kansas

Rotary Drilling Completed 11-2-81

CONTRACTOR: **PICKRELL DRILLING COMPANY**
Wichita, Kansas

CASING RECORD: Spud date 10-21-81, Surf pipe 8 5/8", set @ 206' w/175 sacks/

LOG

(Figures indicate bottom of formation — measurements from top of rotary bushing.)

0 - 217	Red Bed
217 - 617	Red Bed & Shale
617 - 1370	Shale
1370- 1575	Shale & Lime
1575- 1875	Lime & Shale
1875- 2175	Shale
2175- 2422	Shale & Lime
2422- 2655	Lime & Shale
2655- 3165	Shale & Lime
3165- 3385	Lime
3385- 3695	Lime & Shale
3695- 3790	Shale & Lime
3790- 3920	Lime
3920- 4020	Lime & Shale
4020- 4132	Shale & Miss.
4132- 4147	Shale
4147- 4150	Miss.
4150- 4162	Shale
4162- 4212	Miss.

RECEIVED
STATE CORPORATION COMMISSION

NOV 10 1981

CONSERVATION DIVISION
Wichita, Kansas

The undersigned, C.W. Sebitts, Attorney-in-Fact for PICKRELL DRILLING COMPANY, hereby certifies in behalf of said Company, that the above is a true and correct log of the formation encountered in drilling the above well as reflected by the Daily Drilling Reports.

PICKRELL DRILLING COMPANY

By [Signature]
C.W. Sebitts Attorney-in-Fact

STATE OF KANSAS }
COUNTY OF SEDGWICK } ss.:

On this 9 day of November, 1981, before me the undersigned, a Notary Public, in and for

the County and State aforesaid, personally appeared C.W. Sebitts, to me known to be the identical person who subscribed the name of PICKRELL DRILLING COMPANY to the foregoing instrument as its Attorney-in-Fact and acknowledged to me that he executed the same as his free and voluntary act and deed, and as the free and voluntary act and deed of such company, for the uses and purposes therein set forth.

Given under my hand and seal of office the day and year last above written.

My commission expires:

JANA LEA SCHNEWEIS
12-9-82 STATE NOTARY PUBLIC
Sedgwick County, Kansas

[Signature]
Jana Lea Schneewis
Notary Public