

Give All Information Completely
Make Required Affidavit
Mail or Deliver Report to:
Conservation Division
State Corporation Commission
211 No. Broadway
Wichita, Kansas

WELL PLUGGING RECORD

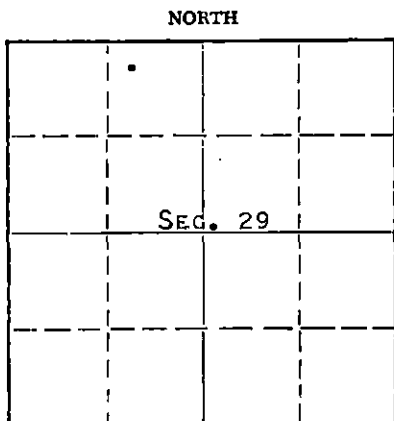

Locate well correctly on above
Section Plat

KINGMAN County. Sec. 29 Twp. 29 Rge. (E) 6 (W)
Location as "NE/CNWxSWx" or footage from lines 150' NW/NE NW
Lease Owner PETROLEUM, INC.,
Lease Name BENTLEY Well No. 1
Office Address ROUTE #2, GREAT BEND, KANSAS
Character of Well (completed as Oil, Gas or Dry Hole) DRY HOLE
Date well completed 8-9- 19 64
Application for plugging filed 8-9- 19 64
Application for plugging approved 8-9- 19 64
Plugging commenced 8-9- 19 64
Plugging completed 8-9- 19 64
Reason for abandonment of well or producing formation NO PRODUCIBLE ZONES

If a producing well is abandoned, date of last production - 19
Was permission obtained from the Conservation Division or its agents before plugging was commenced? YES

Name of Conservation Agent who supervised plugging of this well ARCHIE ELVING, BOX 248, PRATT, KANSAS
Producing formation _____ Depth to top _____ Bottom _____ Total Depth of Well 4164 Feet
Show depth and thickness of all water, oil and gas formations.

OIL, GAS OR WATER RECORDS

CASING RECORD

FORMATION	CONTENT	FROM	TO	SIZE	PUT IN	PULLED OUT
				8-5/8"	256'	NONE

Describe in detail the manner in which the well was plugged, indicating where the mud fluid was placed and the method or methods used in introducing it into the hole. If cement or other plugs were used, state the character of same and depth placed, from _____ feet to _____ feet for each plug set.

MUDDED UP WITH HEAVY MUD TO 250', FOLLOWED BY A WOODEN PLUG, 1/4 SACK HULLS AND 25 SACKS CEMENT. MUDDED UP WITH HEAVY MUD TO 40', FOLLOWED BY A WOODEN PLUG, 1/4 SACK HULLS AND 10 SACKS CEMENT TO BASE OF WELL CELLAR.

RECEIVED
STATE CORPORATION COMMISSION

AUG 24 1964

CONSERVATION DIVISION
Wichita, Kansas

(If additional description is necessary, use BACK of this sheet)

Name of Plugging Contractor GARVEY DRILLING COMPANY
Address ROUTE #2, GREAT BEND, KANSAS

STATE OF KANSAS, COUNTY OF BARTON, ss.
MONTE CHADD (employee of owner) or (owner) of the above-described

well, being first duly sworn on oath, says: That I have knowledge of the facts, statements, and matters herein contained and the log of the above-described well as filed and that the same are true and correct. So help me God. MONTE CHADD, DIST. PROD. SUPT.

(Signature) [Signature]
ROUTE #2, GREAT BEND, KANSAS
(Address)

SUBSCRIBED AND SWORN TO before me this 21 day of AUGUST, 19 64

My commission expires SEPTEMBER 23, 1967

Notary Public.

WELL LOG

COMPANY Petroleum, Inc.

SEC. 29 T-29S R. 6W

FARM Bentley NO. 1

LOC. App 150' NW of NE-NW

TOTAL DEPTH 4164'

COUNTY Kingman, Kansas

COMM. 7-30-64 COMP. 8-9-64

CONTRACTOR Garvey Drilling Company

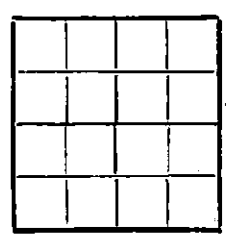

CASING 8 5/8" @ 256' w/225 sx

ELEVATION 1531' DF

PRODUCTION D & A.

FIGURES INDICATE BOTTOM OF FORMATIONS

- 45' Sand
- 70' Clay and Red Bed
- 420' Red Bed and Shale
- 1032' Shale
- 1465' Lime and Shale
- 1815' Lime
- 2480' Lime and Shale
- 2887' Shale and Lime
- 3093' Lime and Shale
- 3130' Douglas Sand
- 3180' Lime
- 3295' Lime and Shale
- 4164' Lime
- 4164' RTD

RECEIVED
STATE CORPORATION COMMISSION

AUG 24 1964

CONSERVATION DIVISION
Wichita, Kansas

State of Kansas }
County of Barton } ss

I, Sam N. Stephens of Garvey Drilling Company

upon oath state the above and foregoing is a true and correct copy of the log of the Bentley #1 well.

Sam N. Stephens

Subscribed and sworn to before me this 19th day of August 1964

My Commission Expires: September 23, 1967

Howard C. Quinn
NOTARY PUBLIC