

STATE OF KANSAS
STATE CORPORATION COMMISSION

WELL PLUGGING RECORD

Give All Information Completely
Make Required Affidavit
Mail or Deliver Report to
Conservation Division
State Corporation Comm.
245 North Water
Wichita, KS 67202

Stevens County, Sec. 24 Twp. 32S Rge. 39 ~~W~~
Location as "NE/CNW $\frac{1}{4}$ SW $\frac{1}{4}$ " or footage from lines
1250' FNL & 2590' FEL
Lease Owner Anadarko Production Company
Lease Name SHIRLEY "A" Well No. 1
Office Address P. O. Box 351, Liberal, Kansas 67901
Character of Well (Completed as Oil, Gas or Dry Hole)

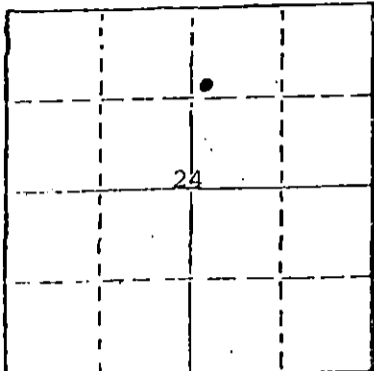

Locate well correctly on above
Section Plat

DRY HOLE
Date Well completed 7/7 1980
Application for plugging filed 8/22 1980
Application for plugging approved verbal 7/7 1980
Plugging commenced 7/6 1980
Plugging completed 7/7 1980
Reason for abandonment of well or producing formation

DRY HOLE
If a producing well is abandoned, date of last production 19

Was permission obtained from the Conservation Division or its agents before plugging was commenced? yes

Name of Conservation Agent who supervised plugging of this well Clarence Thomas
Producing formation Depth to top Bottom Total Depth of Well 6045'
Show depth and thickness of all water, oil and gas formations.

OIL, GAS OR WATER RECORDS

CASING RECORD

FORMATION	CONTENT	FROM	TO	SIZE	PUT IN	PULLED OUT
				8-5/8"	1657'	-0-

Describe in detail the manner in which the well was plugged, indicating where the mud fluid was placed and the method or methods used in introducing it into the hold. If cement or other plugs were used, state the character of same and depth placed, from feet to feet for each plug set.

Spotted 25 sxs cmt @ 2950, 25 sxs @ 2600, 35 sxs @ 1650, 25 sxs @ 750, 10 sxs 40-0, 5 sxs rathole.

RECEIVED
STATE CORPORATION COMMISSION

AUG 26 1980

CONSERVATION DIVISION
Wichita, Kansas

(If additional description is necessary, use BACK of this sheet)

Name of Plugging Contractor Gabbert-Jones, Inc.

STATE OF KANSAS COUNTY OF SEWARD, ss.
Paul Campbell (employee of owner) or ~~owner or operator~~
of the above-described well, being first duly sworn on oath, says: That I have knowledge of the facts, statements, and matters herein contained and the log of the above-described well as filed and that the same are true and correct. So help me God.

(Signature) Paul Campbell
P. O. Box 351, Liberal, Kansas 67901
(Address)

SUBSCRIBED AND SWORN TO before me this 25th day of August, 1980

STATE NOTARY PUBLIC
BEVERLY J. WILLIAMS
Seward County, Kansas
My Appt. Exp. 11/21/82

Beverly J. Williams
Notary Public.

My commission expires November 21, 1982

15-189-20513-0000

KANSAS

WELL COMPLETION REPORT AND
DRILLER'S LOG

S. 24 T. 32S R. 39 Ex
W
Loc. 1250' FNL & 2590' FEL
County Stevens

API No. 15 — 189 — 20,513
County Number

Operator
Anadarko Production Company

Address
P. O. Box 351, Liberal, Kansas 67901

Well No. 1 Lease Name SHIRLEY "A"

Footage Location
1250 feet from (N) 1/4 line 2590 feet from (E) 1/4 line

Principal Contractor Geologist
Gabbert-Jones, Inc. Joe Blair

Spud Date Date Completed Total Depth P.B.T.D.
6/22/80 7/7/80 6045'

Directional Deviation Oil and/or Gas Purchaser
Not applicable DRY HOLE

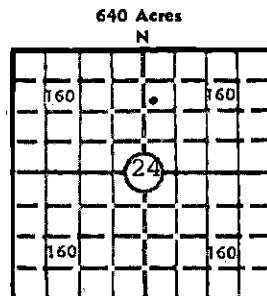

Locate well correctly
Elev.: Gr. 3144'
DF 3147' KB 3148'

CASING RECORD

Report of all strings set — surface, intermediate, production, etc.

Purpose of string	Size hole drilled	Size casing set (in O.D.)	Weight lbs/ft.	Setting depth	Type cement	Sacks	Type and percent additives
Surface	12-1/4"	8-5/8"	24#	1657'	Pozmix Common	600 200	4% gel 2% CaCl 2% CaCl

LINER RECORD

PERFORATION RECORD

Top, ft.	Bottom, ft.	Sacks cement	Shots per ft.	Size & type	Depth interval

TUBING RECORD

Size	Setting depth	Packer set at

ACID, FRACTURE, SHOT, CEMENT SQUEEZE RECORD

Amount and kind of material used	Depth interval treated

RECEIVED
STATE CORPORATION COMMISSION

AUG 26 1980

CONSERVATION DIVISION
Wichita, Kansas

INITIAL PRODUCTION

Date of first production Producing method (flowing, pumping, gas lift, etc.)
DRY HOLE

RATE OF PRODUCTION PER 24 HOURS
Oil Gas Water Gas-oil ratio
bbls. MCF bbls. CFPB

Disposition of gas (vented, used on lease or sold) Producing interval (s)

INSTRUCTIONS: As provided in KCC Rule 82-2-125, within 90 days after completion of a well, one completed copy of this Drillers Log shall be transmitted to the State Geological Survey of Kansas, 4150 Monroe Street, Wichita, Kansas 67209. Copies of this form are available from the Conservation Division, State Corporation Commission, 245 No. Water, Wichita, Kansas 67202. Phone AC 316-522-2206. If confidential custody is desired, please note Rule 82-2-125. Drillers Logs will be on an open file in the Oil and Gas Division, State Geological Survey of Kansas, Lawrence, Kansas 66044.

Operator Anadarko Production Company		DESIGNATE TYPE OF COMP.: OIL, GAS, DRY HOLE, SWDW, ETC.:
Well No. 1	Lease Name SHIRLEY "A"	DRY HOLE
S 24 T 32S R 39 E W		

WELL LOG

Show all important zones of porosity and contents thereof; cored intervals, and all drill-stem tests, including depth interval tested, cushion used, time tool open, flowing and shut-in pressures, and recoveries.

SHOW GEOLOGICAL MARKERS, LOGS RUN, OR OTHER DESCRIPTIVE INFORMATION.

FORMATION DESCRIPTION, CONTENTS, ETC.	TOP	BOTTOM	NAME	DEPTH
Sand, Redbed	0'	909'	LOGS: Schlumberger Dual Induction-SFL Compensated Neutron- Formation Density	
Sand, Redbed, Anhydrite	909'	1164'		
Sand, Anhydrite	1164'	1374'		
Sand, Redbed	1374'	1558'		
Anhydrite, Sand, Redbed	1558'	1816'		
Shale, Lime, Redbed	1816'	2500'		
Lime, Shale	2500'	5850'		
Shale, Lime	5850'	5880'		
Lime, Shale	5880'	6050'		
TD		6050'		
<p>DST #1 5850-88 (Morrow) op 30 M w/vry wk blow, 30-60-60-120, 2nd op no blow rec, 10' DM, HP 2891-2891, IFP 35-35, ISIP 1410 (60), FFP 45-42, FSIP 1271 (120), temp 143 deg.</p> <p>DST #2 5870-5947 (Keyes) 30-60-60-120, op 30 GTS after SI, op 60 40M ga 3.8 MCFD-stab, rec 600' O&GCM, 360' GCSW, IFP 114-148, ISIP 1356 (60), FFP 148-218, FSIP 1380 (120), HP 2699-2633.</p>				

USE ADDITIONAL SHEETS, IF NECESSARY, TO COMPLETE WELL RECORD.

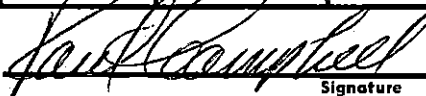
Date Received	 Signature Paul Campbell, Division Production Manager Title August 22, 1980 Date
---------------	---