

STATE OF KANSAS  
STATE CORPORATION COMMISSION

Form CP-4

Give All Information Completely  
Make Required Affidavit  
Mail or Deliver Report to:  
Conservation Division  
State Corporation Commission  
212 No. Market  
Wichita, Kansas 67202

WELL PLUGGING RECORD

Kingman County, Sec. 36 Twp. 29S. Rge. (E) 10 (W)  
Location as "NE/CNW&SW" or footage from lines C N/2 SW NE  
Lease Owner Donald T. Ingling et al  
Lease Name Liebl Well No. 1  
Office Address 615 First National Bldg., Wichita, Ksn 67202  
Character of Well (completed as Oil, Gas or Dry Hole) Dry hole  
Date well completed 8-21 1970  
Application for plugging filed 8-21 1970  
Application for plugging approved 8-21 1970  
Plugging commenced 8-24 1970  
Plugging completed 8-27 11:30 1970  
Reason for abandonment of well or producing formation Dry

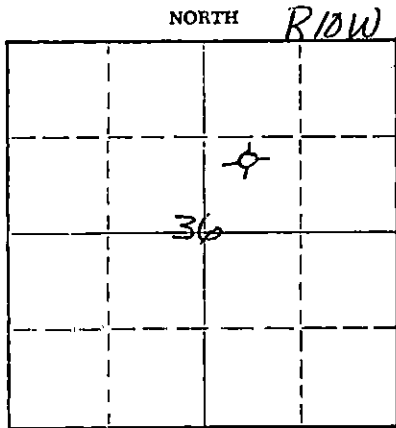

Locate well correctly on above Section Plat

If a producing well is abandoned, date of last production None 19  
Was permission obtained from the Conservation Division or its agents before plugging was commenced? Yes

Name of Conservation Agent who supervised plugging of this well G. Russell Biberstein, Attica, Ks. 67009  
Producing formation \_\_\_\_\_ Depth to top \_\_\_\_\_ Bottom \_\_\_\_\_ Total Depth of Well 4517 Feet  
Show depth and thickness of all water, oil and gas formations.

OIL, GAS OR WATER RECORDS

CASING RECORD

FORMATION	CONTENT	FROM	TO	SIZE	PUT IN	PULLED OUT
				8-5/8	330	none
				5-1/2	4491	3800

Describe in detail the manner in which the well was plugged, indicating where the mud fluid was placed and the method or methods used in introducing it into the hole. If cement or other plugs were used, state the character of same and depth placed, from \_\_\_\_\_ feet to \_\_\_\_\_ feet for each plug set.

Dump chat (1 yd.) From 4450' to 4392'  
5 sacks of cement From 4392' to 4351'

Ripped pipe at 3800' and pulled

Build wood bridge at 260'  
Rock from 260' to 250'

Ready Mix Cement (4 yds.) from 250' to Bottom of collar

RECEIVED  
STATE CORPORATION COMMISSION  
OCT 9 1970  
CONSERVATION DIVISION  
Wichita, Kansas

10-9-70

(If additional description is necessary, use BACK of this sheet)

Name of Plugging Contractor Clarke Corporation  
Address Box 187, Medicine Lodge, Kansas 67104

STATE OF KANSAS, COUNTY OF BARBER, ss.  
Elma Morgenstern (employee of owner) or (owner or operator) of the above-described well, being first duly sworn on oath/says: That I have knowledge of the facts, statements, and matters herein contained and the log of the above-described well as filed and that the same are true and correct. So help me God.

(Signature) Elma Morgenstern  
Medicine Lodge, Kansas  
(Address)

SUBSCRIBED AND SWORN TO before me this 9th day of September, 1970

My commission expires April 4, 1974

Notary Public.

15-095-20198-0000

KANSAS GEOLOGICAL SOCIETY  
KANSAS WELL LOG BUREAU - KANSAS WELL SAMPLE BUREAU  
KANSAS GEOLOGICAL SOCIETY BUILDING  
508 EAST MURDOCK - WICHITA, KANSAS

COMPANY Donald T. Ingling, et al  
FARM Liebl NO. 1

SEC. 36 T. 29S R. 10W  
LOC. CN/2 SW NE

TOTAL DEPTH 4,517'  
COMM. August 1, 1970  
SHOT OR TREATED  
CONTRACTOR H-30, Inc.  
ISSUED

COMP. August 12, 1970

COUNTY Kingman  
KANSAS

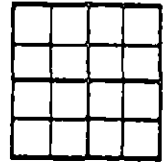

CASINO

20 10  
15 8-5/8" 330' cemented w/225 sx cement ELEVATION 1631 KB  
12 6  
13 5-1/2" 4491' cemented w/800 sx cement PRODUCTION

FIGURES INDICATE BOTTOM OF FORMATIONS

Sand & Clay 75  
Red Beds & Shale 330  
Shale 1635  
Lime & Shale 2025  
Shale & Lime 2945  
Lime & Shale 3530  
Shale & Lime 3620  
Lime 4230  
Shale & Lime 4390  
Lime 4453  
Lime & Chert 4465  
Lime & Shale 4510  
Lime & Sand 4517

SAMPLE TOPS:

Heebner Shale 3390 - 1759  
Lansing K.C. 3611 - 1980  
B Pen. Cong. 4186 - 2555  
Mississippian LS. 4228 - 2597  
Kinderhook 4236 - 2605  
Chattanooga Shale 4401 - 2770  
Viola 4427 - 2796  
Simpson Shale 4477 - 2846  
Simpson Sand 4498 - 2867  
Rotary Total Depth 4517 - 2886

I hereby certify the above and foregoing to be a true and correct log of the above described well as shown by the drilling reports.

H-30, INC.

*Dean E. Britting*  
Dean E. Britting

STATE OF KANSAS

COUNTY OF SEDGWICK

SS:

Subscribed and Sworn to before me a Notary Public in and said county and state this 19th. day of August, 1970.

*Elsie Willison*  
Elsie Willison - Notary Public

My Commission Expires:

June 30, 1974

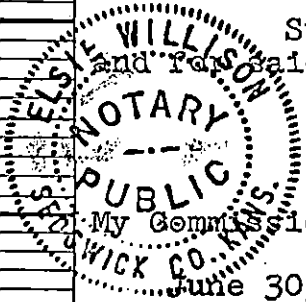

RECEIVED  
STATE CORPORATION COMMISSION  
AUG 21 1970  
CONSERVATION DIVISION  
Wichita, Kansas

8-21-70