

EFFECTIVE DATE: 2-19-91

NOTICE OF INTENTION TO DRILL

Must be approved by the K.C.C. five (5) days prior to commencing well

Expected Spud Date February 16, 1991  
month day year

C - NW NW Sec 36 Twp 28 S, Rg 14 X East West

OPERATOR: License # 5010  
Name: KNIGHTON OIL COMPANY, INC.  
Address: 710 Petroleum Building  
City/State/Zip: Wichita, Kansas 67202  
Contact Person: Earl Knighton  
Phone: 316/264-7918

4620 feet from South line of Section   
4620 feet from East line of Section   
(Note: Locate well on Section Plat on Reverse Side)

CONTRACTOR: License #: 5929  
Name: DUKE DRILLING CO., INC.

County: Pratt  
Lease Name: Beard Well #: 2  
Field Name: Earl North  
Is this a Prorated Field? yes  no   
Target Formation(s): Arbuckle  
Nearest lease or unit boundary: 660'  
Ground Surface Elevation: Unknown feet MSL   
Domestic well within 330 feet: yes  no   
Municipal well within one mile: yes  no   
Depth to bottom of fresh water: 180'  
Depth to bottom of usable water: 260'  
Surface Pipe by Alternate:  1  2   
Length of Surface Pipe Planned to be set: 280'  
Length of Conductor pipe required: None  
Projected Total Depth: 4600'  
Formation at Total Depth: Arbuckle  
Water Source for Drilling Operations:  
... well ... farm pond  other

Well Drilled For: Well Class: Type Equipment:  
 Oil ... Inj  Infield  Mud Rotary   
... Gas ... Storage ... Pool Ext. ... Air Rotary  
... OWWO ... Disposal ... Wildcat ... Cable  
... Seismic; ... # of Holes

If OWD: old well information as follows:  
Operator: \_\_\_\_\_  
Well Name: \_\_\_\_\_  
Comp. Date: \_\_\_\_\_ Old Total Depth \_\_\_\_\_

Directional, Deviated or Horizontal wellbore? ... yes  no   
If yes, total depth location: \_\_\_\_\_

DWR Permit #: \_\_\_\_\_  
Will Cores Be Taken? ... yes  no   
If yes, proposed zone: \_\_\_\_\_

AFFIDAVIT

The undersigned hereby affirms that the drilling, completion and eventual plugging of this well will comply with K.S.A. 55-101, et. seq.

It is agreed that the following minimum requirements will be met:

1. The appropriate district office shall be notified before setting surface pipe;
2. The minimum amount of surface pipe as specified above shall be set by circulating cement to the top; in all cases surface pipe shall be set through all unconsolidated materials plus a minimum of 20 feet into the underlying formation;
3. If the well is dry, a plugging proposal shall be submitted to the district office. An agreement between the operator and the district office on plug length and placement is necessary prior to plugging;
4. The appropriate district office will be notified before well is either plugged or production casing is cemented in;
5. If an Alternate II completion, production pipe shall be cemented from below any usable water to surface within 120 days of spud date. In all cases, notify district office prior to any cementing.

I hereby certify that the statements made herein are true and to the best of my knowledge and belief.

Date: 2/13/91 Signature of Operator or Agent: Sally R. Byers Title: Agent

W  
A  
L  
K  
I  
N

FOR KCC USE:

API # 15- 151-22,037-00-00  
 Conductor pipe required None feet  
 Minimum surface pipe required 280 feet per Alt. ①  
 Approved by: MLW 2-14-91  
 EFFECTIVE DATE: 2-19-91  
 This authorization expires: 8-14-91  
 (This authorization void if drilling not started within 6 months of effective date.)  
 Spud date: \_\_\_\_\_ Agent: \_\_\_\_\_

STATE CORPORATION COMMISSION  
2-13-91  
FEB 13 1991  
CONSERVATION DIVISION  
Wichita, Kansas

REMEMBER TO:

- File Drill Pit Application (form CDP-1) with Intent to Drill;
- File Completion Form ACO-1 within 120 days of spud date;
- File acreage attribution plat according to field proration orders;
- Notify appropriate district office 48 hours prior to workover or re-entry;
- Submit plugging report (CP-4) after plugging is completed;
- Obtain written approval before disposing or injecting salt water.

PLAT OF ACREAGE ATTRIBUTABLE TO A WELL

State Corporation Commission, Conservation Division  
200 Colorado Derby Bldg. Wichita, Kansas 67202

OPERATOR KNIGHTON OIL COMPANY, INC. LOCATION OF WELL:  
 LEASE BEARD 4620 feet north of SE corner  
 WELL NUMBER 2 4620 feet west of SE corner  
 FIELD Earl North NW/4 Sec. 36 T 28S R 14 N/W  
 COUNTY Pratt  
 NO. OF ACRES ATTRIBUTABLE TO WELL 10 IS SECTION X REGULAR     IRREGULAR?  
 DESCRIPTION OF ACREAGE NW/4 IF IRREGULAR, LOCATE WELL FROM NEAREST  
 CORNER BOUNDARY.

NOTE: If plat depicted is insufficient for your circumstances, you may attach your own scaled or surveyed plat.

PLAT

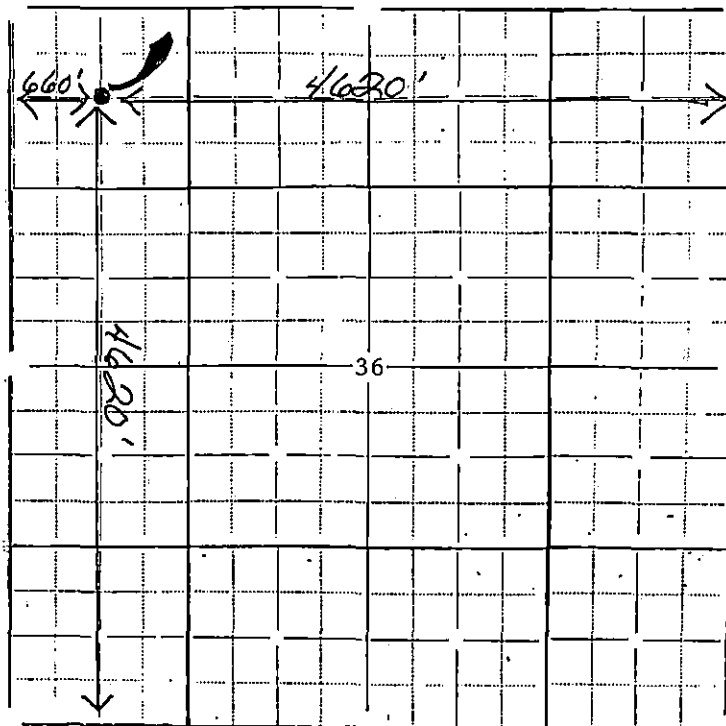

In plotting the proposed location of the well, you must show:

- 1) The manner in which you are using the depicted plat by identifying section lines, i.e. 1 section, 1 section with 8 surrounding partial sections, 4 sections, 16 sections, etc.;
- 2) the well's location relative to the location of other wells producing from the same common source of supply in adjoining drilling units, pursuant to K.A.R. 82-3-108, 82-3-207, 82-3-312, or special orders of the Commission;
- 3) the distance of the proposed drilling location from the section's east and south lines;
- 4) the distance to the nearest lease or unit boundary line.

I hereby certify that the statements made herein are true and to the best of my knowledge and belief.

Signature of Operator or Agent Dally H. Myers  
 Date February 13, 1991 Title Agent