

STATE CORPORATION COMMISSION OF KANSAS
OIL & GAS CONSERVATION DIVISION
WELL COMPLETION OR RECOMPLETION FORM
ACO-1 WELL HISTORY
DESCRIPTION OF WELL AND LEASE

S

API NO. 15-..... N/A 095-20,404-0000

County..... Kingman
150' E of
C..... SW..... SE Sec. 22 Twp. 29 Rge. 8 East
K.C.C. West

Operator: License # 5123
Name..... Pickrell Drilling Company, Inc.
Address..... 110 N. Market
Suite 205
City/State/Zip..... Wichita, KS 67202

..... 660 Ft North from Southeast Corner of Section
..... 1930 Ft West from Southeast Corner of Section
(Note: Locate well in section plat below)

Purchaser..... Koch

Lease Name..... Young 'K' Well # 3

Operator Contact Person..... Jack Gurley
Phone..... 262-8427

Field Name..... Belmont Center

Contractor: License # 5123
Name..... Pickrell Drilling Company, Inc.

Producing Formation..... Mississippi

Wellsite Geologist..... Richard Linehan
Phone.....

Elevation: Ground..... 1620 KB..... 1625

Designate Type of Completion
 New Well Re-Entry Workover
 Oil SWD Temp Abd
 Gas Inj Delayed Comp.
 Dry Other (Core, Water Supply etc.)

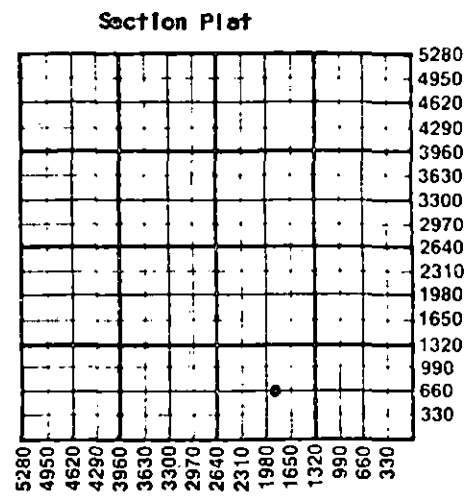

If ONWO: old well info as follows:
Operator.....
Well Name.....
Comp. Date..... Old Total Depth.....

WATER SUPPLY INFORMATION

Disposition of Produced Water: Disposal
Docket #..... Repressuring

WELL HISTORY

Drilling Method:
 Mud Rotary Air Rotary Cable
6-2-75..... 6-11-75..... 7-16-75.....
Spud Date Date Reached TD Completion Date
4290'..... 4250' (Loggers)
Total Depth PBTD

Questions on this portion of the ACO-1 call:
Water Resources Board (913) 296-3717

Source of Water:
Division of Water Resources Permit #..... N/A

Amount of Surface Pipe Set and Cemented at 203 feet
Multiple Stage Cementing Collar Used? Yes No
If yes, show depth set..... feet
If alternate 2 completion, cement circulated
from..... feet depth to..... w/..... SX cmt
Cement Company Name.....
Invoice #.....

Groundwater..... Ft North from Southeast Corner
(Well)..... Ft West from Southeast Corner of
Sec Twp Rge East West

Surface Water..... Ft North from Southeast Corner
(Stream, pond etc)..... Ft West from Southeast Corner
Sec Twp Rge East West

Other (explain).....
(purchased from city, R.W.D. #)

INSTRUCTIONS: This form shall be completed in triplicate and filed with the Kansas Corporation Commission, 200 Colorado Derby Building, Wichita, Kansas 67202, within 120 days of the spud date of any well. Rule 82-3-130, 82-3-107 and 82-3-106 apply. Information on side two of this form will be held confidential for a period of 12 months if requested in writing and submitted with the form. See rule 82-3-107 for confidentiality in excess of 12 months. One copy of all wireline logs and drillers time log shall be attached with this form. Submit CP-4 form with all plugged wells. Submit CP-111 form with all temporarily abandoned wells.

All requirements of the statutes, rules and regulations promulgated to regulate the oil and gas industry have been fully complied with and the statements herein are complete and correct to the best of my knowledge.

Signature.....
Title..... C.W. Sebitts, President Date..... 10-7-86

K.C.C. OFFICE USE ONLY
F Letter of Confidentiality Attached
C Wireline Log Received
C Drillers Timelog Received
Distribution
 KCC SWD/Rep NGPA
 KGS Plug Other
(Specify)
RECEIVED
STATE CORPORATION COMMISSION
CONS. DIV. WICHITA, KS

Subscribed and sworn to before me this 7th day of October 1986
Notary Public..... Katherine J. Rule
Date Commission Expires..... 6-29-88

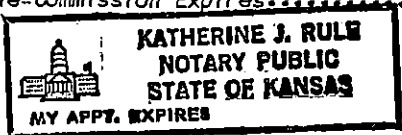

10-14-86
OCT 14 1986

Sec 29 Twp 29 Rge 3 W

Operator Name Pickrell Drilling Company, Inc. Lease Name Young 'K' Well # 3

Sec. 22 Twp. 29S Rge. 8 East West County Kingman

WELL LOG

INSTRUCTIONS: Show important tops and base of formations penetrated. Detail all cores. Report all drill stem tests giving interval tested, time tool open and closed, flowing and shut-in pressures, whether shut-in pressure reached static level, hydrostatic pressures, bottom hole temperature, fluid recovery, and flow rates if gas to surface during test. Attach extra sheet if more space is needed. Attach copy of log.

Drill Stem Tests Taken Yes No
 Samples Sent to Geological Survey Yes No
 Cores Taken Yes No

Formation Description
 Log Sample

DST #1 4173-4200, 30"-30"-5"-60", GTS 2", GA 1860MCF in 20". Rec. 190' CGO, 20' HO&GCthin mud, IFP 386#-481#, FFP 522#-522#, ISIP 1305#, FSIP 1315#.

DST #2 4200-4217, 30"-30"-90"-60", GTS 4", GA 542MCF/10", 411MCF/30", 2nd op GA 480MCF/10", 332MCF/30", 221MCF/60", Oil to surface 75", Rec. 1170' gsoil, 30' mud water. IFP 83#-167#, FFP 188#-407#, ISIP 1305#, FSIP 1315#.

DST #3 4220-4235, 30"-30"-90"-60", GTS 2". 2nd op GA 9MCF/10", 18MCF/20", 12MCF at end of test, Rec. 90' O&GCM, 60' MCGO. IFP 41#-41#, FFP 52#-83#, ISIP 1252#, FSIP 1252#

Name	Top	Bottom
Heebner	3211(-1568)	
Lansing	3435(-1810)	
Stark	3837(-2212)	
B/Kansas City	3924(-2299)	
Mississippi	4169(-2544)	

CASING RECORD <input checked="" type="checkbox"/> New <input type="checkbox"/> Used							
Report all strings set-conductor, surface, intermediate, production, etc.							
Purpose of String	Size Hole Drilled	Size Casing Set (In O.D.)	Weight Lbs/Ft.	Setting Depth	Type of Cement	#Sacks Used	Type and Percent Additives
Surface	12 1/4"	8 5/8"		230'	common	165	
Production	7 7/8"	4 1/2"	10.5#	4289'	common	120	
PERFORATION RECORD				Acid, Fracture, Shot, Cement Squeeze Record (Amount and Kind of Material Used)			
Shots Per Foot	Specify Footage of Each Interval Perforated					Depth	
2	4202-4210			250 gal. 15% NE acid		4202-10	
				3024 gal. GW spearhead			
				5040 gal. GSW w/3500# 20-40sd			
TUBING RECORD				Liner Run <input type="checkbox"/> Yes <input checked="" type="checkbox"/> No			
Date of First Production		Size <u>2 3/8"</u> Set At <u>4192'</u> Packer at					
7-16-75		Producing Method <input checked="" type="checkbox"/> Flowing <input type="checkbox"/> Pumping <input type="checkbox"/> Gas Lift <input type="checkbox"/> Other (explain).....					
Estimated Production Per 24 Hours		Oil	Gas	Water	Gas-Oil Ratio	Gravity	
➔		22 Bbls	550 MCF				

METHOD OF COMPLETION

Production Interval

Disposition of gas: Vented Open Hole Perforation
 Sold Other (Specify) 4202-4210
 Used on Lease Dually Completed
 Commingled

