

STATE CORPORATION COMMISSION OF KANSAS
OIL & GAS CONSERVATION DIVISION

WELL COMPLETION OR RECOMPLETION FORM
ACO-1 WELL HISTORY

DESCRIPTION OF WELL AND LEASE

Operator: License # 5673
Name W. L. Kirkman, Inc.
Address 453 S. Webb Road
P.O. Box 18611
City/State/Zip Wichita, KS 67218

Purchaser Koch Oil Company
Wichita, Kansas

Operator Contact Person Wayne L. Kirkman
Phone 316-685-5372

Contractor: License # 5829
Name Aldebaran Drilling Co., Inc.

Wellsite Geologist L. Kristopher Moore
Phone 316-685-5372

Designate Type of Completion

New Well Re-Entry Workover

Oil SWD Temp Abd
 Gas Inj Delayed Comp.
 Dry Other (Core, Water Supply etc.)

If OWNO: old well info as follows:

Operator
Well Name
Comp. Date Old Total Depth

WELL HISTORY

Drilling Method:

Mud Rotary Air Rotary Cable

8-30-84 9-10-84 11-26-84
Spud Date Date Reached TD Completion Date

4963' 4719
Total Depth PBTD

Amount of Surface Pipe Set and Cemented at 255 feet
Multiple Stage Cementing Collar Used? Yes No
If yes, show depth set feet
If alternate 2 completion, cement circulated from feet depth to w/SX cmt

API NO. 15-191-21-739-00-00

County Sumner

125' W of C.E/2 SE NE Sec 9 Twp 35S Rge 2 East West

3365 Ft North from Southeast Corner of Section
455 Ft West from Southeast Corner of Section
(Note: Locate well in section plat below)

Lease Name Weber Well # 2

Field Name Alton

Producing Formation Simpson

Elevation: Ground 1119 KB 1128

Section Plat

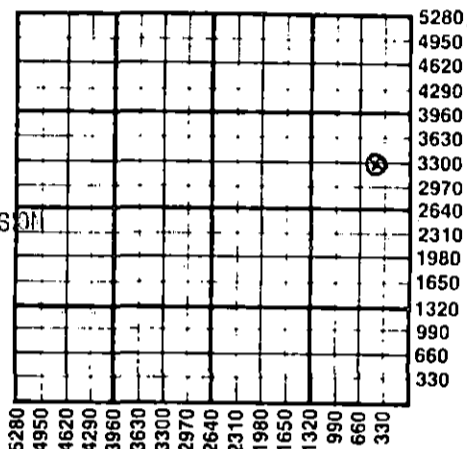

RECEIVED
STATE CORPORATION COMMISSION OF
2-1-1985
FEB 01 1985
CONSERVATION DIVISION
Wichita, Kansas

WATER SUPPLY INFORMATION

Disposition of Produced Water: Disposal Repressuring
Docket #

Questions on this portion of the ACO-1 call:

Water Resources Board (913) 296-3717

Source of Water:

Division of Water Resources Permit #

Groundwater Ft North from Southeast Corner (Well) Ft West from Southeast Corner of Sec Twp Rge East West

Surface Water Ft North from Southeast Corner (Stream, pond etc) Ft West from Southeast Corner Sec Twp Rge East West

Other (explain) (purchased from city, R.W.D. #)

INSTRUCTIONS: This form shall be completed in duplicate and filed with the Kansas Corporation Commission, 200 Colorado Derby Building, Wichita, Kansas 67202, within 90 days after completion or recompletion of any well. Rule 82-3-130 and 82-3-107 apply.

Information on side two of this form will be held confidential for a period of 12 months if requested in writing and submitted with the form. See rule 82-3-107 for confidentiality in excess of 12 months. One copy of all wireline logs and drillers time log shall be attached with this form. Submit CP-4 form with all plugged wells. Submit CP-111 form with all temporarily abandoned wells.

All requirements of the statutes, rules and regulations promulgated to regulate the oil and gas industry have been fully complied with and the statements herein are complete and correct to the best of my knowledge.

Signature L. Kristopher Moore

L. Kristopher Moore

Title Geologist Date 1-15-85

Subscribed and sworn to before me this 15th day of January 1985

Notary Public Kathleen G. Quinn

Kathleen G. Quinn

Date Commission Expires March 20, 1987



K.C.C. OFFICE USE ONLY
F Letter of Confidentiality Attached
C Wireline Log Received
C Drillers Timelog Received
Distribution
 KCC SWD/Rep NGPA
 KGS Plug Other (Specify)

Sec. 9, Twp. 35S, Rge. 2W

SIDE TWO

Operator Name W. L. Kirkman, Inc. Lease Name Weber Well # 2

Sec. 9 Twp. 35S Rge. 2W East West County Sumner

WELL LOG

INSTRUCTIONS: Show important tops and base of formations penetrated. Detail all cores. Report all drill stem tests giving interval tested, time tool open and closed, flowing and shut-in pressures, whether shut-in pressure reached static level, hydrostatic pressures, bottom hole temperature, fluid recovery, and flow rates if gas to surface during test. Attach extra sheet if more space is needed. Attach copy of log.

Drill Stem Tests Taken Yes No
 Samples Sent to Geological Survey Yes No
 Cores Taken Yes No

Formation Description
 Log and Sample

Mississippi (4300-4320)
 chert, dolomitic, white w/ brown stain, very good vuggy porosity, fair crystalline porosity, some fossil cast porosity, strong odor, very good show of light oil, good show of gas, bright fluorescence.

Simpson Sand (4710-4720)
 clear, brown stain, fine to medium angular to subrounded grains, few scattered round grains, friable, fair intergranular porosity, poor to fair sorting, trace of free oil.

Name	Top	Bottom
Iatan	3029*	-1901
Kansas City	3600*	-2472
Base Kansas City	3770*	-2642
Marmaton	3840*	-2712
Mississippi	4292	-3164
Kinderhook Shale	4642	-3514
Chattanooga Shale	4680	-3552
Simpson Sand	4703	-3575
Simpson Sand Porosity	4710	-3582
Arbuckle	4906	-3778

*sample tops

CASING RECORD <input type="checkbox"/> New <input type="checkbox"/> Used							
Report all strings set-conductor, surface, intermediate, production, etc.							
Purpose of String	Size Hole Drilled	Size Casing Set (In O.D.)	Weight Lbs/Ft.	Setting Depth	Type of Cement	#Sacks Used	Type and Percent Additives
Surface	12 1/4"	8 5/8"	23#	255'	Common	200	3% cc 2% gel
Production	7 7/8"	5 1/2"	14#	4923'	60-40 Pot	30	15% Salt
					60-40 Pot	225	Salt Sat
							12# Gils/Sack
PERFORATION RECORD				Acid, Fracture, Shot, Cement Squeeze Record			
Shots Per Foot	Specify Footage of Each Interval Perforated			(Amount and Kind of Material Used)		Depth	
4	4724-4726			500 Gallons 15% MCA		4724-26	
4	4302-4306			500 Gallons 15% NE			
				13 1/2 bbls saltwater		4302-06	
4	4710-4711.5						
TUBING RECORD				Liner Run <input type="checkbox"/> Yes <input checked="" type="checkbox"/> No			
	Size	Set At	Packer at				
	2 7/8	4178.76					
Date of First Production		Producing Method					
No commercial production at this date		<input type="checkbox"/> Flowing <input checked="" type="checkbox"/> Pumping <input type="checkbox"/> Gas Lift <input type="checkbox"/> Other (explain).....					
Estimated Production Per 24 Hours		Oil will prod.	Gas	Water	Gas-Oil Ratio	Gravity	
8 to 10				30			
		Bbls	MCF	Bbls	CFPB		

METHOD OF COMPLETION

Production Interval

Disposition of gas: Vented Sold Used on Lease
 Open Hole Perforation Other (Specify) 4710-4711.5
 Dually Completed Commingled