

API # CORRECTION

SIDE ONE

AFFIDAVIT OF COMPLETION FORM

(REV) ACO-1

This form shall be filed in duplicate with the Kansas Corporation Commission, 200 Colorado Derby Building, Wichita, Kansas 67202, within ten days after the completion of the well, regardless of how the well was completed.

Attach separate letter of request if the information is to be held confidential. If confidential, only file one copy. Information on side one will be of public record and side two will then be held confidential.

Circle one: Oil, Gas, Dry, SWD, OWWO, Injection. Type and complete ALL sections. Applications must be filed for dual completion, commingling, SWD and injection, T.A.

Attach wireline logs (i.e. electrical log, sonic log, gamma ray neutron log, etc.). KCC # (316), 263-3238. (Rules 82-2-105 & 82-2-125)

15,197-21,128-00-00  
~~CC-177852~~

OPERATOR Ceja Corporation

API NO. 15,197-21,128-00-00

ADDRESS 4400 One Williams Center  
Tulsa, Okla. 74172

COUNTY Sumner

FIELD Caldwell

\*\*CONTACT PERSON James Freeman  
PHONE 918-584-7266

PROD. FORMATION Miss. Chat & Wilcox

LEASE Williams

PURCHASER Total Pet. Co.

WELL NO. 1

ADDRESS P.O. Box 500  
Denver, Colo. 80201

WELL LOCATION

660 Ft. from S Line and

330 Ft. from W Line of Lot 3

the SW/4 SEC. 16 TWP. 35S. RGE. 3W

DRILLING CONTRACTOR Curt Brown Drlg. Co.  
ADDRESS Tulsa, Okla.

RECEIVED  
STATE CORPORATION COMMISSION  
FEB 12 1982

PLUGGING CONTRACTOR ADDRESS

CONSERVATION DIVISION  
Wichita, Kansas

WELL FLAT

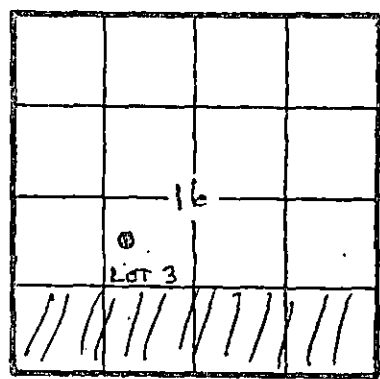

KCC   
KGS   
(Office Use)

TOTAL DEPTH 5213 PBD

SPUD DATE 10-7-80 DATE COMPLETED 10-21-80

ELEV: GR 1130 DF 1135 KB 1137

DRILLED WITH (CABLE) (ROTARY) (AIR) TOOLS

Amount of surface pipe set and cemented 240' DV Tool Used? No

A F F I D A V I T

STATE OF Oklahoma, COUNTY OF Tulsa SS, I, Joseph L. Maruchek

OF LAWFUL AGE, BEING FIRST DULY SWORN UPON HIS OATH,

DEPOSES THAT HE IS Representative (FOR)(OF) Ceja Corporation

OPERATOR OF THE Williams LEASE, AND IS DULY AUTHORIZED TO MAKE

THIS AFFIDAVIT FOR AND ON THE BEHALF OF SAID OPERATOR, THAT WELL NO. 1 ON

SAID LEASE HAS BEEN COMPLETED AS OF THE 4 DAY OF 6, 1981, AND THAT

ALL INFORMATION ENTERED HEREIN WITH RESPECT TO SAID WELL IS TRUE AND CORRECT.

FURTHER AFFIANT SAITH NOT.

SUBSCRIBED AND SWORN BEFORE ME THIS 10<sup>th</sup> DAY OF February, 1982

(S) Joseph L. Maruchek  
Joseph L. Maruchek  
Jan F. Brown  
NOTARY PUBLIC

MY COMMISSION EXPIRES: Dec. 23, 1984

\*\*The person who can be reached by phone regarding any questions concerning this information. Within 45 days of completion, a witnessed initial test by the Commission is required if the well produces more than 25 BOPD or is located in a Basic Order Pool.

This form shall be filed in duplicate with the Kansas Corporation Commission, 200 Colorado Derby Building, Wichita, Kansas 67202, within ten days after the completion of the well, regardless of how the well was completed.

Attach separate letter of request if the information is to be held confidential. If confidential, only file one copy. Information on side one will be of public record and side two will then be held confidential.

Circle one: Oil, Gas, Dry, SWD, OWWO, Injection. Type and complete ALL sections. Applications must be filed for dual completion, commingling, SWD and injection, T.A.

Attach wireline logs (i.e. electrical log, sonic log, gamma ray neutron log, etc.). KCC # (316) 263-3238. (Rules 82-2-105 & 82-2-125)

OPERATOR Ceja Corporation

API NO. C C 177852

ADDRESS 4400 One Williams Center

COUNTY Sumner

Tulsa, Okla. 74172

FIELD Caldwell

\*\*CONTACT PERSON James Freeman

PROD. FORMATION Miss. Chat & Wilcox

PHONE 918-584-7266

LEASE Williams

PURCHASER Total Pet. Co.

WELL NO. 1

ADDRESS P.O. Box 500

WELL LOCATION

Denver, Colo. 80201

660 Ft. from S Line and

DRILLING Curt Brown Drlg. Co.

330 Ft. from W Line of Lot 3

CONTRACTOR ADDRESS Tulsa, Okla.

the SW/4 SEC. 16 TWP. 35S. RGE. 3W

RECEIVED STATE CORPORATION COMMISSION

WELL PLAT

PLUGGING CONTRACTOR ADDRESS

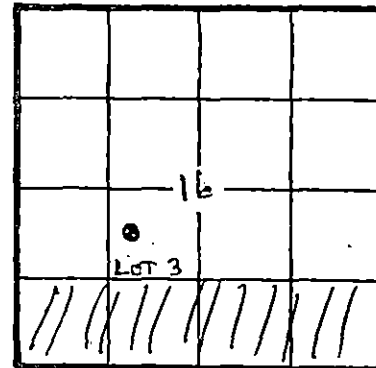

KCC KGS (Office Use)

FEB 12 1982

CONSERVATION DIVISION Wichita, Kansas

TOTAL DEPTH 5213 PBD

SPUD DATE 10-7-80 DATE COMPLETED 10-21-80

ELEV: GR 1130 DF 1135 KB 1137

DRILLED WITH (CABLE) (ROTARY) (AIR) TOOLS

Amount of surface pipe set and cemented 240' DV Tool Used? No

AFFIDAVIT

STATE OF Oklahoma, COUNTY OF Tulsa SS, I, Joseph L.

Maruchek OF LAWFUL AGE, BEING FIRST DULY SWORN UPON HIS OATH,

DEPOSES THAT HE IS Representative (FOR)(OF) Ceja Corporation

OPERATOR OF THE Williams LEASE, AND IS DULY AUTHORIZED TO MAKE

THIS AFFIDAVIT FOR AND ON THE BEHALF OF SAID OPERATOR, THAT WELL NO. 1 ON

SAID LEASE HAS BEEN COMPLETED AS OF THE 4 DAY OF 6, 19 81, AND THAT

ALL INFORMATION ENTERED HEREIN WITH RESPECT TO SAID WELL IS TRUE AND CORRECT.

FURTHER AFFIANT SAITH NOT.

(S) Joseph L. Maruchek

SUBSCRIBED AND SWORN BEFORE ME THIS 10th DAY OF February, 19 82

Joseph L. Maruchek

Notary Public signature

MY COMMISSION EXPIRES: Dec. 23, 1984

\*\*The person who can be reached by phone regarding any questions concerning this information. Within 45 days of completion, a witnessed initial test by the Commission is required if the well produces more than 25 BOPD or is located in a Basic Order Pool.

SIDE TWO

WELL LOG

Show all important zones of porosity and contents thereof; cored intervals, and all drill-stem tests, including depth interval tested, cushion used, time tool open, flowing and shut-in pressures, and recoveries.

SHOW GEOLOGICAL MARKERS, LOGS RUN, OR OTHER DESCRIPTIVE INFORMATION.

FORMATION DESCRIPTION, CONTENTS, ETC.	TOP	BOTTOM	NAME	DEPTH
Shale & Thin Sands and Limes	0	2020		
Sand & Shy Sand	2020	2157	Logs Schlumberger	
Shale	2157	2207	Dual Induction	
Broken Sand	2207	2330	Later log and Compen-	
Shale	2330	2409	sated Neutron Density.	
White Cloud Sand	2409	2578		
Shale	2578	2673		
Broken Lime	2673	2750		
Shale & Sdy. Shale & Thin Limes	2750	2935		
Shale	2935	3234		
Broken Sand	3234	3422		
Shale & Sdy. Shale	3422	3669		
Kansas City	3669	3752		
Shale	3752	3803		
Broken Thin Limes & Shale	3803	3952		
Big Lime - Oswego	3952	4082		
Shale & Sdy. Shale	4082	4341		
Miss. Chert & Chat	4341	4431		
Miss Lime	4431	4632		
Woodford Shale	4632	4734		
Wilcox Sand	4734	4850		
Simpson Zn Shale Sand & Sdy. Shale	4850	4973		
Arbuckle Lime	4973	5213		
No Cores on D.S.T.'s				
Samples sent to Kansas State Geological Survey Wichita by Schlumberger.				

Report of all strings set— surface, intermediate, production, etc. CASING RECORD (New) or (Used)

Purpose of string	Size hole drilled	Size casing set (in O.D.)	Weight lbs/ft.	Setting depth	Type cement	Sacks	Type and percent additives
Surface	11	8 5/8	24	240	Reg.	240	2% Ca Cl <sub>2</sub>
Production	7 7/8	5 1/2	15.5	5208	Hall lite regular	200 200	10% salt & .75% CFR2 + 1/4 # Flu-cele per sk.

LINER RECORD

PERFORATION RECORD

Top, ft.	Bottom, ft.	Sacks cement	Shots per ft.	Size & type	Depth interval
			4	2 1/8" Hyperdome	4842-4847
TUBING RECORD			4	4" Hyper # 11 Gun	4829-4834
Size	Setting depth	Packer set at			
2 1/2" EUE	4864	None	4	2 1/8" Hyperdome	4396-4400

ACID, FRACTURE, SHOT, CEMENT SQUEEZE RECORD

Amount and kind of material used	Depth interval treated
Frac. 7 Bbls. MA, 72 Bbls. CF-2 Pad, 48 Bbls. CE-2, & 1/2#	4842-4847
R 20/40 Sand per Bbl.	
Mini-Frac. 180 bbls. X-Link gelled water & 1000# R 20/40 Sand	4396-4400
Date of first production 4-6-81	Producing method (flowing, pumping, gas lift, etc.) Pumping & Flowing
GRAVITY 41	
RATE OF PRODUCTION PER 24 HOURS	Oil 20 bbls. Gas 145 MCF Water % 80 bbls. Gas-oil ratio 7000/1 CFPB
Disposition of gas (vented, used on lease or sold) Used on lease	Perforations 4842-47, 4829-34 & 4390-4400