

STATE OF KANSAS
STATE CORPORATION COMMISSION

WELL PLUGGING RECORD

Give All Information Completely
Make Required Affidavit
Mail or Deliver Report to:
Conservation Division
State Corporation Commission
800 Bittling Building
Wichita, Kansas

Pratt County. Sec. 26 Twp. 28 Rge. (E) 12 (W)
Location as "NE/CNW/SW" or footage from lines C N/2 NW/4 SW/4
Lease Owner Skelly Oil Company
Lease Name Bernard Megaffin Well No. 1
Office Address Box 1650, Tulsa, Oklahoma
Character of Well (completed as Oil, Gas or Dry Hole) Gas
Date well completed August 26, 1945
Application for plugging filed February 10, 1954
Application for plugging approved February 11, 1954
Plugging commenced February 25, 1954
Plugging completed March 1, 1954
Reason for abandonment of well or producing formation Depleted Gas Well

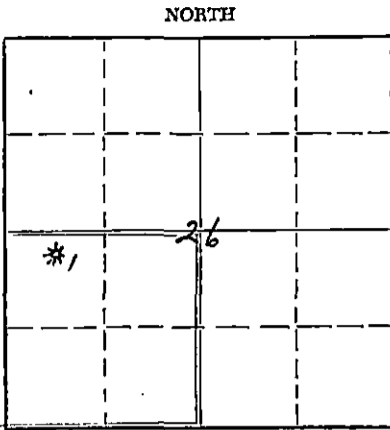

Locate well correctly on above
Section Plat

If a producing well is abandoned, date of last production February 24, 1954
Was permission obtained from the Conservation Division or its agents before plugging was commenced? Yes

Name of Conservation Agent who supervised plugging of this well Mr. M. A. Rives
Producing formation Viola Lime Depth to top 4340' Bottom 4355' Total Depth of Well 4443' Feet
PB 4413 1/2'
Show depth and thickness of all water, oil and gas formations.

OIL, GAS OR WATER RECORDS

CASING RECORD

FORMATION	CONTENT	FROM	TO	OD SIZE	PUT IN	PULLED OUT
Viola Lime	Gas	4340'	4355'	8 5/8"	380' 0"	None
				5-1/2"	4472' 0"	3125' 0"

Describe in detail the manner in which the well was plugged, indicating where the mud fluid was placed and the method or methods used in introducing it into the hole. If cement or other plugs were used, state the character of same and depth placed, from _____ feet to _____ feet for each plug set.

Sand	4413 1/2' to 4330'
Mud laden fluid	4330' to 310'
Rock	310' to 300'
20 sacks of cement	300' to 235'
Mud laden fluid	235' to 30'
10 sacks of cement	30' to 6'
Surface soil	6' to 0'

RECEIVED
STATE CORPORATION COMMISSION
MAR 20 1954
3-20-54
CONSERVATION DIVISION
Wichita, Kansas

(If additional description is necessary, use BACK of this sheet)
Name of Plugging Contractor West Supply Company
Address Chase, Kansas

STATE OF Kansas, COUNTY OF Reno, ss.
H. E. Wamsley (employee of owner) of the above-described well, being first duly sworn on oath, says: That I have knowledge of the facts, statements, and matters herein contained and the log of the above-described well as filed and that the same are true and correct. So help me God.

(Signature) _____
Box 391, Hutchinson, Kansas
(Address)

SUBSCRIBED AND SWORN TO before me this 19th day of March, 1954

My commission expires April 7, 1955
Josephine L. Johnson Notary Public.

PLUGGING
FILE SEC 26 T 28 R 12W
BOOK PAGE 13 LINE 12

SKELLY OIL COMPANY

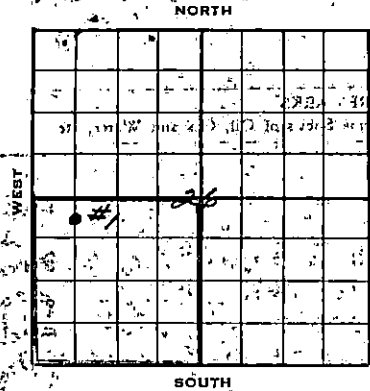

Well Record
 Lease Name and No. BERNARD Loggaffin Well No. 1 Elev. 1866' DF
 Lease Description SW/4 Sec. 26-288-124
Pratt County, Kansas
 Location made July 14 1945 by Kingsman County Engineer
330 feet from North line _____ feet from East line _____
 _____ feet from South line 660 feet from West line of SW/4

Work com'd July 16 1945 Rig com'd July 20 1945 Drlg. com'd July 22 1945 Drlg. comp'd Aug. 13 1945
 Rig Contractor Rudd Drilling Company
 Drilling Contractor Rudd Drilling Company, Tulsa, Oklahoma
 Rotary-Drilling from Top to 4443' Cable Tool Drilling from _____ to _____

Commenced Producing August 26 1945 { Initial Prod. before shot or acid _____ Bbls.
 Initial Prod. after shot or acid _____ Bbls.
 Dry Gas Well Press _____ Volume Before acid, 16% Cu. ft.
 Casing Head Gas Pressure _____ Volume After acid, 1,486 Cu. ft.
 Braden Head (8-5/8" 251" OD) Gas Pressure _____ Volume _____ Cu. ft.
 Braden Head (_____) Gas Pressure _____ Volume _____ Cu. ft.

PRODUCING FORMATION Viola Line (Name) Top 4340' Bottom 4355' TOTAL DEPTH 4443'

CASING RECORD

Size	Wt.	Thds.	Where Set	RULLED OUT			LEFT IN			KIND	Cond'n.	CEMENTING	
				Jts.	Feet	In.	Jts.	Feet	In.			Sacks Used	Method Employed
8-5/8" 0	20	SR	378'				13	380'	0	H40 R2 RBG A	200	Halliburton	
5-1/2" 0	14	SR	436'				142	4472'	0	H40 R2 B3 A	260	Halliburton	
(8-5/8" 0 Casing set 6' in collar & 5' 0" casing to derrick floor)													
5-1/2" Casing perforated with 96 holes between 4340' and 4355'													
(1 - 8" 0 Baker Combination Guide and Float Shoe)													

Liner Set at _____ Length _____ Perforated at _____
 Liner Set at _____ Length _____ Perforated at _____
 Backer Set at _____ Size and Kind _____
 Backer Set at _____ Size and Kind _____

SHOT OR ACID TREATMENT RECORD

	FIRST	SECOND	THIRD	FOURTH
Date	<u>August 26, 1945</u>	<u>August 28, 1945</u>		
Acid Used Size Shot	<u>1000</u>	<u>3000</u>		
Shot Between	<u>4340 Ft. and 4355 Ft.</u>	<u>4340 Ft. and 4355 Ft.</u>		
Size of Shell				
Put in by (Co.)	<u>Dowell, Inc.</u>	<u>Dowell, Inc.</u>		
Length anchor				
Distance below Cas'g				
Damage to Casing or Casing Shoulder	<u>None</u>	<u>None</u>		

SIGNIFICANT GEOLOGICAL FORMATIONS

NAME	Top	Bottom	GAS		OIL		REMARKS
			From	To	From	To	
<u>Harding Lias</u>	<u>3753'</u>						
<u>Mississippian Lias</u>	<u>4189'</u>						
<u>Hardhook shale</u>	<u>4214'</u>						
<u>Viola Line</u>	<u>4340'</u>				<u>4340'</u>	<u>4355'</u>	<u>Sh. por., oil odor</u>
<u>Simpson Sand</u>	<u>4436'</u>				<u>4436'</u>	<u>4439'</u>	<u>Sh. por. & saturation</u>

CLEANING OUT RECORDS

	DATE COMMENCED	DATE COMPLETED	PROD. BEFORE	PROD. AFTER	REMARKS
1st	<div style="border: 2px solid black; padding: 5px; display: inline-block;"> PLUGGING PER SEC <u>267</u> <u>27</u> <u>120</u> BOX PAGE <u>13</u> LINE <u>12</u> </div>				See Reverse for other details.
2nd					" " " " "
3rd					" " " " "
4th					" " " " "

PLUGGING BACK AND DEEPENING RECORDS

	Date Commenced	Date Completed	No. Feet Plugged Back or Deepened	Prod. Before	Prod. After	REMARKS
1st						See Reverse for other details.
2nd						" " " " "
3rd						" " " " "
4th						" " " " "

(See Reverse for Record of Formation)

RECEIVED
 STATE CORP. COM. DIVISION
 MAR 20 1945
 CONSERVATION DIVISION
 Wichita, Kansas

RECORD OF FORMATIONS

FORMATION	WELL RECORD	TOP	BOTTOM	REMARKS
Surface well and sand		0	40	
Sand		40	200	
Red bed		200	380	Get and cone bed 3-5/8" OD, 200' grade 2-40, Range 2, seamless steel casing at 443' with 200 sacks of cement.
Red bed and shale		380	660	
Shale and shells		660	900	
Shale		900	1195	
Shale and shells		1195	1340	
Salt		1340	1435	
Shale and shells		1435	1440	
Lime		1440	1625	
Lime and shale		1625	1805	
Lime		1805	2780	
Shale		2780	2820	
Shale and lime		2820	2880	
Lime		2880	2985	
Shale		2985	3060	
Lime		3060	3360	
Sandy lime		3360	3465	
Lime		3465	3605	
Lime and shale		3605	3779	
Medium soft colitic lime		3779	3792	
Lime		3792	3799	
Medium soft colitic lime		3799	3804	
Lime		3804	3850	
Sand and lime		3850	3883	
Vary soft colitic lime		3883	3897	Porous and stained
Lime		3897	3905	
Vary soft colitic lime		3905	3915	
Lime		3915	3940	
Vary soft colitic lime		3940	3945	
Lime and shale		3945	3965	
Lime		3965	4030	
Lime and shale		4030	4070	
Lime		4070	4160	
Shale		4160	4189	TOP BLENDED LIME 4189'
Chert		4189	4200	
Shale and chert		4200	4220	TOP BLENDED LIME 4214'
Shale		4220	4270	
Lime		4270	4310	
Shale		4310	4340	TOP BLENDED LIME 4340'
Medium dense coarsely crystalline dolomite		4340	4350	Light porous
Sand		4350	4355	oil odor
Lime and shale		4355	4413	
Dense gray dolomite		4413	4426	
Grey coarsely crystalline lime		4426	4436	TOP BLENDED LIME 4436'
Medium hard grey and tan dolomitic sand		4436	4443	
Hard grey sand		4443	4443	
<p>On August 26th perforated 5 1/2" casing with 96 holes from 4340' to 4355' by means of tubing and perforator. Total Depth 4413'.</p> <p>On August 28th acidized with 1000 gallons of Dowell 20% acid as follows:</p>				

San Halliburton drill stem test with 30 minutes open at 4432' and recovered 100' of thin salty mud.

5 1/2" OD, 144, 3rd shd., grade 2-40, Range 2, seamless steel casing at 4436' with 200 sacks of cement and 8 sacks of aquagel. Finished cementing at 7:45 AM August 14th, 1945. Moved in and rigged up cable tools and bailed the hole down on August 20th and 5 1/2" casing tested OK. Drilled cement plug and hole filled 1000' with water in 1 hour and 2000' in 2 hours. On August 22nd ran 2" tubing and plugged back by Halliburton.

5 1/2" OD, 144, 3rd shd., grade 2-40, Range 2, seamless steel casing at 4436' with 200 sacks of cement and 8 sacks of aquagel. Finished cementing at 7:45 AM August 14th, 1945. Moved in and rigged up cable tools and bailed the hole down on August 20th and 5 1/2" casing tested OK. Drilled cement plug and hole filled 1000' with water in 1 hour and 2000' in 2 hours. On August 22nd ran 2" tubing and plugged back by Halliburton.

TOTAL DEPTH 4443' PB 4413'

On August 26th perforated 5 1/2" casing with 96 holes from 4340' to 4355' by means of tubing and perforator. Total Depth 4413'.

On August 28th acidized with 1000 gallons of Dowell 20% acid as follows:

FORMATION	WELL RECORD	TOP	BOTTOM	REMARKS

ACID TREATMENT NO. 1 - Between 4340' and 4355'

Treatment put in by Dowell, Inc., using 1000 gallons acid and 125 barrels of water to fill hole and to flush:

TIME	CP	TP	REMARKS
1:15 PM			Hole filled with 99 barrels of water
1:25 PM	500 $\frac{1}{2}$	400 $\frac{1}{2}$	1000 gallons of acid in hole, on bottom
1:50 PM	200 $\frac{1}{2}$	200 $\frac{1}{2}$	Hole flushed with 26 barrels of water and treatment complete

After acid treatment gas gauged 1,020 M cu. ft., CP 500 $\frac{1}{2}$, then reacidized with 3000 gallons of Dowell "AIP-20" acid as follows:

ACID TREATMENT NO. 2 - Between 4340' and 4355'

Treatment put in by Dowell, Inc., using 3000 gallons acid and 26 barrels of water to fill hole and to flush:

TIME	CP	TP	REMARKS
5:30 PM			Hole filled with 6 barrels of water
6:01 PM	875 $\frac{1}{2}$	Vac.	1000 gallons of acid in hole
6:12 PM	875 $\frac{1}{2}$	Vac.	2000 gallons of acid in hole
6:23 PM	875 $\frac{1}{2}$	Vac.	3000 gallons of acid in hole
6:32 PM	875 $\frac{1}{2}$	Vac.	Hole flushed with 20 barrels of water and treatment complete

After acid treatment, flowed 8 hours and gas gauged 1,500 M cu. ft., CP 350 $\frac{1}{2}$. On August 30th on State Corporation Commission potential test, open three hours, gas gauged 1,486 M cu. ft., CP 340 $\frac{1}{2}$.

GLOBE TEST DATA

DEPTH	ANGLE OF DIRECTION
250'	0 Degrees
500'	1 "
750'	0 "
1000'	0 "
1250'	1/2 "
1500'	1/2 "
1750'	1/2 "
2000'	1/2 "
2250'	1/2 "
2500'	1/2 "
2750'	1 "
3000'	1/2 "
3250'	1/2 "
3500'	1/2 "
3750'	1/2 "
4000'	1 "
4250'	0 "

RECEIVED
 RESEARCH
 10/22/54
 CONSERVATION DIVISION
 Wichita, Kansas

SKELLY OIL COMPANY

REPORT OF CHANGE IN WELL RECORD

Give complete description of all cleaning out, deepening, plugging back and fishing jobs, changes in casing, material lost in hole, etc., not recorded in original well record.

Bernard Megaffin

1

Western Kansas

LEASE

WELL NO.

DISTRICT

SEC. **26** T. **28S** R. **12W**

COUNTY **Pratt**

8366

JOB NO.

SURVEY

BLOCK

STATE

Kansas

CLEANING OUT RECORD

PLUGGING BACK OR DEEPENING RECORD

Date commenced.....19.....
 Date completed.....19.....
 Cleaned out from..... to..... T. D.....
 Prod. before.....
 bbls. bbls. cu. ft.
 oil..... water..... gas.....
 Prod. after.....
 bbls. bbls. cu. ft.
 oil..... water..... gas.....
 Kind of tools used:.....
 Tools owned by:.....

Date commenced..... **February 25,** 19 **54.**
 Date completed..... **March 1,** 19 **54.**
 Plugged back or deepened from **4412 1/2'** to **0'** T. D. **P & A**
 Prod. before.....
 0 bbls. 0 bbls. 5,000 cu. ft.
 oil..... water..... gas.....
 Prod. after.....
 bbls. bbls. cu. ft.
 oil..... water..... gas.....
 Kind of tools used: **Pulling Machine**
 Tools owned by: **West Supply Company**

SHOT RECORD

Date	Size shot	Shot between	Size of shell	Put in by (Co.)	Length anchor	Distance below casing	Damage to casing or casing shoulder
	Qts.	Ft. and Ft.					
	Qts.	Ft. and Ft.					
	Qts.	Ft. and Ft.					
	Qts.	Ft. and Ft.					

RECEIVED
 STATE CORPORATION COMMISSION
 MAR 20 1954

CHANGES IN CASING RECORD.

CONSERVATION DIVISION

Western Kansas

SIZE	Wt.	Thds.	Where Set	PULLED OUT			LEFT IN			KIND	Cond'n	CEMENTING	
				Jts.	Feet	In.	Jts.	Feet	In.			Sacks Used	Method Employed
5 1/2"	11 1/2	BR	4436'	100	3229	0	42	1347	0	140 R2 SS	B		

Liner set at..... Length..... Perforated at.....

Packer set at..... Size and kind.....

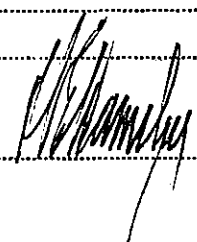

Superintendent.

REMARKS (Give review of work accomplished and any other comment of interest) **On February 25, 1954,**
 moved in tools of West Supply Company and plugged the well as follows:

Sand 4413½' to 4330'

Shot off 5½" casing at 3100' and spotted 60 barrels of oil behind 5½" casing. Pulled 100 joints (3125') of 5½" OD, 140, 6R thd., H-40, R-2, S.S. casing "B" cond.

Mud laden fluid	4330'	to	310'
Rock	310'	to	300'
20 sacks of cement	300'	to	235'
Mud laden fluid	235'	to	30'
10 sacks of cement	30'	to	6'
surface soil	6'	to	0'

Plugged and abandoned March 1, 1954.

RECORD OF FORMATIONS

FORMATION	TOP	BOTTOM	REMARKS
			Indicate Casing Points, Describe Shows of Oil, Gas and Water, etc.