

STATE OF KANSAS
STATE CORPORATION COMMISSION

WELL PLUGGING RECORD

Give All Information Completely
Make Required Affidavit
Mail or Deliver Report to
Conservation Division
State Corporation Comm.
245 North Water
Wichita, KS 67202

Sumner County, Sec. 33 Twp. 34S Rge. 4 E/W
Location as "NE/CNW^{SW}SW^{NE}" or footage from lines
Lease Owner N.F. Oil & Gas - Petroleum Enterprises
Lease Name Baker Well No. 1
Office Address 3333 Quebec Street - Suite 7300 - Denver
Character of Well (Completed as Oil, Gas or Dry Hole) Dry Hole

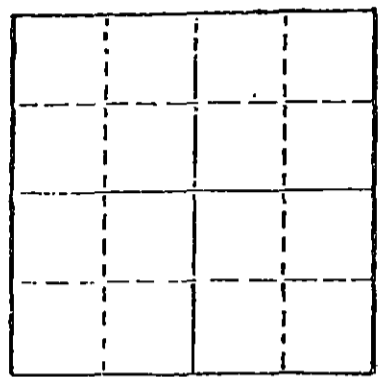

Date Well completed Dry Hole 19
Application for plugging filed 1/13/ 1981
Application for plugging approved 1/14 1981
Plugging commenced 1/14 1981
Plugging completed 1/14 1981
Reason for abandonment of well or producing formation Dry Hole

If a producing well is abandoned, date of last production 19

Was permission obtained from the Conservation Division or its agents before plugging was commenced? Yes

Name of Conservation Agent who supervised plugging of this well Carl Barnett
Producing formation Depth to top Bottom Total Depth of Well
Show depth and thickness of all water, oil and gas formations.

OIL, GAS OR WATER RECORDS

CASING RECORD

FORMATION	CONTENT	FROM	TO	SIZE	PUT IN	PULLED OUT

Describe in detail the manner in which the well was plugged, indicating where the mud fluid was placed and the method or methods used in introducing it into the hold. If cement or other plugs were used, state the character of same and depth placed, from 40 feet to 365' feet for each plug set. Mud to 40 feet, bottom plug 365' cement with 35 sks cement.

(If additional description is necessary, use BACK of this sheet)

Name of Plugging Contractor REYNOLDS DRILLING COMPANY, INC.

STATE OF _____ COUNTY OF _____, ss. _____ (employee of owner) or (owner or operator)

of the above-described well, being first duly sworn on oath, says: That I have knowledge of the facts, statements, and matters herein contained and the log of the above-described well as filed and that the same are true and correct. So help me God.

(Signature) *Robert J. Mathews*

(Address)

SUBSCRIBED AND SWORN TO before me this 26th day of January, 19 81

Lance C. Mathews
Notary Public.

My commission expires _____

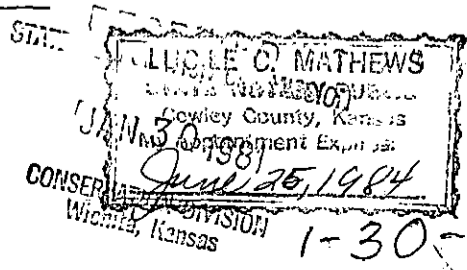

KANSAS

WELL COMPLETION REPORT AND DRILLER'S LOG

S. 33 T. 34S R. 4 ^X E W

Loc. C NE SE NE

API No. 15

County Number

County Sumner

Operator

N. F. Oil & Gas, Inc. - Petroleum Enterprises

Address

3333 Quebec Street Suite 7300 Denver, Colorado

Well No.

1

Lease Name

Baker

Footage Location

feet from (N) (S) line feet from (E) (W) line

Principal Contractor

REYNOLDS DRILLING COMPANY, INC

Geologist

Mike Vaughn

Spud Date

12/20/80

Date Completed

Total Depth

5039'

P.B.T.D.

Directional Deviation

Oil and/or Gas Purchaser

none

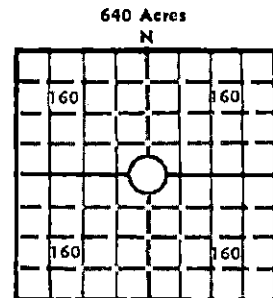

Elev.: Gr.

DF KB

CASING RECORD

Report of all strings set — surface, intermediate, production, etc.

Purpose of string	Size hole drilled	Size casing set (in O.D.)	Weight lbs/ft.	Setting depth	Type cement	Sacks	Type and percent additives
SURFACE	7 7/8"	8 5/8"		363'	Common		

LINER RECORD

PERFORATION RECORD

Top, ft.	Bottom, ft.	Sacks cement	Shots per ft.	Size & type	Depth interval

TUBING RECORD

Size	Setting depth	Packer set at

ACID, FRACTURE, SHOT, CEMENT SQUEEZE RECORD

Amount and kind of material used	Depth interval treated

INITIAL PRODUCTION

Date of first production	Producing method (flowing, pumping, gas lift, etc.)
--------------------------	---

RATE OF PRODUCTION PER 24 HOURS	Oil bbls.	Gas MCF	Water bbls.	Gas-oil ratio	CFPB
---------------------------------	-----------	---------	-------------	---------------	------

Disposition of gas (vented, used on lease or sold)	Producing interval (s)
--	------------------------

INSTRUCTIONS: As provided in KCC Rule 82-2-125, within 90 days after completion of a well, one completed copy of this Drillers Log shall be transmitted to the State Geological Survey of Kansas, 4150 Monroe Street, Wichita, Kansas 67209. Copies of this form are available from the Conservation Division, State Corporation Commission, 245 No. Water, Wichita, Kansas 67202. Phone AC 316-522-2206. If confidential custody is desired, please note Rule 82-2-125. Drillers Logs will be on open file in the Oil and Gas Division, State Geological Survey of Kansas, Lawrence, Kansas 66044.

STATE RECEIVED
JAN 5 0 1981
CONSERVATION DIVISION
Wichita, Kansas

Operator N. F. Oil & Gas DESIGNATE TYPE OF COMP.: OIL, GAS, DRY HOLE, SWDW, ETC.: Dry hole

Well No. 1 Lease Name Baker

S 33 T 34SR 4 E W

WELL LOG

Show all important zones of porosity and contents thereof; cored intervals, and all drill-stem tests, including depth interval tested, cushion used, time tool open, flowing and shut-in pressures, and recoveries.

SHOW GEOLOGICAL MARKERS, LOGS RUN, OR OTHER DESCRIPTIVE INFORMATION.

FORMATION DESCRIPTION, CONTENTS, ETC.	TOP	BOTTOM	NAME	DEPTH
Cement	290	363		
Shale & Sand	363	755		
Lime & Shale	755	1063		
Lime & Shale	1063	1225		
Shale	1225	1380		
Lime & Shale	1380	1504		
Lime & Shale	1504	1645		
Lime & Shale	1645	1710		
Shale & Lime	1710	1890		
Lime & Shale	1890	2136		
Lime & Shale	2136	2293		
Shale & Lime	2293	2410		
Lime & Shale	2410	2572		
Lime & Shale	2572	2716		
Shale & Lime	2716	2890		
Lime & Shale	2890	3023		
Lime & Shale	3023	3156		
Shale & Lime	3156	3274		
Shale & Lime	3274	3457		
Lime & Shale	3457	3570		
Lime & Shale	3570	3660		
Lime & Shale	3660	3757		
Lime & Shale	3757	3877		
Lime & Shale	3877	3919		
Lime & Shale	3919	4001		
Lime & Shale	4001	4063		
Lime & Shale	4063	4150		
Lime & Shale	4150	4220		
Lime & Shale	4220	4298		
Lime & Shale	4298	4406		
Lime & Shale	4406	4516		
Lime	4516	4634		
Lime & Shale	4634	4681		
Shale & Lime	4681	4799		
Shale & Lime	4799	4858		
Lime & Shale	4858	4960		
Lime & Shale	4960	5032		
Total Depth	5039			

USE ADDITIONAL SHEETS, IF NECESSARY, TO COMPLETE WELL RECORD.

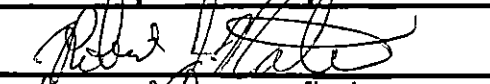
Date Received	 Signature
	J. Petroleum Enterprises Title
	Date