

STATE OF KANSAS
STATE CORPORATION COMMISSION
200 Colorado Derby Bldg.
Wichita, Kansas 67202

WELL PLUGGING RECORD

Give All Information Completely
Make Required Affidavit

COUNTY Kingman SEC. 30 TWP. 29S RGE. 9 W
Location as in quarters or footage from lines:
E.2 - E.2 - N.W.

Locate Well
correctly on above
Section Platt.

Lease Owner Beren Corp.
Lease Name Henning Well No. 1
Office Address 970 4th Financial Center/Wichita, KS 67202
Character of Well (Completed as Oil, Gas or Dry Hole): Gas
Date Well Completed 10/1/80
Application for plugging filed 1/17/83
Plugging commenced 1/28/83
Plugging completed 3/1/83
Reason for abandonment of well or producing formation Dry

Was permission obtained from the Conservation Division or it's
Agent's before plugging was commenced? Yes

Name of Conservation Agent who supervised plugging of this well M.V. Leslie

Producing formation _____ Depth to top _____ bottom _____ T.D. 2550

Show depth and thickness of all water, oil and gas formations.

OIL, GAS OR WATER RECORDS

Casing Record

Formation	Content	From	To	Size	Put in	Pulled Out
				8 5/8	275	none
				4 1/2	2545	1400

Describe in detail the manner in which the well was plugged, indicating where the mud
fluid was placed and the method or methods used in introducing it into the hold. If cement
or other plugs were used, state the character of same and depth placed, from _____ feet
to _____ feet for each plug set. Plugged back at 2515

Sand from 2515 to 2430
4 sacks of cement with dump bailer from 2430 to 2400
15 jell, 6 hull, 10 jell, 125 comm. 3%
Sun Cementing Pumped

Zimmerman and Leslie on location for top plug

(If additional description is necessary, use BACK of this sheet)

Name of Plugging Contractor Clarke Corp.

STATE OF Kansas COUNTY OF Barber, ss.
Olmos R. Wargenstern (employee of ~~owner~~) or (~~owner or operator~~) of the
above-described well, being first duly sworn on oath, says: That I have knowledge of the
facts, statements, and matters herein contained and the log of the above-described well as
filed and that the same are true and correct. So help me God.

(Signature) Medicine Lodge, Kas.
(Address)

SUBSCRIBED AND SWORN TO before me this 7th day of March 19 83.

Jess Hamilton
STATE CORPORATION COMMISSION Notary Public.

My Commission expires: April 4, 1986.

MAR 9 1983

KANSAS

15-095-20973-0000

WELL COMPLETION REPORT AND DRILLER'S LOG

API No. 15 - 095 - 20973
County Number

Operator
Beren Corporation

Address
970 Fourth Financial Center, Wichita, Kansas 67202

Well No. 1 Lease Name HENNING

Footage Location
feet from (N) (S) line feet from (E) (W) line

Principal Contractor BEREDCO, Inc. Geologist Steve Dixon

Spud Date Sept. 28, 1980 Date Completed Oct. 1, 1980 Total Depth 2518 P.B.T.D.

Directional Deviation Oil and/or Gas Purchaser

S. 30 T. 29S R. 9W E W

Loc. E/2 E/2 NW

County Kingman

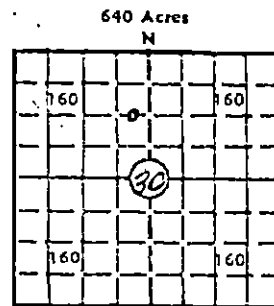

Elev.: Gr. 1679

DF KB 1692

CASING RECORD

Report of all strings set— surface, intermediate, production, etc.

Purpose of string	Size hole drilled	Size casing set (in O.D.)	Weight lbs/ft.	Setting depth	Type cement	Sacks	Type and percent additives
Surface	12 1/4"	8-5/8	24#	275	60-40 pozmix	225	2% gel, 3% CC
Production		4 1/2	10.5#	2545	60-40 pozmix	225	2% gel, 3% CC

LINER RECORD

PERFORATION RECORD

Top, ft.	Bottom, ft.	Sacks cement	Shots per ft.	Size & type	Depth interval

TUBING RECORD

Size	Setting depth	Packer set at

ACID, FRACTURE, SHOT, CEMENT SQUEEZE RECORD

Amount and kind of material used	Depth interval treated

RECEIVED
STATE CORPORATION COMMISSION
JAN 20 1983
CONSERVATION DIVISION
Wichita, Kansas

INITIAL PRODUCTION

Date of first production	Producing method (flowing, pumping, gas lift, etc.)				
RATE OF PRODUCTION PER 24 HOURS	Oil bbls.	Gas MCF	Water bbls.	Gas-oil ratio	CFPB
Disposition of gas (vented, used on lease or sold)			Producing interval(s)		

INSTRUCTIONS: As provided in KCC Rule 82-2-125, within 90 days after completion of a well, one completed copy of this Drillers Log shall be transmitted to the State Geological Survey of Kansas, 4150 Monroe Street, Wichita, Kansas 67209. Copies of this form are available from the Conservation Division, State Corporation Commission, 245 No. Water, Wichita, Kansas 67202. Phone AC 316-522-2206. If confidential custody is desired, please note Rule 82-2-125. Drillers Logs will be on open file in the Oil and Gas Division, State Geological Survey of Kansas, Lawrence, Kansas 66044.

DESIGNATE TYPE OF COMP.: OIL, GAS, DRY HOLE, SWDW, ETC.:

Operator
Beren Corporation

Well No. 1 Lease Name HENNING Gas

s 30 T 29S R 9W E W

WELL LOG

Show all important zones of porosity and contents thereof; cased intervals, and all drill-stem tests, including depth interval tested, cushion used, time tool open, flowing and shut-in pressures, and recoveries.

SHOW GEOLOGICAL MARKERS, LOGS RUN, OR OTHER DESCRIPTIVE INFORMATION.

FORMATION DESCRIPTION, CONTENTS, ETC.	TOP	BOTTOM	NAME	DEPTH
Sand	0	100		
Redbed and shale	100	298		
Redbed	298	540		
Shale	540	1460		
Lime and shale	1460	2100		
Lime	2100	2340		
Lime and shale	2340	2518		
RTD	2518			

USE ADDITIONAL SHEETS, IF NECESSARY, TO COMPLETE WELL RECORD.

Date Received	<i>Don Beauchamp</i>
	Signature
	Don Beauchamp - Geologist
	Title
	November 19, 1980
	Date