

STATE OF KANSAS  
STATE CORPORATION COMMISSION

Give All Information Completely  
Make Required Affidavit  
Mail or Deliver Report to:  
Conservation Division  
State Corporation Commission  
212 North Market, Insurance Bldg.  
Wichita, Kansas

WELL PLUGGING RECORD

Kingman County. Sec. 34 Twp. 29S Rge. (E) 7 (W)

Location as "NE/CNW%SW%" or footage from lines NW/4 NW/4 NE/4  
Lease Owner Skelly Oil Company  
Lease Name Ruth Holder Well No. 1  
Office Address Box 1650, Tulsa, Oklahoma  
Character of Well (completed as Oil, Gas or Dry Hole) Oil  
Date well completed November 4, 19 57  
Application for plugging filed September 20, 19 61  
Application for plugging approved September 26, 19 61  
Plugging commenced September 30, 19 61  
Plugging completed October 3, 19 61  
Reason for abandonment of well or producing formation Depleted

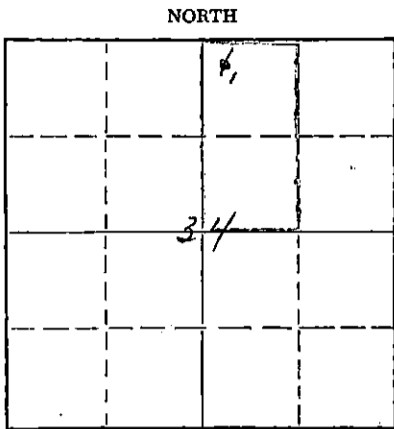

Locate well correctly on above Section Plat

If a producing well is abandoned, date of last production April 5, 19 61  
Was permission obtained from the Conservation Division or its agents before plugging was commenced? Yes

Name of Conservation Agent who supervised plugging of this well Mr. Fred Hampel  
Producing formation Mississippi Depth to top 4160' Bottom 4167' Total Depth of Well 4167 Feet  
Show depth and thickness of all water, oil and gas formations. PB 3447'

OIL, GAS OR WATER RECORDS

CASING RECORD

FORMATION	CONTENT	FROM	TO	SIZE	PUT IN	PULLED OUT
Mississippi	Oil	4160'	4167'	8-5/8"	321'	None
Lansing Lime	Water	3434'	3782'	5-1/2"	4155' 3"	3206'
				4-3/4"	50'	None

Describe in detail the manner in which the well was plugged, indicating where the mud fluid was placed and the method or methods used in introducing it into the hole. If cement or other plugs were used, state the character of same and depth placed, from \_\_\_\_\_ feet to \_\_\_\_\_ feet for each plug set.

Sand	3447' to 3420'
5 sacks cement	3420' to 3380'
Mud	3380' to 310'
Rock bridge	310' to 300'
20 sacks of cement	300' to 240'
Mud	240' to 35'
Rock	35' to 30'
10 sacks of cement	30' to 5'
Surface soil	5' to Surface

RECEIVED  
STATE CORPORATION COMMISSION

OCT 20 1961

CONSERVATION DIVISION  
Wichita, Kansas

10-20-1961

(If additional description is necessary, use BACK of this sheet)  
Name of Plugging Contractor Ace Pipe Pulling Company  
Address P.O. Box 304, Great Bend, Kansas

STATE OF Kansas, COUNTY OF Reno, ss.  
D. E. Smith (employee of owner) of the above-described well, being first duly sworn on oath, says: That I have knowledge of the facts, statements, and matters herein contained and the log of the above-described well as filed and that the same are true and correct. So help me God.

(Signature) D. E. Smith  
P.O. Box 391, Hutchinson, Kansas  
(Address)

SUBSCRIBED AND SWORN TO before me this 19th day of October, 19 61

My commission expires April 7, 1963

Notary Public.



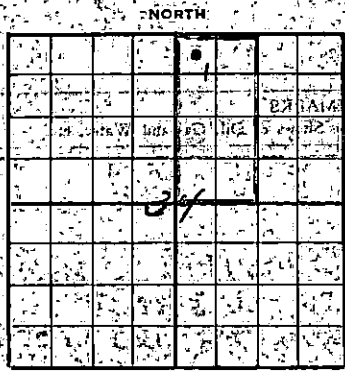

# SKELLY OIL COMPANY

**Well Record**

Lease Name and No. Ruth Holder Well No. 1 Elevation 1512' RB  
1509' DP  
1505' SS

Lease Description W/2 NE/4 Section 34-290-71,  
Wingman County, Kansas (80 Acres)

Location made September 8, 57 by I. L. Dix  
330 feet from North line 330 feet from East line 330/4  
330 feet from South line 330 feet from West line of Sec. 34

Work com'd 9/10 1957 Rig com'd 9/12 1957 Drlg. com'd 9/12 1957 of 10/18 1957

Rig Contractor Claude Wentworth Drilling Co., Inc.  
 Drilling Contractor Claude Wentworth Drilling Co., Inc., Tulsa, Oklahoma

Rotary Drilling from 0' to 4160' Cable Tool Drilling from 4160' to 4167'

Commenced Producing November 4, 1957 Initial Prod. before shot or acid flowed thru 2" CG, Bbls.  
Initial Prod. after shot or acid 9.56.78 @ 10 hrs. @ Bbls.

Dry Gas Well Press. 24 hr. Volume 30 potential 178 barrels. Cu. ft.  
 Casing Head Gas Pressure 100 Volume 129,000 Cu. ft.

Braden Head ( 8-9/8" x 55" PC ) Gas Pressure 117-140 Volume 129,000 Cu. ft.  
 Braden Head ( Size ) Gas Pressure Volume Cu. ft.

PRODUCING FORMATION Mississippi Top 4160' Bottom 4167' TOTAL DEPTH 4167'

## CASING RECORD

OD Size	Wt.	Thds.	Where Set	PULLED OUT			LEFT IN			KIND	Cond'n	CEMENTING	
				Jts.	Feet	In.	Jts.	Feet	In.			Sacks Used	Method Employed
8-5/8	22.7	30	323'				2	321	0	HEAVY	A	12	Halliburton
5-1/2	11.8	18	413'				12	415	3	555 RZ	B	150	Halliburton
4-3/4	10.2	12	4180				3	40	0	555 R1	B	50	Halliburton
(8-5/8)			Casing set	1	11	collar and	22			cased to Derrick floor			

4 3/4" Liner Set at 4160' Length 50' Perforated at \_\_\_\_\_  
 Liner Set at \_\_\_\_\_ Length \_\_\_\_\_ Perforated at \_\_\_\_\_  
 Packer Set at \_\_\_\_\_ Size and Kind \_\_\_\_\_  
 Packer Set at \_\_\_\_\_ Size and Kind \_\_\_\_\_

## SHOT OR ACID TREATMENT RECORD

	FIRST	SECOND	THIRD	FOURTH
Date	<u>10/18/57</u>	<u>10/19/57</u>		
Acid Used	<u>250</u> Gals.			
Size Shot	<u>4160</u> Ft. and <u>4167</u> Ft.	<u>4160</u> Ft. and <u>4167</u> Ft.		
Shot Between				
Size of Shell		<u>Halliburton</u>		
Put in by (Co.)	<u>Halliburton</u>	<u>Hand-ill-trac</u>		
Length anchor				
Distance below Cas'g				
Damage to Casing or Casing Shoulder				

## SIGNIFICANT GEOLOGICAL FORMATIONS

NAME	Top	Bottom	GAS		OIL		REMARKS
			From	To	From	To	
<u>Lensing Clay</u>	<u>3312'</u>						
<u>Conglomerate</u>	<u>4171'</u>						
<u>Mississippi</u>	<u>4145'</u>				<u>4160'</u>	<u>4167'</u>	

## CLEANING OUT RECORDS

	DATE COMMENCED	DATE COMPLETED	PROD. BEFORE	PROD. AFTER	REMARKS
1st					See Reverse for other details.
2nd					" " " " "
3rd					" " " " "
4th					" " " " "

## PLUGGING BACK AND DEEPENING RECORDS

	Date Commenced	Date Completed	No. Feet Plugged Back or Deepened	Prod. Before	Prod. After	REMARKS
1st						See Reverse for other details.
2nd						" " " " "
3rd						" " " " "
4th						" " " " "

# RECORD OF FORMATIONS

FORMATION	TOP	BOTTOM	REMARKS
Surface soil, shale and sand	0	150	
Shale and shells	150	310	
Red bed and shale	310	600	Set and cemented 8-5/8" O.D., 22.7#, Arco S.S. steel casing (6 cond.) at 323' with 125 sacks of common cement, 25 Gal and 12' calcium chloride. Cement circulated. Finished cementing at 6:30 p.m. 9/13/57.
Shale	600	1050	
Shale and lime	1050	4123	TOP LINING LINE 3319' TOP CONGLOMERATE 4121'
Chert, white tripolitic	4123	4142	Fair porosity, good spotted to saturated stain, trace of free oil and gas bubbles.
Chert and lime	4142	4154	TOP MISSISSIPPIAN 4145' Ran Halliburton drill stem test No. 1, used straddle packer with top set at 4123', bottom packer set at 4142', used 12' anchor, open 1 hour, strong blow of air on opening, gas to surface in 35 minutes, too small to gauge, recovered 30' of very slightly gas cut drilling mud, ISP-47, ISP-47, ISP-1118 in 20 mins.
Dolomite, light tan, medium crystalline vuggy with white dolomitic and slightly tripolitic chert	4154	4160	Trace of free oil and gas bubbles, strong odor in samples. Poor porosity, poor black spotted stain in chert, no free oil. Ran Halliburton drill stem test No. 2 with packer set at 4142', used 18' anchor, open 1 hour and 15 minutes, fair blow of air throughout test, recovered 2000' of gas, 60' of slightly oil and gas cut mud, ISP-1132, ISP-347, ISP-378 in 20 mins.
SLOPE MEASUREMENTS TO BE TAKEN			
Ran Schlumberger Survey.			
			Set and cemented 5 1/2" O.D., 16#, 16# S.S. casing (2 cond.) at 4123' with 150 sacks of common cement and 25 Gal. Finished cementing at 6:00 p.m. 9/29/57. Halliburton Temperature Survey showed top of cement behind 5 1/2" casing at 3270'.
Rigged up cable tools, swabbed and bailed the hole down and 5 1/2" casing tested dry on October 12. Drilled cement plug and cleaned out to 4160'. Tested 2 gallons of muddy oil per hour.			
Ran 50' of 4-3/4" O.D., 16#, 16#, S.S., 1-1, 3-55, S.S. casing liner on 2" tubing with Baker cement float shoe and RP guide shoe. Set liner with top at 4110' and bottom at 4160', and cemented liner with 50 sacks of common cement. Finished cementing at 6:00 p.m. 10/14/57. Pulled 2" tubing and shut down for cement to set.			
On October 17, swabbed and bailed the hole dry and 4-3/4" casing liner tested OK. Drilled cement and cleaned out to 4160'. Drilled deeper as follows:			
Lime	4160	4167	Good porosity, well saturated.
TOTAL DEPTH 4167'			Bailed and tested 6 hours, 7 gallons of muddy oil per hour. Ran Leco-Lille Gamma Ray Neutron Survey.
Treated through 5 1/2" casing with 250 gallons of Halliburton HGA acid as follows:			

Wichita, Kansas  
CONSERVATION DIVISION

OCT 20 1957

ACID TREATMENT NO. 1 - Between 4160' and 4167'

Treatment put in 10/18/57 by Halliburton, using 250 gallons of acid and 115 barrels of oil.

TIME	CP	TP	REMARKS
8:37 pm			Start oil
8:41 pm			Start acid
8:45 pm	0		Start flush
9:04 pm	600		Oil on bottom
9:08 pm	1600		Acid on bottom
9:15 pm	1300		Acid clear
9:17 pm	1300		Treatment completed

Swabbed through 5 1/2" casing 9 hours, 112 barrels of oil used in treating and no water. Ran 2" tubing open end to 4102', then ran Halliburton Sand-Oil-Frac through 5 1/2" casing from 4160' to 4167' as follows:

SAND-OIL-FRAC TREATMENT NO. 1 - Between 4160' and 4167'

Used 3000' of sand  
72 barrels of heavy oil  
235 barrels of regular crude oil to fill hole and flush  
Maximum CP-2900', minimum CP-1700'  
Time 7 minutes

Shut in 14 hours for pressure drop, then flowed through 2" tubing 1 hour, 53 barrels of oil used in treating and no water. On October 20, flowed through 2" tubing 17 hours, 2 1/2/64" choke, 254 barrels of oil used in treating and no water. Flowed through 2" tubing 7 hours, 2 1/2/64" choke, 133 barrels of formation oil and 1 1/2 barrels of water, gas gauged 139 MCF, FTP-340', FCP-880'. On October 21, flowed through 2" tubing with 2 1/2/64" choke 24 hours, 227 barrels of oil and 2 1/2 barrels of water, FTP-300', FCP-660'. On October 22, flowed through 2" tubing 4 hours, 2 1/2/64" choke, 3 barrels of oil and 2 1/2 barrels of water per hour, FCP-770', FTP-120'.

Loaded hole with 160 barrels of oil. Pulled and reran 2" tubing to 4165'. Swabbed through 2" tubing 2 hours, 40 barrels of oil used to load hole and well started flowing. Flowed through 2" tubing 9 hours, 2 1/2/64" choke, 120 barrels of oil used to load hole, gas gauged 139 MCF, FCP-240', FTP-50'. Shut down on October 23, to install tank battery.

On November 1, flowed through 2" tubing with 1 1/2/64" choke 16 hours, 91 barrels of oil and 47 barrels of water, FTP-420', FCP-620'. On November 2, flowed through 2" tubing 15 hours, 20/64" choke, 68 barrels of oil and 35 barrels of water, gas gauged 129 MCF, FTP-200', FCP-600'.

On November 4, flowed through 2" tubing 8 hours, 2 1/2/64" choke, on physical potential, 56.78 barrels of oil and 30 barrels of water, gas gauged 129 MCF to establish 24 hour State Corporation Commission potential of 1/8 barrels. This potential allows 31 barrels per day. FTP-140', FCP-480'.

SLOPE TEST DATA: Tests were taken at 350', 500', 750', 1000', 1250', 1500', 1750', 2000', 2250', 2500', 2750', 3000', 3250', 3500', and 4000' with no deviation from vertical noted.

RECEIVED

STATE CORPORATION

OCT 2 1957

CONSERVATION DIVISION  
Wichita, Kansas

See

# SKELLY OIL COMPANY

## REPORT OF CHANGE IN WELL RECORD

Give complete description of all cleaning out, deepening, plugging back and fishing jobs, changes in casing, material lost in hole, etc., not recorded in original well record.

Lease Holder John Holder

LEASE 1 WELL NO. Western Kansas DISTRICT

SEC. 36 T. 290 R. 70 COUNTY McPherson JOB NO. 129

SURVEY \_\_\_\_\_ BLOCK \_\_\_\_\_ STATE Kansas

ACID CLEANING OUT RECORD				PLUGGING BACK OR DEEPENING RECORD			
Date commenced.....	<u>June 9,</u>		19 <u>58</u>	Date commenced.....			19.....
Date completed.....	<u>June 12,</u>		19 <u>58</u>	Date completed.....			19.....
Cleaned out from.....	to.....	T.D. <u>4367'</u>		Plugged back or deepened from.....	to.....	T.D. ....	
Prod. before <u>10</u> bbls. <u>5</u> bbls. <u>--</u> cu. ft.	oil.....	water.....	gas.....	Prod. before.....	bbls. oil.....	bbls. water.....	cu. ft. gas.....
Prod. after <u>210</u> bbls. <u>36</u> bbls. <u>--</u> cu. ft.	oil.....	water.....	gas.....	Prod. after.....	bbls. oil.....	bbls. water.....	cu. ft. gas.....
Kind of tools used: <u>Pulling Unit</u>				Kind of tools used:.....			
Tools owned by: <u>Pratt Well Service</u>				Tools owned by:.....			

**SHOT RECORD**

Date	Size shot	Shot between	Size of shell	Put in by (Co.)	Length anchor	Distance below casing	Damage to casing or casing shoulder
<u>6/9/58</u>	<u>1750 gals. Qts.</u>	<u>4100 Ft. and 4167 Ft.</u>		<u>Calliburton</u>			

**CHANGES IN CASING RECORD**

SIZE	Wt.	Thds.	Where Set	PULLED OUT			LEFT IN			KIND	Cond'n	CEMENTING	
				Jts.	Feet	In.	Jts.	Feet	In.			Sacks Used	Method Employed

STILL UNDER REVIEW  
 OIL AND GAS COMMISSION  
 WICHITA, KANSAS

OCT 20 1961

CONSERVATION DIVISION  
 Wichita, Kansas

Liner set at..... Length..... Perforated at.....  
 Packer set at..... Size and kind.....

Superintendent.

REMARKS (Give review of work accomplished and any other comment of interest)

On June 3, 1958, pulled rods and pump. Treated through 2" tubing with 250 gallons of Halliburton 15% acid and 1500 gals. Halliburton HV acid as follows:

ACID TREATMENT NO. 2 - Between 4160' and 4167'

Treatment run in 6/3/58 by Halliburton, using 1750 gallons of acid and 160 barrels of oil.

TIME	CP	TP	REMARKS
2:27 pm			Start acid
2:33 pm	100'	100'	Acid on bottom
2:40 pm	400'	400'	
2:50 pm	800'	800'	
2:59 pm	800'	800'	

Ran rods and on June 4, FOB 10 hours, 31 barrels of oil used in treating and no water. On June 5, FOB 2 1/2 hours, 41 barrels of oil used in treating, no water.

DATE	HOURS PUMPED	BBLS. OIL	BBLS. WTR.	REMARKS
6/6/58	24	31	0	Oil used in treating
6/7/58	24	33	0	"
6/8/58	24	20	0	"
		8	0	Formation oil
6/9/58	24	26 1/2	43	
6/10/58	24	20	47	
6/11/58	24	18	29	

RECORD OF FORMATIONS

FORMATION	TOP	BOTTOM	REMARKS
6/12/58	24	21 1/2	36
TOTAL DEPTH 4167'			

Indicate Casing Points, Describe Shows of Oil, Gas and Water, etc.

## DEEPENING RECORD

Date Commenced: May 14, 1959  
Date Completed: May 24, 1959

Deepened from 4167' to 4180 1/2' SLM PB TD-4174'

Production Before: 6 1/2 barrels of oil and 15 1/2 barrels water  
Production After: POB 24 hours, 11 barrels of oil and 40 barrels water

Producing Formation: Mississippi Lime (open hole)

On May 14, 1959, moved in and rigged up cable tools of W. L. Copeland, pulled rods and 2" tubing and bailed and cleaned out hole to bottom, 4167'. Swabbed hole down to top of liner at 4110'. Deepened as follows:

Light tan dolomite with very small amount of stain and saturation	4167	4172
White to gray dolomite, no stain or saturation	4172	4177
SLM correction	4177	4180 1/2'

TOTAL DEPTH 4180 1/2'

Swabbed through 5 1/2" casing 12 hours, 8 barrels of oil and 11 barrels of water (last 5 hours, 1/2 barrel of oil and 3/4 barrels of water per hour). Loaded hole with 30 barrels of oil and plugged back with 6 gallons of Halliburton Latex cement from 4180 1/2' to 4174' SLM.

PLUGGED BACK TOTAL DEPTH 4174'

Swabbed through 5 1/2" casing 6 hours, 24 barrels of oil used in loading hole and 4 barrels of water; then swabbed through 5 1/2" casing 4 hours, 6 barrels of oil used in loading hole and 2 barrels of water. Ran Halliburton Acid-Frac as follows:

TREATMENT NO. 4 - Acid-Frac between 4167' and 4174' <sup>60</sup>

Used 8000# of sand  
5000 gallons of gelled acid  
140 barrels of oil to flush  
Maximum CP-1400#, minimum CP-600#  
Time 13 minutes  
Injection rate: 10 barrels per minute

Let set 8 hours, then swabbed through 5 1/2" casing 8 hours, 82 barrels of oil used in treating and 46 barrels of spent acid water. On May 17, swabbed through casing 24 hours, 28 barrels of oil used in treating, 77 barrels spent acid water. Swabbed through 5 1/2" casing 4 hours, 4 barrels of oil used in treating and 10 barrels of water.

Ran 2" tubing and rods and set tubing at 4171' and pump at 4155'.

DATE	HOURS POB	BBL. OIL	BBL. WTR.	REMARKS
5/18/59	6	5	20	Oil used in treating
5/19/59	24	9	36	"
5/20/59	24	10	40	"
5/21/59	24	2	8	"
5/22/59	24	10	34	
5/23/59	24	10	36	
5/24/59	24	11	40	

RECEIVED  
STATE CORPORATION COMMISSION

OCT 20 1959

CONSERVATION DIVISION  
Wichita, Kan.

# SKELLY OIL COMPANY

## CHANGE IN WELL RECORD

Give complete description of all cleaning out, deepening, plugging back and fishing jobs, changes in casing, material lost in hole, etc, not recorded in original well record.

LEASE NAME Ruth Holder  
 SEC. 34 T. 29S R. 7W  
 BLOCK \_\_\_\_\_ SURVEY \_\_\_\_\_

WELL NO. 1 DISTRICT Western Kansas  
 COUNTY Kingman AFE NO. 6822  
 STATE Kansas

### TYPE OF WORK TEST LANSING LINE

Date commenced April 7, 1961 Date completed April 9, 1961  
 Deepened from \_\_\_\_\_ to \_\_\_\_\_ Total Depth \_\_\_\_\_  
 Plugged back from 4174' to 3447' P.B.T.D. 3447'  
 Cleaned out from \_\_\_\_\_ to \_\_\_\_\_  
 Production before 3 bbls. oil 4 bbls. water 0 cu. ft. gas.  
 Production after \_\_\_\_\_ bbls. oil \_\_\_\_\_ bbls. water \_\_\_\_\_ cu. ft. gas.  
 Tools owned by: W. L. Copeland Kind used: Cable No. days rig time: 3  
 Cost of Job \$ \_\_\_\_\_ Revised Estimated Payout (Mos.) \_\_\_\_\_

### TREATMENT RECORD

DATE	TYPE TREATMENT	INTERVAL TREATED	AMOUNT OF TREATMENT

### CHANGES IN CASING RECORD

STRINGS	SIZE	WHERE SET (Depth)	CEMENTING RECORD		REMARKS
			Sacks Used	Top Cem't. Bh'd. Cas'g.	
Production					
Liner					Top liner;

SIZE	WT.	THDS.	KIND	COND.	LEFT IN						PULLED OUT					
					Jts.	LTM		WTM		Jts.	LTM		WTM			
						Feet	In.	Feet	In.		Feet	In.	Feet	In.		

### PRODUCING FROM

\_\_\_\_\_ thru OPEN HOLE PERFORATIONS \_\_\_\_\_ TOP \_\_\_\_\_ BOTTOM \_\_\_\_\_ Total No. Shots \_\_\_\_\_

REMARKS (Give review of work performed and any other comment of interest)

On April 7, 1961, moved in and rigged up cable tools, pulled rods and 2" tubing. Ran steel line measurement and found no fill up. Swabbed hole down, 2 barrels of oil and 2 1/2 barrels of water; bailed 2 hours, 5 gallons oil per hour.

Set bridging plug at 3790' and plugged back from 3790' to 3787' with 1/2 sack of Cal-Seal.

PERFORATION JOB NO. 1 - Lansing Line - 3777'-3782'  
 5 1/2" casing perforated with 4 Kone shots per foot by Lane-Wells:

3777'-3782' - 5' - 20 Holes

Swabbed through 5 1/2" casing 3 hours, no oil and 1 barrel of water per hour, then swabbed 5 hours, 1 barrel of salt water per hour.

Set Lane-Wells cast iron bridging plug at 3450' and plugged back with 1/2 sack of Cal-Seal from 3450' to 3447'.

PLUGGED BACK TOTAL DEPTH 3447'

PERFORATION JOB NO. 2 - Lansing Line - 3434'-3440'  
 5 1/2" casing perforated with 4 Kone shots per foot by Lane-Wells:

3434'-3440' - 6' - 24 holes

Swabbed through casing 14 hours, 2-3/4 barrels of salt water per hour, no oil or gas. On April 9, 1961, shut down for orders.



# SKELLY OIL COMPANY

## CHANGE IN WELL RECORD

Give complete description of all cleaning out, deepening, plugging, back and fishing jobs, changes in casing, material lost in hole, etc, not recorded in original well record.

LEASE NAME Euth Holder WELL NO. 1 DISTRICT Kansas  
 SEC. 34 T. 29S R. 7W COUNTY Wichita AFE NO. 7121  
 BLOCK \_\_\_\_\_ SURVEY \_\_\_\_\_ STATE Kansas

### TYPE OF WORK PLUG AND ABANDON WELL

Date commenced September 30, 1961 Date completed October 3, 1961  
 Deepened from \_\_\_\_\_ to \_\_\_\_\_ Total Depth \_\_\_\_\_  
 Plugged back from 3447' to Surface P.B.T.D. Surface  
 Cleaned out from \_\_\_\_\_ to \_\_\_\_\_  
 Production before 0 bbls. oil 100% wtr. bbls. water 0 cu. ft. gas.  
 Production after \_\_\_\_\_ bbls. oil \_\_\_\_\_ bbls. water \_\_\_\_\_ cu. ft. gas.  
 Tools owned by: Ace Pipe Pulling Company Kind used: Hydraulic No. days rig time: 3  
 Cost of Job \$ \_\_\_\_\_ Revised Estimated Payout (Mos.) \_\_\_\_\_

### TREATMENT RECORD

DATE	TYPE TREATMENT	INTERVAL TREATED	AMOUNT OF TREATMENT

### CHANGES IN CASING RECORD

STRINGS	SIZE	WHERE SET (Depth)	CEMENTING RECORD		REMARKS
			Sacks Used	Top Cem't. Bh'd. Casg.	
Production					
Liner					Top liner;

SIZE OD	WT.	THDS.	KIND	COND.	LEFT IN				PULLED OUT					
					Jts.	LTM	WTM	In.	Jts.	LTM	WTM	In.		
<u>5-1/2</u>	<u>16.9</u>	<u>SR</u>	<u>55 R2 S5</u>	<u>0</u>	<u>29</u>	<u>9.7</u>	<u>0</u>	<u>9.5</u>	<u>3</u>	<u>100</u>	<u>3206</u>	<u>0</u>	<u>3227</u>	<u>0</u>

### PRODUCING FROM

FORMATION \_\_\_\_\_ thru OPEN HOLE PERFORATIONS TOP \_\_\_\_\_ BOTTOM \_\_\_\_\_ Total No. Shots \_\_\_\_\_

REMARKS (Give review of work performed and any other comment of interest)

As the Lansing zones have been tested with 100 per cent show of salt water, and as there are no other zones to test and the well is not required for disposal or secondary recovery purposes, regular authority was granted to plug and abandon it.

On September 30, 1961, moved in machine and plugged back with sand as follows:

Sand 3447' to 3420'  
 5 sacks cement 3420' to 3380'

Shot off 5 1/2" casing at 3270' and 3200'. Pulled 100 joints (3206') of 5 1/2" casing.

Mud 3380' to 310'  
 Rock bridge 310' to 300'  
 20 sacks cement 300' to 240'  
 Mud 240' to 35'  
 Rock 35' to 30'  
 10 sacks of cement 30' to 5'  
 Surface soil 5' to Surface

Plugged and abandoned October 3, 1961.

**RECEIVED**  
 STATE CORPORATION COMMISSION

OCT 20 1961  
 CONSERVATION DIVISION  
 Wichita, Kansas