

STATE OF KANSAS
STATE CORPORATION COMMISSION

WELL PLUGGING RECORD

Give All Information Completely
Make Required Affidavit
Mail or Deliver Report to
Conservation Division
State Corporation Comm.
245 North Water
Wichita, KS 67202

Stanton County. Sec. 32 Twp. 29 Rge. 40 W
Location as "NE/CNW $\frac{1}{4}$ SW $\frac{1}{4}$ " or footage from lines _____
C NW/4 1320 FNL x 1320 FWL
Lease Owner Amoco Production Company
Lease Name Plummer Gas Unit/CG/ Well No. 2
Office Address P. O. Box 432 Liberal, KS 67901
Character of Well (Completed as Oil, Gas or Dry Hole) _____
P&A - Lost Circulation
Date Well completed August 28 1980
Application for plugging filed August 28 1980
Application for plugging approved August 27 (Verbally) 1980
Plugging commenced August 28 1980
Plugging completed August 28 1980
Reason for abandonment of well or producing formation _____
Lost Circulation

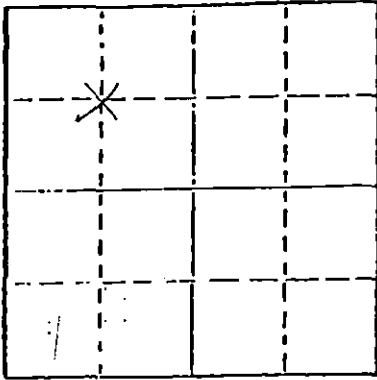

Locate well correctly on above
Section Plot

If a producing well is abandoned, date of last production _____
19

Was permission obtained from the Conservation Division or
its agents before plugging was commenced? Yes

Name of Conservation Agent who supervised plugging of this well Clarence Thomas
Producing formation None Depth to top Bottom Total Depth of Well 1483
Show depth and thickness of all water, oil and gas formations.

OIL, GAS OR WATER RECORDS

CASING RECORD

FORMATION	CONTENT	FROM	TO	SIZE	PUT IN	PULLED OUT
				8-5/8	619	0

Describe in detail the manner in which the well was plugged, indicating where the mud fluid
was placed and the method or methods used in introducing it into the hold. If cement or other
plugs were used, state the character of same and depth placed, from _____ feet to
_____ feet for each plug set.

Set Bridge Plug at 400 Ft. Cement with 50 sacks on bridge plug. Mud to 40 ft. and
cement with 10 sacks from 40 ft to top. 5 sacks of cement in rat and mouse hole.

RECEIVED
STATE CORPORATION COMMISSION

9-3-1980
SEP - 3 1980

(If additional description is necessary, use BACK of this sheet)

Name of Plugging Contractor Amoco Production Company with Dowell Sewittek Company

STATE OF Kansas COUNTY OF Seward, ss.
Gale McCord (employee of owner) or (owner or operator)
of the above-described well, being first duly sworn on oath, says: That I have knowledge of
the facts, statements, and matters herein contained and the log of the above-described well
as filed and that the same are true and correct. So help me God.

(Signature) Gale McCord Gale McCord
P. O. Box 432 Liberal, KS 67901

(Address)

SUBSCRIBED AND SWORN TO before me this 28th day of August, 19 80

J. L. Dressen J. L. Dressen
Notary Public.

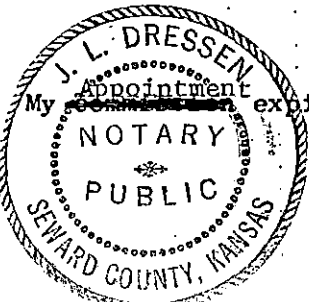

KANSAS DRILLERS LOG

S. 35 T. 29S R. 40 W
 Loc. 1320 FNL x 1320 FWL
 County Stanton

API No. 15 — 187 — 20328
 County Number

Operator
Amoco Production Company

Address
P. O. Box 432 Liberal, KS 67901

Well No. 2 Lease Name Plummer Gas Unit/CG/

Footage Location
1320 feet from (N) line 1320 feet from (W) line

Principal Contractor Service Drilling Geologist

Spud Date 8-24-80 Total Depth 1483 P.B.T.D.

Date Completed 8-28-80 Oil Purchaser

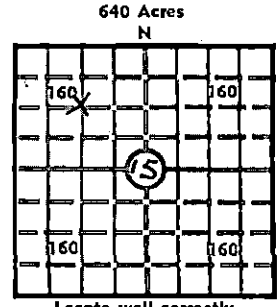

Elev.: Gr. _____
 DF _____ KB _____

CASING RECORD

Report of all strings set — surface, intermediate, production, etc.

Purpose of string	Size hole drilled	Size casing set (in O.D.)	Weight lbs/ft.	Setting depth	Type cement	Sacks	Type and percent additives
Surface	12-1/4	8-5/8	24	619	65/35 Poz	250	2% Calcium
					Class "H"	150	

LINER RECORD

PERFORATION RECORD

Top, ft.	Bottom, ft.	Sacks cement	Shots per ft.	Size & type	Depth interval

Size	Setting depth	Packer set at

ACID, FRACTURE, SHOT, CEMENT SQUEEZE RECORD

Amount and kind of material used	Depth interval treated

RECEIVED
 STATE CORPORATION COMMISSION
 SEP - 3 1980

INITIAL PRODUCTION

CONSERVATION DIVISION
 Wichita, Kansas

Date of first production _____ Producing method (flowing, pumping, gas lift, etc.) _____

RATE OF PRODUCTION PER 24 HOURS	Oil	Gas	Water	Gas-oil ratio
	bbls.	MCF	bbls.	CFPB

Disposition of gas (vented, used on lease or sold) _____ Producing interval(s) _____

INSTRUCTIONS: As provided in KCC Rule 82-2-125, within 90 days after completion of a well, one completed copy of this Drillers Log shall be transmitted to the State Geological Survey of Kansas, 4150 Monroe Street, Wichita, Kansas 67209. Copies of this form are available from the Conservation Division, State Corporation Commission, 3830 So. Meridian (P.O. Box 17027), Wichita, Kansas 66217. Phone AC 316-522-2206. If confidential custody is desired, please note Rule 82-2-125. Drillers Logs will be on an open file in the Oil and Gas Division, State Geological Survey of Kansas, Lawrence, Kansas 66044.

Operator Amoco Production Company DESIGNATE TYPE OF COMP.: OIL, GAS, DRY HOLE, SWDW, ETC.:

Well No. 2 Lease Name Plummer Gas Unit P&A - Lost Circulation

S 35 T29S R 40 W

WELL LOG
 Show all important zones of porosity and contents thereof; cored intervals, and all drill-stem tests, including depth interval tested, cushion used, time tool open, flowing and shut-in pressures, and recoveries. SHOW GEOLOGICAL MARKERS, LOGS RUN, OR OTHER DESCRIPTIVE INFORMATION.

FORMATION DESCRIPTION, CONTENTS, ETC.	TOP	BOTTOM	NAME	DEPTH
Surface , Sand	0	560		
Red Bed	560	830		
Red Bed, Sand	830	1060		
Sand	1060	1483		
Lost Circulation at 1483 Ft. Unable to regain circulation, and well was plugged.				

USE ADDITIONAL SHEETS, IF NECESSARY, TO COMPLETE WELL RECORD.

Date Received _____
 Signature Gale McCord
 Title Administrative Supervisor
 Date August 28, 1980