

STATE OF KANSAS
STATE CORPORATION COMMISSION

WELL PLUGGING RECORD

Give All Information Completely
Make Required Affidavit
Mail or Deliver Report to
Conservation Division
State Corporation Comm.
245 North Water
Wichita, KS 67202

Stanton County, Sec. 28 Twp. 29S Rge. 40 W/W
Location as "NE/CNW $\frac{1}{4}$ SW $\frac{1}{4}$ " or footage from lines
2310' ENL x 2310' FEL
Lease Owner Amoco Production Company
Lease Name R. Fletcher Gas Unit Well No. 1
Office Address P. O. Box 432 Liberal, KS
Character of Well (Completed as Oil, Gas or Dry Hole) Dry Hole

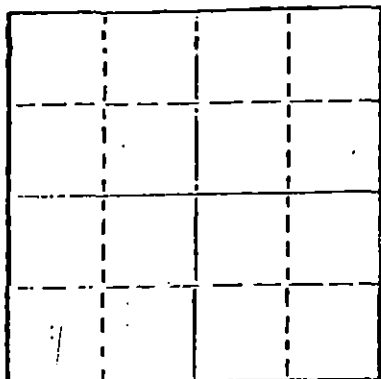

Locate well correctly on above
Section Plot

Date Well completed 2-7 1979
Application for plugging filed 1-10 1979
Application for plugging approved 1-12 1979
Plugging commenced 2-7 1979
Plugging completed 2-7 1979
Reason for abandonment of well or producing formation Excessive water production

If a producing well is abandoned, date of last production 19

Was permission obtained from the Conservation Division or its agents before plugging was commenced? Yes

Name of Conservation Agent who supervised plugging of this well Clarence Thomas
Producing formation Depth to top Bottom Total Depth of Well 2508

Show depth and thickness of all water, oil and gas formations.

OIL, GAS OR WATER RECORDS

CASING RECORD

FORMATION	CONTENT	FROM	TO	SIZE	PUT IN	PULLED OUT
Chase	Lime	2190	2396	8-5/8	630	-0-
				5-1/2	2516	-0-

Describe in detail the manner in which the well was plugged, indicating where the mud fluid was placed and the method or methods used in introducing it into the hold. If cement or other plugs were used, state the character of same and depth placed, from feet to feet for each plug set. Fill 5-1/2 inch casing with 50 sacks REC, wait one hour and follow with 250 sx 35/65 pozmix 6% gel, which fill casing with cement to within 6 feet of surface. Cut off casing and weld on cap 6 feet below ground level.

RECEIVED
STATE CORPORATION COMMISSION

FEB 25 1979

CONSERVATION DIVISION
Wichita, Kansas

2-23-1979

(If additional description is necessary, use BACK of this sheet)

Name of Plugging Contractor Dowell

STATE OF Kansas COUNTY OF Seward, ss.
G. E. Mullins (employee of owner) or (owner or operator)
of the above-described well, being first duly sworn on oath, says: That I have knowledge of the facts, statements, and matters herein contained and the log of the above-described well as filed and that the same are true and correct. So help me God.

(Signature) G. E. Mullins C. E. Mullins
P. O. Box 432 Liberal, KS Dist. Admin Supvr.
(Address)

SUBSCRIBED AND SWORN TO before me this 22 day of February, 19 79

J. L. Dressen
J. L. Dressen
Notary Public.

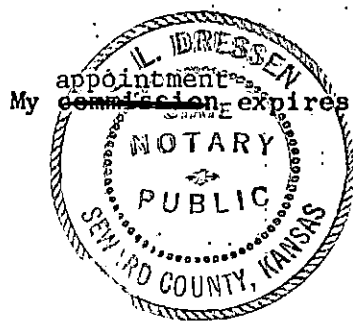

15-187-20287-0000

IMPORTANT
 Kans. Geo. Survey request
 samples on this well.

KANSAS DRILLERS LOG

S. 28 T. 29 R. 40 ^N/_W

API No. 15 — 187 — 20,287
 County Number

Loc. SW SW NE

Operator
Amoco Production Co.

County Stanton

Address
P. O. Box 432 Liberal, Kansas 67901

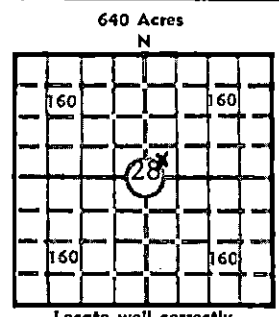

Well No. #1 Lease Name R. Fletcher Gas Unit

Footage Location
2310 feet from (N) ~~88~~ line 2310 feet from (E) ~~88~~ line

Elev.: Gr. 3281

Principal Contractor Service Drilling Company Geologist

Spud Date 9-6-78 Total Depth 2508 P.B.T.D. 2507

Date Completed Oil Purchaser

DF _____ KB _____

CASING RECORD

Report of all strings set — surface, intermediate, production, etc.

Purpose of string	Size hole drilled	Size casing set (in O.D.)	Weight lbs/ft.	Setting depth	Type cement	Sacks	Type and percent additives
Surface	12-1/4	8-5/8	24	634	35-65 Pozmix	250	2% CACL
					Class "H"	150	3% CACL
Production	7-7/8	5-1/2	14	2508	35-65 Pozmix	500	1/4# Flakes
					50-50 Pozmix	150	10% Salt

LINER RECORD

PERFORATION RECORD

Top, ft.	Bottom, ft.	Sacks cement	Shots per ft.	Size & type	Depth interval
			2	1/2" JET	2280-88

TUBING RECORD

Size	Setting depth	Packer set at	
			STOP

ACID, FRACTURE, SHOT, CEMENT SQUEEZE RECORD

Amount and kind of material used	Depth interval treated
Acidize w/1000 gal 15% HCL. Acidize w/2500 gal 15% HCL & 24 ball sealers. Frac w/34,000 gal gel wtr & 38,750# 8-12 frac sand, frac screened out. Pmp 1000 gal 15% HCL. Frac w/34,200 gal gel wtr & 38,750# 10-20 sand. INITIAL PRODUCTION	2280-2248

RECEIVED
 STATE CORPORATION COMMISSION
 JAN 12 1979

CONSERVATION DIVISION
 Wichita, Kansas

Date of first production No Production Producing method (flowing, pumping, gas lift, etc.)

RATE OF PRODUCTION PER 24 HOURS	Oil	Gas	Water	Gas/Oil Ratio	CFPB

Disposition of gas (vented, used on lease or sold) Well to be plugged and abandoned Producing interval(s)

INSTRUCTIONS: As provided in KCC Rule 82-2-125, within 90 days after completion of a well, one completed copy of this Drillers Log shall be transmitted to the State Geological Survey of Kansas, 4150 Monroe Street, Wichita, Kansas 67209. Copies of this form are available from the Conservation Division, State Corporation Commission, 3830 So. Meridian (P.O. Box 17027), Wichita, Kansas 66217. Phone AC 316-522-2206. If confidential custody is desired, please note Rule 82-2-125. Drillers Logs will be on an open file in the Oil and Gas Division, State Geological Survey of Kansas, Lawrence, Kansas 66044.

Operator AMOCO PRODUCTION COMPANY DESIGNATE TYPE OF COMP.: OIL, GAS, DRY HOLE, SWDW, ETC.:

Well No. 1 Lease Name R. FLETCHER GAS UNIT Dry hole

S 28 T 29S R 40 W

WELL LOG
 Show all important zones of porosity and contents thereof; cored intervals, and all drill-stem tests, including depth interval tested, cushion used, time tool open, flowing and shut-in pressures, and recoveries.
 SHOW GEOLOGICAL MARKERS, LOGS RUN, OR OTHER DESCRIPTIVE INFORMATION.

FORMATION DESCRIPTION, CONTENTS, ETC.	TOP	BOTTOM	NAME	DEPTH
Sand, Red Bed	0	570		
Red Bed	570	1170		
Sand, Shale	1170	1894		
Shale, Lime	1184	2195		
Lime	2195	2508		
TD		2508		
PBD		2507		

USE ADDITIONAL SHEETS, IF NECESSARY, TO COMPLETE WELL RECORD.

Date Received _____

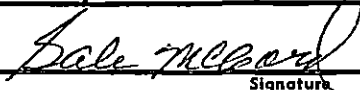
 Signature
 Administrative Supervisor
 Title
 1-10-79
 Date