

STATE OF KANSAS
STATE CORPORATION COMMISSION

WELL PLUGGING RECORD

Give All Information Completely
Make Required Affidavit
Mail or Deliver Report to
Conservation Division
State Corporation Comm.
245 North Water
Wichita, KS 67202

Stanton County. Sec. 32 Twp. 29 Rge. 40 E/W
Location as "NE/CNW $\frac{1}{4}$ SW $\frac{1}{4}$ " or footage from lines 2540' FNL
& 1320' FWL N. W. $\frac{1}{4}$
Lease Owner Amoco Production Company
Lease Name Stanley A. Julian Well No. 1-A
Office Address P. O. Box 432, Liberal, Kansas 67901
Character of Well (Completed as Oil, Gas or Dry Hole) Dry Hole
Date Well completed 4-13 1979
Application for plugging filed 3-21 1979
Application for plugging approved 3-22 1979
Plugging commenced 4-13 1979
Plugging completed 4-13 1979
Reason for abandonment of well or producing formation Excessive water production
If a producing well is abandoned, date of last production 19
Was permission obtained from the Conservation Division or its agents before plugging was commenced? Yes
Name of Conservation Agent who supervised plugging of this well Clarence Thomas
Producing formation N/A Depth to top Bottom Total Depth of Well 2507
Show depth and thickness of all water, oil and gas formations. PBTD 2503

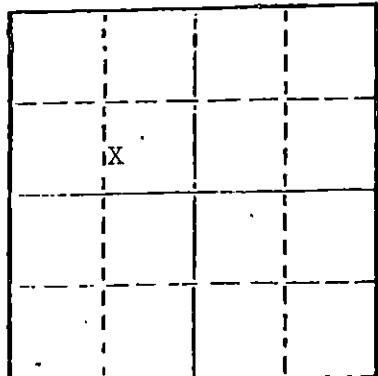

Locate well correctly on above Section Plot

OIL, GAS OR WATER RECORDS

CASING RECORD

FORMATION	CONTENT	FROM	TO	SIZE	PUT IN	PULLED OUT
Chase	Water	2152	2371	8-5/8"	664'	None
Fort Riley	Water	2371	2507	5-1/2"	2515'	None

Describe in detail the manner in which the well was plugged, indicating where the mud fluid was placed and the method or methods used in introducing it into the hold. If cement or other plugs were used, state the character of same and depth placed, from feet to feet for each plug set.

Fill well bore (5 1/2" 14# Csg) from 2503' to 8' below surface w/350 SX Cement. Cut off 8-5/8" & 5-1/2 Csg 8' below GR level and weld on steel cap.

(If additional description is necessary, use BACK of this sheet)

Name of Plugging Contractor Amoco Production Company with use of service company cementing truck. No casing recovered.

STATE OF Kansas COUNTY OF Seward, ss.
Gale McCord (employee of owner) or (owner or operator)
of the above-described well, being first duly sworn on oath, says: That I have knowledge of the facts, statements, and matters herein contained and the log of the above-described well, as filed and that the same are true and correct. So help me God.

(Signature) Gale McCord Gale McCord
P. O. Box 432, Liberal, Kansas 67901
(Address)

SUBSCRIBED AND SWORN TO before me this 11 day of October, 19 79
J. L. Dressen
Notary Public.

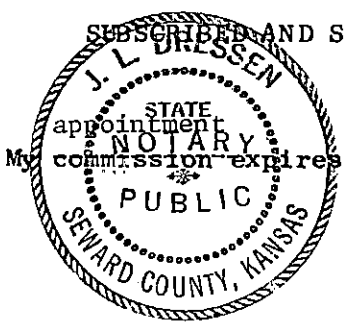

RECEIVED
STATE CORPORATION COMMISSION
OCT 19 1979
CONSERVATION DIVISION
Wichita, Kansas
10-19-1979

15-187-20294-0000

KANSAS DRILLERS LOG

S. 32 T. 29S R. 40 E. W

API No. 15 — 187 — 20294
 County Number

Loc. 2540' FNL & 1320' FWL
 County Stanton

Operator
Amoco Production Company

Address
P. O. Box 432, Liberal, KS 67901

Well No. 1-A Lease Name Stanley A. Julian

Footage Location
2540 feet from (N) (SE) line 1320 feet from (E) (W) line

Principal Contractor Service Drilling Company Geologist

Spud Date 09-26-78 Total Depth 2507 P.B.T.D. 2503

Date Completed Dry Hole Oil Purchaser

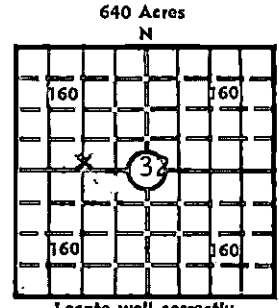

Elev.: Gr. _____
 DF _____ KB _____

CASING RECORD

Report of all strings set — surface, intermediate, production, etc.

Purpose of string	Size hole drilled	Size casing set (in O.D.)	Weight lbs/ft.	Setting depth	Type cement	Sacks	Type and percent additives
Surface	12-1/4	8-5/8	24	668	Howco Lite	235	2% CACL
					Pozmix	150	3% CACL
Production	7-7/8	5-1/2	14	2507	Howco Lite	450	1/4# Flakes
					50-50 Pozmix	150	18% Salt

LINER RECORD

PERFORATION RECORD

Top, ft.	Bottom, ft.	Sacks cement	Shots per ft.	Size & type	Depth interval
			2	1/2" Jet	2152-70, 2200-
TUBING RECORD					12, 2224-50
Size	Setting depth	Packer set at			

ACID, FRACTURE, SHOT, CEMENT SQUEEZE RECORD

Amount and kind of material used	Depth interval treated
Acid w/5000 gal 15% HCL & 140 ball sealers. Frac w/ 50,000 gal trt wtr & 75,000# river sand.	2152 - 2250

INITIAL PRODUCTION

Date of first production <u>Dry hole</u>	Producing method (flowing, pumping, gas lift, etc.)		
RATE OF PRODUCTION PER 24 HOURS	Oil bbls.	Gas MCF	Water CFPB
Disposition of gas (vented, used on lease or sold) <u>Well to be plugged and abandoned</u>		Producing interval (s)	

RECEIVED
 STATE CORPORATION COMMISSION
 MAR 22 1979
 CONSERVATION DIVISION
 WICHITA, KANSAS

INSTRUCTIONS: As provided in KCC Rule 82-2-125, within 90 days after completion of a well, one completed copy of this Drillers Log shall be transmitted to the State Geological Survey of Kansas, 4150 Monroe Street, Wichita, Kansas 67209. Copies of this form are available from the Conservation Division, State Corporation Commission, 3830 So. Maridian (P.O. Box 17027), Wichita, Kansas 66217. Phone AC 316-522-2206. If confidential custody is desired, please note Rule 82-2-125. Drillers Logs will be on open file in the Oil and Gas Division, State Geological Survey of Kansas, Lawrence, Kansas 66044.

Operator Amoco Production Company		DESIGNATE TYPE OF COMP.: OIL, GAS, DRY HOLE, SWDW, ETC.:
Well No. 1-A	Lease Name Stanley A. Julian	Dry Hole
S 32 T 29S R 40		

WELL LOG

Show all important zones of porosity and contents thereof; cored intervals, and all drill-stem tests, including depth interval tested, cushion used, time tool open, flowing and shut-in pressures, and recoveries.

SHOW GEOLOGICAL MARKERS, LOGS RUN, OR OTHER DESCRIPTIVE INFORMATION.

FORMATION DESCRIPTION, CONTENTS, ETC.	TOP	BOTTOM	NAME	DEPTH
Sand, Red Bed	0	560		
Red Bed	560	1050		
Sand, Shale	1050	1604		
Red Bed, Sand, Shale	1604	1813		
Sand, Shale, Gyp	1813	2040		
Lime	2040	2507		

USE ADDITIONAL SHEETS, IF NECESSARY, TO COMPLETE WELL RECORD.

Date Received	<i>Gale McCord</i>	Gale McCord
	Signature	
	Administrative Supervisor	
	Title	
	3-21-79	
	Date	