

15-187-20283-0000

| | |
|-------------------------|-------|
| RECEIVED | |
| LIBERAL DIST. FORM-CP-4 | |
| FEB 27 1979 | |
| DS | |
| DAS | |
| DE | |
| DF | |
| DR | |
| RS | |
| WELL No. | 1 |
| FJR. | 67901 |
| City | |
| BDL | |

STATE OF KANSAS
STATE CORPORATION COMMISSION

WELL PLUGGING RECORD

Give All Information Completely
Make Required Affidavit
Mail or Deliver Report to
Conservation Division
State Corporation Comm.
245 North Water
Wichita, KS 67202

Stanton County. Sec. 29 Twp. 29S. Rge. 40 W
Location as "NE/CNW $\frac{1}{4}$ SW $\frac{1}{4}$ " or footage from lines
2540' FSL x 2310' FEL

Lease Owner Amoco Production Company
Lease Name Strong Gas Unit
Office Address P. O. Box 432 Liberal, KS
Character of Well (Completed as Oil, Gas or Dry Hole)
Dry Hole

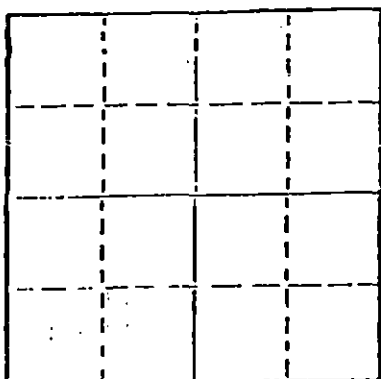

Locate well correctly on above
Section Plat

Date Well completed 2-7 1979
Application for plugging filed 1-10 1979
Application for plugging approved 1-12 1979
Plugging commenced 2-7 1979
Plugging completed 2-7 1979
Reason for abandonment of well or producing formation
Excessive water production

If a producing well is abandoned, date of last production
19

Was permission obtained from the Conservation Division or
its agents before plugging was commenced? Yes

Name of Conservation Agent who supervised plugging of this well Clarence Thomas
Producing formation Depth to top Bottom Total Depth of Well 3000

Show depth and thickness of all water, oil and gas formations.

OIL, GAS OR WATER RECORDS

CASING RECORD

| FORMATION | CONTENT | FROM | TO | SIZE | PUT IN | PULLED OUT |
|---------------|---------|------|------|-------|--------|------------|
| Chase | Lime | 2170 | 2380 | 8-5/8 | 618 | - 0- |
| Council Grove | Lime | 2481 | 2772 | 5-1/2 | 3011 | - 0- |
| | | | | | | |
| | | | | | | |

Describe in detail the manner in which the well was plugged, indicating where the mud fluid
was placed and the method or methods used in introducing it into the hold. If cement or other
plugs were used, state the character of same and depth placed, from feet to
feet for each plug set. Fill 5-1/2 inch casing with 50 sacks REC, waited one
hour and followed with 250 sacks 35/65 pozmix with 6% gel which filled casing
to within 6 feet of surface. Cut off casing and welded on cap.

RECEIVED
STATE CORPORATION COMMISSION
3-1-1979
MAR - 1 1979

RECEIVED
STATE CORPORATION COMMISSION
FEB 26 1979
CONSERVATION DIVISION
Wichita, Kansas

(If additional description is necessary, use BACK of this sheet)

Name of Plugging Contractor Dowell

STATE OF Kansas COUNTY OF Seward, ss.
C. E. Mullins (employee of owner) or (owner or operator)
of the above-described well, being first duly sworn on oath, says: That I have knowledge of
the facts, statements, and matters herein contained and the log of the above-described well
as filed and that the same are true and correct. So help me God.

(Signature) C. E. Mullins
P. O. Box 432 Liberal, KS 67901
(Address)
C. E. Mullins
Dist. Admtr.
Supvr.

SUBSCRIBED AND SWORN TO before me this 22 day of February, 19 79

X [Signature]
I. I. Dressen
Notary Public.

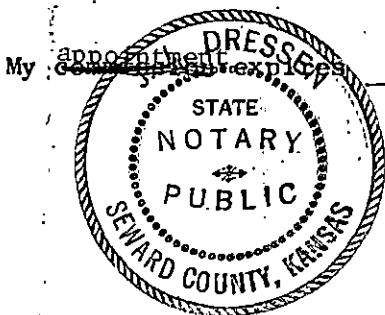

2-2-81

KANSAS DRILLERS LOG

S. 29 T. 29S R. 40 ^{XK}W
 Loc. 2540' FSL & 2310' FEL
 County Stanton

API No. 15 — 187 — 20283
 County Number

Operator
 Amoco Production Company

Address
 P. O. Box 432, Liberal, KS 67901

Well No. 1 Lease Name Strong Gas Unit

Footage Location
 2540 feet from ~~XXX~~ (S) line 2310 feet from (E) ~~XXX~~ line

Principal Contractor Service Drilling Company Geologist

Spud Date 8-26-78 Total Depth 3000 P.B.T.D. 2425

Date Completed Oil Purchaser

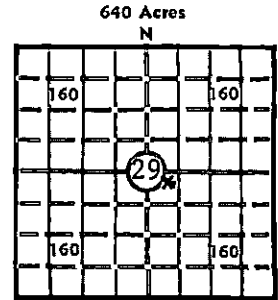

Elev.: Gr. 3293
 DF KB

CASING RECORD

Report of all strings set — surface, intermediate, production, etc.

| Purpose of string | Size hole drilled | Size casing set (in O.D.) | Weight lbs/ft. | Setting depth | Type cement | Sacks | Type and percent additives |
|-------------------|-------------------|---------------------------|----------------|---------------|-------------|-------|----------------------------|
| Surface | 12-1/4 | 8-5/8 | 24 | 622 | Howco Lite | 235 | 2% CACL |
| | | | | | Galss "H" | 150 | 3% CACL |
| Production | 7-7/8 | 5-1/2 | 14 | 2999 | Howco Lite | 600 | 1/4# Flakes |
| | | | | | Class "H" | 150 | 18% Salt |

LINER RECORD

PERFORATION RECORD

| Top, ft. | Bottom, ft. | Sacks cement | Shots per ft. | Size & type | Depth interval |
|----------------------|-------------|--------------|---------------|-------------|-----------------------------|
| | | | 2 | 1/2" JET | 2481-2508 |
| TUBING RECORD | | | | | 2262-70 |
| | | | | | 2170-88, 2208-14 2220-28 |

ACID, FRACTURE, SHOT, CEMENT SQUEEZE RECORD

| Amount and kind of material used | Depth interval treated |
|--|------------------------|
| Acidize w/1350 gal 15% HCL w/60 ball sealers. Frac w/ 25,000 gal trt wtr & 50,000# river sand. | 2481-2508 |
| Acidize w/800 gal 15% HCL | 2262-70 |
| Acidize w/2500 gal 15% HCL w/50 ball sealers. Frac w/60,000 gal trt wtr & 120,000# river sand. | 2170-2228 |

INITIAL PRODUCTION

Date of first production No Production Producing method (flowing, pumping, gas lift, etc.) JAN 12 1979

RATE OF PRODUCTION PER 24 HOURS Oil Gas Water
 bbls. MCF bbls. CFPB

Disposition of gas (vented, used on lease or sold) Producing interval (s)
 Well to be plugged & abandoned

RECEIVED
 STATE CORPORATION COMMISSION

CONSERVATION DIVISION
 Wichita, Kansas

INSTRUCTIONS: As provided in KCC Rule 82-2-125, within 90 days after completion of a well, one completed copy of this Drillers Log shall be transmitted to the State Geological Survey of Kansas, 4150 Monroe Street, Wichita, Kansas 67209. Copies of this form are available from the Conservation Division, State Corporation Commission, 3830 So. Meridian (P.O. Box 17027), Wichita, Kansas 66217. Phone AC 316-522-2206. If confidential custody is desired, please note Rule 82-2-125. Drillers Logs will be on open file in the Oil and Gas Division, State Geological Survey of Kansas, Lawrence, Kansas 66044.

Operator AMOCO PRODUCTION COMPANY DESIGNATE TYPE OF COMP.: OIL, GAS, DRY HOLE, SWDW, ETC.:

Well No. 1 Lease Name STRONG GAS UNIT Dry hole

S 29 T 29S R 40 K W

WELL LOG

Show all important zones of porosity and contents thereof; cored intervals, and all drill-stem tests, including depth interval tested, cushion used, time tool open, flowing and shut-in pressures, and recoveries.

SHOW GEOLOGICAL MARKERS, LOGS RUN, OR OTHER DESCRIPTIVE INFORMATION.

| FORMATION DESCRIPTION, CONTENTS, ETC. | TOP | BOTTOM | NAME | DEPTH |
|---------------------------------------|------|--------|------|-------|
| Sand, Red Bed | 0 | 560 | | |
| Red Bed | 560 | 907 | | |
| Red Bed, Sand | 907 | 1583 | | |
| Shale, Lime | 1583 | 1803 | | |
| Shale | 1803 | 2384 | | |
| Shale Lime | 2384 | 2594 | | |
| Lime | 2594 | 3000 | | |
| TD | | 3000 | | |
| PBD | | 2425 | | |

USE ADDITIONAL SHEETS, IF NECESSARY, TO COMPLETE WELL RECORD.

Date Received

Gale McCord Signature
 Administrative Supervisor Title
 1-10-79 Date