

STATE OF KANSAS  
STATE CORPORATION COMMISSION

WELL PLUGGING RECORD

Give All Information Completely  
Make Required Affidavit  
Mail or Deliver Report to  
Conservation Division  
State Corporation Comm.  
245 North Water  
Wichita, KS 67202

Stanton County. Sec. 7 Twp. 29 Rge. 40 E/W  
Location as "NE/CNW 1/4 SW 1/4" or footage from lines 1740 Ft.  
FNL and 2490 Ft. FEL

Lease Owner Amoco Production Company  
Lease Name Trostle Gas Unit Well No. 1-A  
Office Address P. O. Box 432, Liberal, Kansas 67901  
Character of Well (Completed as Oil, Gas or Dry Hole) \_\_\_\_\_

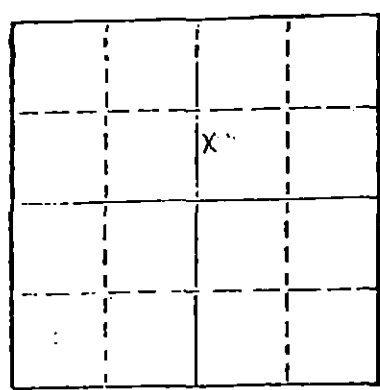

Lost Hole  
Date Well completed 2-17- 1978  
Application for plugging filed 4-7 1978  
Application for plugging approved 4-12- 1978  
Plugging commenced 4-21- 1978  
Plugging completed 4-21- 1978  
Reason for abandonment of well or producing formation Lost circulation during drilling, could not regain.  
If a producing well is abandoned, date of last production 19 \_\_\_\_\_

Was permission obtained from the Conservation Division or its agents before plugging was commenced? Yes

Name of Conservation Agent who supervised plugging of this well Clarence Thomas  
Producing formation \_\_\_\_\_ Depth to top \_\_\_\_\_ Bottom \_\_\_\_\_ Total Depth of Well 1538  
Show depth and thickness of all water, oil and gas formations.

OIL, GAS OR WATER RECORDS

CASING RECORD

FORMATION	CONTENT	FROM	TO	SIZE	PUT IN	PULLED OUT
				8 5/8	654	-0-

Describe in detail the manner in which the well was plugged, indicating where the mud fluid was placed and the method or methods used in introducing it into the hold. If cement or other plugs were used, state the character of same and depth placed, from \_\_\_\_\_ feet to \_\_\_\_\_ feet for each plug set. Set cast iron bridge plug at 305 feet. Filled 8 5/8" casing with 100 sacks Class "H" cement to surface. Cut 8 5/8" off 6 feet below ground level.

(If additional description is necessary, use BACK of this sheet)

Name of Plugging Contractor \_\_\_\_\_

STATE OF KANSAS COUNTY OF SEWARD, ss.  
Gale McCord (employee of owner) or (owner or operator)  
of the above-described well, being first duly sworn on oath, says: That I have knowledge of the facts, statements, and matters herein contained and the log of the above-described well as filed and that the same are true and correct. So help me God.

(Signature) Gale McCord Gale McCord  
P. O. Box 432, Liberal, Kansas 67901  
(Address)

SUBSCRIBED AND SWORN TO before me this 17 day of May, 1978

J. L. Dressen J. L. Dressen  
Notary Public.

My appointment expires 2-2-81

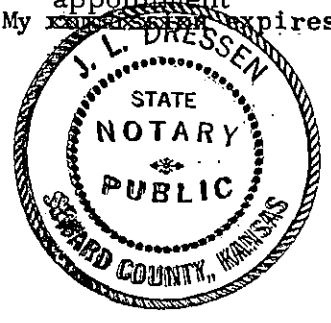

RECEIVED  
STATE CORPORATION COMMISSION

MAY 19 1978 5-19-1978  
CONSERVATION DIVISION  
Wichita, Kansas

15-187-20259-0000

**KANSAS DRILLERS LOG**

S. 7 T. 29 R. 40 ~~X~~ W  
 Loc. 1740 FNL X 2490 FEL  
 County Stanton

API No. 15 — 187 — 20259  
 County Number

Operator  
Amoco Production Company

Address  
P. O. Box 432, Liberal, Kansas 67901

Well No. 21-A Lease Name Trostle Gas Unit

Footage Location  
1740 feet from (N) ~~(S)~~ line 2490 feet from (E) ~~(W)~~ line

Principal Contractor Service Drilling Geologist \_\_\_\_\_

Spud Date 02-14-78 Total Depth 1538 P.B.T.D. \_\_\_\_\_

Date Completed \_\_\_\_\_ Oil Purchaser \_\_\_\_\_

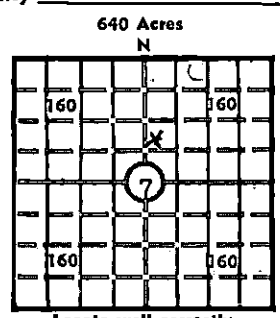

Locate well correctly  
 Elev.: Gr. 3318  
 DF \_\_\_\_\_ KB \_\_\_\_\_

**CASING RECORD**

Report of all strings set— surface, intermediate, production, etc.

Purpose of string	Size hole drilled	Size casing set (in O.D.)	Weight lbs/ft.	Setting depth	Type cement	Sacks	Type and percent additives
Surface	12 1/4	8 5/8	24	658	Class "H"	385	3% CC

**LINER RECORD**

**PERFORATION RECORD**

Top, ft.	Bottom, ft.	Sacks cement	Shots per ft.	Size & type	Depth interval

Size	Setting depth	Packer set at

**ACID, FRACTURE, SHOT, CEMENT SQUEEZE RECORD**

Amount and kind of material used	Depth interval treated

RECEIVED  
 STATE CORPORATION COMMISSION  
 APR 12 1978

**INITIAL PRODUCTION**

CONSERVATION DIVISION  
 WICHITA, KANSAS

Date of first production \_\_\_\_\_ Producing method (flowing, pumping, gas lift, etc.) \_\_\_\_\_

RATE OF PRODUCTION PER 24 HOURS	Oil	Gas	Water	Gas-oil ratio
	bbls.	MCF	bbls.	CFPB

Disposition of gas (vented, used on lease or sold) \_\_\_\_\_ Producing interval(s) \_\_\_\_\_

**INSTRUCTIONS:** As provided in KCC Rule 82-2-125, within 90 days after completion of a well, one completed copy of this Drillers Log shall be transmitted to the State Geological Survey of Kansas, 4150 Monroe Street, Wichita, Kansas 67209. Copies of this form are available from the Conservation Division, State Corporation Commission, 3830 So. Maridian (P.O. Box 17027), Wichita, Kansas 66217. Phone AC 316-522-2206. If confidential custody is desired, please note Rule 82-2-125. Drillers Logs will be on an open file in the Oil and Gas Division, State Geological Survey of Kansas, Lawrence, Kansas 66044.

Operator **Amoco Production Company** DESIGNATE TYPE OF COMP.: OIL, GAS, DRY HOLE, SWDW, ETC.:

Well No. **1-A** Lease Name **Trostle Gas Unit** Lost Hole

S 7 T 29 R 40 E  
W

**WELL LOG**  
 Show all important zones of porosity and contents thereof; cored intervals, and all drill-stem tests, including depth interval tested, cushion used, time tool open, flowing and shut-in pressures, and recoveries. SHOW GEOLOGICAL MARKERS, LOGS RUN, OR OTHER DESCRIPTIVE INFORMATION.

FORMATION DESCRIPTION, CONTENTS, ETC.	TOP	BOTTOM	NAME	DEPTH
Sand, Rock	0	163		
Shale, Sand, Red Bed	163	653		
Red Bed, Sand	653	934		
Red Bed, Sand, Shale	934	1538		

USE ADDITIONAL SHEETS, IF NECESSARY, TO COMPLETE WELL RECORD.

Date Received \_\_\_\_\_  
 Signature Gale McCord **Gale McCord**  
 Administrative Supervisor  
 Title  
 Date April 7, 1978  
 Date