

STATE CORPORATION COMMISSION OF KANSAS
 OIL & GAS CONSERVATION DIVISION

WELL COMPLETION OR RECOMPLETION FORM
 ACO-1 WELL HISTORY

DESCRIPTION OF WELL AND LEASE

Operator: License # 6417
 Name Champlin Petroleum Company
 Address 6441 NW Grand Blvd., Suite 300
 City/State/Zip Oklahoma City, OK 73116

Purchaser City Service Gas

Operator Contact Person J. L. Ford
 Phone 405-840-5521

Contractor: License # N/A
 Name

Wellsite Geologist N/A
 Phone

Designate Type of Completion
 New Well Re-Entry Workover
 Oil SWD Temp Abd
 Gas Inj Delayed Comp.
 Dry Other (Core, Water Supply etc.)

If OWWO: old well info as follows:
 Operator
 Well Name
 Comp. Date Old Total Depth.....

WELL HISTORY

Drilling Method:
 Mud Rotary Air Rotary Cable
 ..10/8/56.. ..10/22/56... ..11/6/56.....
 Spud Date Date Reached TD Completion Date
 ...4251..... ...4249.....
 Total Depth PBDT

Amount of Surface Pipe Set and Cemented at ²³⁶ feet
 Multiple Stage Cementing Collar Used? Yes No
 If yes, show depth set...4220...feet
 If alternate 2 completion, cement circulated
 from.....feet depth to.....w/.....SX cmt

API NO. 15-..... N/A 56-NA
 County..... Kingman
 ..SW.. SE.. NW.. Sec. 20.. Twp. 30.. Rge. 7... East West

..2970.... Ft North from Southeast Corner of Section
 ...990.... Ft West from Southeast Corner of Section
 (Note: Locate well in section plat below)

Lease Name... Schuman..... Well #... 3...
 Field Name... Spivey Grabs.....
 Producing Formation... Mississippi.....
 Elevation: Ground... 1538..... KB... 1543.....

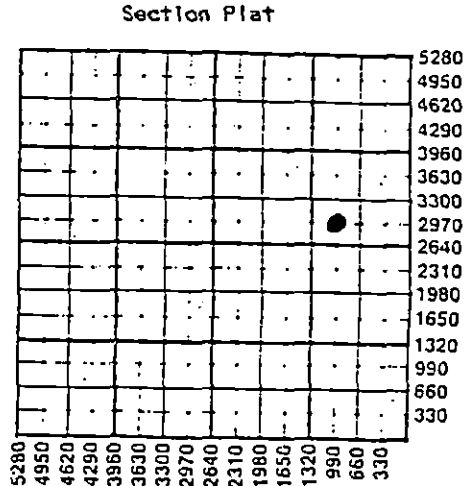

WATER SUPPLY INFORMATION
 Disposition of Produced Water: Disposal Repressuring
 Docket #

Questions on this portion of the ACO-1 call:
 Water Resources Board (913) 296-3717
 Source of Water:
 Division of Water Resources Permit #.....
 Groundwater.....Ft North from Southeast Corner
 (Well)Ft West from Southeast Corner of
 Sec Twp Rge East West
 Surface Water.....Ft North from Southeast Corner
 (Stream, pond etc).....Ft West from Southeast Corner
 Sec Twp Rge East West
 Other (explain).....
 (purchased from city, R.W.D. #)

INSTRUCTIONS: This form shall be completed in duplicate and filed with the Kansas Corporation Commission, 200 Colorado Derby Building, Wichita, Kansas 67202, within 90 days after completion or recompletion of any well. Rule 82-3-130 and 82-3-107 apply.
 Information on slide two of this form will be held confidential for a period of 12 months if requested in writing and submitted with the form. See rule 82-3-107 for confidentiality in excess of 12 months.
 One copy of all wireline logs and drillers time log shall be attached with this form. Submit CP-4 form with all plugged wells. Submit CP-111 form with all temporarily abandoned wells.

All requirements of the statutes, rules and regulations promulgated to regulate the oil and gas industry have been fully complied with and the statements herein are complete and correct to the best of my knowledge.

Signature *J. L. Ford*
 Title Regulatory Analyst Date 10/7/85
 Subscribed and sworn to before me this 7 day of October 1985
 Notary Public *W. A. Quinn*
 Date Commission Expires 10-08-87

K.C.C. OFFICE USE ONLY

F Letter of Confidentiality Attached
 C Wireline Log Received
 C Drillers Timelog Received

Distribution

KCC SWD/Rep NGPA
 KGS Plug Other
 (Specify)

RECEIVED

STATE CORPORATION COMMISSION
 Form ACO-1 (7-84)

Sec. 20 Twp. 30 Rge. 7 W

OCT 28 1985
 10-28-86

SIDE TWO

Operator Name Champlin Petroleum Company Lease Name Schuman Well # 3

Sec. 20 Twp. 30S Rge. 7 East West County Kingman

WELL LOG

INSTRUCTIONS: Show important tops and base of formations penetrated. Detail all cores. Report all drill stem tests giving interval tested, time tool open and closed, flowing and shut-in pressures, whether shut-in pressure reached static level, hydrostatic pressures, bottom hole temperature, fluid recovery, and flow rates if gas to surface during test. Attach extra sheet if more space is needed. Attach copy of log.

Drill Stem Tests Taken	<input type="checkbox"/> Yes	<input type="checkbox"/> No	Formation Description <input checked="" type="checkbox"/> Log <input type="checkbox"/> Sample
Samples Sent to Geological Survey	<input checked="" type="checkbox"/> Yes	<input type="checkbox"/> No	
Cores Taken	<input type="checkbox"/> Yes	<input type="checkbox"/> No	

Name	Top	Bottom
Heebner	3172	
Toronto	3206	
Douglas	3219	
Lansing	3398	
Checkerboard	3964	
Marmaton	3989	
Cherokee	4138	
Mississippian	4217	
T. D.	4251	

CASING RECORD <input checked="" type="checkbox"/> New <input type="checkbox"/> Used							
Report all strings set-conductor, surface, intermediate, production, etc.							
Purpose of String	Size Hole Drilled	Size Casing Set (in O.D.)	Weight Lbs/Ft.	Setting Depth	Type of Cement	#Sacks Used	Type and Percent Additives
Surface	13-3/4"	10-3/4"	32.75	236	Regular	250	2% CaCl ₂
Production	7-7/8"	5-1/2"	15.5	4251		135	3% Gel

PERFORATION RECORD		Acid, Fracture, Shot, Cement Squeeze Record (Amount and Kind of Material Used)	
Shots Per Foot	Specify Footage of Each Interval Perforated		Depth
4	4226-4236	7500# Sd., 8200 Gal. Frac. Oil, 169 Bbls. Flush Oil	

TUBING RECORD	Size 2-3/8	Set At 4247	Packer at	Liner Run <input type="checkbox"/> Yes <input type="checkbox"/> No
---------------	------------	-------------	-----------	--

Date of First Production	Producing Method <input checked="" type="checkbox"/> Flowing <input type="checkbox"/> Pumping <input type="checkbox"/> Gas Lift <input type="checkbox"/> Other (explain).....
--------------------------	---

Estimated Production Per 24 Hours	Oil	Gas	Water	Gas-Oil Ratio	Gravity
	77 Bbls	43 MCF	0 Bbls	409/1	CFPB

METHOD OF COMPLETION Production Interval 4226-4236

Disposition of gas: Vented Open Hole Perforation Sold Other (Specify) Used on Lease

Dually Completed Coningled

RECEIVED

STATE CORPORATION COMMISSION

OCT 28 1955