

is to inform you that we have completed our portion of the ACO-1 Form. Please complete the form and mail it to the Kansas Corporation Commission, as required.

KANSAS
OIL & GAS CONSERVATION DIVISION
WELL COMPLETION OR RECOMPLETION FORM
ACO-1 WELL HISTORY
DESCRIPTION OF WELL AND LEASE

SIDE ONE **PRELIMINARY / IN COMPLETION** FEB 5 1987

Operator: License # 5188
Name Silver Creek Oil & Gas, Inc.
Address 1900 N. Amidon, Suite 221
City/State/Zip Wichita, KS 67203

Purchaser none at this time 8/15/87

Operator Contact Person Greg B. Porterfield
Phone 316-832-0603

Contractor: License # 5107
Name H-30, Inc.

Wellsite Geologist H.C. HOPKINS
Phone

Designate Type of Completion
 New Well Re-Entry Workover
 Oil SWD Temp Abd
 Gas Inj Delayed Comp.
 Dry Other (Core, Water Supply etc.)

If CWNO: old well info as follows:
Operator
Well Name
Comp. Date Old Total Depth

WELL HISTORY

Drilling Method:
 Mud Rotary Air Rotary Cable

1-19-87 1-27-87
Spud Date Date Reached TD Completion Date
4740' 4671'
Total Depth PBD

Amount of Surface Pipe Set and Cemented at 300 feet
Multiple Stage Cementing Collar Used? Yes No
If yes, show depth set feet
If alternate 2 completion, cement circulated from feet depth to w/SX cmt
Cement Company Name
Invoice #

API NO. 15-151-21,824-00-00
County Pratt
C... SE... NW... Sec 30... Twp 28S... Rge 14... East West
3300 Ft North from Southeast Corner of Section
3300 Ft West from Southeast Corner of Section
(Note: Locate well in section plat below)

Lease Name Vaughn Well # 4A
Field Name COLLISON
Producing Formation MISSISSIPPI
Elevation: Ground 2043' 2052' KB

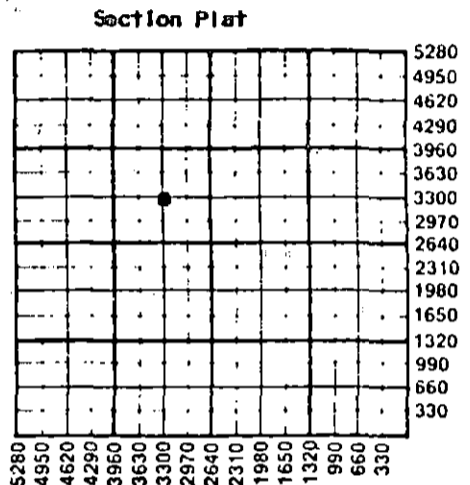

WATER SUPPLY INFORMATION

Disposition of Produced Water: Disposal Repressuring
Docket #

Questions on this portion of the ACO-1 call:
Water Resources Board (913) 296-3717

Source of Water:
Division of Water Resources Permit #
Groundwater... Ft North from Southeast Corner (Well) ... Ft West from Southeast Corner of Sec Twp Rge East West
Surface Water... Ft North from Southeast Corner (Stream, pond etc) ... Ft West from Southeast Corner Sec Twp Rge East West
Other (explain) (purchased from city, R.W.D. #)

INSTRUCTIONS: This form shall be completed in triplicate and filed with the Kansas Corporation Commission, 200 Colorado Derby Building, Wichita, Kansas 67202, within 120 days of the spud date of any well. Rule 82-3-130, 82-3-107 and 82-3-106 apply.
Information on side two of this form will be held confidential for a period of 12 months if requested in writing and submitted with the form. See rule 82-3-107 for confidentiality in excess of 12 months.
One copy of all wireline logs and drillers time log shall be attached with this form. Submit CP-4 form with all plugged wells. Submit CP-111 form with all temporarily abandoned wells.

All requirements of the statutes, rules and regulations promulgated to regulate the oil and gas industry have been fully complied with and the statements herein are complete and correct to the best of my knowledge.

Signature Jackie Brown
Title Secretary Date 8/15/87

Subscribed and sworn to before me this 15th day of September 1987
Notary Public Jackie Brown
Date Commission Expires 12/11/90

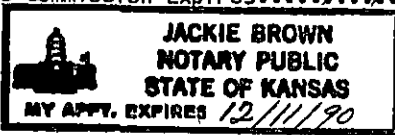

K.C.C. OFFICE USE ONLY

F Letter of Confidentiality Attached
C Wireline Log Received
C Drillers Time Log Received
STATE CORPORATION COMMISSION
KCC SWD/Rep NGPA
KGS SEP 22 1987 Other (Specify)
CONSERVATION DIVISION
Wichita, Kansas

RECEIVED
STATE CORPORATION COMMISSION
SEP 4 1987
9-4-87
CONSERVATION DIVISION
Wichita, Kansas

Sec. 30 W.P. 2 Page 14

SIDE TWO

Operator Name Silver Creek Oil & Gas, Inc. Lease Name Vaughn Well # 4-A

Sec. 30 Twp. 28S Rge. 1A East West County Pratt

WELL LOG

INSTRUCTIONS: Show important tops and base of formations penetrated. Detail all cores. Report all drill stem tests giving interval tested, time tool open and closed, flowing and shut-in pressures, whether shut-in pressure reached static level, hydrostatic pressures, bottom hole temperature, fluid recovery, and flow rates if gas to surface during test. Attach extra sheet if more space is needed. Attach copy of log.

Drill Stem Tests Taken Yes No
 Samples Sent to Geological Survey Yes No
 Cores Taken Yes No

Formation Description
 Log Sample

Chevokee SD 4524'
 Mississippi Chert 4546'
 VIOLA 4614'
 Simpson Shale 4687
 TD 4747

Name	Top	Bottom
Shale and Sand	0	110'
Sand	110'	259'
Red Bed	259'	302'
Shale and Sand	302'	915'
Anhydrite	915'	940'
Shale	940'	1,485'
Shale and Lime	1,485'	1,739'
Shale	1,739'	2,200'
Shale and Lime	2,200'	3,815'
Lime and Shale	3,815'	4,250'
Lime	4,250'	4,531'
Shale and Lime	4,531'	4,721'
Lime	4,721'	4,740'
Rotary Total Depth		4,740'

Core of VIOLA
 4628 to 4647
 4647 to 4676

Surface Production

CASING RECORD <input checked="" type="checkbox"/> New <input checked="" type="checkbox"/> Used							
Report all strings set-conductor, surface, intermediate, production, etc.							
Purpose of String	Size Hole Drilled	Size Casing Set (In O.D.)	Weight Lbs/Ft.	Setting Depth	Type of Cement	#Sacks Used	Type and Percent Additives
Surface	12-1/4"	8-5/8"	20#	300'	60/40 Pozmix	200	3% cc 2% ge
Production	7-7/8"	4-1/2"	10.5#	4698'	Surefill	150	

PERFORATION RECORD		Acid, Fracture, Shot, Cement Squeeze Record	
Shots Per Foot	Specify Footage of Each Interval Perforated	(Amount and Kind of Material Used)	Depth
2	4562.5 to 4572.5	500 gal 15% MCA FRAC 27,000 20/40 SAND 67.2 BB) C1052 1mk gel	

TUBING RECORD	Size	Set At	Packer at	Liner Run	<input type="checkbox"/> Yes <input type="checkbox"/> No

Date of First Production	Producing Method
In completion	<input type="checkbox"/> Flowing <input checked="" type="checkbox"/> Pumping <input type="checkbox"/> Gas Lift <input type="checkbox"/> Other (explain).....

Estimated Production Per 24 Hours	Oil	Gas	Water	Gas-Oil Ratio	Gravity
	Bbls	MCF			

METHOD OF COMPLETION SEP 22 1987 Production Interval

Disposition of gas: Vented Open Hole Perforation Sold Other (Specify)..... CONSERVATION DIVISION
 Used on Lease

Dually Completed Commingled RECEIVED STATE CORPORATION COMMISSION

SEP 4 1987