

FOR KCC USE:

FORM C-1 7/91

FORM MUST BE TYPED

FORM MUST BE SIGNED

ALL BLANKS MUST BE FILLED

EFFECTIVE DATE: 9-23-91

State of Kansas

DISTRICT # 2

NOTICE OF INTENTION TO DRILL

SEAL?  Yes  No

Must be approved by the K.C.C. five (5) days prior to commencing well

Expected Spud Date September 15, 1991 month day year

Spot 56 N 1/4 SW 1/4 SE Sec 3 Twp 25 S Rg 9 East West

OPERATOR: License # 30080 Name: HONEY OIL CO., INC. Address: 401 East Douglas - Suite 505 City/State/Zip: Wichita, Kansas 67202 Contact Person: L. V. Bell Phone: 316/265-7300

380 feet from South / North line of Section 990 feet from East / West line of Section

IS SECTION X REGULAR IRREGULAR? (NOTE: Locate well on the Section Plat on Reverse Side)

CONTRACTOR: License #: 5929 Name: DUKE DRILLING CO., INC.

County: Reno Lease Name: Bontrager, Well #: 1 Field Name: Unknown

Is this a Prorated/Spaced Field? yes X no Target Formation(s): Viola

Well Drilled For: Well Class: Type Equipment: X Oil Enh Rec X Infield X Mud Rotary Gas Storage Pool Ext Air Rotary OWWO Disposal Wildcat Cable Seismic # of Holes Other

Nearest lease or unit boundary: 660' Ground Surface Elevation: Unknown feet MSL

Water well within one-quarter mile: yes X no Public water supply well within one mile: yes X no

If OWWO: old well information as follows: Operator: Well Name: Comp. Date: Old Total Depth

Depth to bottom of fresh water: 90' Depth to bottom of usable water: 140' Surface Pipe by Alternate: X 1 2

Length of Surface Pipe Planned to be set: 200' Length of Conductor pipe required: N/A

Projected Total Depth: 3900' Formation at Total Depth: Viola

Water Source for Drilling Operations: X well farm pond other

Directional, Deviated or Horizontal wellbore? yes X no If yes, true vertical depth: Bottom Hole Location:

DWR Permit #: Applied For Will Cores Be Taken?: yes X no

If yes, proposed zone:

AFFIDAVIT

The undersigned hereby affirms that the drilling, completion and eventual plugging of this well will comply with K.S.A. 55-101, et. seq.

It is agreed that the following minimum requirements will be met:

- 1. Notify the appropriate district office prior to spudding of well;
2. A copy of the approved notice of intent to drill shall be posted on each drilling rig;
3. The minimum amount of surface pipe as specified below shall be set by circulating cement to the top; in all cases surface pipe shall be set through all unconsolidated materials plus a minimum of 20 feet into the underlying formation;
4. If the well is dry hole, an agreement between the operator and the district office on plug length and placement is necessary prior to plugging;
5. The appropriate district office will be notified before well is either plugged or production casing is cemented in;
6. IF AN ALTERNATE II COMPLETION, PRODUCTION PIPE SHALL BE CEMENTED FROM BELOW ANY USABLE WATER TO SURFACE WITHIN 120 DAYS OF SPUD DATE. IN ALL CASES, NOTIFY DISTRICT OFFICE PRIOR TO ANY CEMENTING.

I hereby certify that the statements made herein are true and to the best of my knowledge and belief.

Date: 9/5/91 Signature of Operator or Agent: Sally S. Byers Title: Agent

FOR KCC USE: API # 15- 155-21,179-0000 Conductor pipe required None feet Minimum surface pipe required 140 feet per Alt. (1) Approved by: MWO 9-18-91 This authorization expires: 3-18-92 (This authorization void if drilling not started within 6 months of effective date.) Spud date: Agent:

RECEIVED STATE COMMISSION 9-6-91 SEP 06 1991

REMEMBER TO:

- File Drill Pit Application (form CDP-1) with Intent to Drill;
- File Completion Form ACO-1 within 120 days of spud date;
- File acreage attribution plat according to field proration orders;
- Notify appropriate district office 48 hours prior to workover or re-entry;
- Submit plugging report (EP-4) after plugging is completed;
- Obtain written approval before disposing or injecting salt water.

Mail to: Conservation Division, 200 Colorado Derby Building, 202 W. First St., Wichita, Kansas 67202-1286.

Handwritten marks: 13, 25, 9W

IN ALL CASES PLOT THE INTENDED WELL ON THE PLAT BELOW

PLAT OF ACREAGE ATTRIBUTABLE TO A WELL IN A PRORATED OR SPACED FIELD

If the intended well is in a prorated or spaced field, please fully complete this side of the form. If the intended well is in a prorated or spaced field complete the plat below showing that the well will be properly located in relationship to other wells producing from the common source of supply. Please show all the wells within 1 mile of the boundaries of the proposed acreage attribution unit for gas wells and within 1/2 mile of the boundaries of the proposed acreage attribution unit for oil wells.

API NO. 15- \_\_\_\_\_  
 OPERATOR \_\_\_\_\_ LOCATION OF WELL: COUNTY \_\_\_\_\_  
 LEASE \_\_\_\_\_ feet from south/north line of section  
 WELL NUMBER \_\_\_\_\_ feet from east/west line of section  
 FIELD \_\_\_\_\_ SECTION \_\_\_\_\_ TWP \_\_\_\_\_ RG \_\_\_\_\_

NUMBER OF ACRES ATTRIBUTABLE TO WELL \_\_\_\_\_ IS SECTION \_\_\_\_\_ REGULAR or \_\_\_\_\_ IRREGULAR  
 QTR/QTR/QTR OF ACREAGE \_\_\_\_\_ IF SECTION IS IRREGULAR, LOCATE WELL FROM NEAREST  
CORNER BOUNDARY.

Section corner used: \_\_\_\_\_ NE \_\_\_\_\_ NW \_\_\_\_\_ SE \_\_\_\_\_ SW

**PLAT**

(Show location of the well and shade attributable acreage for prorated or spaced wells.)  
 (Show footage to the nearest lease or unit boundary line.)

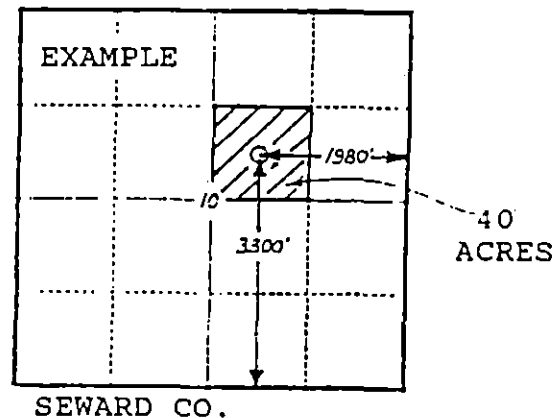
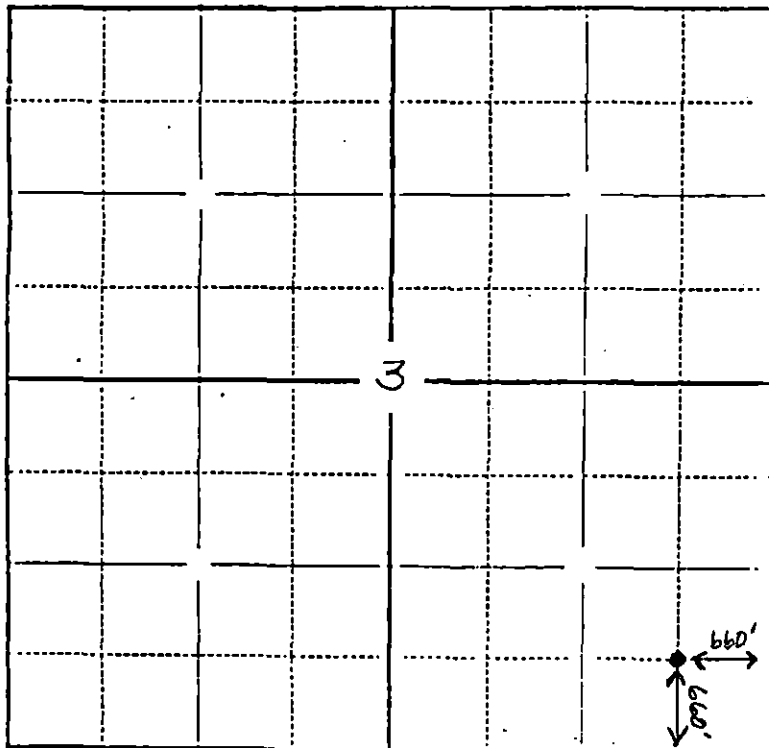

In plotting the proposed location of the well, you must show:

- 1) The manner in which you are using the depicted plat by identifying section lines, i.e. 1 section, 1 section with 8 surrounding sections, 4 sections, etc.;
- 2) the distance of the proposed drilling location from the section's south/north and east/west lines; and
- 3) the distance to the nearest lease or unit boundary line.