

FAX - DUKE DRILLING

FOR KCC USE:

EFFECTIVE DATE: 4-6-94
DISTRICT # 2
SEAT Yes No

FORM C-1 7/9
FORM MUST BE TYPED
FORM MUST BE STAMPED
ALL BLANKS MUST BE FILLED

State of Kansas
NOTICE OF INTENTION TO DRILL

Must be approved by the K.C.C. five (5) days prior to commencing well

Expected Spud Date 03 28 94
month day year

Spec Approx. SW NE Sec 3 Twp 25 S Rg 9 E Est
APPR. NE

OPERATOR: License # 5046
Name: Raymond Oil Company, Inc.
Address: P.O. Box 48788
City/State/Zip: Wichita, KS 67201-8788
Contact Person: William S. Raymond
Phone: (316) 267-4214

1590 FNL feet from Section North line of Section
1880 FNL feet from East line of Section
IS SECTION X REGULAR IRREGULAR?

(NOTE: Locate well on the Section Plat on Reverse Side)
County: Reno

CONTRACTOR: License # 5929
Name: Duke Drilling Company

Lease Name: Benschmidt Well #: 1
Field Name: Langdon NE Ext.

Is this a Prorated/Spec'd Field? yes X no
Target Formation(s): Miss

Well Drilled For: Well Class: Type Equipment:
X.. Oil ... Enh Rec ... Infield X. Mud Rotary
... Gas ... Storage X. Pool Ext. ... Air Rotary
... OWD ... Disposal ... Wildcat ... Cable
... Seismic; ... # of Holes ... Other
... Other

Nearest Lease or unit boundary:
Ground Surface Elevation: est. 1660' feet MSL

Water well within one-quarter mile: yes X no
Public water supply well within one mile: yes X no

If OWD: old well information as follows:
Operator:
Well Name:
Comp. Date: Old Total Depth

Depth to bottom of fresh water: 85
Depth to bottom of usable water: 190 / 110

Surface Pipe by Alternate: X 1 2
Length of Surface Pipe Planned to be set: (220') 140'

Length of Conductor pipe required: None
Projected Total Depth: 4000

Formation at Total Depth: Viola
Water Source for Drilling Operations:
... well ... farm pond X other

Directional, Deviated or Horizontal wellbore? yes X no
If yes, true vertical depth:
Bottom Hole Location:

DNR Permit #:
Will Cores Be Taken?: yes X no
If yes, proposed zone:

AFFIDAVIT

RECEIVED
KANSAS CORPORATION COMMISSION

The undersigned hereby affirms that the drilling, completion and eventual plugging of this well will comply with K.S.A. 55-101, et. seq.
It is agreed that the following minimum requirements will be met:

MAR 16 1994 pm
3-16-94
CONSERVATION DIVISION
WICHITA, KS

- 1. Notify the appropriate district office prior to spudding of well;
- 2. A copy of the approved notice of intent to drill shall be posted on each drilling rig;
- 3. The minimum amount of surface pipe as specified below shall be set by circulating cement in all cases surface pipe shall be set through all unconsolidated materials plus a minimum of 20 feet into the underlying formation;
- 4. If the well is dry hole, an agreement between the operator and the district office on plug length and placement is necessary prior to plugging;
- 5. The appropriate district office will be notified before well is either plugged or production casing is cemented in;
- 6. IF AN ALTERNATE IS COMPLETED, PRODUCTION PIPE SHALL BE CEMENTED FROM BELOW ANY USABLE WATER TO SURFACE WITHIN 120 DAYS OF SPUD DATE. IN ALL CASES, NOTIFY DISTRICT OFFICE PRIOR TO ANY CEMENTING.

I hereby certify that the statements made herein are true and to the best of my knowledge and belief.
Date: 03-16-94 Signature of Operator or Agent: [Signature] Title: Vice President

FOR KCC USE:
API # 15- 155-21315-0000
Conductor pipe required NONE feet
Minimum surface pipe required 140' feet per Alt. ① X
Approved by: [Signature] 4-1-94
This authorization expires: 10-1-94
(This authorization void if drilling not started within 6 months of effective date.)
Spud date: Agent:

REMEMBER TO:

- File Drill Pit Application (form CSP-1) with intent to drill;
- File Completion Form ACC-1 within 120 days of spud date;
- File acreage attribution plat according to field production orders;
- Notify appropriate district office 48 hours prior to workover or re-entry;
- Submit plugging report (CP-4) after plugging is completed;
- Obtain written approval before disposing or injecting salt water.

Mail to: Conservation Division, 200 Colorado Derby Building, 202 W. First St., Wichita; Kansas 67202-1286.

3
25
9

IN ALL CASES PLOT THE INTENDED WELL ON THE PLAT BELOW

PLAT OF ACREAGE ATTRIBUTABLE TO A WELL IN A PRORATED OR SPACED FIELD

If the intended well is in a prorated or spaced field, please fully complete this side of the form. If the intended well is in a prorated or spaced field complete the plat below showing that the well will be properly located in relationship to other wells producing from the common source of supply. Please show all the wells within 1 mile of the boundaries of the proposed acreage attribution unit for gas wells and within 1/2 mile of the boundaries of the proposed acreage attribution unit for oil wells.

API NO. 15- _____
 OPERATOR Raymond Oil Company, Inc.
 LEASE Benscheidt
 WELL NUMBER 1
 FIELD Langdon NE Ext

LOCATION OF WELL: COUNTY Reno
1590' feet from ~~south~~ north line of section
1880' feet from east ~~west~~ line of section
 SECTION 3 TWP 25S RG 9W

NUMBER OF ACRES ATTRIBUTABLE TO WELL 40
 QTR/QTR/QTR OF ACREAGE C - SW - NE

IS SECTION X REGULAR or IRREGULAR
 IF SECTION IS IRREGULAR, LOCATE WELL FROM NEAREST CORNER BOUNDARY.

Section corner used: X NE NW SE SW
 PLAT

(Show location of the well and shade attributable acreage for prorated or spaced wells.)
 (Show footage to the nearest lease or unit boundary line.)

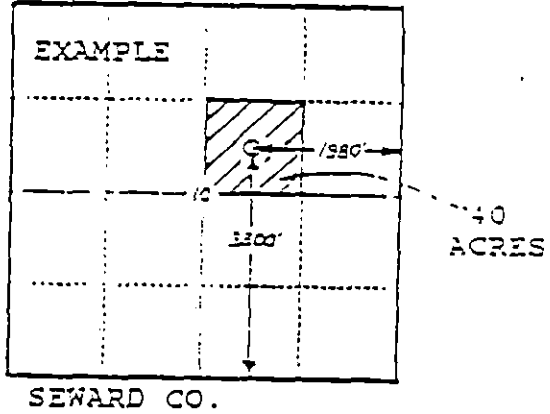
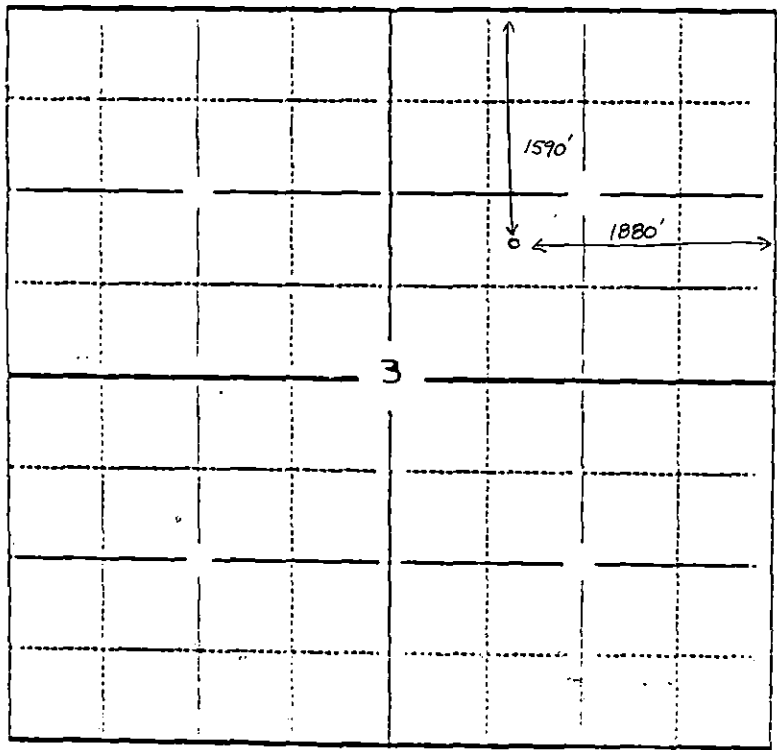

In plotting the proposed location of the well, you must show:

- 1) The manner in which you are using the depicted plat by identifying section lines, i.e. 1 section, 1 section with 8 surrounding sections, 4 sections, etc.;
- 2) the distance of the proposed drilling location from the section's south/north and east/west lines; and
- 3) the distance to the nearest lease or unit boundary line.