

Give All Information Completely
Make Required Affidavit
Mail or Deliver Report to:
Conservation Division
State Corporation Commission
212 No. Market
Wichita, Kansas

WELL PLUGGING RECORD

Kiowa County, Sec. 19 Twp. 29S Rge. (E) 19 (W)

Location as "NE/CNWSW24" or footage from lines 660' FS&EL

Lease Owner Anadarko Production Company, Diamond Shamrock

Lease Name Rice "B" Well No. #1

Office Address Box 351, Liberal, Kansas 67901

Character of Well (completed as Oil, Gas or Dry Hole) Dry Hole

Date well completed 12-23-74 19 74

Application for plugging filed Verbal approval 12-22 19 74

Application for plugging approved 12-22 19 74

Plugging commenced 12-22 19 74

Plugging completed 12-23 19 74

Reason for abandonment of well or producing formation Dry Hole

If a producing well is abandoned, date of last production 19

Was permission obtained from the Conservation Division or its agents before plugging was commenced? Yes

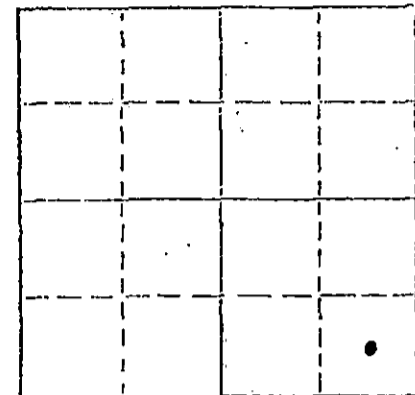

Locate well correctly on above Section Plat

Name of Conservation Agent who supervised plugging of this well G. Russell Biberstein

Producing formation Depth to top Bottom Total Depth of Well 5195 Feet

Show depth and thickness of all water, oil and gas formations.

OIL, GAS OR WATER RECORDS

CASING RECORD

FORMATION	CONTENT	FROM	TO	SIZE	PUT IN	PULLED OUT
				9-5/8"	290'	

Describe in detail the manner in which the well was plugged, indicating where the mud fluid was placed and the method or methods used in introducing it into the hole. If cement or other plugs were used, state the character of same and depth placed, from feet to feet for each plug set.

Spotted 50 sacks cmt @ 240', spotted 10 sacks cmt 40'-0', 3 sacks in rathole.

RECEIVED
STATE CORPORATION COMMISSION

JAN 6 1975

CONSERVATION DIVISION
Wichita, Kansas

1-6-1975

(If additional description is necessary, use BACK of this sheet)
Name of Plugging Contractor Gabbert-Jones, Inc.
Address 830 Sutton Place, Wichita, Kansas 67901

STATE OF Kansas, COUNTY OF Seward, ss.
T. W. Williams (employee of owner) or (owner or operator) of the above-described well, being first duly sworn on oath, says: That I have knowledge of the facts, statements, and matters herein contained and the log of the above-described well as filed and that the same are true and correct. So help me God.

(Signature) T. W. Williams
Box 351, Liberal, Kansas 67901
(Address)

SUBSCRIBED AND SWORN TO before me this 2nd day of January, 1975

NORMA L. ATKINSON
STATE NOTARY PUBLIC
Seward County, Kansas
MY COMMISSION EXPIRES
September 3, 1977

Norma L. Atkinson
Notary Public.

My commission expires

KANSAS DRILLERS LOG

S. 19 T. 29 R. 19 ^K W

API No. 15 — 097 — 20,271
County Number

Loc. SE SE

County Kiowa

Operator
Anadarko Production Co., Diamond Shamrock Corp.

Address
Box 351, Liberal, Kansas 67901

Well No. #1 Lease Name Rice "B"

Footage Location
660 feet from ~~(N)~~ (S) line 660 feet from (E) ~~(W)~~ line

Principal Contractor Gabbert-Jones, Inc. Geologist Edward B. Donnelly

Spud Date 12-9-74 Total Depth 5195 P.B.T.D.

Date Completed 12-23-74 Oil Purchaser

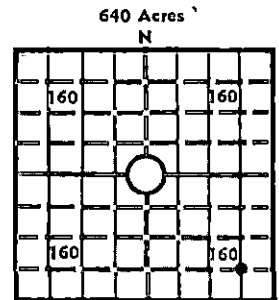

Elev.: Gr. 2373

DF _____ KB _____

CASING RECORD

Report of all strings set — surface, intermediate, production, etc.

Purpose of string	Size hole drilled	Size casing set (in O.D.)	Weight lbs/ft.	Setting depth	Type cement	Sacks	Type and percent additives
Surface	13-3/4"	9-5/8"	30#	290'	Common	300	3% CC

LINER RECORD

PERFORATION RECORD

Top, ft.	Bottom, ft.	Sacks cement	Shots per ft.	Size & type	Depth interval

TUBING RECORD

Size	Setting depth	Packer set at

ACID, FRACTURE, SHOT, CEMENT SQUEEZE RECORD

Amount and kind of material used	Depth interval treated

RECEIVED
 STATE CORPORATION COMMISSION

JAN 6 1975

INITIAL PRODUCTION DIVISION
 CONSERVATION

Date of first production _____ Producing method (flowing, pumping, gas lift, etc.) _____

RATE OF PRODUCTION PER 24 HOURS
 Oil _____ bbls. Gas _____ MCF Water _____ bbls. Gas-oil ratio _____ CFPB

Disposition of gas (vented, used on lease or sold) _____ Producing interval (s) _____

INSTRUCTIONS: As provided in KCC Rule 82-2-125, within 90 days after completion of a well, one completed copy of this Drillers Log shall be transmitted to the State Geological Survey of Kansas, 4150 Monroe Street, Wichita, Kansas 67209. Copies of this form are available from the Conservation Division, State Corporation Commission, 3830 So. Meridian (P.O. Box 17027), Wichita, Kansas 66217. Phone AC 316-522-2206. If confidential custody is desired, please note Rule 82-2-125. Drillers Logs will be on an open file in the Oil and Gas Division, State Geological Survey of Kansas, Lawrence, Kansas 66044.

Operator Anadarko Production Company DESIGNATE TYPE OF COMP.: OIL, GAS, DRY HOLE, SWDW, ETC.: Dry Hole

Well No. #1 Lease Name Rice "B"

s 19 T 29 R 19 X W

WELL LOG

Show all important zones of porosity and contents thereof; corod intervals, and all drill-stem tests, including depth interval tested, cushion used, time tool open, flowing and shut-in pressures, and recoveries.

SHOW GEOLOGICAL MARKERS, LOGS RUN, OR OTHER DESCRIPTIVE INFORMATION.

FORMATION DESCRIPTION, CONTENTS, ETC.	TOP	BOTTOM	NAME	DEPTH
Surface-Shale	0	160	Chase	2706
Sand	160	205	Council Grove	3089
Shale-Redbed	205	226	Cottonwood	3228
Redbed	226	300	Wabaunsee	3654
Redbed-Shale-Sand	300	542	Topeka	3855
Sand-Redbed	542	754	Heebner	4317
Redbed	754	1313	Lansing	4505
Redbed-Shale	1313	1878	B/KC	4918
Redbed-Shale-Lime	1878	2301	Cherokee	5049
Shale-Lime	2301	2535	Miss	5129
Lime	2535	3091		
Lime-Shale	3091	3732		
Lime	3732	4151		
Lime-Shale	4151	4293		
Lime	4293	4461		
Shale	4461	4489		
Lime	4489	5023		
Lime-Shale	5023	5145		
Lime	5145	5195		
Total Depth		5195		

DST - 5090'-5145', open 30 min, SI 45 min, open 60 min, SI 75 min, fair blow thruout, REC 480' fluid (100' mud, 380' muddy SW), FP 100-220#, 230-279#, ISIP 939#, FSIP 739#, temp 120°. Formation water REC (RW#04 @ 126°.)

USE ADDITIONAL SHEETS, IF NECESSARY, TO COMPLETE WELL RECORD.

Date Received

T. W. Williams
 Signature
 T. W. Williams
 Division Office Supervisor
 Title
 January 2, 1975
 Date