

STATE OF KANSAS
STATE CORPORATION COMMISSION

WELL PLUGGING RECORD

Give All Information Completely
Make Required Affidavit
Mail or Deliver Report to
Conservation Division
State Corporation Comm.
245 North Water
Wichita, KS 67202

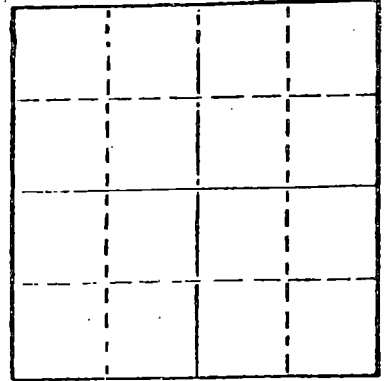

Locate well correctly on above
Section Plat

KIOWA County. Sec. 8 Twp. 29S Rge. 20 E/W
Location as "NE/CNW 1/4 SW 1/4" or footage from lines
660' FNL & 660' FWL

Lease Owner Texas Oil & Gas Corp.
Lease Name Hammer Well No. 1
Office Address 200 W. Douglas, Suite 300, Wichita KS 67202
Character of Well (Completed as Oil, Gas or Dry Hole) Dry Hole

Date Well completed 8-16-77 19
Application for plugging filed 8-16-77 19
Application for plugging approved 8-16-77 19
Plugging commenced 8-16-77 19
Plugging completed 8-16-77 19
Reason for abandonment of well or producing formation _____

If a producing well is abandoned, date of last production _____ 19

Was permission obtained from the Conservation Division or its agents before plugging was commenced? Yes

Name of Conservation Agent who supervised plugging of this well Bill Owens
Producing formation _____ Depth to top _____ Bottom _____ Total Depth of Well 5220'
Show depth and thickness of all water, oil and gas formations.

OIL, GAS OR WATER RECORDS

CASING RECORD

FORMATION	CONTENT	FROM	TO	SIZE	PUT IN	PULLED OUT
		0	535'	8 5/8"		

Describe in detail the manner in which the well was plugged, indicating where the mud fluid was placed and the method or methods used in introducing it into the hold. If cement or other plugs were used, state the character of same and depth placed, from _____ feet to _____ feet for each plug set.

40 sacks @ 530', mud to 40' 1/2 sack hulls, plugged,
12 sacks to surface, 5 sacks in rathole. Job by Howco.

RECEIVED
STATE CORPORATION COMMISSION

AUG 24 1977

CONSERVATION DIVISION
Wichita, Kansas

(If additional description is necessary, use BACK of this sheet)

Name of Plugging Contractor Xplor Drilling Co.

STATE OF KANSAS COUNTY OF SEDGWICK, ss.
Wayne L. Kirkman (~~employee of owner~~) or (owner or operator)
of the above-described well, being first duly sworn on oath, says: That I have knowledge of the facts, statements, and matters herein contained and the log of the above-described well as filed and that the same are true and correct. So help me God.

(Signature) Wayne L. Kirkman
180 S. Rock Road, Suite 300, Wichita KS 67207
(Address)

SUBSCRIBED AND SWORN TO before me this 22 day of August, 1977

Virginia Lee Smith
Virginia Lee Smith, Notary Public.

My commission expires August 25, 1980

15-097-20411-0000

KANSAS DRILLERS LOG

S. 8 T. 29S R. 20 ^E_(W)
 Loc. 660' FNL & 660' FWL
 County Kiowa

API No. 15 — 097 — 20,411
 County Number

Operator
Texas Oil & Gas Corp.

Address
200 West Douglas, Suite 300, Wichita, KS 67202

Well No. 1 Lease Name Hammer

Footage Location
660 feet from (N) (S) line 660 feet from (E) (W) line

Principal Contractor Xplor Drilling Co. Geologist High Plains Consulting Ltd

Spud Date 8-05-77 Total Depth 5220' P.B.T.D. N/A

Date Completed 8-16-77 Oil Purchaser N/A

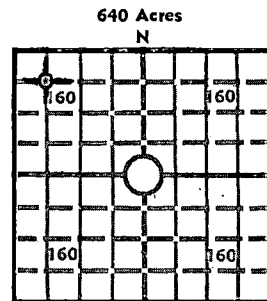

Locate well correctly
 Elev.: Gr. 2386'
 DF. 2391' KB 2394'

CASING RECORD

Report of all strings set—surface, intermediate, production, etc.

Purpose of string	Size hole drilled	Size casing set (in O.D.)	Weight lbs/ft.	Setting depth	Type cement	Sacks	Type and percent additives
Surface	12-1/4"	8-5/8"	24#	535'	Common	550	2% Gel, 3% CaCl

LINER RECORD

PERFORATION RECORD

Top, ft.	Bottom, ft.	Sacks cement	Shots per ft.	Size & type	Depth interval
N/A	N/A	N/A			
TUBING RECORD			N/A	N/A	N/A
Size	Setting depth	Packer set at			
N/A	N/A	N/A			

ACID, FRACTURE, SHOT, CEMENT SQUEEZE RECORD

Amount and kind of material used	Depth interval treated
N/A	N/A

RECEIVED
 STATE CORPORATION COMMISSION
 AUG 19 1977
 CONSERVATION DIVISION
 Wichita, Kansas

INITIAL PRODUCTION

Date of first production N/A	Producing method (flowing, pumping, gas lift, etc.) N/A
RATE OF PRODUCTION PER 24 HOURS	Oil N/A bbls. Gas N/A MCF Water N/A bbls. Gas-oil ratio N/A CFPB
Disposition of gas (vented, used on lease or sold) N/A	Producing interval (s) N/A

INSTRUCTIONS: As provided in KCC Rule 82-2-125, within 90 days after completion of a well, one completed copy of this Drillers Log shall be transmitted to the State Geological Survey of Kansas, 4150 Monroe Street, Wichita, Kansas 67209. Copies of this form are available from the Conservation Division, State Corporation Commission, 3830 So. Meridian (P.O. Box 17027), Wichita, Kansas 66217. Phone AC 316-522-2206. If confidential custody is desired, please note Rule 82-2-125. Drillers Logs will be on open file in the Oil and Gas Division, State Geological Survey of Kansas, Lawrence, Kansas 66044.

Operator
Texas Oil & Gas Corp.

DESIGNATE TYPE OF COMP.: OIL, GAS,
DRY HOLE, SWDW, ETC.:

Well No. 1 Lease Name Hammer Dry Hole

S 8 T 29S R 20 E W

WELL LOG

Show all important zones of porosity and contents thereof; cored intervals, and all drill-stem tests, including depth interval tested, cushion used, time tool open, flowing and shut-in pressures, and recoveries.

SHOW GEOLOGICAL MARKERS, LOGS RUN,
OR OTHER DESCRIPTIVE INFORMATION.

FORMATION DESCRIPTION, CONTENTS, ETC.	TOP	BOTTOM	NAME	DEPTH
Herrington	2656	-262		
Krider	2686	-292		
Winfield	2724	-330		
Towanda	2784	-390		
Ft. Riley	2841	-447		
Wreford	2991	-597		
Crouse	3101	-707		
Cottonwood	3155	-761		
Neva	3212	-818		
Foraker	3354	-960		
Stotler	3596	-1202		
Tarkio	3654	-1260		
Burlingame	3748	-1354		
Howard	3808	-1414		
Topeka	3844	-1450		
Heebner	4256	-1862		
Douglas	4300	-1906		
Iatan	4428	-2034		
Lansing	4438	-2044		
Stark	4730	-2336		
Swope	4738	-2344		
Hertha	4778	-2384		
B/Kansas City	4848	-2454		
Pawnee	4936	-2542		
Ft. Scott	4969	-2575		
Cherokee	4984	-2590		
Mississippi	5070	-2676		
TD	5220	-2826		

DST #1, 5074-98', (Mississippi) w/results as follows: Misrun.
 DST #2, 5096-5118', (Mississippi) w/results as follows: IFP/30": 81-163#, strong blow throughout; ISIP/60": 1168#; FFP/45": 184-235#, strong blow throughout; FSIP/90": 1137#; Rec 30' O&WCM, 60' MW, & 340' wtr.
 DST #3, 5124-46', (Mississippi) w/results as follows: IFP/30": 10-62#, weak to fair blow; ISIP/60": 1525#; FFP/45": 62-114#, weak to fair blow; FSIP/90": 1474#; USE ADDITIONAL SHEETS, IF NECESSARY, TO COMPLETE WELL RECORD. Rec 210' MW.

Date Received

Harold A. Brown
 HAROLD A. BROWN Signature
 District Geologist

August 17, 1977