

STATE CORPORATION COMMISSION OF KANSAS  
OIL & GAS CONSERVATION DIVISION  
WELL COMPLETION OR RECOMPLETION FORM  
ACO-1 WELL HISTORY  
DESCRIPTION OF WELL AND LEASE

5

API NO. 15-151-21-875-00-00  
County Pratt  
S 1/2 N 1/2 SE Sec. 30 Twp. 29S Rge. 13 East  
X West

Operator: License # 09408  
Name Trans. Pacific Oil Corporation  
Address 410 QOA Main Place  
City/State/Zip Wichita, KS 67202

1650 Ft North from Southeast Corner of Section  
1320 Ft West from Southeast Corner of Section  
(Note: Locate well in section plat below)

Purchaser

Lease Name Lambert Well # 1

Operator Contact Person Alan D. Banta  
Phone (316) 262-3596

Field Name

Producing Formation

Elevation: Ground 1926 KB 1934

Contractor: License # 05841  
Name Trans Pac Drilling, Inc.

Wellsite Geologist Chuck Schmalz  
Phone

Designate Type of Completion  
New Well Re-Entry Workover  
Oil SWD Temp Abd  
Gas Inj Delayed Comp.  
X Dry Other (Core, Water Supply etc.)

If ONWO: old well info as follows:  
Operator  
Well Name  
Comp. Date Old Total Depth

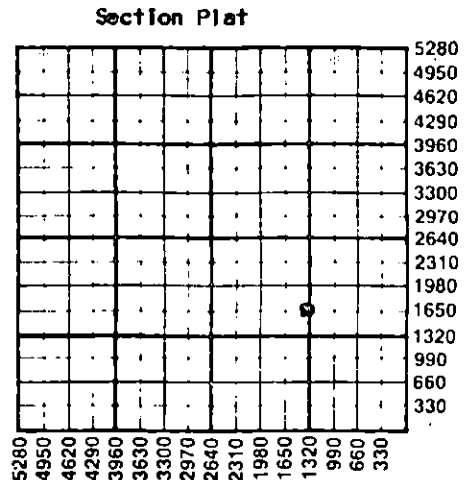

WELL HISTORY  
Drilling Method: Mud Rotary Air Rotary Cable  
01/22/88 02/02/88 02/02/88  
Spud Date Date Reached TD Completion Date  
4800  
Total Depth PBD

Amount of Surface Pipe Set and Cemented at 255 feet  
Multiple Stage Cementing Collar Used? Yes X No  
If yes, show depth set feet  
If alternate 2 completion, cement circulated from feet depth to w/SX cmt  
Cement Company Name  
Invoice #

WATER SUPPLY INFORMATION  
Disposition of Produced Water: Disposal  
Docket # Repressuring

Questions on this portion of the ACO-1 call:  
Water Resources Board (913) 296-3717  
Source of Water:  
Division of Water Resources Permit # T.88-45  
Groundwater 1650 Ft North from Southeast Corner  
(Well) 1320 Ft West from Southeast Corner of  
Sec Twp Rge East West  
Surface Water Ft North from Southeast Corner  
(Stream, pond etc) Ft West from Southeast Corner  
Sec Twp Rge East West  
Other (explain)  
(purchased from city, R.W.D. #)

INSTRUCTIONS: This form shall be completed in triplicate and filed with the Kansas Corporation Commission, 200 Colorado Derby Building, Wichita, Kansas 67202, within 120 days of the spud date of any well. Rule 82-3-130, 82-3-107 and 82-3-106 apply. Information on side two of this form will be held confidential for a period of 12 months if requested in writing and submitted with the form. See rule 82-3-107 for confidentiality in excess of 12 months. One copy of all wireline logs and drillers time log shall be attached with this form. Submit CP-4 form with all plugged wells. Submit CP-111 form with all temporarily abandoned wells.

All requirements of the statutes, rules and regulations promulgated to regulate the oil and gas industry have been fully complied with and the statements herein are complete and correct to the best of my knowledge.

Signature Isao Sugiura  
Title President Date 2/17/88  
Trans Pacific Oil Corporation

Subscribed and sworn to before me this 17th day of February 1988  
Notary Public Sondra J. Follis

Date Commission Expires July 13, 1991

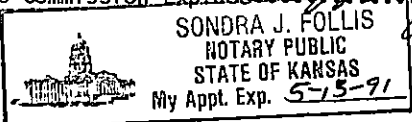

K.C.C. OFFICE USE ONLY  
F Letter of Confidentiality Attached  
C Wireline Log Received  
C Drillers Time Log Received  
Distribution  
KCC SWD/Rep NGPA  
KGS Plug Other (Specify)  
FEB 25 1988  
ACO-1 (5-86)

Sec. 30 Twp. 29Rge. 13W

SIDE TWO

Operator Name .....Trans. Pacific Oil Corporation... Lease Name.....Lambert.....Well #.....1.....

Sec.....30..... Twp.....29S..... Rge.....13W.....  East  West County.....Pratt.....

WELL LOG

INSTRUCTIONS: Show important tops and base of formations penetrated. Detail all cores. Report all drill stem tests giving interval tested, time tool open and closed, flowing and shut-in pressures, whether shut-in pressure reached static level, hydrostatic pressures, bottom hole temperature, fluid recovery, and flow rates if gas to surface during test. Attach extra sheet if more space is needed. Attach copy of log.

Drill Stem Tests Taken  Yes  No  
 Samples Sent to Geological Survey  Yes  No  
 Cores Taken  Yes  No

Formation Description  
 Log  Sample

DST# 1 4405-92/Mis Run  
 DST# 2 4433-92/30-30-30-30 Strong Blow  
 Decr. to med. blo. Rec: 605' GIP, 15' GCM  
 ISIP 243# FSIP 253# IFP 49-39# FFP 39-39-#  
 DST# 3 4548-4628 / 20-20-20-20 Wk Blow, died  
 Rec: 122' M, 62' GCM ISIP 175# FSIP 156#  
 IFP 117-117# FFP 117-117#  
 \*Note: Large mud recovery was due to problems getting packers to seat.  
 DST# 4 4645-90/45-45-45-45  
 Wk blo inc. to med. Rec: 117' M (SPKS 0)  
 62' WM (Oil Spks) (25%W, 75%M) ISIP 693#  
 FSIP 683# IFP 29-68# FFP 88-107#

Name	Top	Bottom
HB	3802	(-1868)
Tor.	3825	(-1891)
Brn Lm.	3982	(-2048)
Lans	3999	(-2065)
Stark Sh	4268	(-2334)
BKC	4384	(-2450)
Miss.	4485	(-2551)
Viola	4550	(-2616)
Simp Sh.	4672	(-2738)
Simp Sd.	4684	(-2750)
ARB	4762	(-2828)
RTD.		

CASING RECORD <input type="checkbox"/> New <input type="checkbox"/> Used							
Report all strings set-conductor, surface, intermediate, production, etc.							
Purpose of String	Size Hole Drilled	Size Casing Set (In O.D.)	Weight Lbs/Ft.	Setting Depth	Type of Cement	#Sacks Used	Type and Percent Additives
surface		10 3/4"		255	60/40	180	
PERFORATION RECORD				Acid, Fracture, Shot, Cement Squeeze Record			
Shots Per Foot	Specify Footage of Each Interval Perforated			(Amount and Kind of Material Used)		Depth	
TUBING RECORD				Size	Set At	Packer at	Liner Run <input type="checkbox"/> Yes <input type="checkbox"/> No
Date of First Production		Producing Method <input type="checkbox"/> Flowing <input type="checkbox"/> Pumping <input type="checkbox"/> Gas Lift <input type="checkbox"/> Other (explain).....					
Estimated Production Per 24 Hours	Oil	Gas	Water	Gas-Oil Ratio	Gravity		
	Bbls	MCF	Bbls	CFPB			

METHOD OF COMPLETION

Production Interval

Disposition of gas:  Vented  Open Hole  Perforation  
 Sold  Other (Specify) .....  
 Used on Lease  Dually Completed .....  
 Commingled .....

Trans Pacific Oil Corporation  
410 One Main Place  
Wichita, Kansas 67202

DRILLERS LOG

# 1 Lambert  
Pratt County  
Kansas

Spud Date: 1/22/88  
Comp. Date: 1/29/88

0-240	Top Soil
240-1250	Shale (Red Beds)
1250-1660	Lime & Shale
1660-2705	Shale & Lime
2705-3265	Lime & Shale
3265-3550	Lime & Shale
3550-4000	Lime & Shale
4000-4245	Lime & Shale
4245-4555	Lime & Shale
4555-4690	Shale & Lime
4690-4800	Lime & Shale
4800	RTD

Surface Pipe: 6 jts 10 3/4 Set @255' W/180 SXS  
60/40 3% CC 2% GEL

This well was plugged as follows:

740' W/50 SX  
Plug @280' W/50 SX  
Top Plug 40' W/10 SXS to Surface

AFFIDAVIT

STATE OF KANSAS  
COUNTY OF SEDGWICK ss

Alan D. Banta of lawful age does swear and state that  
the facts and statements herein are true and correct  
to the best of his knowledge.

Alan D. Banta  
Alan D. Banta

Subscribed and sworn to before me this 17<sup>th</sup> day of Feb. 19 88

My Commission Expires:

May 13, 1991

Sondra J. Follis  
Notary Public  
Sondra J. Follis

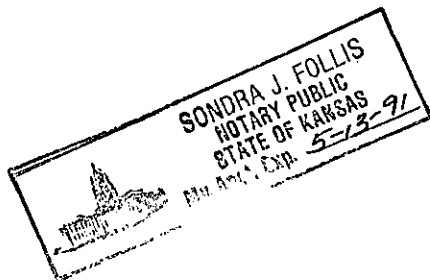

STATE CORPORATION COMMISSION  
FEB 25 1988  
CONSERVATION DIVISION  
Wichita, Kansas