

STATE OF KANSAS
STATE CORPORATION COMMISSION
200 Colorado Derby Bldg.
Wichita, Kansas 67202

15-151-20618 - 00-00
RECEIVED CP-4
STATE CORPORATION COMMISSION 15-80

MAY - 5 1982

CONSERVATION DIVISION
Wichita, Kansas

WELL PLUGGING RECORD

Give All Information Completely
Make Required Affidavit

COUNTY Pratt SEC. 1 TWP. 29S RGE. 12W E/W
Location as in quarters or footage from lines:
2310 FSL 330 FEL

Lease Owner Texas Oil & Gas Corp.
Lease Name McInteer Well No. 1
Office Address Suite 300-200 W. Douglas, Wichita, Kansas 67202
Character of Well (Completed as Oil, Gas or Dry Hole): Gas
Date Well Completed 2-5-79
Application for plugging filed 4-22-82
Plugging commenced 4-24-82
Plugging completed 4-30-82
Reason for abandonment of well or producing formation Not Productive

Locate Well
correctly on above
Section Platt.

Was permission obtained from the Conservation Division or it's
Agent's before plugging was commenced? Yes

Name of Conservation Agent who supervised plugging of this well M. V. Leslie
Producing formation _____ Depth to top _____ bottom _____ T.D. 2775
Show depth and thickness of all water, oil and gas formations.

OIL, GAS OR WATER RECORDS

Casing Record

Formation	Content	From	To	Size	Put in	Pulled Out
				8 5/8"	303	None
				2 7/8"	2771	1775

Describe in detail the manner in which the well was plugged, indicating where the mud fluid was placed and the method or methods used in introducing it into the hold. If cement or other plugs were used, state the character of same and depth placed, from _____ feet to _____ feet for each plug set.

Allied pumped in 10 sacks common cement. Stop plug at 2450.
Allied pumped in 15 sacks gell. 6 sacks hulls, 10 sacks gell.
150 sacks common cement. 3% c.c.

(If additional description is necessary, use BACK of this sheet)

Name of Plugging Contractor Clarke Corporation

STATE OF Kansas COUNTY OF Barber, ss.
Charles K. Margenau (employee of owner) or (owner or operator) of the above-described well, being first duly sworn on oath, says: That I have knowledge of the facts, statements, and matters herein contained and the log of the above-described well as filed and that the same are true and correct. So help me God.

(Signature) Charles K. Margenau
Medicine Lodge, Kansas
(Address)

SUBSCRIBED AND SWORN TO before me this 4th day of May, 1982
Jessie Hamilton
Notary Public.

My Commission expires: April 4, 1986

KANSAS DRILLERS LOG

COMPANY Texas Oil & Gas Corp.

SEC. 1 T. 29S R. 12W

FARM McInteer

NO. 1

LOC. 2310' FSL & 330' FE.

COUNTY Pratt

ROTARY TOTAL DEPTH 2,775'

COMM. January 22, 1979

COMP. January 26, 1979

CONTRACTOR H-30, Inc. (Rig #3)

ISSUED February 1, 1979

CASING

10 3/4"

8 5/8" Set at 303' cemented w/300 sxs cement

ELEVATION 1,846' GR.

5 1/2"

4 1/2"

2 7/8" Set at 2,774' cemented w/200 sxs cement

FIGURES INDICATE BOTTOM OF FORMATIONS

Sand

195'

Red Bed

305'

Shale

1,000'

Shale and Lime

2,775'

Rotary Total Depth

2,775'

RECEIVED
STATE CORPORATION COMMISSION

APR 23 1979

CONSERVATION DIVISION
Wichita, Kansas

I hereby certify the above and foregoing to be a true and correct log of the above described well as shown by the drilling reports.

H-30, Inc.

Dean Britting

State of Kansas

County of Sedgwick

ss:

Subscribed and Sworn to before me a Notary Public in and for said county and state this 1st day of February, 1979.

Elsie Willison - Notary Public

My Commission Expires:

July 25, 1982

RECEIVED
STATE CORPORATION COMMISSION

APR 23 1979

CONSERVATION DIVISION
Wichita, Kansas

IMPORTANT
Kans. Geo. Survey request
samples on this well.

KANSAS DRILLERS LOG

S. 1 T. 29 R. 12 ^N_W
Loc. 2310' FSL & 330' FEL
County Pratt

API No. 15 — 151 — 20,618 - 00-00
County Number

Operator
Texas Oil & Gas Corp.

Address
200 West Douglas, Suite 300 Wichita, Kansas 67202

Well No. #1 Lease Name McInteer

Footage Location
2310 feet from (N) (S) line 330 feet from (E) (W) line

Principal Contractor H-30 Drilling, Rig #3 Geologist N/A

Spud Date 1-22-79 Total Depth 2775' P.B.T.D. N/A

Date Completed 2-5-79 Oil Purchaser N/A

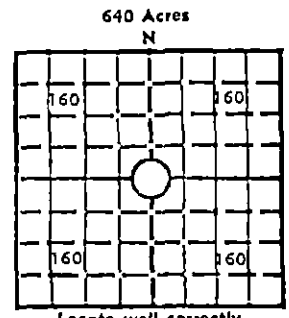

Locate well correctly
Elev.: Gr. 1846'
DF KB 1854'

CASING RECORD

Report of all strings set— surface, intermediate, production, etc.

Purpose of string	Size hole drilled	Size casing set (in O.D.)	Weight lbs/ft.	Setting depth	Type cement	Sacks	Type and percent additives
Surface		8-5/8"	28#	303'	lite common	150	CaCl ₂ & 2% Gel
Production		2-7/8"	6.5#	2771'		200	50/50 pozmix, w/1% salt to 25 CFR-2 & 8# gilsonite/sx

LINER RECORD

PERFORATION RECORD

Top, ft.	Bottom, ft.	Sacks cement	Shots per ft.	Size & type	Depth interval
N/A	N/A	N/A	2/SPF	N/A	2686-96'

Size	Setting depth	Packer set at
N/A	N/A	N/A

ACID, FRACTURE, SHOT, CEMENT SQUEEZE RECORD

Amount and kind of material used	Depth interval treated
Acidize w/500 gals 7½% HCl & 1½% HF @ ½ BPM	2686-96'

Rec'd 4-23-82

INITIAL PRODUCTION

Date of first production: Shut-In Producing method (flowing, pumping, gas lift, etc.): flowing

RATE OF PRODUCTION PER 24 HOURS	Oil <u>N/A</u> bbls.	Gas <u>300</u> MCF	Water <u>NONE</u> bbls.	Gas-oil ratio <u>N/A</u> CFPB
---------------------------------	----------------------	--------------------	-------------------------	-------------------------------

Disposition of gas (vented, used on lease or sold): Shut-In Producing interval (s): 2686-96'

INSTRUCTIONS: As provided in KCC Rule 82-2-125, within 90 days after completion of a well, one completed copy of this Drillers Log shall be transmitted to the State Geological Survey of Kansas, 4150 Monroe Street, Wichita, Kansas 67209. Copies of this form are available from the Conservation Division, State Corporation Commission, 3830 So. Meridian (P.O. Box 17027), Wichita, Kansas 66217. Phone AC 316-522-2206. If confidential custody is desired, please note Rule 82-2-125. Drillers Logs will be on an open file in the Oil and Gas Division, State Geological Survey of Kansas, Lawrence, Kansas 66044.

Operator: Texas Oil & Gas Corp. DESIGNATE TYPE OF COMP.: OIL, GAS, DRY HOLE, SWDW, ETC.:

Well No. 1 Lease Name McInteer gas

S 1 T 29 R 12 ^E W

WELL LOG
 Show all important zones of porosity and contents thereof; cored intervals, and all drill-stem tests, including depth interval tested, cushion used, time tool open, flowing and shut-in pressures, and recoveries. SHOW GEOLOGICAL MARKERS, LOGS RUN, OR OTHER DESCRIPTIVE INFORMATION.

FORMATION DESCRIPTION, CONTENTS, ETC.	TOP	BOTTOM	NAME	DEPTH
Herrington	1904	-50		
Top Florence	2131	-277		
Bottom Florence	2177!	-323		
Wreford	2198	-344		
Bader	2361	-507		
Cottonwood	2443	-589		
Wabaunsee	2717	-863		
No DST's.				

RECEIVED
 STATE CORPORATION COMMISSION
APR 23 1979
 CONSERVATION DIVISION
 Wichita, Kansas

USE ADDITIONAL SHEETS, IF NECESSARY, TO COMPLETE WELL RECORD.

Date Received	<i>Harold Brown</i>
	HAROLD A. BROWN District Geologist
	Signature Title
	May 2, 1979
	Date



209 SOUTH MAIN
MEDICINE LODGE, KANSAS 67104

8583

DATE 4-26-82

DEL TO Parsons #1

SALE	CASH	REG.	30-60-90	CREDIT	RBA	OTHER	CREDIT	PAYMENT	MOSE. RETD.	OTHER	SALESMAN	DEL. BY	CUST. ORD. NO.
------	------	------	----------	--------	-----	-------	--------	---------	-------------	-------	----------	---------	----------------

PCS.	DESCRIPTION	FEET	TOTAL FEET	PRICE	AMOUNT	FOR OFFICE USE
10	5x5 post & rail			585	5850	

RECEIVED THE ABOVE IN GOOD CONDITION

TOTAL

176
~~5850~~
6026

REC'D BY

THANK YOU - WE APPRECIATE YOUR BUSINESS!

Ch. J. Meyer

DELIVERY RECEIPT



209 SOUTH MAIN
MEDICINE LODGE, KANSAS 67104

8579

DATE 4 19

DEL TO Markinton

SALE	CASH	REG.	30-60-90	CREDIT	RBA	OTHER	CREDIT	PAYMENT	MOSE. RETD.	OTHER	SALESMAN	DEL. BY	CUST. ORD. NO.
------	------	------	----------	--------	-----	-------	--------	---------	-------------	-------	----------	---------	----------------

PCS.	DESCRIPTION	FEET	TOTAL FEET	PRICE	AMOUNT	FOR OFFICE USE
10	5x5 post & rail			585	5850	

RECEIVED THE ABOVE IN GOOD CONDITION

TOTAL

176
~~5850~~
6026

REC'D BY

THANK YOU - WE APPRECIATE YOUR BUSINESS!

Ch. J. Meyer

DELIVERY RECEIPT

DELIVERY TICKET

P.O. Box 108
Great Bend, Kansas

DAVIS MUD & CHEMICAL, INC.

(316) 792-1751

WELL _____

19572

WELL NAME

Mc HERRINT 1

DATE

4-30-1982

OPERATOR (PURCHASED BY)

T.X.O. PRODUCTION

ON ORDER NO. _____

CONTRACTOR

CLARK

LOCATION _____

FROM (WAREHOUSE)

MED. LODGE

DELIVERED BY

CLARK

QUANTITY	PRODUCT	SIZE	CODE	UNIT PRICE	AMOUNT
<u>25</u>	BAGS DAVIS GEL	100 LB.	1200		
	BAGS SODA ASH	100 LB.	1225		
	BAGS SALT MUD	50 LB.	1205		
	BAGS DRILSTARCH	50 LB.	1206		
<u>6</u>	BAGS COTTONSEED HULLS	100 LB.	1213		
	BAGS LIME	50 LB.	1230		
	PRESERVATIVE BIOCIDE	50 LB.	1231		
	DEFOAMER				
	BAGS CEDAR FIBER	40 LB.	1216		
	DLX DRLG. LIQ. SPEC.	5 GAL.	1238		

19572

RECEIVED

BY

Clark Huff



GEARHART INDUSTRIES, INC. WIRELINE SERVICES

P.O. BOX 12587 / FORT WORTH, TEXAS 76101

JOB TICKET
172389

Engineer: Piggott
Operators: MAWGAN
Schmidt
Legal: 330' RWL, 330' FWH
Description: 31/293/9"

Bill To: TEXAS OIL & GAS
Address: 200 W. DOUGLAS SWITE 300
City: WICHITA KS 67202
Lease and Well No.: PANEK A-1
Field: N/A County: KINGMAN
Job No.: 5200 - 169 State: KANSAS

Invoice No. _____
Date: _____
Customer's Order No. _____
Date of Service: 27 APR 82
WICHITA, KS
R & S Code: 21-192

CONDITIONS OF THIS CONTRACT

TO GEARHART INDUSTRIES, INC.
You are hereby requested to furnish the service and materials and equipment herein set forth upon the following terms and conditions to wit:
The undersigned, as customer, agrees to pay you for the services and/or materials ordered hereunder at the office of Gearhart Industries, Inc., Fort Worth, Texas.
Should any account not be paid within the term fixed by this invoice, interest will be charged at the rate of ten per cent (10%) per annum from date of such invoice.
In the event you employ an attorney to enforce any claims of indebtedness against the undersigned customer, said customer agrees to pay all costs of collection and reasonable attorney's fees which, in no event, shall be less than the sum of \$75.00.
The above described work shall be performed by you as an independent contractor. However, it is understood and agreed that you do not guarantee the results of your service and shall not be liable for injury to persons or to property of well owners and/or customers unless caused by your willful negligence, this provision applying, but not limited to, sub-surface damage and surface damage arising from sub-surface damage. Well owner and/or customer shall be responsible for and secure you against any liability for reservoir loss or damage or personal or property damage arising from a well blowout, unless such loss or damage is caused by your willful negligence. The well owner or drilling company will pay for the actual cost of replacing or repairing the well service equipment or any part thereof, if same should be lost or damaged while being used in performing the work on the above described well.
Should any of your instruments, tools, or equipment be lost or destroyed in the rendition of your service, customer agrees to use all reasonable diligence and facilities available to recover the same, and customer agrees to reimburse you for the reasonable value of any instrument, tools, or other personal property that cannot be recovered within (60) days; or for the cost of replacing any damage to items recovered.
Customer agrees that all depth measurements shall be made by it or its employees, and shall be supervised by customer or its employees.
Customer certifies that it is the owner of the well on which the work herein ordered is to be done or that it has the full right and authority to order such work done on such well, and that the well in which the work is to be done by yours in proper and suitable condition for the performance of said work.
Customer further agrees that the terms and conditions herein set forth constitute the entire agreement and that no employee of your company is authorized to alter the terms hereof, I have read and understand the terms of this agreement and represent that I am authorized to sign the same as agent of customer.

TXO

X [Signature]
Agent

DESCRIPTION	PRICE	AMOUNT
1000-001 Service CHARGE		600.00
2800-010 2 1/4" TUBE CUTTER @ 16.75'		1020.00
		1220.00

REMARKS: NOTE: PRICES SHOWN ARE ESTIMATES AND SUBJECT TO CHANGE BY ACCOUNTING DEPARTMENT



GEARHART INDUSTRIES, INC.
WIRELINE SERVICES

P.O. BOX 1258-1 FORT WORTH, TEXAS 76101

JOB TICKET

172388

Engineer: Figott

Operators: MAUGAN

SCHMIDT

Legal: 310 FSL, 330 FEL

Description: 1/275/12

Bill To: TEXAS OIL & GAS
Address: 200 W. Douglas Suite 200
City: WICHITA KS 67202
Lease and Well No: MCINTOCH #1
Field: N/A County: PRATT
Job No: 5100-163 State: KANSAS

Invoice No. _____
Invoice Date _____
Customer's Order No. _____
Date of Service: 27 APR 82
Service: WICHITA, KS
R & S Code: 21-192

CONDITIONS OF THIS CONTRACT

TO GEARHART INDUSTRIES, INC.
You are hereby requested to furnish the service and materials and equipment herein set forth upon the following terms and conditions to wit:
The undersigned, as customer, agrees to pay you for the services and/or materials ordered hereunder at the office of Gearhart Industries, Inc., Fort Worth, Texas.
Should any account not be paid within the term fixed by the invoice, interest will be charged at the rate of ten per cent (10%) per annum from date of such invoice.
In the event you employ an attorney to enforce any claims of indebtedness against the undersigned customer, said customer agrees to pay all costs of collection and reasonable attorney's fees which, in no event, shall be less than the sum of \$75.00.
The above described work shall be performed by you as an independent contractor. However, it is understood and agreed that you do not guarantee the results of your service and shall not be liable for injury to persons or to property of well owners and/or customers unless caused by your willful negligence, this provision applying but not limited to, sub-surface damage and surface damage arising from subsurface damage. Well owner and/or customers shall be responsible for and secure you against any liability for reservoir loss or damage or personal or property damage arising from a well blowout, unless such loss or damage is caused by your willful negligence. (The well owner or drilling company will pay for the actual cost of replacing or repairing the well service equipment, or any part thereof, if same should be lost or damaged while being used in performing the work on the above described well.)
Should any of your instruments, tools, or equipment be lost or destroyed in the rendition of your service, customer agrees to use all reasonable diligence and facilities available to recover the same, and customer agrees to reimburse you for the reasonable value of any instrument, tool, or other personal property that cannot be recovered within (60) days, or for the cost of repairing any damage to items recovered.
Customer agrees that all depth measurements shall be made by it or its employees, and shall be supervised by customer or its employees.
Customer certifies that it is the owner of the well on which the work herein ordered is to be done or that it has the full right and authority to order such work and on such wells, and that the well in which the work is to be done by you is in proper and suitable condition for the performance of said work.
Customer further agrees that the terms and conditions herein set forth constitute the entire agreement and that no employee of your company is authorized to alter the terms hereof. I have read and understand the terms of this agreement and represent that I am authorized to sign the same as agent of customer.

T-10

X. J. Maguire
Agent

DESCRIPTION	PRICE	AMOUNT
1000-001 SERVICE CHARGE		600
2800-010 2 1/4" TUBE CUTTER @ 2,024'		620
2800-010 2 1/4" TUBE CUTTER @ 1915'		620
TOTAL		1840

REMARKS: NOTE: PRICES SHOWN ARE ESTIMATES AND SUBJECT TO CHANGE BY ACCOUNTING DEPARTMENT