

STATE CORPORATION COMMISSION OF KANSAS
OIL & GAS CONSERVATION DIVISION
WELL COMPLETION OR RECOMPLETION FORM
ACO-1 WELL HISTORY
DESCRIPTION OF WELL AND LEASE

S

API NO. 15-097-21,246-0000

County.....Kiowa.....
100' E of C
SW.. SW.. NE. Sec. 28.. Twp. 29.. Rge. 18.. X West

Operator: License # ... 5004
Name .. Vincent Oil Corporation
Address 125 N. Market, Suite 1110
City/State/Zip ... Wichita, Kansas 67202

.. 2970.... Ft North from Southeast Corner of Section
.. 2210.... Ft West from Southeast Corner of Section
(Note: Locate well in section plat below)

Purchaser.... Kocb. Oil Company
... Wichita, Kansas 67201

Lease Name..... Koehn..... Well #... 2

Operator Contact Person .. Richard A. Hiebsch
Phone (316) 262-3573

Field Name..... Nichols

Contractor: License # ... 5107
Name ... H-30 Drilling, Inc.

Producing Formation..... Mississippian

Wellsite Geologist... Ernie Morrison
Phone... (316) 262-1729

Elevation: Ground... 2193..... KB..... 2198

Designate Type of Completion
X New Well ___ Re-Entry ___ Workover
X Oil ___ SWD ___ Temp Abd
___ Gas ___ Inj ___ Delayed Comp.
___ Dry ___ Other (Core, Water Supply etc.)

If OHWO: old well info as follows:
Operator
Well Name
Comp. Date Old Total Depth.....

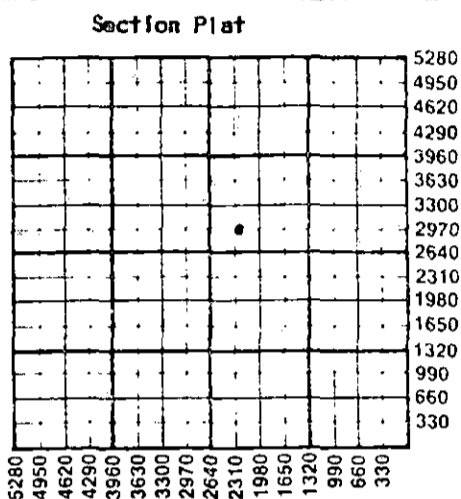

WATER SUPPLY INFORMATION
Disposition of Produced Water: ___ Disposal
Docket # ___ Repressuring

WELL HISTORY

Drilling Method:
X Mud Rotary ___ Air Rotary ___ Cable

.7-25-87... ..8-02-87... ..9-10-87...
Spud Date Date Reached TD Completion Date

4926
Total Depth PBDT

Amount of Surface Pipe Set and Cemented at 286 feet
Multiple Stage Cementing Collar Used? ___ Yes X No
If yes, show depth set..... feet
If alternate 2 completion, cement circulated
from..... feet depth to..... w/..... SX cmt
Cement Company Name
Invoice #

Questions on this portion of the ACO-1 call:
Water Resources Board (913) 296-3717
Source of Water:
Division of Water Resources Permit #.....
___ Groundwater..... Ft North from Southeast Corner
(Well) Ft West from Southeast Corner of
Sec Twp Rge ___ East ___ West
___ Surface Water..... Ft North from Southeast Corner
(Stream, pond etc)..... Ft West from Southeast Corner
Sec Twp Rge ___ East ___ West
___ Other (explain).....
(purchased from city, R.W.D. #)

INSTRUCTIONS: This form shall be completed in triplicate and filed with the Kansas Corporation Commission, 200 Colorado Derby Building, Wichita, Kansas 67202, within 120 days of the spud date of any well. Rule 82-3-130, 82-3-107 and 82-3-106 apply.
Information on side two of this form will be held confidential for a period of 12 months if requested in writing and submitted with the form. See rule 82-3-107 for confidentiality in excess of 12 months.
One copy of all wireline logs and drillers time log shall be attached with this form. Submit CP-4 form with all plugged wells. Submit CP-111 form with all temporarily abandoned wells.

All requirements of the statutes, rules and regulations promulgated to regulate the oil and gas industry have been fully complied with and the statements herein are complete and correct to the best of my knowledge.

Signature .. Richard A. Hiebsch
Richard A. Hiebsch
Title..... Vice President..... Date ... 9-22-87..

Subscribed and sworn to before me this 22nd day of September
1987...
Notary Public..... Julie K. Stout
Date Commission Expires... July 23, 1989

K.C.C. OFFICE USE ONLY
 Letter of Confidentiality Attached
 Wireline Log Received
 Drillers Timelog Received
Distribution
 KCC ___ SWD/Rep ___ NGPA
 KGS ___ Plug ___ Other
(Specify)
.....



Rec- 9-24-87

Form ACO-1 (5-86)

Sec. 21 Twp. 29 Rge. 18 W

Operator Name Vincent Oil Corporation Lease Name Koehn Well # 2

Sec. 28 Twp. 29S Rge. 18 East West County Kiowa

RELEASED

WELL LOG

INSTRUCTIONS: Show important tops and base of formations penetrated. Detail all cores. Report all drill stem tests giving interval tested, time tool open and closed, flowing and shut-in pressures, whether shut-in pressure reached static level, hydrostatic pressures, bottom hole temperature, fluid recovery, and fluid rates if gas to surface during test. Attach extra sheet if more space is needed. Attach copy of log.

MAR 06 1990

FROM CONFIDENTIAL

Drill Stem Tests Taken Yes No
 Samples Sent to Geological Survey Yes No
 Cores Taken Yes No

Formation Description
 Log Sample

DST #1 4702-4830

30" 30" 15" 15"
 1st open: Weak blow, died in 15"
 2nd open: No blow
 Rec: 40' Mud
 IFP 55-55# FFP 55-55#
 ISIP 55# FSIP 55#

| Name | Top | Bottom |
|------------------|------|---------|
| Heebner Shale | 4104 | (-1906) |
| Toronto | 4118 | (-1920) |
| Brown Lst | 4281 | (-2083) |
| Lansing | 4294 | (-2096) |
| Stark Shale | 4603 | (-2405) |
| Base Kansas City | 4698 | (-2500) |
| Marmaton | 4750 | (-2552) |
| Altamont | 4761 | (-2563) |
| Pawnee | 4792 | (-2594) |
| Mississippian | 4893 | (-2695) |
| LTD | 4920 | (-2722) |

DST #2 4862-4926

35" 45" 45" 60"
 1st open: Strong blow, GTS/12"
 Ga: 93 MCFG in 15 min.
 101 MCFG in 20 min.
 106 MCFG in 30 min.
 113 MCFG in 35 min.
 2nd open: GTS/immed.
 Ga: 137 MCFG in 5 min.
 158 MCFG in 15 min.
 158 MCFG in 25 min.
 158 MCFG in 35 min.
 158 MCFG in 45 min.

Rec: 30' Gas cut mud
 240' Heavy oil & gas cut mud (60% oil, 10% gas, 30% mud)
 60' Heavy oil & gas cut watery mud (60% oil, 10% water, 30% gas and mud)
 IFP 133-143# FFP 171-181#
 ISIP 295# FSIP 295#

CASING RECORD New Used
 Report all strings set-conductor, surface, intermediate, production, etc.

| Purpose of String | Size Hole Drilled | Size Casing Set (in O.D.) | Weight Lbs/Ft. | Setting Depth | Type of Cement | #Sacks Used | Type and Percent Additives |
|-------------------|-------------------|---------------------------|----------------|---------------|----------------|-------------|----------------------------|
| Surface | 12 1/4" | 8 5/8" | 28# | 286' | Common Lite | 75 100 | 3% c.c. 2% gel 3% c.c. |
| Production | 7 7/8" | 4 1/2" | 9.5# | 4898' | ASC | 100 | |

PERFORATION RECORD
 Shots Per Foot Specify Footage of Each Interval Perforated

| Shots Per Foot | Specify Footage of Each Interval Perforated | Acid, Fracture, Shot, Cement Squeeze Record (Amount and Kind of Material Used) | Depth |
|----------------|---------------------------------------------|--------------------------------------------------------------------------------|-------|
| Open Hole | 4898-4924' | 500 gallons 15% HCl with N ₂ | |

TUBING RECORD
 Size 2 3/8" Set At 4908' Packer at Liner Run Yes No

Date of First Production 9-10-87 Producing Method Flowing Pumping Gas Lift Other (explain).....

| Estimated Production Per 24 Hours | Oil | Gas | Water | Gas-Oil Ratio | Gravity |
|-----------------------------------|---------|-------|--------|---------------|---------|
| | 10 Bbls | 0 MCF | 0 Bbls | CFPB | |

METHOD OF COMPLETION

Production Interval

Disposition of gas: Vented Open Hole Perforation
 Sold Other (Specify) 4898-4924'
 Used on Lease Dually Completed
 Commingled

100' E of C SW SW NE
is correct location.

(50' alternate was
drilled)

RELEASED

MAR 0 6 1990

FROM CONFIDENTIAL