

EFFECTIVE DATE: 11-12-89 State of Kansas

NOTICE OF INTENTION TO DRILL

Must be approved by the K.C.C. five (5) days prior to commencing well

Expected Spud Date November 12, 1989
month day year

230' East of
E/2 SE-SE Sec 15 Twp 29 S, Rg 11 X East
West

OPERATOR: License # 5056
Name: F. G. HOLL COMPANY
Address: P. O. BOX 780167
City/State/Zip: Wichita, Kansas 67278-0167
Contact Person: Elwyn H. Nagel
Phone: (316) 684-8481

..... 660 feet from South line of Section
..... 100 feet from East line of Section
(Note: Locate well on Section Plat Below)

CONTRACTOR: License #: 5142
Name: Sterling Drilling Company

County: Pratt
Lease Name: Hiskett "C" Well #: 1-15
Field Name: Sandy
Is this a Prorated Field? yes X no
Target Formation(s): Congl. Indian Cave, Simpson
Nearest lease or unit boundary: 100-660' DPW KCC
Ground Surface Elevation: 1790 est. feet MSL
Domestic well within 330 feet: yes X no
Municipal well within one mile: yes X no
Depth to bottom of fresh water: 180
Depth to bottom of usable water: 200
Surface Pipe by Alternate: X 1 2
Length of Surface Pipe Planned to be set: 240
Length of Conductor pipe required: N/A
Projected Total Depth: 4750
Formation at Total Depth: Arbuckle
Water Source for Drilling Operations:
X well farm pond other
DWR Permit #: Apply For Permit
Will Cores Be Taken?: yes X no
If yes, proposed zone:

Well Drilled For: Well Class: Type Equipment:
X Oil ... Inj ... Infield X Mud Rotary
X Gas ... Storage X Pool Ext. ... Air Rotary
... OWMO ... Disposal ... Wildcat ... Cable
... Seismic; ... # of Holes

If OWMO: old well information as follows:
Operator:
Well Name:
Comp. Date: Old Total Depth

Directional, Deviated or Horizontal wellbore? yes X no
If yes, total depth location:

AFFIDAVIT

The undersigned hereby affirms that the drilling, completion and eventual plugging of this well will comply with K.S.A. 55-101, et. seq.

It is agreed that the following minimum requirements will be met:

1. The appropriate district office shall be notified before setting surface pipe;
2. The minimum amount of surface pipe as specified above shall be set by circulating cement to the top; in all cases surface pipe shall be set through all unconsolidated materials plus a minimum of 20 feet into the underlying formation;
3. If the well is dry, a plugging proposal shall be submitted to the district office. An agreement between the operator and the district office on plug length and placement is necessary prior to plugging;
4. The appropriate district office will be notified before well is either plugged or production casing is cemented in;
5. If an Alternate II completion, production pipe shall be cemented from below any usable water to surface within 120 days of spud date. In all cases, notify district office prior to any cementing.

I hereby certify that the statements made herein are true and to the best of my knowledge and belief.

Date: 11/7/89 Signature of Operator or Agent: W. Bruce Bidleman Title: Geologist

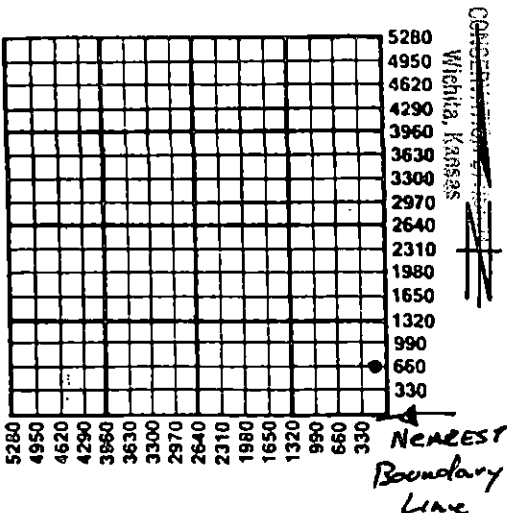

FOR KCC USE:
API # 15- 151-21,956-00-00
Conductor pipe required NONE feet
Minimum surface pipe required 220 feet per Alt. OX
Approved by: DPW 11-07-89
EFFECTIVE DATE: 11-12-89
This authorization expires: 5-07-90
(This authorization void if drilling not started within 6 months of effective date.)
Spud date: _____ Agent: _____

REMEMBER TO:

- File Drill Pit Application (form CDP-1) with Intent to Drill;
- File Completion Form ACO-1 within 120 days of spud date;
- File acreage attribution plat according to field proration orders;
- Notify appropriate district office 48 hours prior to workover or re-entry;
- Submit plugging report (CP-4) after plugging is completed;
- Obtain written approval before disposing or injecting salt water.