

**EFFECTIVE DATE:** \_\_\_\_\_

NOTICE OF INTENTION TO DRILL

(Location Change)

Must be approved by the K.C.C. five (5) days prior to commencing well

Expected Spud Date October 15, 1990  
month day year

30' SOUTH OF  
\* NW NE NE Sec .17. Twp .29S S, Rg .13W X West

OPERATOR: License # 5056  
Name: F. G. HOLL COMPANY  
Address: P.O. Box 780167  
City/State/Zip: Wichita, KS 67278-0167  
Contact Person: Elwyn H. Nagel  
Phone: (316) 684-8481

\* 4920 feet from South line of Section  
990 feet from East line of Section  
(Note: Locate well on Section Plat on Reverse Side)

CONTRACTOR: License # 5142  
Name: Sterling Drilling Company

County: Pratt  
Lease Name: OMO Well #: 1-17  
Field Name: Wildcat (Unnamed)  
Is this a Prorated Field? yes X no  
Target Formation(s): Miss, Viola, Simson  
Nearest lease or unit boundary: 330'  
\* Ground Surface Elevation: 1942' feet MSL  
Domestic well within 330 feet: yes X no  
Municipal well within one mile: yes X no  
Depth to bottom of fresh water: 200  
Depth to bottom of usable water: 220  
Surface Pipe by Alternate: X 1 2  
Length of Surface Pipe Planned to be set: 350'  
Length of Conductor pipe required: \_\_\_\_\_  
Projected Total Depth: 4890'  
Formation at Total Depth: Arbuckle  
Water Source for Drilling Operations:

Well Drilled For: Well Class: Type Equipment:  
X Oil ... Inj ... Infield X Mud Rotary  
X Gas ... Storage ... Pool Ext. ... Air Rotary  
... OMWO ... Disposal X Wildcat ... Cable  
... Seismic; ... # of Holes

If OMWO: old well information as follows:  
Operator: \_\_\_\_\_  
Well Name: \_\_\_\_\_  
Comp. Date: \_\_\_\_\_ Old Total Depth \_\_\_\_\_

Directional, Deviated or Horizontal wellbore? ... yes X no  
If yes, total depth location: \_\_\_\_\_

X well ... farm pond ... other  
DWR Permit #: Applied for by Sterling Drilling  
Will Cores Be Taken?: ... yes X no  
If yes, proposed zone: \_\_\_\_\_

WAS: NW NENE; 4950 FSL; Elev = 1944

**AFFIDAVIT**

IS: 30' South of NW NE NE; 4920 FSL; Elev = 1942'

The undersigned hereby affirms that the drilling, completion and eventual plugging of this well will comply with K.S.A. 55-101, et. seq.

It is agreed that the following minimum requirements will be met:

- 1. The appropriate district office shall be notified before setting surface pipe;
- 2. The minimum amount of surface pipe as specified above shall be set by circulating cement to the top; in all cases surface pipe shall be set through all unconsolidated materials plus a minimum of 20 feet into the underlying formation;
- 3. If the well is dry, a plugging proposal shall be submitted to the district office. An agreement between the operator and the district office on plug length and placement is necessary prior to plugging;
- 4. The appropriate district office will be notified before well is either plugged or production casing is cemented in;
- 5. If an Alternate II completion, production pipe shall be cemented from below any usable water to surface within 120 days of spud date. In all cases, notify district office prior to any cementing.

I hereby certify that the statements made herein are true and to the best of my knowledge and belief.

Date: 9/25/90 Signature of Operator or Agent: Brent B. Reinhardt Title: Geologist  
3/27/91

**FOR KCC USE:**  
API # 15- 151-22,013 - 00-00  
Conductor pipe required None feet  
Minimum surface pipe required 250 feet per Alt. 1  
Approved by: MRW 10/11/90; con 4-1-91 mde  
EFFECTIVE DATE: 10/16/90  
This authorization expires: 4/11/91  
(This authorization void if drilling not started within 6 months of effective date.)  
Spud date: \_\_\_\_\_ Agent: \_\_\_\_\_

RECEIVED  
STATE CORPORATION COMMISSION  
**MAR 27 1991**  
CONSERVATION DIVISION  
Wichita, Kansas

**REMEMBER TO:**

- File Drill Pit Application (form CDP-1) with Intent to Drill;
- File Completion Form ACO-1 within 120 days of spud date;
- File acreage attribution plat according to field proration orders;
- Notify appropriate district office 48 hours prior to workover or re-entry;
- Submit plugging report (CP-4) after plugging is completed;
- Obtain written approval before disposing or injecting salt water.

17  
29S  
13W

PLAT OF ACREAGE ATTRIBUTABLE TO

State Corporation Commission, Conservation Division  
 200 Colorado Derby Bldg. Wichita, Kansas 67202

OPERATOR F. G. Holl Company LOCATION OF WELL:  
 LEASE OMO 4920 feet north of SE corner  
 WELL NUMBER #1-17 990 feet west of SE corner  
 FIELD WILDCAT NE/4 Sec. 17 T 29 R 13w E/W  
 COUNTY Pratt  
 NO. OF ACRES ATTRIBUTABLE TO WELL NA IS SECTION X REGULAR IRREGULAR?  
 DESCRIPTION OF ACREAGE NA IF IRREGULAR, LOCATE WELL FROM NEAREST  
 CORNER BOUNDARY.

NOTE: If plat depicted is insufficient for your circumstances, you may attach your own scaled or surveyed plat.

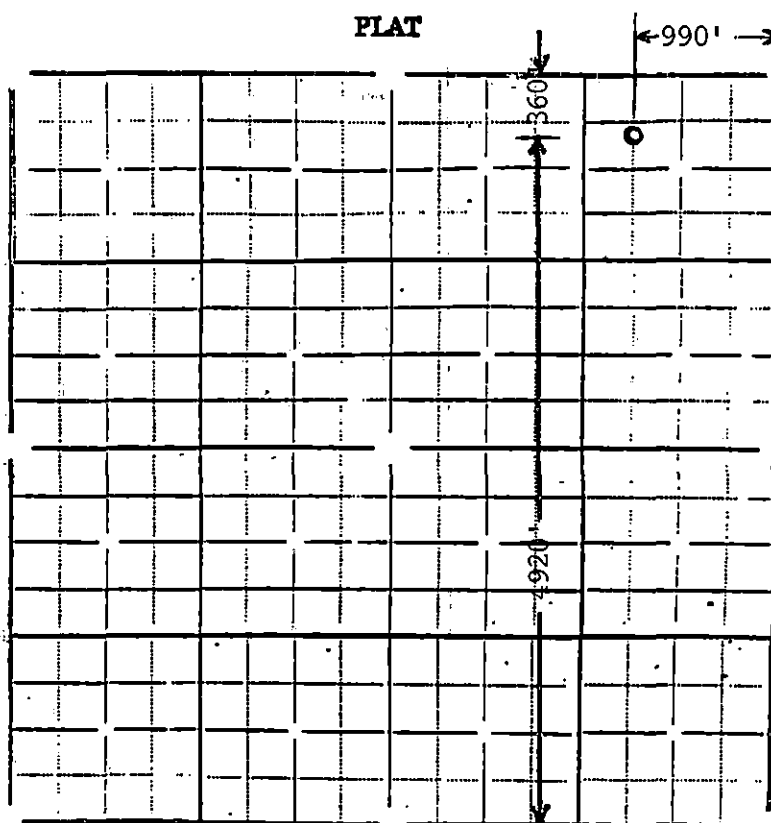

In plotting the proposed location of the well, you must show:

- 1) The manner in which you are using the depicted plat by identifying section lines, i.e. 1 section, 1 section with 8 surrounding partial sections, 4 sections, 16 sections, etc.;
- 2) the well's location relative to the location of other wells producing from the same common source of supply in adjoining drilling units, pursuant to K.A.R. 82-3-108, 82-3-207, 82-3-312, or special orders of the Commission;
- 3) the distance of the proposed drilling location from the section's east and south lines; and
- 4) the distance to the nearest lease or unit boundary line.

I hereby certify that the statements made herein are true and to the best of my knowledge and belief.

Signature of Operator or Agent Brent B. Reinhardt  
 Brent B. Reinhardt  
 Date 3/27/91 Title Geologist