

STATE OF KANSAS  
STATE CORPORATION COMMISSION

WELL PLUGGING RECORD

Give All Information Completely  
Make Required Affidavit.  
Mail or Deliver Report to  
Conservation Division  
State Corporation Comm.  
245 North Water  
Wichita, KS 67202

Ford County, Sec. 30 Twp. 29S Rge. 22 #1/W  
Location as "NE/CNW<sub>1</sub>/SW<sub>1</sub>" or footage from lines  
E/2 SE SE

Lease Owner Pickrell Drilling Company  
Lease Name Clevenger 'C' Well No. 1  
Office Address 110 N. Market, Suite 205, Wichita, KS 67202  
Character of Well (Completed as Oil, Gas or Dry Hole)  
Dry Hole

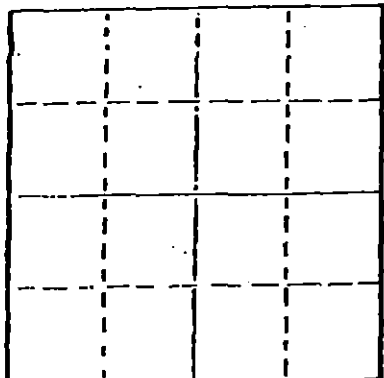

Date Well completed 8-25 1981  
Application for plugging filed 8-25 1981  
Application for plugging approved 8-25 1981  
Plugging commenced 8-25 1981  
Plugging completed 8-25 1981

Reason for abandonment of well or producing formation  
Dry Hole  
If a producing well is abandoned, date of last production  
19

Was permission obtained from the Conservation Division or  
its agents before plugging was commenced? Yes

Name of Conservation Agent who supervised plugging of this well Clarence Thomas, Jr.  
Producing formation \_\_\_\_\_ Depth to top \_\_\_\_\_ Bottom \_\_\_\_\_ Total Depth of Well 5460  
Show depth and thickness of all water, oil and gas formations.

OIL, GAS OR WATER RECORDS

CASING RECORD

FORMATION	CONTENT	FROM	TO	SIZE	PUT IN	PULLED OUT
				8 5/8"	320' KB	None

Describe in detail the manner in which the well was plugged, indicating where the mud fluid  
was placed and the method or methods used in introducing it into the hold. If cement or other  
plugs were used, state the character of same and depth placed, from \_\_\_\_\_ feet to  
\_\_\_\_\_ feet for each plug set.

- 75 sx at 780'
- 40 sx & SBP at 300'
- 10 sx & SBP at 40'
- 5 sx rathole, comp 6:45 a.m. on 8-25-81

RECEIVED  
STATE CORPORATION COMMISSION  
SEP - 2 1981  
CONSERVATION DIVISION  
Wichita, Kansas  
9-2-81

(If additional description is necessary, use BACK of this sheet)

Name of Plugging Contractor Pickrell Drilling Company

STATE OF Kansas COUNTY OF Sedgwick, ss.

C. W. Sebitts (~~employee of owner~~) or (owner or operator)  
of the above-described well, being first duly sworn on oath, says: That I have knowledge of  
the facts, statements, and matters herein contained and the log of the above-described well  
as filed and that the same are true and correct. So help me God.

(Signature) [Signature]  
205 Litwin Building, 110 N. Market, Wichita, KS  
(Address)

SUBSCRIBED AND SWORN TO before me this 1st day of September, 1981



Jana Lea Schneweis  
Notary Public.

My commission expires December 9, 1982

15-057-20230-0000

KANSAS

WELL COMPLETION REPORT AND DRILLER'S LOG

API No. 15 — 057 — 20,230  
County Number

Operator  
Pickrell Drilling Company

Address  
205 Litwin Building, 110 North Market, Wichita, KS 67202

Well No. 1 Lease Name Clevenger 'C'

Footage Location  
feet from (N) (S) line feet from (E) (W) line

Principal Contractor Geologist  
Pickrell Drilling Company Claud Sheats

Spud Date Date Completed Total Depth P.B.T.D.  
8-14-81 8-25-81 5460'

Directional Deviation Oil and/or Gas Purchaser

S. 30 T. 29S R. 22 W  
Loc. E/2 SE SE  
County Ford

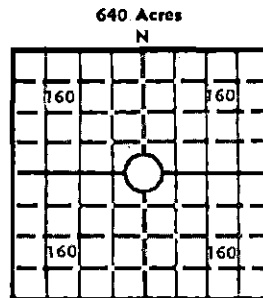

Locate well correctly  
Elev.: Gr. 2481'  
DF 2483' KB 2486'

CASING RECORD

Report of all strings set — surface, intermediate, production, etc.

Purpose of string	Size hole drilled	Size casing set (in O.D.)	Weight lbs/ft.	Setting depth	Type cement	Sacks	Type and percent additives
Surface		8 5/8"		320' KB		225	

LINER RECORD

PERFORATION RECORD

Top, ft.	Bottom, ft.	Sacks cement	Shots per ft.	Size & type	Depth interval

TUBING RECORD

Size	Setting depth	Packer set at

ACID, FRACTURE, SHOT, CEMENT SQUEEZE RECORD

Amount and kind of material used	Depth interval treated

INITIAL PRODUCTION

Date of first production	Producing method (flowing, pumping, gas lift, etc.)				
RATE OF PRODUCTION PER 24 HOURS	Oil bbls.	Gas MCF	Water bbls.	Gas-oil ratio	CFPB
Disposition of gas (vented, used on lease or sold)			Producing interval (s)		

RECEIVED  
STATE CORPORATION COMMISSION  
CONSERVATION DIVISION  
Wichita, Kansas

INSTRUCTIONS: As provided in KCC Rule 82-2-125, within 90 days after completion of a well, one completed copy of this Drillers Log shall be transmitted to the State Geological Survey of Kansas, 4150 Monroe Street, Wichita, Kansas 67209. Copies of this form are available from the Conservation Division, State Corporation Commission, 245 No. Water, Wichita, Kansas 67202. Phone AC 316-522-2206. If confidential custody is desired, please note Rule 82-2-125. Drillers Logs will be on open file in the Oil and Gas Division, State Geological Survey of Kansas, Lawrence, Kansas 66044.

Operator  
 Pickrell Drilling Company

DESIGNATE TYPE OF COMP.: OIL, GAS,  
 DRY HOLE, SWDW, ETC.:  
 Dry Hole

Well No.  
 1

Lease Name  
 Clevenger 'C'

S 30 T 29S R 22W E  
 W

**WELL LOG**

Show all important zones of porosity and contents thereof; cored intervals, and all drill-stem tests, including depth interval tested, cushion used, time tool open, flowing and shut-in pressures, and recoveries.

SHOW GEOLOGICAL MARKERS, LOGS RUN,  
 OR OTHER DESCRIPTIVE INFORMATION.

FORMATION DESCRIPTION, CONTENTS, ETC.	TOP	BOTTOM	NAME	DEPTH
Shale				1360
Lime & Shale				1840
Shale & Lime Streaks				2169
Shale & Lime				2520
Lime & Shale				4590
Lime				4835
Lime & Shale				5290
Lime				5460

USE ADDITIONAL SHEETS, IF NECESSARY, TO COMPLETE WELL RECORD.

Date Received

  
 Signature  
 C. W. Sebits - Partner  
 Title  
 September 1, 1981  
 Date

**ROTARY DRILLING LOG**

COMPANY: Pickrell Drilling Company  
205 Litwin Building, 110 North Market  
Wichita, Kansas 67202  
LOCATION: #1 Clevenger 'C'  
E/2 SE SE, Sec. 30-29S-22W  
Ford County, Kansas  
CONTRACTOR: **PICKRELL DRILLING COMPANY**  
Wichita, Kansas

Rotary Drilling Commenced 8-14-81  
Rotary Drilling Completed 8-25-81

CASING RECORD: Spud 8-14-81, surface 8 5/8", depth 320' KB, cmt 225 sx, comp 8-15-81.

**LOG**

(Figures indicate bottom of formation — measurements from top of rotary bushing.)

Shale	1360
Lime & Shale	1840
Shale & Lime Streaks	2169
Shale & Lime	2520
Lime & Shale	4590
Lime	4835
Lime & Shale	5290
Lime	5460

RECEIVED  
STATE CORPORATION COMMISSION  
'SEP - 2 1981'  
CONSERVATION DIVISION  
Wichita, Kansas

The undersigned, C. W. Sebitts, Attorney-in-Fact for PICKRELL DRILLING COMPANY, hereby certifies in behalf of said Company, that the above is a true and correct log of the formation encountered in drilling the above well as reflected by the Daily Drilling Reports.

**PICKRELL DRILLING COMPANY**

By *C. W. Sebitts*  
C. W. Sebitts Attorney-in-Fact

STATE OF KANSAS }  
COUNTY OF SEDGWICK } ss.:

On this 1st day of September, 1981, before me the undersigned, a Notary Public, in and for the County and State aforesaid, personally appeared C. W. Sebitts, to me known to be the identical person who subscribed the name of PICKRELL DRILLING COMPANY to the foregoing instrument as its Attorney-in-Fact and acknowledged to me that he executed the same as his free and voluntary act and deed, and as the free and voluntary act and deed of such company, for the uses and purposes therein set forth.

Given under my hand and seal of office the day and year last above written.

My commission expires:

December 9, 1982  
JANA LEA SCHNEWEIS  
STATE NOTARY PUBLIC  
Sedgwick County, Kansas

*Jana Lea Schneewis*  
Notary Public  
Jana Lea Schneewis