

STATE OF KANSAS
STATE CORPORATION COMMISSION

WELL PLUGGING RECORD

Give All Information Completely
Make Required Affidavit
Mail or Deliver Report to
Conservation Division
State Corporation Comm.
245 North Water
Wichita, KS 67202

Pratt County, Sec. 18 Twp. 28S Rge. 15W E/W
Location as "NE/CNW $\frac{1}{4}$ SW $\frac{1}{4}$ " or footage from lines

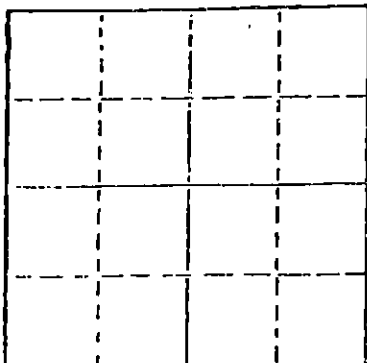

Locate well correctly on above
Section Plat

SW-NW
Lease Owner Trich, Fletcher & Antares
Lease Name Kinney Estate Well No. 1
Office Address P. O. Box 1408 Longview, TX 75601
Character of Well (Completed as Oil, Gas or Dry Hole) DRY & ABANDONED

Date Well completed 5-27-80 19
Application for plugging filed 5-27-80 19
Application for plugging approved 5-27-80 19
Plugging commenced 5-27-80 19
Plugging completed 5-27-80 19
Reason for abandonment of well or producing formation DRY & ABANDONED

If a producing well is abandoned, date of last production 19

Was permission obtained from the Conservation Division or its agents before plugging was commenced? Yes

Name of Conservation Agent who supervised plugging of this well Bill Owens
Producing formation _____ Depth to top _____ Bottom _____ Total Depth of Well _____
Show depth and thickness of all water, oil and gas formations.

OIL, GAS OR WATER RECORDS

CASING RECORD

FORMATION	CONTENT	FROM	TO	SIZE	PUT IN	PULLED OUT

Describe in detail the manner in which the well was plugged, indicating where the mud fluid was placed and the method or methods used in introducing it into the hold. If cement or other plugs were used, state the character of same and depth placed, from _____ feet to _____ feet for each plug set.

1st Plug @ 480' w/50 sks
2nd Plug @ 40' w/10 sks
Rat Hole 5 Sks
Water Well w/2 sks

RECEIVED
STATE CORPORATION COMMISSION

AUG 27 1980

(If additional description is necessary, use BACK of this report)
Name of Plugging Contractor Gabbert-Jones, Inc. Conservation Division
Wichita, Kansas

STATE OF Kansas COUNTY OF Sedgwick, ss.
Jack W. Gabbert (employee of owner) or (owner or operator)
of the above-described well, being first duly sworn on oath, says: That I have knowledge of the facts, statements, and matters herein contained and the log of the above-described well as filed and that the same are true and correct. So help me God.

(Signature) [Signature]
830 Sutton Place Wichita, Ks 67202
(Address)

SUBSCRIBED AND SWORN TO before me this 26th day of August, 1980.

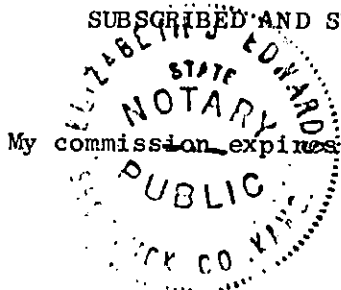

Elizabeth J. Edwards
Elizabeth J. Edwards Notary Public.

GABBERT-JONES, INC.
 WICHITA, KANSAS
 DRILLERS' WELL LOG

Kinney #1
 SW-NW Sec 13-28S-15W
 Kiowa County Kansas

Commenced: 5-16-80

Completed: 5-26-80

OPERATOR: Wenert Trich O & G Exploration & Production

Operator		Formation	Remarks
From	To		
0	260	Surface Clay- Sand	Ran 12 jts of 20# 8 5/8" csg set @ 481' Cemented w/300 aka 60/40 Posmix 2% Gel 3% CC PD @ 12:30 a.m. 5-17-80
260	485	Redbed	
485	1035	Redbed-Shale	
1035	2190	Shale	
2190	2715	Lime-Shale	
2715	2820	Shale-Lime	
2820	4169	Lime-Shale	
4169	4285	Lime	
4285	4493	Lime-Shale	
4493	4560	Lime	
4560	4680	Lime-Shale	
4680	4695	Lime	
4695	4700	Lime-Shale	
	4700 - TD		

COUNTY OF SEDGWICK)
) SS
 STATE OF KANSAS)

I, the undersigned, being duly sworn on oath, state that the above
 Drillers' Well Log is true and correct to the best of my knowledge and belief and
 according to the records of this office.

GABBERT-JONES, INC.

James S. Sutton II
 JAMES S. SUTTON II

Subscribed and sworn to before me this 29th day of May, 1980.

Elizabeth J. Edwards
 ELIZABETH J. EDWARDS-NOTARY PUBLIC

My Commission expires February 6, 1983.



RECEIVED
 STATE CORPORATION COMMISSION

AUG 27 1980

CONSERVATION DIVISION
 Wichita, Kansas

15-151-20730-00-00

KANSAS

WELL COMPLETION REPORT AND DRILLER'S LOG

API No. 15 _____ County _____ Number _____

S. _____ T. _____ R. _____ E _____
 W _____
 Loc. _____
 County _____

Operator
 Trick, Fletcher & Antares Oil.

Address
 P. O. Box 1408 Longview, TX 75601

Well No. _____ Lease Name
 1 Kinney Estate

Footage Location
 feet from (N) (S) line _____ feet from (E) (W) line _____

Principal Contractor _____ Geologist _____

Spud Date _____ Date Completed _____ Total Depth _____ P.B.T.D. _____

Directional Deviation _____ Oil and/or Gas Purchaser _____

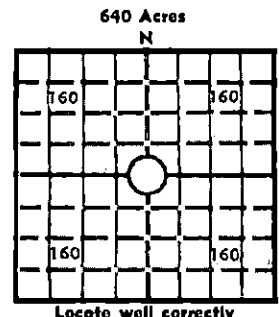

Elev.: Gr. _____
 DF _____ KB _____

CASING RECORD

Report of all strings set — surface, intermediate, production, etc.

Purpose of string	Size hole drilled	Size casing set (in O.D.)	Weight lbs/ft.	Setting depth	Type cement	Sacks	Type and percent additives
Surface	8 5/8		24#	481	60/40 Poz 2% Ce 1 3%CC	300 sks	

LINER RECORD

PERFORATION RECORD

Top, ft.	Bottom, ft.	Sacks cement	Shots per ft.	Size & type	Depth interval

TUBING RECORD

Size	Setting depth	Packer set at

ACID, FRACTURE, SHOT, CEMENT SQUEEZE RECORD

Amount and kind of material used	Depth interval treated

INITIAL PRODUCTION

Date of first production _____	Producing method (flowing, pumping, gas lift, etc.) _____
RATE OF PRODUCTION PER 24 HOURS	Oil _____ Gas _____ Water _____
Disposition of gas (vented, used on lease or sold) _____	Producing interval (s) _____

RECEIVED
 STATE CORPORATION COMMISSION
 AUG 27 1980
 CONSERVATION DIVISION
 Wichita, Kansas
 Gas-oil ratio _____
 bbls. _____ CFPB

INSTRUCTIONS: As provided in KCC Rule 82-2-125, within 90 days after completion of a well, one completed copy of this Drillers Log shall be transmitted to the State Geological Survey of Kansas, 4150 Monroe Street, Wichita, Kansas 67209. Copies of this form are available from the Conservation Division, State Corporation Commission, 245 No. Water, Wichita, Kansas 67202. Phone AC 316-522-2206. If confidential custody is desired, please note Rule 82-2-125. Drillers Logs will be on open file in the Oil and Gas Division, State Geological Survey of Kansas, Lawrence, Kansas 66044.

Operator

DESIGNATE TYPE OF COMP.: OIL, GAS, DRY HOLE, SWDW, ETC.:

Well No.

Lease Name

S _____ T _____ R _____ E _____ W _____

WELL LOG

Show all important zones of porosity and contents thereof; cored intervals, and all drill-stem tests, including depth interval tested, cushion used, time tool open, flowing and shut-in pressures, and recoveries.

SHOW GEOLOGICAL MARKERS, LOGS RUN, OR OTHER DESCRIPTIVE INFORMATION.

FORMATION DESCRIPTION, CONTENTS, ETC.	TOP	BOTTOM	NAME	DEPTH

USE ADDITIONAL SHEETS, IF NECESSARY, TO COMPLETE WELL RECORD.

Date Received

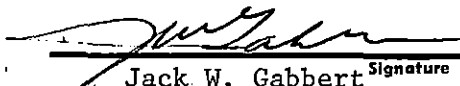

Jack W. Gabbert Signature

Vice President

Title

Date
8-26-80