

STATE CORPORATION COMMISSION OF KANSAS  
OIL & GAS CONSERVATION DIVISION  
WELL COMPLETION OR RECOMPLETION FORM  
ACO-1 WELL HISTORY  
DESCRIPTION OF WELL AND LEASE

S

API NO. 15-095-21,597-0000  
County.. Kingman  
C... SE... SE... Sec. 31... Twp. 30... Rge. 7... XX West

Operator: License # 5399  
Name American Energies Corp  
Address 155 N. Market  
Suite 710  
City/State/Zip Wichita, KS. 67202

660 Ft North from Southeast Corner of Section  
600 Ft West from Southeast Corner of Section  
(Note: Locate well in section plat below)

Purchaser.....

Lease Name... KUB... Well #... 1  
Field Name... Washbon

Operator Contact Person Alan L. DeGood  
Phone (316) 263-5785

Producing Formation... Mississippi and Simpson  
Elevation: Ground... 1616... 1621 KB

Contractor: License # 5418  
Name Allen Drilling Company

Wellsite Geologist John Christiansen  
Phone.....

Designate Type of Completion  
X New Well Re-Entry Workover  
Oil SWD Temp Abd  
Gas Inj Delayed Comp.  
X Dry Other (Core, Water Supply etc.)  
If OWWO: old well info as follows:  
Operator  
Well Name  
Comp. Date Old Total Depth

RECEIVED  
STATE CORPORATION COMMISSION

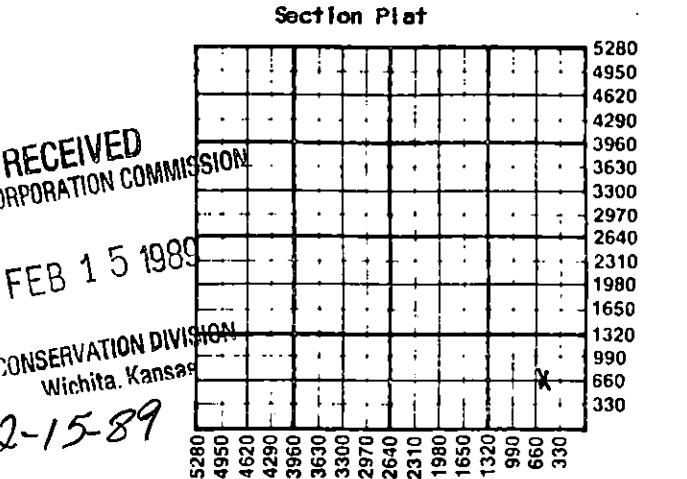

FEB 15 1989

CONSERVATION DIVISION  
Wichita, Kansas

2-15-89

WATER SUPPLY INFORMATION

Disposition of Produced Water: Disposal  
Docket # Repressuring

Questions on this portion of the ACO-1 call:  
Water Resources Board (913) 296-3717

Source of Water:  
Division of Water Resources Permit # T88-620

X Groundwater... 560 Ft North from Southeast Corner  
(Well) ... 560 Ft West from Southeast Corner of  
31 Sec 30 Twp 7 Rge East X West

Surface Water... Ft North from Southeast Corner  
(Stream, pond etc)... Ft West from Southeast Corner  
Sec Twp Rge East West

Other (explain).....  
(purchased from city, R.W.D. #)

WELL HISTORY

Drilling Method:  
X Mud Rotary Air Rotary Cable  
1/5/89 1/14/89 1-14-89  
Spud Date Date Reached TD Completion Date  
4753'  
Total Depth PBTD  
Amount of Surface Pipe Set and Cemented at 265 feet  
Multiple Stage Cementing Collar Used? Yes X No  
If yes, show depth set... feet  
If alternate 2 completion, cement circulated  
from... feet depth to... w/... SX cmt  
Cement Company Name  
Invoice #  
A/I U/O

INSTRUCTIONS: This form shall be completed in triplicate and filed with the Kansas Corporation Commission, 200 Colorado Derby Building, Wichita, Kansas 67202, within 120 days of the spud date of any well. Rule 82-3-130, 82-3-107 and 82-3-106 apply. Information on side two of this form will be held confidential for a period of 12 months if requested in writing and submitted with the form. See rule 82-3-107 for confidentiality in excess of 12 months. One copy of all wireline logs and drillers time log shall be attached with this form. Submit CP-4 form with all plugged wells. Submit CP-111 form with all temporarily abandoned wells.

All requirements of the statutes, rules and regulations promulgated to regulate the oil and gas industry have been fully complied with and the statements herein are complete and correct to the best of my knowledge.

Signature Alan L. DeGood  
Title Vice-President Date 2-14-89

Subscribed and sworn to before me this 14th day of February 1989  
Notary Public Melinda S. Wooten  
Date Commission Expires 3-12-92

K.C.C. OFFICE USE ONLY  
F Letter of Confidentiality Attached  
C Wireline Log Received  
C Drillers Timelog Received  
Distribution  
KCC SWD/Rep NGPA  
KGS Plug Other  
(Specify)  
2-15-89



Sec 31, Twp 30, Rge 7, W

Operator Name American Energies Corp Lease Name KUB Well # 1

Sec 31 Twp 30 Rge 7 East West County Kingman

WELL LOG

INSTRUCTIONS: Show important tops and base of formations penetrated. Detail all cores. Report all drill stem tests giving interval tested, time tool open and closed, flowing and shut-in pressures, whether shut-in pressure reached static level, hydrostatic pressures, bottom hole temperature, fluid recovery, and flow rates if gas to surface during test. Attach extra sheet if more space is needed. Attach copy of log.

Drill Stem Tests Taken [X] Yes [ ] No
Samples Sent to Geological Survey [X] Yes [ ] No
Cores Taken [ ] Yes [X] No

Formation Description [ ] Log [ ] Sample

DST #1: 3861-3880 (Kansas City "B"), 30-60-30-60. 1st opening: strong blow off bottom in 1". 2nd opening: strong blow off bottom in 1". GTS in 5' into final shutin. Recovered 190' M&WCGO (30% Oil, 35% Gas, 15% Wtr, 20% Mud), 780' GSW with scum of oil. IFP: 142-325#, ISIP: 1510#, FFP: 406-548#, FSIP: 1510#. DST #2: 3968-3985 (Swope), 30-60-30-60. 1st opening: strong blow off bottom in 10". 2nd opening: strong blow off bottom in 6" GTS TSTM. Rec. 360' GIP, 70' HOGCMW (20% Oil, 5% Gas, 30% Mud, 45% Wtr), 60' GCMW (10% Gas, 30% Oil, 60% Wtr). IFP: 41-91#, ISIP: 1520#, FFP: 111-111, FSIP: 1520#. DST #3: 4736-4753 (Simpson), 30-60-30-60. Recovered 160' MW, 900' SW. IFP: 101-315#, ISIP: 1752#, FFP: 386-538#, FSIP: 1752#.

Table with 3 columns: Name, Top, Bottom. Rows include Heebner Shale, Lansing, Kansas City, Stark Shale, Swope Porosity, Hertha, Cherokee Shale, Mississippi, Kinderhook Sh., Viola, Simpson SS.

CASING RECORD [X] New [ ] Used
Report all strings set-conductor, surface, intermediate, production, etc.
PERFORATION RECORD
Acid, Fracture, Shot, Cement Squeeze Record
TUBING RECORD
Date of First Production
Producing Method
Estimated Production Per 24 Hours

METHOD OF COMPLETION Production Interval

Disposition of gas: [ ] Vented [ ] Sold [ ] Used on Lease [ ] Open Hole [ ] Other (Specify) [ ] Perforation [ ] Dually Completed [ ] Commingled

