

10/15/85
10-13-86

STATE CORPORATION COMMISSION OF KANSAS
OIL & GAS CONSERVATION DIVISION

WELL COMPLETION OR RECOMPLETION FORM
ACO-1 WELL HISTORY

DESCRIPTION OF WELL AND LEASE

CONFIDENTIAL

Operator: License # 5415
Name Tenneco Oil Company
Address 139 Ciudad Bldg.
3000 United Founders Blvd.
City/State/Zip Oklahoma City, OK 73112

Purchaser Permian

Operator Contact Person Randy Yost
Phone (405) 848-8551

Contractor: License # 5107
Name H-30, Inc.

Wellsite Geologist
Phone

Designate Type of Completion
 New Well Re-Entry Workover

Oil SWD Temp Abd
 Gas Inj Delayed Comp.
 Dry Other (Core, Water Supply etc.)

If OWNO: old well info as follows:
Operator
Well Name
Comp. Date Old Total Depth

WELL HISTORY

Drilling Method:
 Mud Rotary Air Rotary Cable

6-18-85 7-11-85 7-13-85
Spud Date Date Reached TD Completion Date
7170 7076
Total Depth PBTD

Amount of Surface Pipe Set and Cemented at 1250 feet
Multiple Stage Cementing Collar Used? Yes No
If yes, show depth set...feet
If alternate 2 completion, cement circulated from...feet depth to...w/...SX cmt

API No. 15-025-20-912-0000
County Clark
NW SW Sec 7 Twp 33 Rge 25 East West

1011 Ft North from Southeast Corner of Section
1950 Ft West from Southeast Corner of Section
(Note: Locate well in section plat below)

Lease Name Pyla Well # 1-7
Field Name Wildcat

Producing Formation Viola

Elevation: Ground 2182 KB 2194

Section Plat

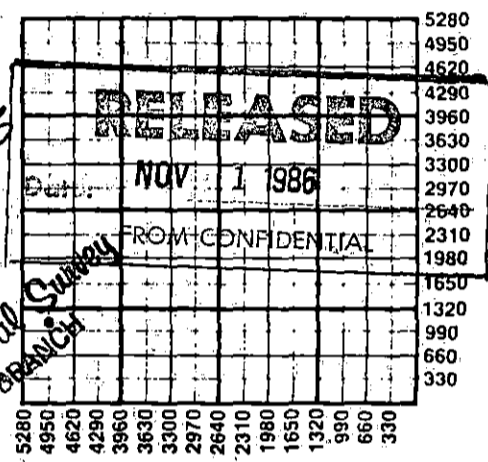

10-11-85
OCT 11 1985
State Geological Survey
WICHITA BRANCH

WATER SUPPLY INFORMATION

Disposition of Produced Water: Disposal Repressuring
Docket #

Questions on this portion of the ACO-1 call:
Water Resources Board (913) 296-3717

Source of Water:
Division of Water Resources Permit #

Groundwater...Ft North from Southeast Corner (Well) ...Ft West from Southeast Corner of Sec Twp Rge East West

Surface Water...Ft North from Southeast Corner (Stream, pond etc)...Ft West from Southeast Corner Sec Twp Rge East West

Other: (explain) (purchased from city, R.W.D. #)

INSTRUCTIONS: This form shall be completed in duplicate and filed with the Kansas Corporation Commission, 200 Colorado Derby Building, Wichita, Kansas 67202, within 90 days after completion or recompletion of any well. Rule 82-3-130 and 82-3-107 apply. Information on side two of this form will be held confidential for a period of 12 months if requested in writing and submitted with the form. See rule 82-3-107 for confidentiality in excess of 12 months. One copy of all wireline logs and drillers time log shall be attached with this form. Submit CP-4 form with all plugged wells. Submit CP-111 form with all temporarily abandoned wells.

All requirements of the statutes, rules and regulations promulgated to regulate the oil and gas industry have been fully complied with and the statements herein are complete and correct to the best of my knowledge.

Signature Duane K Gandy
Title Production Analyst II Date Sept. 3, 1985

Subscribed and sworn to before me this 3rd day of September 1985.
Notary Public Jana Dee Smart
Date Commission Expires April 15, 1988

K.C.C. OFFICE USE ONLY
 Letter of Confidentiality Attached
 Wireline Log Received
 Drillers Timelog Received
Distribution
 KCC SWD/Rep NGPA
 KGS Plug Other (Specify)
RECEIVED
STATE CORPORATION COMMISSION

OCT 8 1985

NJ 8675

Operator Name Tenneco Oil Company Lease Name Pyle Well # 1-7

Sec. 7 Twp. 33 Rge. 25 East West County Clark

WELL LOG

INSTRUCTIONS: Show important tops and base of formations penetrated. Detail all cores. Report all drill stem tests giving interval tested, time tool open and closed, flowing and shut-in pressures, whether shut-in pressure reached static level, hydrostatic pressures, bottom hole temperature, fluid recovery, and flow rates if gas to surface during test. Attach extra sheet if more space is needed. Attach copy of log.

Drill Stem Tests Taken Yes No
 Samples Sent to Geological Survey Yes No
 Cores Taken Yes No

Formation Description
 Log Sample

DST #1 - Depth 4520' RIH w/tools - btm pkr. @ 4496'; gas to surf. 1st flow period 30 mcf, 10 mcf on 2nd flow; POOH 3260' gas cut mud 8 oil.
 DST #2 - Depth 5047' RIH w/tools set @ 5004' recvd. 560' SW.
 DST #3 - Depth 6761' RIH w/tools pkr. @ 6736' 4-3/4 hr. - FTP 80 psi on 1/4" chk, est. 118 MCF/D; init. SI SI btmp 2465 psi @ 6708'; final flow mar. TP-48 FTP-46 on 1/4" chk; final SI BP 2447 psi; rec'd. 2316' of gas cut oil; ~10 BBLS 44° API @ 60°F.

Name	Top	Bottom
Red bed	0'	630'
Red bed & shale	630'	1200'
Red bed & sand	1200'	1256'
Lime, sand, red bed	1256'	1756'
Shale & lime	1756'	2286'
Red bed & shale	2286'	2410'
Shale & sand	2410'	2875'
Shale & shell	2875'	3105'
Shale & sand	3105'	3197'
Lime & shale	3197'	3212'
Shale	3212'	3610'
Lime & shale	3610'	3790'
Shale	3790'	4052'
Lime & shale	4052'	4454'
Lime	4454'	4520'
Shale & lime	4520'	4620'
Lime	4620'	4745'
Lime & shale	4745'	4930'
Lime	4930'	5047'
Lime & shale	5047'	5252' (see attached)

CONFIDENTIAL

CASING RECORD <input checked="" type="checkbox"/> New <input type="checkbox"/> Used Report all strings set-conductor, surface, intermediate, production, etc.							
Purpose of String	Size Hole Drilled	Size Casing Set (in O.D.)	Weight Lbs/Ft.	Setting Depth	Type of Cement	#Sacks Used	Type and Percent Additives
...SURFACE...	12-1/4"	8-5/8"	24#	1250'	Lite Class H	435	2% cc
...PRODUCTION...	7-7/8"	5-1/2"	15.5#	7169'	65/35	600	2% gel
PERFORATION RECORD				Acid, Fracture, Shot, Cement Squeeze Record			
Shots Per Foot	Specify Footage of Each Interval Perforated			(Amount and Kind of Material Used)		Depth	
4	6834 - 6844			1000 gals 7-1/2% Sequestered		6834'	
4	6742 - 6748			750 gals 7-1/2% FE Acid		6742'	
TUBING RECORD				Liner Run <input type="checkbox"/> Yes <input checked="" type="checkbox"/> No			
Size		Set At	Packer at	RELEASED			
2-7/8"		6773	6658'				
Date of First Production		Producing Method					
8-17-85		<input type="checkbox"/> Flowing <input checked="" type="checkbox"/> Pumping <input type="checkbox"/> Other (explain).....					
Estimated Production Per 24 Hours		Oil	Gas	Water	Gas-Oil Ratio	Gravity	
88 Bbls		0 MCF	336 Bbls	--	CFPB	41.4	

METHOD OF COMPLETION

Production Interval

Disposition of gas: Vented Open Hole Perforation
 Sold Other (Specify)
 Used on Lease Dually Completed Commingled

6834-6844

Viola

CONFIDENTIAL

SIDE TWO (Page Two)

ACO-1 WELL HISTORY

OPERATOR Tenneco Oil Company LEASE NAME Pyle #1-7

SEC. 7 TWP. 33 RGE. 25 X000 (W)

FILL IN WELL LOG AS REQUIRED:

Show all important zones of porosity and contents thereof; cased intervals, and all drill-stem tests, including depth interval tested, cushion used, time tool open, flowing and shut-in pressures, and recoveries.

SHOW GEOLOGICAL MARKERS, LOGS RUN, OR OTHER DESCRIPTIVE INFORMATION.

FORMATION DESCRIPTION, CONTENTS, ETC.	TOP	BOTTOM	NAME	DEPTH
From Page 1				
Lime	5252'	6165'		
Lime & shale	6165'	6410'		
Lime	6410'	6477'		
Lime & shale	6477'	6609'		
Lime	6609'	6799'		
Lime & chert	6799'	6883'		
Lime	6883'	7170'		
Rotary total depth	7170'			

OCT 11 1985
State Geological Survey
WICHITA BRANCH

RECEIVED
STATE CORPORATION COMMISSION

OCT 8 1985

CONSERVATION DIVISION
Wichita Kansas