

STATE CORPORATION COMMISSION OF KANSAS  
OIL & GAS CONSERVATION DIVISION  
WELL COMPLETION OR RECOMPLETION FORM  
ACO-1 WELL HISTORY  
DESCRIPTION OF WELL AND LEASE

API No. 15-025-20837-00-00  
County... Clark  
...SW...SE...SW... Sec 4... Twp. 30S... Rge. 25W East West

Operator: License # 5171  
Name TXO Production Corp.  
Address 200 W. Douglas, Suite 300

400 Ft North from Southeast Corner of Section  
3380 Ft West from Southeast Corner of Section  
(Note: Locate well in section plat below)

City/State/Zip Wichita, KS 67202  
\*Transferred to Murfin Drlg. Co. 5/8/85  
Purchaser n/a  
Murfin Drilling Co.

Lease Name Norton "E" Well # 4  
Field Name Norcan East ~~Ext~~  
Producing Formation Morrow

Operator Contact Person Larry M. Jack  
Phone 267-3241

Elevation: Ground 2571' KB 2583'

Contractor: License # 5106  
Name Freeman Drilling, Inc.

Wellsite Geologist Scott Banks  
Phone 267-0783

Designate Type of Completion  
 New Well  Re-Entry  Workover  
 Oil  SWD  Temp Abd  
 Gas  Inj  Delayed Comp.  
 Dry  Other (Core, Water Supply etc.)

If ~~OWO~~: old well info as follows:  
Operator  
Well Name  
Comp. Date  
Old Total Depth

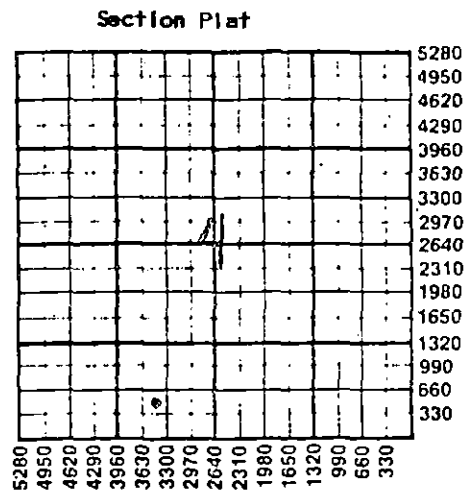

WATER SUPPLY INFORMATION  
Disposition of Produced Water:  Disposal  
Docket #  Repressuring

Questions on this portion of the ACO-1 call:  
Water Resources Board (913) 296-3717  
Source of Water:  
Division of Water Resources Permit #  
 Groundwater... Ft North from Southeast Corner (Well) ... Ft West from Southeast Corner of Sec Twp Rge East West  
 Surface Water... Ft North from Southeast Corner (Stream, pond etc.) ... Ft West from Southeast Corner Sec Twp Rge East West  
 Other (explain) (purchased from city, R.W.D. #)

WELL HISTORY  
Drilling Method:  Mud Rotary  Air Rotary  Cable  
9/4/84 9/23/84 10/18/84  
Spud Date Date Reached TD Completion Date  
5500' 5391'  
Total Depth PBTD  
Amount of Surface Pipe Set and Cemented at 633 feet  
Multiple Stage Cementing Collar Used?  Yes  No  
If yes, show depth set... feet  
If alternate 2 completion, cement circulated from... feet depth to... w/... SX cmt  
Cement Company Name  
Invoice #

INSTRUCTIONS: This form shall be completed in triplicate and filed with the Kansas Corporation Commission, 200 Colorado Derby Building, Wichita, Kansas 67202, within 120 days of the spud date of any well. Rule 82-3-130, 82-3-107 and 82-3-106 apply. Information on side two of this form will be held confidential for a period of 12 months if requested in writing and submitted with the form. See rule 82-3-107 for confidentiality in excess of 12 months. One copy of all wireline logs and drillers time log shall be attached with this form. Submit CP-4 form with all plugged wells. Submit CP-111 form with all temporarily abandoned wells.

All requirements of the statutes, rules and regulations promulgated to regulate the oil and gas industry have been fully complied with and the statements herein are complete and correct to the best of my knowledge.

Signature By: Larry M. Jack  
Larry M. Jack  
Title Eastern Div., Prod. Mgr. Date 9/21/87

Subscribed and sworn to before me this 21 day of Sept. 1987  
Notary Public: Kerran Redington  
Date Commission Expires 2/6/90

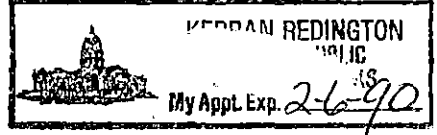

K.C.C. OFFICE USE ONLY  
F  Letter of Confidentiality Attached  
C  Wireline Log Received  
C  Drillers Time Log Received  
Distribution  
 KCC  SWD/Rep  NGPA  
 KGS  Plug  Other  
RECEIVED (Specify)  
STATE CORPORATION COMMISSION  
SEP 22 1987

Form ACO-1 (5-86) 9-22-87  
CONSERVATION DIVISION  
Wichita, Kansas

NS 8675

Operator Name \*TXO Production Corp..... Lease Name... Norton "E"..... Well #... 14...  
 \*Transferred to Murfin Drilling Co. 5/8/85  
 Sec. 4..... Twp. 30S..... Rge. 25W.....  East  West County... Clark.....

WELL LOG

INSTRUCTIONS: Show important tops and base of formations penetrated. Detail all cores. Report all drill stem tests giving interval tested, time tool open and closed, flowing and shut-in pressures, whether shut-in pressure reached static level, hydrostatic pressures, bottom hole temperature, fluid recovery, and flow rates if gas to surface during test. Attach extra sheet if more space is needed. Attach copy of log.

Drill Stem Tests Taken  Yes  No  
 Samples Sent to Geological Survey  Yes  No  
 Cores Taken  Yes  No

Formation Description  
 Log  Sample

None

Name	Top	Bottom
Herrington	2730'	(-147')
Heebner	4384'	(-1801')
Lansing	4501'	(-1918')
Stark	4902'	(-2319')
B/KC	5024'	(-2441')
Marmaton	5038'	(-2455')
Pawnee	5132'	(-2549')
Cherokee	5180'	(-2597')
B. Inola	5300'	(-2717')
Morrow Sd.	5339'	(-2756')
Miss	5401'	(-2819')
RTD	5500'	

CASING RECORD <input checked="" type="checkbox"/> New <input type="checkbox"/> Used							
Report all strings set-conductor, surface, intermediate, production, etc.							
Purpose of String	Size Hole Drilled	Size Casing Set (In O.D.)	Weight Lbs/Ft.	Setting Depth	Type of Cement	#Sacks Used	Type and Percent Additives
Surface	12 1/2"	8 5/8"	23#	633'	Common Lite	150 350	2% gel, 3% GC
Prod.	7 7/8"	4 1/2"	10.5#	5499'	Thixotropic	150	-
PERFORATION RECORD				Acid, Fracture, Shot, Cement Squeeze Record			
Shots Per Foot	Specify Footage of Each Interval Perforated			(Amount and Kind of Material Used)		Depth	
4	5339-44'			Frac w/5000 gal. diesel + 6500# 20/40 sand + 226,000 SCF N <sub>2</sub>		5339-44'	
TUBING RECORD				Liner Run <input type="checkbox"/> Yes <input type="checkbox"/> No			
Date of First Production		Size	Set At	Packer at			
T&A		2 3/8"	5337'				
Date of First Production		Producing Method					
		<input type="checkbox"/> Flowing <input type="checkbox"/> Pumping <input type="checkbox"/> Gas Lift <input type="checkbox"/> Other (explain).....					
Estimated Production Per 24 Hours		Oil	Gas	Water	Gas-Oil Ratio	Gravity	
		---	---	---	---	---	
		Bbls	MCF	Bbls	CFPB		

METHOD OF COMPLETION

Production Interval

Disposition of gas:  Vented  Sold  Used on Lease  
 Open Hole  Perforation  Other (Specify) .....  
 Dually Completed  Conmingled

as above  
 .....  
 .....

W. R. MURFIN

**MURFIN**

**MURFIN  
DRILLING  
COMPANY**



**CONTRACTORS AND PRODUCERS**

September 21, 1987

State Corporation Commission  
200 Colorado Derby Bldg.  
Wichita, KS 67202

Re: Change of Operator

Gentlemen:

Please be advised that effective May 8, 1985, Murfin Drilling Company took over operations of the Norton "E" #1-4 well, located SW SE SW Sec. 4-30S-25W; Clark County, KS, from TXO Production Corp.

Enclosed your will find ACO-1 Well Completion Report and CP-111 Temporary Abandoned report.

Sincerely,

MURFIN DRILLING COMPANY

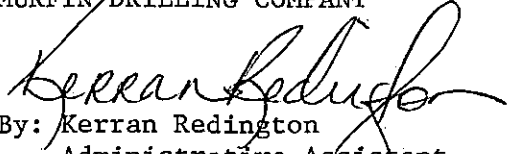
  
By: Kerran Redington  
Administrative Assistant  
Production Records

/kr  
Enclosures

RECEIVED  
STATE CORPORATION COMMISSION

SEP 22 1987

CONSERVATION DIVISION  
Wichita, Kansas