

NOTICE OF INTENTION TO DRILL

ALL BLANKS MUST BE FILLED

Must be approved by the K.C.C. five (5) days prior to commencing well

* 156'S & 106'E of

Expected Spud Date..... February 20, 1991.....
month day year

.....C. NW NE. Sec 31.. Twp 29. S, Rg 13W. X East West

OPERATOR: License # 5056.....
Name: F. G. HOLL COMPANY.....
Address: P.O. BOX 780167.....
City/State/Zip: Wichita, KS 67278-0167.....
Contact Person: Elwyn H. Nagel.....
Phone: (316) 684-8481.....

* 4464..... feet from South line of Section
1874..... feet from East line of Section
(Note: Locate well on Section Plat on Reverse Side)

CONTRACTOR: License #: 5142.....
Name: Sterling Drilling Company.....

County: Pratt.....
Lease Name: DORIS LAMBERT Well #: "A" #1-31.....
Field Name: Jem.....

Well Drilled For: Well Class: Type Equipment:
 Oil ... Inj Infield Mud Rotary
 Gas ... Storage ... Pool Ext. ... Air Rotary
... OWWO ... Disposal ... Wildcat ... Cable
... Seismic; ... # of Holes

Is this a Prorated Field? ... yes no
Target Formation(s): Simpson Sd, Arbuckle.....
Nearest lease or unit boundary: 554'
Ground Surface Elevation: 1924'..... feet MSL
Domestic well within 330 feet: ... yes no
Municipal well within one mile: ... yes no
Depth to bottom of fresh water: 180'
Depth to bottom of usable water: 220'
Surface Pipe by Alternate: 1 ... 2
Length of Surface Pipe Planned to be set: 275'
Length of Conductor pipe required: NA
Projected Total Depth: 4750'
Formation at Total Depth: Arbuckle

If OWWO: old well information as follows:
Operator:
Well Name:
Comp. Date: Old Total Depth

Water Source for Drilling Operations:
 well ... farm pond ... other
DWR Permit #: (Applied for by Sterling Drilling)
Will Cores Be Taken?: ... yes no
If yes, proposed zone:

Directional, Deviated or Horizontal wellbore? ... yes no
If yes, total depth location:

WAS: 150' SE of N4WNE, 4514' FSL

AFFIDAVIT

The undersigned hereby affirms that the drilling, completion and eventual plugging of this well will comply with K.S.A. 55-101, et. seq.

It is agreed that the following minimum requirements will be met:

1. The appropriate district office shall be notified before setting surface pipe;
2. The minimum amount of surface pipe as specified above shall be set by circulating cement to the top; in all cases surface pipe shall be set through all unconsolidated materials plus a minimum of 20 feet into the underlying formation;
3. If the well is dry, a plugging proposal shall be submitted to the district office. An agreement between the operator and the district office on plug length and placement is necessary prior to plugging;
4. The appropriate district office will be notified before well is either plugged or production casing is cemented in;
5. If an Alternate II completion, production pipe shall be cemented from below any usable water to surface within 120 days of spud date. In all cases, notify district office prior to any cementing.

I hereby certify that the statements made herein are true and to the best of my knowledge and belief.

Date: 2/4/91..... Signature of Operator or Agent: Brent B. Reinhardt..... Title: Geologist
6/20/91

FOR KCC USE:	
API # 15-	151-22,035-00-00
Conductor pipe required	None feet
Minimum surface pipe required	240 feet per Alt. 1 2
Approved by:	MPW 2/7/91 <i>Da</i> 6-25-91
EFFECTIVE DATE:	2/12/91
This authorization expires:	8/7/91
(This authorization void if drilling not started within 6 months of effective date.)	
Spud date:	Agent:

STATE OF KANSAS
RECEIVED
CONSERVATION DIVISION
Wichita, Kansas
JUN 24 1991
06-249

31
29
13

REMEMBER TO:

- File Drill Pit Application (form CDP-1) with Intent to Drill;
- File Completion Form ACO-1 within 120 days of spud date;
- File acreage attribution plat according to field proration orders;
- Notify appropriate district office 48 hours prior to workover or re-entry;
- Submit plugging report (CP-4) after plugging is completed;
- Obtain written approval before disposing or injecting salt water.

PLAT OF ACREAGE ATTRIBUTABLE TO A WELL

"corrected copy"
 *=Corrected Portions

State Corporation Commission, Conservation Division
 200 Colorado Derby Bldg. Wichita, Kansas 67202

OPERATOR F. G. HOLL COMPANY LOCATION OF WELL:
 LEASE DORIS LAMBERT "A" * 4464 feet north of SE corner
 WELL NUMBER #1-31 1874 feet west of SE corner
 FIELD Jem Sec. 31 T 29s R 13w E/W
 COUNTY Pratt
 NO. OF ACRES ATTRIBUTABLE TO WELL NA IS SECTION X REGULAR IRREGULAR?
 DESCRIPTION OF ACREAGE NA IF IRREGULAR, LOCATE WELL FROM NEAREST
 CORNER BOUNDARY.

NOTE: If plat depicted is insufficient for your circumstances, you may attach your own scaled or surveyed plat.

PLAT

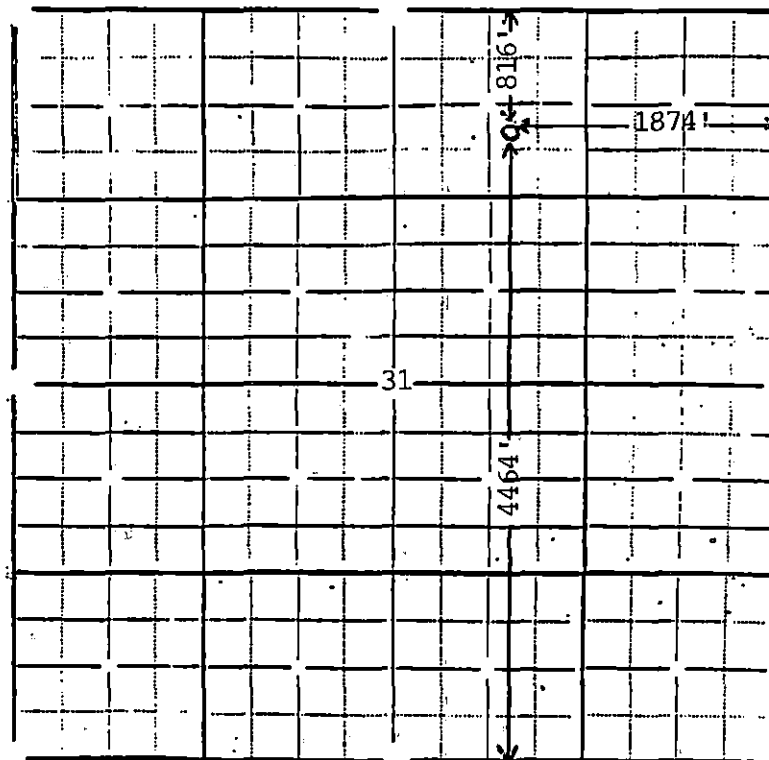

In plotting the proposed location of the well, you must show:

- 1) The manner in which you are using the depicted plat by identifying section lines, i.e. 1 section, 1 section with 8 surrounding partial sections, 4 sections, 16 sections, etc.;
- 2) the well's location relative to the location of other wells producing from the same common source of supply in adjoining drilling units, pursuant to K.A.R. 82-3-108, 82-3-207, 82-3-312, or special orders of the Commission;
- 3) the distance of the proposed drilling location from the section's east and south lines; and
- 4) the distance to the nearest lease or unit boundary line.

I hereby certify that the statements made herein are true and to the best of my knowledge and belief.

Signature of Operator or Agent Brent B. Reinhardt
 Date 6/20/91 Title Geologist