

EFFECTIVE DATE: 3-22-93

FORM MUST BE TYPED

DISTRICT 0 2

State of Kansas

FORM MUST BE SIGNED

55A7 Yes... No

NOTICE OF INTENTION TO DRILL

ALL BLANKS MUST BE FILLED

Must be approved by the K.C.C. five (5) days prior to commencing well

Expected Spud Date 03 19 93 month day year

Spot NW NE Sec 13 Twp 25 S Rg 9 East West

OPERATOR: License # 5058 Griggs Oil, Inc. 107 N. Market, Suite 800 Wichita, KS 67202 James G. Collins (316) 267-7779

660 2310 North line of Section foot from East

CONTRACTOR: License # 5142 Sterling Drilling Company

IS SECTION X REGULAR IRREGULAR?

(NOTE: Locate well on the Section Plat on Reverse Side)

County: Reno

Lease Name: Brooks Johnson Well #: 1-13

Field Name: W. Collins

Is this a Prorated/Spaced Field? yes X no

Target Formation(s): Mississippi

Nearest lease or unit boundary: 330'

Ground Surface Elevation: 1652 feet MSL

Water well within one-quarter mile: yes X no

Public water supply well within one mile: yes X no

Depth to bottom of fresh water: 145'

Depth to bottom of usable water: 145'

Surface Pipe by Alternate: X 1 2

Length of Surface Pipe Planned to be set: 165'

Length of Conductor pipe required: 0

Projected Total Depth: 4000

Formation at Total Depth: Kinderhook

Water Source for Drilling Operations: X well farm pond other

DWR Permit #: To be filed

Will Corros Be Taken?: yes X no

If yes, proposed zone:

Well Drilled For: Well Class: Type Equipment: X Oil Enh Rec Infield X Mud Rotary Gas Storage Pool Ext Air Rotary OWD Disposal X Wildcat Cable Seismic # of Holes Other

If OWD: old well information as follows: Operator: N/A Well Name: Comp. Date: Old Total Depth

Directional, Deviated or Horizontal wellbore? yes X no

If yes, true vertical depth:

Bottom Hole Location:

AFFIDAVIT

The undersigned hereby affirms that the drilling, completion and eventual plugging of this well will comply with K.S.A. 55-101, et. seq.

It is agreed that the following minimum requirements will be met:

- 1. Notify the appropriate district office prior to spudding of well;
2. A copy of the approved notice of intent to drill shall be posted on each drilling rig;
3. The minimum amount of surface pipe as specified below shall be set by circulating cement to the top; in all cases surface pipe shall be set through all unconsolidated materials plus a minimum of 20 feet into the underlying formation;
4. If the well is dry hole, an agreement between the operator and the district office on plug length and placement is necessary prior to plugging;
5. The appropriate district office will be notified before well is either plugged or production casing is cemented in;
6. IF AN ALTERNATE II COMPLETION, PRODUCTION PIPE SHALL BE CEMENTED FROM BELOW ANY USABLE WATER TO SURFACE WITHIN 120 DAYS OF SPUD DATE. IN ALL CASES, NOTIFY DISTRICT OFFICE PRIOR TO ANY CEMENTING.

I hereby certify that the statements made herein are true and to the best of my knowledge and belief.

Date: 3/16/93 Signature of Operator or Agent: James G. Collins Title: Vice President

FOZ KCC USE: API # 15- 155-21247-0000 Conductor pipe required None foot Minimum surface pipe required 165' feet per Alt. 0 X Approved by: CB 3-17-93 This authorization expires: 9-17-93 (This authorization void if drilling not started within 6 months of effective date.) Spud date: Agent:

REMEMBER TO:

- File Drill Pit Application (form CDP-1) with Intent to Drill;
- File Completion Form ACD-1 within 120 days of spud date;
- File acreage attribution plat according to field prorations orders;
- Notify appropriate district office 48 hours prior to workover or re-entry;
- Submit plugging report (CP-4) after plugging is completed;
- Obtain written approval before disposing or injecting salt water.

Mail to: Conservation Division, 200 Colorado Derby Building, 202 W. First St., Wichita, Kansas 67202-1286.

RECEIVED STATE CORPORATION COMMISSION 3-17-93 MAR 17 1993 CONSERVATION DIVISION Wichita, Kansas

13 25 9

IN ALL CASES PLOT THE INTENDED WELL ON THE PLAT BELOW.

PLAT OF ACREAGE ATTRIBUTABLE TO A WELL IN A PRORATED OR SPACED FIELD

If the intended well is in a prorated or spaced field, please fully complete this side of the form. If the intended well is in a prorated or spaced field complete the plat below showing that the well will be properly located in relationship to other wells producing from the common source of supply. Please show all the wells within 1 mile of the boundaries of the proposed acreage attribution unit for gas wells and within 1/2 mile of the boundaries of the proposed acreage attribution unit for oil wells.

API NO. 15- _____
 OPERATOR Griggs Oil, Inc.
 LEASE Brooks-Johnson
 WELL NUMBER 1-13
 FIELD _____

LOCATION OF WELL: COUNTY Reno
660 feet from south/north line of section
2310 feet from east/west line of section
 SECTION 13 TWP 25S RG 9W

NUMBER OF ACRES ATTRIBUTABLE TO WELL 40
 QTR/QTR/QTR OF ACREAGE C W/2 - NW - NE

IS SECTION X REGULAR or _____ IRREGULAR
IF SECTION IS IRREGULAR, LOCATE WELL FROM NEAREST CORNER BOUNDARY.

Section corner used: X NE - NW - SE - SW

PLAT

(Show location of the well and shade attributable acreage for prorated or spaced wells.)
 (Show footage to the nearest lease or unit boundary line.)

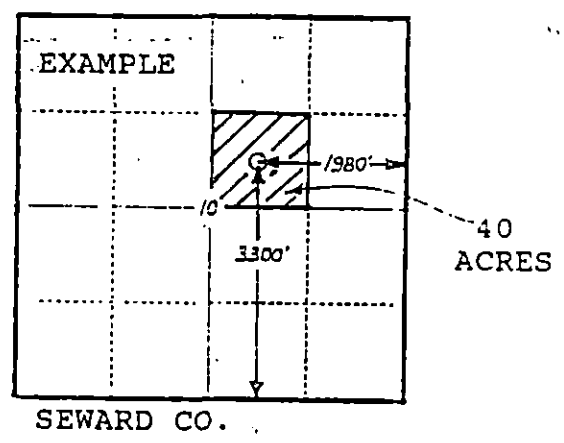
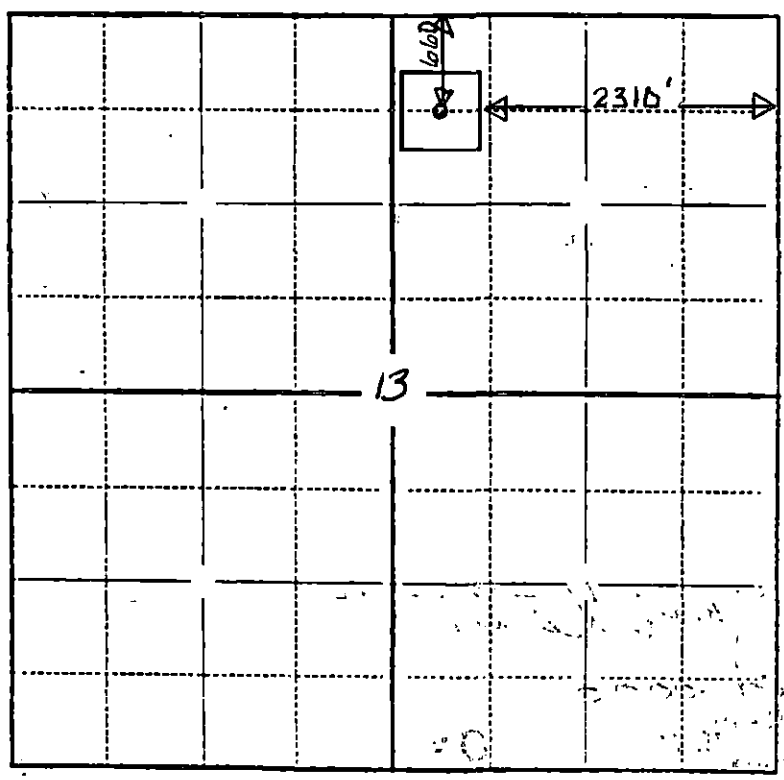

In plotting the proposed location of the well, you must show:

- 1) The manner in which you are using the depicted plat by identifying section lines, i.e. 1 section, 1 section with 8 surrounding sections, 4 sections, etc.;
- 2) the distance of the proposed drilling location from the section's south/north and east/west lines; and
- 3) the distance to the nearest lease or unit boundary line.