

FOR KCC USE:

FORM C-1 7/91

EFFECTIVE DATE: 9-15-91

State of Kansas
NOTICE OF INTENTION TO DRILL

FORM MUST BE TYPED
FORM MUST BE SIGNED
ALL BLANKS MUST BE FILLED

DISTRICT # 2
SSAT Yes... No

Must be approved by the K.C.C. five (5) days prior to commencing well

Expected Spud Date 09 12 91
month day year

Spot N/2 NE SE Sec 18 Twp 25 S, Rg 9 East West

OPERATOR: License # 5151
Name: Gear Petroleum Co., Inc.
Address: 125 N. Market, Suite 1075
City/State/Zip: Wichita, KS 67202
Contact Person: Jim Thatcher
Phone: (316) 265-3351

2310 feet from South North line of Section
660 feet from East West line of Section
IS SECTION REGULAR IRREGULAR

CONTRACTOR: License # 5929
Name: Duke Drilling Co.

(NOTE: Locate well on the Section Plat on Reverse Side)
County: Rego
Lease Name: J. R. Well # 1

Well Drilled For: Well Class: Type Equipment:
 Oil ... Enh Rec ... Infield Mud Rotary
... Gas ... Storage ... Pool Ext. ... Air Rotary
... OWMO ... Disposal Wildcat ... Cable
... Seismic; ... # of Holes ... Other
If OWMO: old well information as follows:
Operator: _____
Well Name: _____
Comp. Date: _____ Old Total Depth _____

Field Name: ~~Rego~~ LANG DOO
Is this a Prorated/Spaced Field? yes no

Target Formation(s): Mississippi
Nearest lease or unit boundary: 660'
Ground Surface Elevation: 1708 feet MSL

Directional, Deviated or Horizontal wellbore? ... yes no
If yes, true vertical depth: _____
Bottom Hole Location: _____

Water well within one-quarter mile: ... yes no
Public water supply well within one mile: ... yes no

Depth to bottom of fresh water: 100
Depth to bottom of usable water: 130

Surface Pipe by Alternate: 1 2
Length of Surface Pipe Planned to be set: 280

Length of Conductor pipe required: none
Projected Total Depth: 3950
Formation at Total Depth: Mississippi

Water Source for Drilling Operations:
... well ... farm pond other

DWR Permit #: _____
Will Cores Be Taken?: ... yes no
If yes, proposed zone: _____

AFFIDAVIT

The undersigned hereby affirms that the drilling, completion and eventual plugging of this well will comply with K.S.A. 55-101, et. seq.

It is agreed that the following minimum requirements will be met:

1. Notify the appropriate district office prior to spudding of well;
2. A copy of the approved notice of intent to drill shall be posted on each drilling rig;
3. The minimum amount of surface pipe as specified below shall be set by circulating cement to the top; in all cases surface pipe shall be set through all unconsolidated materials plus a minimum of 20 feet into the underlying formation;
4. If the well is dry hole, an agreement between the operator and the district office on plug length and placement is necessary prior to plugging;
5. The appropriate district office will be notified before well is either plugged or production casing is cemented in;
6. IF AN ALTERNATE II COMPLETION, PRODUCTION PIPE SHALL BE CEMENTED FROM BELOW ANY USABLE WATER TO SURFACE WITHIN 120 DAYS OF SPUD DATE. IN ALL CASES, NOTIFY DISTRICT OFFICE PRIOR TO ANY CEMENTING.

I hereby certify that the statements made herein are true and to the best of my knowledge and belief.

Date: 09/05/91 Signature of Operator or Agent: [Signature] Title Mgr. Drilling & Prod.

FOR KCC USE:
 API # 15- 155-21,177-0000
 Conductor pipe required None feet
 Minimum surface pipe required 150 feet per Alt. 1
 Approved by: [Signature] 9-10-91
 This authorization expires: 3-10-92
 (This authorization void if drilling not started within 6 months of effective date.)
 Spud date: _____ Agent: _____

RECEIVED
STATE CORPORATION COMMISSION

9-6-91
SEP 06 1991

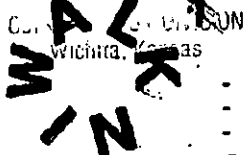

REMEMBER TO:

- File Drill Pit Application (form CDP-1) with Intent to Drill;
- File Completion Form ACO-1 within 120 days of spud date;
- File acreage attribution plat according to field proration orders;
- Notify appropriate district office 48 hours prior to workover or re-entry;
- Submit plugging report (CP-4) after plugging is completed;
- Obtain written approval before disposing or injecting salt water.

Mail to: Conservation Division, 200 Colorado Derby Building, 202 W. First St., Wichita, Kansas 67202-1286.

IN ALL CASES PLOT THE INTENDED WELL ON THE PLAT BELOW

PLAT OF ACREAGE ATTRIBUTABLE TO A WELL IN A PRORATED OR SPACED FIELD

If the intended well is in a prorated or spaced field, please fully complete this side of the form. If the intended well is in a prorated or spaced field complete the plat below showing that the well will be properly located in relationship to other wells producing from the common source of supply. Please show all the wells within 1 mile of the boundaries of the proposed acreage attribution unit for gas wells and within 1/2 mile of the boundaries of the proposed acreage attribution unit for oil wells.

API NO. 15- _____
OPERATOR Gear Petroleum Co., Inc.
LEASE J. R.
WELL NUMBER 1
FIELD wildcat

LOCATION OF WELL: COUNTY Reno
2310 feet from south/north line of section
660 feet from east/west line of section
SECTION 18 TWP 25S RG 9W

NUMBER OF ACRES ATTRIBUTABLE TO WELL 40
QTR/QTR/QTR OF ACREAGE _____ - NE - SE

IS SECTION X REGULAR or _____ IRREGULAR
IF SECTION IS IRREGULAR, LOCATE WELL FROM NEAREST CORNER BOUNDARY.

Section corner used: _____ NE _____ NW _____ SE _____ SW
PLAT

(Show location of the well and shade attributable acreage for prorated or spaced wells.)
(Show footage to the nearest lease or unit boundary line.)

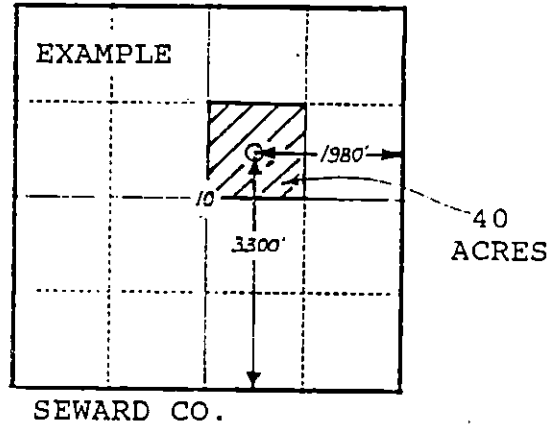
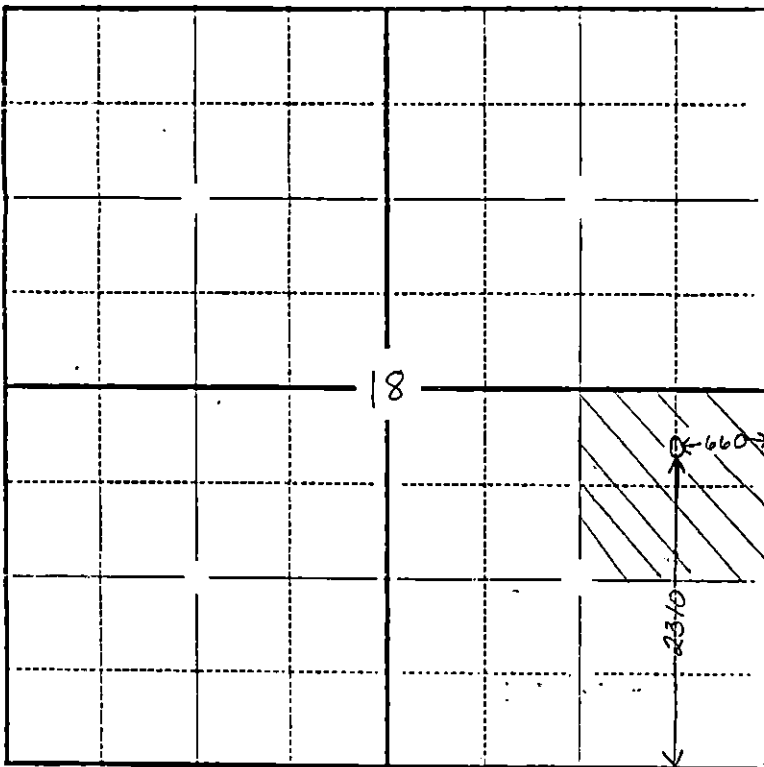

NOTE: No wells within 1/2 mile.

In plotting the proposed location of the well, you must show:

- 1) The manner in which you are using the depicted plat by identifying section lines, i.e. 1 section, 1 section with 8 surrounding sections, 4 sections, etc.;
- 2) the distance of the proposed drilling location from the section's south/north and east/west lines; and
- 3) the distance to the nearest lease or unit boundary line.

