

FOR KCC USE:

FORM C-1 7/9

FORM MUST BE TYPE

FORM MUST BE SIGNED

ALL BLANKS MUST BE FILLED

EFFECTIVE DATE: 1-23-96

State of Kansas

NOTICE OF INTENTION TO DRILL

Must be approved by the K.C.C. five (5) days prior to commencing well

DISTRICT # 2
SEAT Yes No

Expected Spud Date 01 20 1996
month day year

Spot SW SW Soc 14 Twp 25 S, Rg 9 Eas
SW SW Soc 14 Twp 25 S, Rg 9 Eas

OPERATOR: License # 5058
Name: Griggs Oil, Inc.
Address: 100 N. Main, Suite 1010
City/State/Zip: Wichita, KS 67202
Contact Person: Jim Collins
Phone: 316-267-7779

660 feet from South / North line of Section
660 feet from East / West line of Section
IS SECTION X REGULAR IRREGULAR?

(NOTE: Locate well on the Section Plat on Reverse Side.)
County: Reno
Lease Name: Hamilton HAMEL Well #: 1-14
Field Name: Langdon Extension

CONTRACTOR: License #: Sterling Drilling Co.
Name: 5142

Is this a Prorated/Spaced Field? yes X no
Target Formation(s): Mississippi

Well Drilled For: Well Class: Type Equipment:

X Oil ... Enh Rec ... Infield X Mud Rotary
Gas ... Storage ... Pool Ext. ... Air Rotary
OHWD ... Disposal ... Wildcat ... Cable
Seismic: # of Holes Other
Other

Nearest lease or unit boundary: 660
Ground Surface Elevation: 1665 feet HSL
Water well within one-quarter mile: yes X no
Public water supply well within one mile: yes X no

If OHWD: old well information as follows:
Operator: NA
Well Name:
Comp. Date: Old Total Depth

Depth to bottom of fresh water: 115
Depth to bottom of usable water: 140
Surface Pipe by Alternate: X 1 2

Directional, Deviated or Horizontal wellbore? yes X no
If yes, true vertical depth:
Bottom Hole Location:

Length of Surface Pipe Planned to be set: 160
Length of Conductor pipe required: 0
Projected Total Depth: 3950
Formation at Total Depth: Kinderhook

Water Source for Drilling Operations:
X well ... farm pond ... other

DNR Permit #: Applied for
Will Cores Be Taken? yes X no
If yes, proposed zone:

AFFIDAVIT

The undersigned hereby affirms that the drilling, completion and eventual plugging of this well will comply with K.S.A. 55-101, et. seq.

It is agreed that the following minimum requirements will be met:

- 1. Notify the appropriate district office prior to spudding of well;
- 2. A copy of the approved notice of intent to drill shall be posted on each drilling rig;
- 3. The minimum amount of surface pipe as specified below shall be set by circulating cement to the top; in all cases surface pipe shall be set through all unconsolidated materials plus a minimum of 20 feet into the underlying formation;
- 4. If the well is dry hole, an agreement between the operator and the district office on plug length and placement is necessary prior to plugging;
- 5. The appropriate district office will be notified before well is either plugged or production casing is cemented in;
- 6. IF AN ALTERNATE II COMPLETION, PRODUCTION PIPE SHALL BE CEMENTED FROM BELOW ANY USABLE WATER TO SURFACE WITHIN 120 DAYS OF SPUD DATE. IN ALL CASES, NOTIFY DISTRICT OFFICE PRIOR TO ANY CEMENTING.

I hereby certify that the statements made herein are true and to the best of my knowledge and belief.

Date: 12-18-95 Signature of Operator or Agent: Title: Vice President

FOR KCC USE:
API # 15- 155-213780000
Conductor pipe required NONE feet
Minimum surface pipe required 160' foot per Alt. (1) X
Approved by: JK 1-18-96
This authorization expires: 7-18-96
(This authorization void if drilling not started within 6 months of effective date.)
Spud date: Agent:

REMEMBER TO:

- File Drill Pit Application (form GDP-1) with Intent to Drill;
- File Completion Form ACO-1 within 120 days of spud date;
- File acreage attribution plat according to field proration orders;
- Notify appropriate district office 48 hours prior to workover or re-entry;
- Submit plugging report (CP-4) after plugging is completed;
- Obtain written approval before disposing or injecting salt water.

Mail to: Conservation Division, 200 Colorado Derby Building, 202 W. First St., Wichita, Kansas 67202-1286.

1-30-96 NOT RECORDED

RECEIVED
KANSAS CORPORATION COMMISSION
DEC 19 1995
12-19-95
CONSERVATION DIVISION
WICHITA, KS

14
25
95

IN ALL CASES PLOT THE INTENDED WELL ON THE PLAT BELOW

PLAT OF ACREAGE ATTRIBUTABLE TO A WELL IN A PRORATED OR SPACED FIELD

If the intended well is in a prorated or spaced field, please fully complete this side of the form. If the intended well is in a prorated or spaced field complete the plat below showing that the well will be properly located in relationship to other wells producing from the common source of supply. Please show all the wells within 1 mile of the boundaries of the proposed acreage attribution unit for gas wells and within 1/2 mile of the boundaries of the proposed acreage attribution unit for oil wells.

API NO. 15- _____
 OPERATOR Griggs Oil, Inc.
 LEASE Hamill
 WELL NUMBER 1-14
 FIELD Langdon Extension

LOCATION OF WELL: COUNTY Reno
660 feet from south/north line of section
660 feet from east/west line of section
 SECTION 14 TWP 25S RG 9W

NUMBER OF ACRES ATTRIBUTABLE TO WELL 40
 QTR/QTR/QTR OF ACREAGE SW - SW - _____

IS SECTION X REGULAR or _____ IRREGULAR
IF SECTION IS IRREGULAR, LOCATE WELL FROM NEAREST CORNER BOUNDARY.

Section corner used: _____ NE _____ NW _____ SE X SW
PLAT

(Show location of the well and shade attributable acreage for prorated or spaced wells.)
 (Show footage to the nearest lease or unit boundary line.)

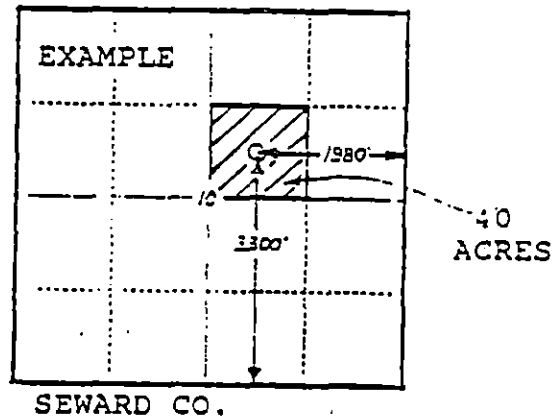
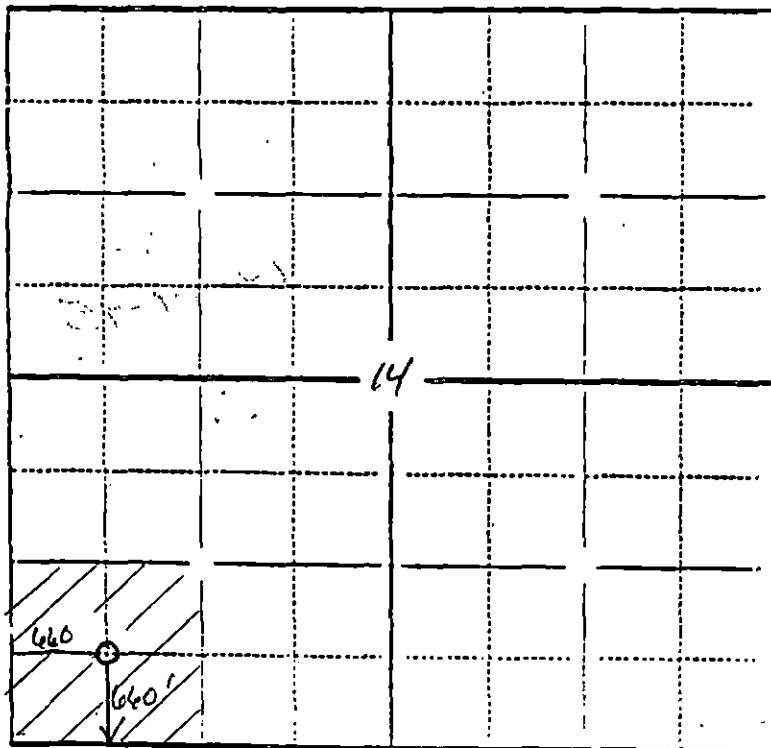

In plotting the proposed location of the well, you must show:

- 1) The manner in which you are using the depicted plat by identifying section lines, i.e. 1 section, 1 section with 8 surrounding sections, 4 sections, etc.;
- 2) the distance of the proposed drilling location from the section's south/north and east/west lines; and
- 3) the distance to the nearest lease or unit boundary line.

FOR KCC USE:

CORRECTION

CORRECTION

FORM C-1 7/9

FORM MUST BE TYPE

FORM MUST BE SIKED

ALL BLANKS MUST BE FILLED

EFFECTIVE DATE: 1-23-96

DISTRICT # 2

SEAT: Yes No

State of Kansas

NOTICE OF INTENTION TO DRILL

Must be approved by the K.C.C. five (5) days prior to commencing well

Expected Spud Date 01 20 1996 month day year

Spot SW SW Sec 14 Twp 25 S. Rg 9 East West

OPERATOR: License # 5058 Name: Griggs Oil, Inc. Address: 100 N. Main, Suite 1010 City/State/Zip: Wichita, KS 67202 Contact Person: Jim Collins Phone: 316-267-7779

660 feet from South North line of Section 660 feet from East West line of Section IS SECTION X REGULAR IRREGULAR

CONTRACTOR: License # Sterling Drilling Co. Name: 5142

(NOTE: Locate well on the Section Plat on Reverse Side. County: Reno. Lease Name: Hamel Well #: 1-14 Field Name: Langdon Extension

Well Drilled For: Well Class: Type Equipment:

- X Oil Enh Rec Infield Mud Rotary
Gas Storage Pool Ext. Air Rotary
OWWO Disposal Wildcat Cable
Seismic: # of Holes Other

Is this a Perforated/Spaced Field? yes X no Target Formation(s): Mississippi Nearest lease or unit boundary: 660 Ground Surface Elevation: 1665 feet MSL

If OWWO, old well information as follows:

Operator: NA Well Name: Comp. Date: Old Total Depth

Water well within one-quarter mile: yes X no Public water supply well within one mile: yes X no Depth to bottom of fresh water: 115 Depth to bottom of usable water: 140 Surface Pipe by Alternate: X 1 2 Length of Surface Pipe Planned to be set: 160 Length of Conductor pipe required: -0- Projected Total Depth: 3950 Formation at Total Depth: Kinderhook Water Source for Drilling Operations:

Directional, Deviated or Horizontal wellbore? yes X no

DWR Permit #: Applied for Will Cores Be Taken? yes X no

If yes, true vertical depth:

Bottom Hole Location:

If yes, proposed zone:

* ORIGINAL LEASE WAS SPELLED WRONG. WAS: HAMILL. IS: HAMEL

The undersigned hereby affirms that the drilling, completion and eventual plugging of this well will comply with K.S.A. 55-101, et. seq.

It is agreed that the following minimum requirements will be met:

- 1. Notify the appropriate district office prior to spudding of well;
2. A copy of the approved notice of intent to drill shall be posted on each drilling rig;
3. The minimum amount of surface pipe as specified below shall be set by circulating cement to the top; in all cases surface pipe shall be set through all unconsolidated materials plus a minimum of 20 feet into the underlying formation;
4. If the well is dry hole, an agreement between the operator and the district office on plug length and placement is necessary prior to plugging;
5. The appropriate district office will be notified before well is either plugged or production casing is cemented in;
6. IF AN ALTERNATE IS COMPLETION, PRODUCTION PIPE SHALL BE CEMENTED FROM BELOW ANY USABLE WATER TO SURFACE WITHIN 120 DAYS OF SPUD DATE. IN ALL CASES, NOTIFY DISTRICT OFFICE PRIOR TO ANY CEMENTING.

I hereby certify that the statements made herein are true and to the best of my knowledge and belief.

Date: 12-18-95 Signature of Operator or Agent: Title: Vice President

FOR KCC USE: API # 15- 155-213780000 Conductor pipe required NONE feet Minimum surface pipe required 160 feet per Alt. (1) X Approved by: JK 1-30-96 / ORIG 1-18-96 This authorization expires: 7-18-96 (This authorization void if drilling not started within 6 months of effective date.) Spud date: Agent:

RECEIVED KANSAS CORP COMM 1996 JAN 30 A 11:22

REMEMBER TO:

- File Drill Pit Application (form CDR-1) with Intent to Drill;
- File Completion Form ACO-1 within 120 days of spud date;
- File acreage attribution plat according to field production orders;
- Notify appropriate district office 48 hours prior to workover or re-entry;
- Submit plugging report (SP-4) after plugging is completed;
- Obtain written approval before disposing or injecting salt water.

Mail to: Conservation Division, 200 Colorado Derby Building, 202 W. First St., Wichita, Kansas 67202-1286.

IN ALL CASES PLOT THE INTENDED WELL ON THE PLAT BELOW

PLAT OF ACREAGE ATTRIBUTABLE TO A WELL IN A PRORATED OR SPACED FIELD

If the intended well is in a prorated or spaced field, please fully complete this side of the form. If the intended well is in a prorated or spaced field complete the plat below showing that the well will be properly located in relationship to other wells producing from the common source of supply. Please show all the wells within 1 mile of the boundaries of the proposed acreage attribution unit for gas wells and within 1/2 mile of the boundaries of the proposed acreage attribution unit for oil wells.

API NO. 15- _____
 OPERATOR _____
 LEASE _____
 WELL NUMBER _____
 FIELD _____

LOCATION OF WELL: COUNTY _____
 _____ feet from south/north line of section
 _____ feet from east/west line of section
 SECTION _____ TWP _____ RG _____

NUMBER OF ACRES ATTRIBUTABLE TO WELL _____
 QTR/QTR/QTR OF ACREAGE _____ - _____ - _____

IS SECTION _____ REGULAR or _____ IRREGULAR
IF SECTION IS IRREGULAR, LOCATE WELL FROM NEAREST CORNER BOUNDARY.

Section corner used: _____ NE _____ NW _____ SE _____ SW

PLAT

(Show location of the well and shade attributable acreage for prorated or spaced wells.)
 (Show footage to the nearest lease or unit boundary line.)

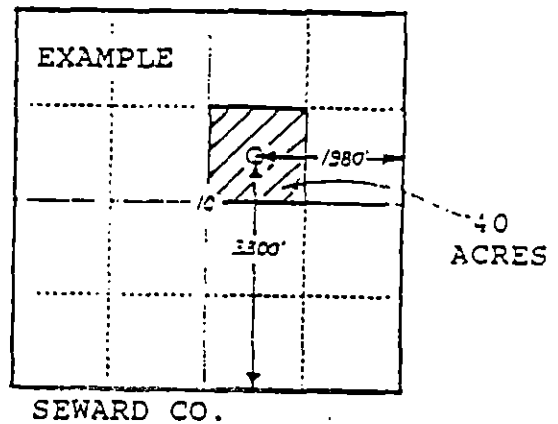
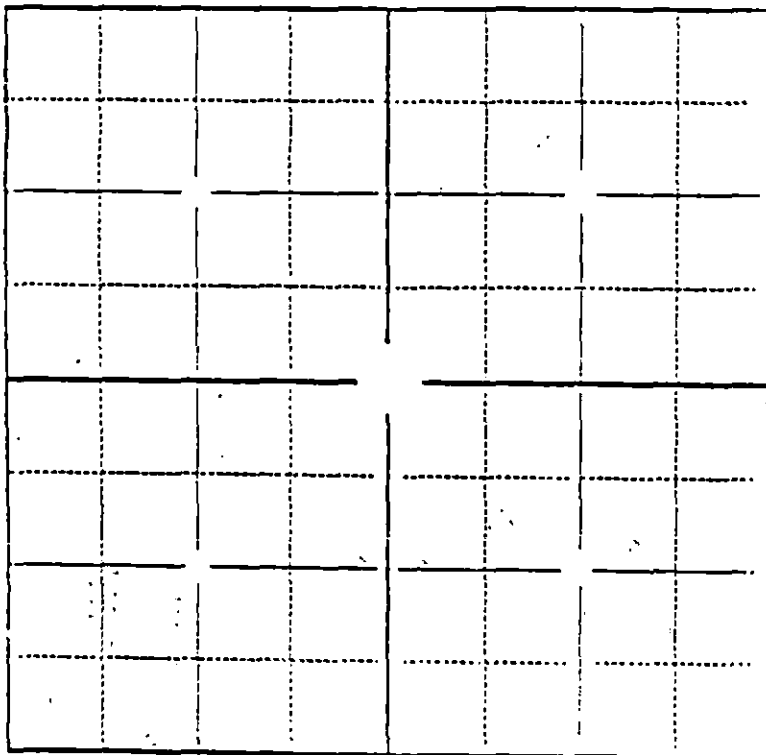

In plotting the proposed location of the well, you must show:

- 1) The manner in which you are using the depicted plat by identifying section lines, i.e. 1 section, 1 section with 8 surrounding sections, 4 sections, etc.
- 2) the distance of the proposed drilling location from the section's south/north and east/west lines; and
- 3) the distance to the nearest lease or unit boundary line.