

ORIGINAL

STATE CORPORATION COMMISSION OF KANSAS
OIL & GAS CONSERVATION DIVISION
WELL COMPLETION FORM
ACO-1 WELL HISTORY
DESCRIPTION OF WELL AND LEASE

API NO. 15- 081-20955-0000

County HASKELL
Spot: 489'N & 185'E of
C. NE - NE Sec. 16 Twp. 29 Rge. 34 X E

Operator: License # 4549

SHL 171 Feet from NX (circle one) Line of Section

Name: ANADARKO PETROLEUM CORPORATION

SHL 475 Feet from EX (circle one) Line of Section

Address P. O. BOX 351

Footages Calculated from Nearest Outside Section Corner:
NE SE, NW or SW (circle one)

CONFIDENTIAL

Lease Name OWENS "A" Well # 3

City/State/Zip LIBERAL, KANSAS 67905-0351

Field Name EUBANK

Purchaser: NATIONAL COOPERATIVE REFINING ASSOCIATION

Producing Formation CHESTER NOV 20

Operator Contact Person: J. L. ASHTON

Elevation: Ground 2979.1 KB **CONFIDENTIAL**

Phone (316) 624-6253

Total Depth 5752 TMD, 5650 TVD PBDT 5687

Contractor: Name: NORSEMAN DRILLING INC.

Amount of Surface Pipe Set and Cemented at 1806 Feet

License: 3779

Multiple Stage Cementing Collar Used? X Yes No

Wellsite Geologist: NA

If yes, show depth set 3193 Feet

Designate Type of Completion
X New Well Re-Entry Workover

If Alternate II completion, cement circulated from

X Oil SWD SLOW Temp. Abd.
 Gas ENHR SIGW
 Dry Other (Core, WSW, Exp. Cemented, etc)

feet depth to w/ sx cmt.

If Workover:

Drilling Fluid Management Plan ALT 1 5-10-99
(Data must be collected from the Reserve Pit) DPW

Operator:

Chloride content 5900 ppm Fluid volume 700 bbls

Well Name:

Watering method used NATURAL EVAPORATION

Comp. Date Old Total Depth

Location of fluid disposal if hauled offsite:

 Deepening Re-perf. Conv. to Inj/SWD
 Plug Back PBDT
 Commingled Docket No.
 Dual Completion Docket No.
 Other (SWD or Inj?) Docket No.

Operator Name

Lease Name License No.

8-21-95 9-04-95 11-11-95
Spud Date Date Reached TD Completion Date

 Quarter Sec. Twp. S Rng. E/W

County Docket No.

RELEASED

MAR 23 1998

FROM CONFIDENTIAL

INSTRUCTIONS: An original and two copies of this form shall be filed with the Kansas Corporation Commission, 130 S. Market - Room 2078, Wichita, Kansas 67202, within 120 days of the spud date, recompletion, workover or conversion of a well. Rule 82-3-130, 82-3-106 and 82-3-107 apply. Information on side two of this form will be held confidential for a period of 12 months if requested in writing and submitted with the form (see rule 82-3-107 for confidentiality in excess of 12 months). One copy of all wireline logs and geologist well report shall be attached with this form. ALL CEMENTING TICKETS MUST BE ATTACHED. Submit CP-4 form with all plugged wells. Submit CP-111 form with all temporarily abandoned wells.

All requirements of the statutes, rules and regulations promulgated to regulate the oil and gas industry have been fully complied with and the statements herein are complete and correct to the best of my knowledge.

Signature David W. Kapple
Title DIVISION DRILLING ENGINEER Date 11/20/95

Subscribed and sworn to before me this 20th day of November, 19 95.

Notary Public L. Marc Harvey
Date Commission Expires

L. MARC HARVEY
Notary Public - State of Kansas
My Appt. Expires 10-12-99

K.C.C. OFFICE USE ONLY
F Letter of Confidentiality Attached
C Wireline Log Received
C Geologist Report Received
Distribution
 KCC SWD/Rep NGPA
 KGS Plug Other
RECEIVED (Specify)
KANSAS CORPORATION COMMISSION

Form ACO-1 (7-91)
NOV 21 1995
11-21-95
CONSERVATION DIVISION
WICHITA, KS

Operator Name ANADARKO PETROLEUM CORPORATION Lease Name OWENS "A" Well # 3

Sec. 16 Twp. 29 Rge. 34 East West

County HASKELL

INSTRUCTIONS: Show important tops and base of formations penetrated. Detail all cores. Report all drill stem tests giving interval tested, time tool open and closed, flowing and shut-in pressures, whether shut-in pressure reached static level, hydrostatic pressures, bottom hole temperature, fluid recovery, and flow rates if gas to surface during test. Attach extra sheet if more space is needed. Attach copy of log.

Drill Stem Tests Taken Yes No
 (Attach Additional Sheets.)
 Samples Sent to Geological Survey Yes No
 Cores Taken Yes No
 Electric Log Run Yes No
 (Submit Copy.)
 List All E.Logs Run: CNL-LDT, DIL, ML, SONIC, SBL-CCL-GR.
 CORE DESCRIPTION ATTACHED.

<input checked="" type="checkbox"/> Log Formation (Top), Depth and Datums <input type="checkbox"/> Sample		
Name	Top TMD	Datum
B/STONE CORRAL	1816	
CHASE	2510	
COUNCIL GROVE	2847	
HEEBNER	3988	
LANSING	4068	
MARMATON	4686	
MORROW	5234	
CHESTER	5402	
ST LOUIS	5702	

CASING RECORD New Used
 Report all strings set-conductor, surface, intermediate, production, etc.

Purpose of String	Size Hole Drilled	Size Casing Set (In O.D.)	Weight Lbs./Ft.	Setting Depth	Type of Cement	# Sacks Used	Type and Percent Additives
SURFACE	12.25	8.625	24	1806	MIDCON 2/ PREMIUM PLUS	340/160	2%CC, 1/4#/SK FLC/SAME.
PRODUCTION	7.875	5.5	15.5	5728	VERSASET 11PPG /14.5 PPG.	50/160	.6% HALAD 322, 5%KCL, 1/4#SK FLC .9%VERSASET/ SAME.
			FO TOOL @	3193	MIDCON 2	60	NONE

ADDITIONAL CEMENTING/SQUEEZE RECORD

Purpose:	Depth Top Bottom	Type of Cement	#Sacks Used	Type and Percent Additives
<input type="checkbox"/> Perforate <input type="checkbox"/> Protect Casing <input type="checkbox"/> Plug Back TD <input type="checkbox"/> Plug Off Zone				

Shots Per Foot	PERFORATION RECORD - Bridge Plugs Set/Type Specify Footage of Each Interval Perforated	Acid, Fracture, Shot, Cement Squeeze Record (Amount and Kind of Material Used)	Depth
4	5530-5544	ACID: 1400 GAL 7-1/2% FEHCL	5530-5544'

TUBING RECORD Size 2-3/8 Set At 5525 Packer At _____ Liner Run Yes No

Date of First, Resumed Production, SWD or Inj. 11-08-95 Producing Method Flowing Pumping Gas Lift Other (Explain)

Estimated Production Per 24 Hours	Oil Bbls.	Gas Mcf.	Water Bbls.	Gas-Oil Ratio	Gravity
	30	330	5	11000	--

Disposition of Gas: Vented Sold Used on Lease (If vented, submit ACO-18.)
 Method of completion: Open Hole Perf. Dually Comp. Commingled
 Other (Specify) _____ Production Interval 5530-5544

CONFIDENTIAL

ORIGINAL

Core Description:
Anadarko Petroleum Corporation
Owens "A" No. 3
Sec. 16-T29S-R34W
Haskell County, Kansas

15-081-20955

Core No. 1 5465'MD-5525'MD
Core 60' Rec. 55' Total
31' Ss
5' Ls
4' Ss
1' Sh
14' Ss

KCC

NOV 20

CONFIDENTIAL

Core No. 2 5525'MD-5555'MD
Core 30' Rec. 29' Total
29' Ss

RELEASED

Core No. 3. 5555'MD-5611'MD
Core 56' Rec. 54' Total
44' Ss
1' Sh
5' Ss
2' Sh
2' Ss

MAR 23 1998.

FROM CONFIDENTIAL

CONFIDENTIAL

6/11/95
KCC

ORIGINAL

NORSEMAN DRILLING, INC.
WICHITA, KANSAS
DRILLERS' WELL LOG

WELL NAME: OWENS A-3
SECTION 16-29S-34W
HASKELL COUNTY, KANSAS

15-081-20955

COMMENCED: AUGUST 20, 1995

KCC

COMPLETED: SEPTEMBER 06, 1995

NOV 20

OPERATOR: ANADARKO PETROLEUM CORPORATION

CONFIDENTIAL

Depth From	To	Formation	Remarks
0	1399	Sand & Redbed	Ran 43 jts of 24#
1400	1461	Glorietta Sand	8 5/8" csg set @
1462	2114	Redbed & Shale	1806'; w/340 SX of
2115	5760	Lime - Shale	Midcon 2; 1/4 SX Flocele; Tailed w/160 SX Premium Plus; 2% CC; 1/4# SX Flocele; Plug down at 10:15 p.m. on 08/22/95.

RELEASED

MAR 23 1998

FROM CONFIDENTIAL

Ran 133 jts 5 1/2" 15.5#, Set @ 5726'; w/160 SX
Premium Lite "C"; Tailed w/120 SX Premium Lite "C";
Plug down at 1:30 p.m., on 09/06/95

STATE OF KANSAS

)I, the undersigned, being duly sworn on
)oath, state that the above Drillers' Well
)Log is true and correct to the best of my
)knowledge and belief and according to the
)records of this office.

COUNTY OF SEDGWICK

NORSEMAN DRILLING, INC.

James P. Reilly

JAMES P. REILLY, PRESIDENT

Subscribed & sworn to before me this

September 11, 1995

My Appointment Expires:

July 21, 1999

Phyllis E. Brewer

Phyllis E. Brewer, Notary Public
11817 Jamesburg
Wichita, KS 67212 (5)

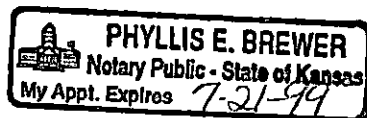



Drawn: 09/29/95 by HTH

ORIGINAL

RELEASED

MAR 23 1998

CONFIDENTIAL

FROM CONFIDENTIAL

Surface Location
171' FNL & 475' FEL

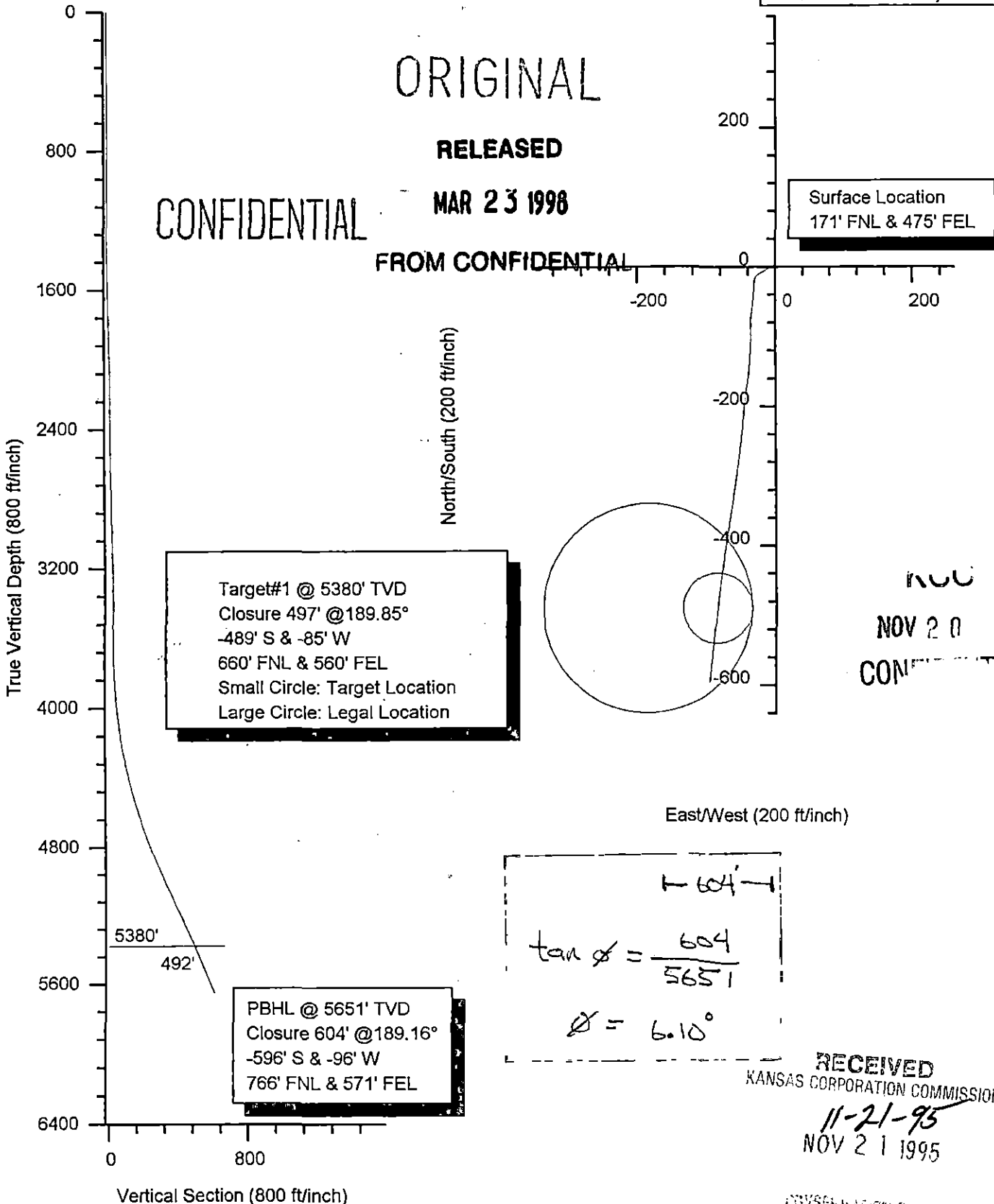

KCC
NOV 20
CONFIDENTIAL

RECEIVED
KANSAS CORPORATION COMMISSION
11-21-95
NOV 21 1995

CONSERVATION DIVISION

Anadarko Petroleum Corporation

SURVEY REPORT

ORIGINAL

RELEASED

MAR 23 1998

Date: 09/29/1995

Time: 16:57

Page: 1

Problem: OWENS A-3
 Description: 171 FNL & 475 FEL
 Location: Sec 16-29S-34W
 Well Number: Haskell County, KS

CONFIDENTIAL

Surface Location

FROM CONFIDENTIAL

Slot	0.0 ft		Location	ONSHORE
N+/-S	0.0 ft		RKB Wellhead	2979.1 ft
E+/-W	0.0 ft	FNL	RKB MGL	0.0 ft
Latitude	0.000000 deg	FEL	RKB MSL	0.0 ft
Longitude	0.000000 deg		Water Depth	0.0 ft
			RKB Mudline	0.0 ft

Survey (Referenced To Tie-In Coordinates)

Calculation Method: Minimum Curvature

Planned Azimuth											
189.85											
MD	Incl	Direc	TVD	Vert Sect	Clos Dist	Clos Direc	+N / -S	+E / -W	DLS	Build	Walk
ft	deg	bearing	ft	ft	ft	bearing	ft	ft	d/100ft	d/100ft	d/100ft
0.0	0.00	189.85	0.0	0.0	0.0	0.00	0.0	0.0	0.00	0.00	0.00
100.0	0.58	235.24	100.0	0.4	0.5	235.24	-0.3	-0.4	0.58	0.58	45.39
200.0	0.42	253.69	200.0	0.9	1.4	240.12	-0.7	-1.2	0.22	-0.16	18.45
300.0	0.25	250.14	300.0	1.1	1.9	243.78	-0.9	-1.7	0.17	-0.17	-3.55
400.0	0.25	220.47	400.0	1.4	2.4	242.27	-1.1	-2.1	0.13	0.00	-29.67
500.0	0.25	318.83	500.0	1.5	2.6	245.15	-1.1	-2.4	0.38	0.00	98.36
600.0	0.33	297.26	600.0	1.3	2.9	253.85	-0.8	-2.8	0.13	0.08	-21.57
700.0	0.58	321.68	700.0	0.8	3.4	265.32	-0.3	-3.3	0.31	0.25	24.42
800.0	0.67	324.99	800.0	0.1	4.0	278.58	0.6	-4.0	0.10	0.09	3.31
900.0	0.42	355.35	900.0	-0.7	4.6	288.37	1.4	-4.4	0.37	-0.25	30.36
1000.0	0.50	64.61	1000.0	-1.3	4.5	296.60	2.0	-4.0	0.53	0.08	69.26
1100.0	0.42	32.79	1100.0	-1.9	4.2	306.27	2.5	-3.4	0.26	-0.08	-31.82
1200.0	0.50	206.71	1200.0	-1.8	4.2	305.38	2.4	-3.4	0.92	0.08	173.92
1300.0	0.75	28.01	1300.0	-2.0	4.2	308.36	2.6	-3.3	1.25	0.25	-178.70
1400.0	1.08	213.34	1400.0	-1.8	4.2	304.37	2.4	-3.5	1.83	0.33	-174.67
1500.0	1.58	236.80	1499.9	0.0	5.2	279.33	0.8	-5.2	0.73	0.50	23.46
1600.0	1.75	233.20	1599.9	2.1	7.6	263.79	-0.8	-7.5	0.20	0.17	-3.60
1700.0	1.92	248.52	1699.8	4.1	10.6	257.18	-2.3	-10.3	0.52	0.17	15.32
1800.0	1.75	235.46	1799.8	6.0	13.7	253.76	-3.8	-13.1	0.45	-0.17	-13.06
1900.0	1.08	234.17	1899.8	7.8	16.0	250.92	-5.2	-15.2	0.67	-0.67	-1.29
2000.0	1.92	232.62	1999.7	9.7	18.6	248.45	-6.8	-17.3	0.84	0.84	-1.55
2100.0	1.00	246.07	2099.7	11.4	21.0	247.11	-8.2	-19.4	0.98	-0.92	13.45
2200.0	0.92	251.40	2199.7	12.2	22.7	247.22	-8.8	-20.9	0.12	-0.08	5.33
2300.0	0.83	240.15	2299.7	13.1	24.2	247.15	-9.4	-22.3	0.19	-0.09	-11.25
2400.0	0.75	245.47	2399.7	13.9	25.6	246.91	-10.0	-23.6	0.11	-0.08	5.32
2500.0	0.75	238.95	2499.6	14.7	26.9	246.68	-10.7	-24.7	0.09	0.00	-6.52
2600.0	1.00	243.42	2599.6	15.7	28.4	246.40	-11.4	-26.1	0.26	0.25	4.47
2700.0	1.00	214.97	2699.6	17.0	30.1	245.45	-12.5	-27.3	0.49	0.00	-28.45
2800.0	1.17	213.32	2799.6	18.7	31.7	243.67	-14.1	-28.4	0.17	0.17	-1.65
2900.0	0.92	201.58	2899.6	20.4	33.2	241.85	-15.7	-29.3	0.33	-0.25	-11.74
3000.0	1.08	188.83	2999.6	22.2	34.4	239.73	-17.3	-29.7	0.27	0.16	-12.75
3100.0	0.67	203.09	3099.6	23.7	35.5	237.98	-18.8	-30.1	0.46	-0.41	14.26
3200.0	0.92	187.27	3199.6	25.0	36.5	236.48	-20.1	-30.4	0.33	0.25	-15.82
3300.0	0.83	182.59	3299.5	26.6	37.4	234.65	-21.7	-30.5	0.12	-0.09	-4.68
3400.0	0.75	186.82	3399.5	27.9	38.3	233.07	-23.0	-30.6	0.10	-0.08	4.23
3500.0	0.58	202.98	3499.5	29.1	39.2	232.01	-24.1	-30.9	0.25	-0.17	16.16
3600.0	0.50	210.17	3599.5	30.0	40.1	231.43	-25.0	-31.3	0.10	-0.08	7.19
3666.0	0.25	184.30	3665.5	30.4	40.4	231.13	-25.4	-31.5	0.45	-0.38	-39.20
3702.0	1.20	170.60	3701.5	30.8	40.7	230.59	-25.8	-31.4	2.66	2.64	-38.06
3734.0	1.80	176.40	3733.5	31.6	41.2	229.62	-26.7	-31.3	1.93	1.87	18.12
3766.0	2.20	178.10	3765.5	32.7	41.8	228.41	-27.8	-31.3	1.26	1.25	5.31
3797.0	2.90	180.20	3796.5	34.1	42.8	227.01	-29.2	-31.3	2.28	2.26	6.77
3828.0	3.10	183.20	3827.4	35.7	43.9	225.51	-30.8	-31.3	0.82	0.65	9.68
3858.0	3.30	185.20	3857.4	37.4	45.2	224.11	-32.4	-31.5	0.76	0.67	6.67
3890.0	3.70	185.00	3889.3	39.3	46.7	222.60	-34.4	-31.6	1.25	1.25	-0.62
3922.0	4.00	185.50	3921.2	41.4	48.5	221.06	-36.5	-31.8	0.94	0.94	1.56

Anadarko Petroleum Corporation SURVEY REPORT

ORIGINAL

Problem: OWENS A-3
Description: 171 FNL & 475 FEL
Location: Sec 16-29S-34W
Well Number: Haskell County, KS

Date: 09/29/1995 **Time:** 16:57 **Page:** 2

CONFIDENTIAL

Survey (Referenced To Tie-In Coordinates)

Calculation Method: Minimum Curvature

Planned Azimuth			189.85								
MD	Incl	Dirac	TVD	Vert	Clos	Clos	+N / -S	+E / -W	DLS	Build	Walk
ft	deg	bearing	ft	ft	ft	ft	ft	ft	d/100ft	d/100ft	d/100ft
3953.0	4.90	184.60	3952.1	43.8	50.4	219.45	-38.9	-32.0	2.91	2.90	-2.90
3985.0	5.50	183.20	3984.0	46.7	52.8	217.62	-41.8	-32.2	1.92	1.88	-4.38
4015.0	5.90	184.30	4013.9	49.7	55.3	215.90	-44.8	-32.4	1.38	1.33	3.67
4076.0	7.20	185.70	4074.5	56.6	61.4	212.57	-51.7	-33.0	2.15	2.13	2.30
4105.0	7.50	186.00	4103.2	60.3	64.7	211.09	-55.4	-33.4	1.04	1.03	1.03
4136.0	8.00	188.90	4133.9	64.5	68.6	209.69	-59.6	-34.0	2.05	1.61	9.35
4166.0	8.80	188.90	4163.6	68.9	72.7	208.47	-63.9	-34.6	2.67	2.67	0.00
4198.0	9.70	186.60	4195.2	74.0	77.5	207.12	-69.0	-35.3	3.04	2.81	-7.19
4230.0	10.00	183.60	4226.7	79.5	82.6	205.69	-74.4	-35.8	1.86	0.94	-9.37
4261.0	10.60	180.20	4257.2	85.0	87.7	204.23	-80.0	-36.0	2.75	1.94	-10.97
4293.0	11.20	179.90	4288.6	90.9	93.3	202.71	-86.0	-36.0	1.88	1.87	-0.94
4324.0	11.80	179.90	4319.0	97.0	99.0	201.32	-92.2	-36.0	1.94	1.94	0.00
4353.0	12.30	180.90	4347.4	103.0	104.7	200.14	-98.3	-36.0	1.87	1.72	3.45
4385.0	12.70	181.10	4378.6	109.8	111.2	198.97	-105.2	-36.2	1.26	1.25	0.63
4416.0	13.50	182.70	4408.8	116.8	118.0	197.97	-112.2	-36.4	2.83	2.58	5.16
4448.0	14.20	182.90	4439.9	124.4	125.4	197.05	-119.9	-36.8	2.19	2.19	0.63
4477.0	15.20	183.60	4467.9	131.7	132.5	196.29	-127.2	-37.2	3.50	3.45	2.41
4508.0	15.90	184.60	4497.8	140.0	140.7	195.58	-135.5	-37.8	2.42	2.26	3.23
4539.0	15.80	185.70	4527.6	148.4	149.0	194.99	-143.9	-38.5	1.02	-0.32	3.55
4570.0	16.20	187.30	4557.4	156.9	157.5	194.53	-152.4	-39.5	1.92	1.29	5.16
4602.0	16.70	188.30	4588.1	166.0	166.5	194.17	-161.4	-40.7	1.80	1.56	3.12
4631.0	17.60	188.30	4615.8	174.5	175.0	193.88	-169.9	-42.0	3.10	3.10	0.00
4663.0	18.30	188.10	4646.3	184.4	184.8	193.58	-179.6	-43.4	2.20	2.19	-0.62
4695.0	18.80	186.70	4676.6	194.6	194.9	193.25	-189.7	-44.7	2.09	1.56	-4.38
4726.0	19.60	186.00	4705.9	204.7	205.0	192.91	-199.8	-45.8	2.69	2.58	-2.26
4758.0	20.00	185.30	4736.0	215.5	215.8	192.55	-210.6	-46.9	1.45	1.25	-2.19
4789.0	20.10	185.20	4765.1	226.1	226.3	192.21	-221.2	-47.9	0.34	0.32	-0.32
4818.0	20.70	185.30	4792.3	236.2	236.4	191.91	-231.3	-48.8	2.07	2.07	0.34
4849.0	21.40	185.90	4821.2	247.3	247.4	191.63	-242.4	-49.9	2.36	2.26	1.94
4881.0	22.10	186.60	4850.9	259.2	259.2	191.38	-254.1	-51.2	2.33	2.19	2.19
4911.0	22.50	187.60	4878.7	270.5	270.6	191.20	-265.4	-52.6	1.84	1.33	3.33
4942.0	22.90	188.10	4907.3	282.5	282.5	191.06	-277.3	-54.2	1.43	1.29	1.61
4972.0	23.50	188.00	4934.9	294.3	294.3	190.94	-289.0	-55.9	2.00	2.00	-0.33
5003.0	23.60	188.10	4963.3	306.7	306.7	190.82	-301.3	-57.6	0.35	0.32	0.32
5033.0	23.20	188.50	4990.8	318.6	318.6	190.73	-313.0	-59.3	1.43	-1.33	1.33
5063.0	23.60	188.30	5018.4	330.5	330.5	190.64	-324.8	-61.0	1.36	1.33	-0.67
5095.0	24.00	188.30	5047.6	343.4	343.4	190.56	-337.6	-62.9	1.25	1.25	0.00
5126.0	23.90	188.50	5076.0	356.0	356.0	190.48	-350.1	-64.7	0.41	-0.32	0.65
5157.0	24.10	188.30	5104.3	368.6	368.6	190.41	-362.5	-66.6	0.70	0.65	-0.65
5188.0	24.40	188.90	5132.6	381.3	381.3	190.35	-375.1	-68.5	1.25	0.97	1.94
5219.0	24.10	189.20	5160.8	394.0	394.1	190.31	-387.7	-70.5	1.05	-0.97	0.97
5250.0	23.90	189.00	5189.1	406.7	406.7	190.27	-400.1	-72.5	0.70	-0.65	-0.65
5280.0	24.00	188.70	5216.6	418.8	418.8	190.23	-412.2	-74.4	0.52	0.33	-1.00
5311.0	24.40	188.30	5244.8	431.5	431.5	190.18	-424.7	-76.2	1.40	1.29	-1.29
5342.0	24.50	188.00	5273.1	444.4	444.4	190.12	-437.5	-78.1	0.51	0.32	-0.97
5372.0	24.00	188.10	5300.4	456.7	456.7	190.06	-449.7	-79.8	1.67	-1.67	0.33
5403.0	24.20	188.00	5328.7	469.3	469.3	190.01	-462.2	-81.6	0.66	0.65	-0.32
5423.0	24.20	188.70	5346.9	477.5	477.5	189.98	-470.3	-82.8	1.43	0.00	3.50
5752.0	21.00	183.00	5650.7	603.5	603.6	189.16	-595.9	-96.0	1.18	-0.97	-1.73

Anadarko Petroleum Corporation SURVEY REPORT

ORIGINAL

Problem: OWENS A-3
Description: 171 FNL & 475 FEL
Location: Sec 16-29S-34W
Well Number: Haskell County, KS

Date: 09/29/1995

Time: 16:57

Page: 3

CONFIDENTIAL

Points Of Interest

Description	MD ft	Incl deg	Direc bearing	TVD ft	+N / -S ft	+E / -W ft	Clos Dist ft
Heebner	3988.0	5.54	183.31	3987.0	-42.1	-32.2	53.0
Toronto	4008.0	5.81	184.04	4006.9	-44.1	-32.4	54.7
Lansing	4068.0	7.03	185.52	4066.5	-50.7	-32.9	60.5
Kansas City	4525.0	15.85	185.20	4514.2	-140.1	-38.2	145.2
Marmaton	4686.0	18.66	187.09	4668.1	-186.8	-44.3	192.0
Cherokee	4872.0	21.90	186.40	4842.6	-250.8	-50.8	255.9
Atoka	5008.0	23.53	188.17	4967.9	-303.2	-57.9	308.7
Morrow	5234.0	24.00	189.10	5174.5	-393.7	-71.5	400.2
Chester	5402.0	24.19	188.00	5327.8	-461.8	-81.5	468.9
St. Louis	5702.0	21.49	183.87	5604.0	-577.9	-94.6	585.6

KCC
 NOV 20
 CONFIDENTIAL

Section View (ft) (Section View Azm=189.85)

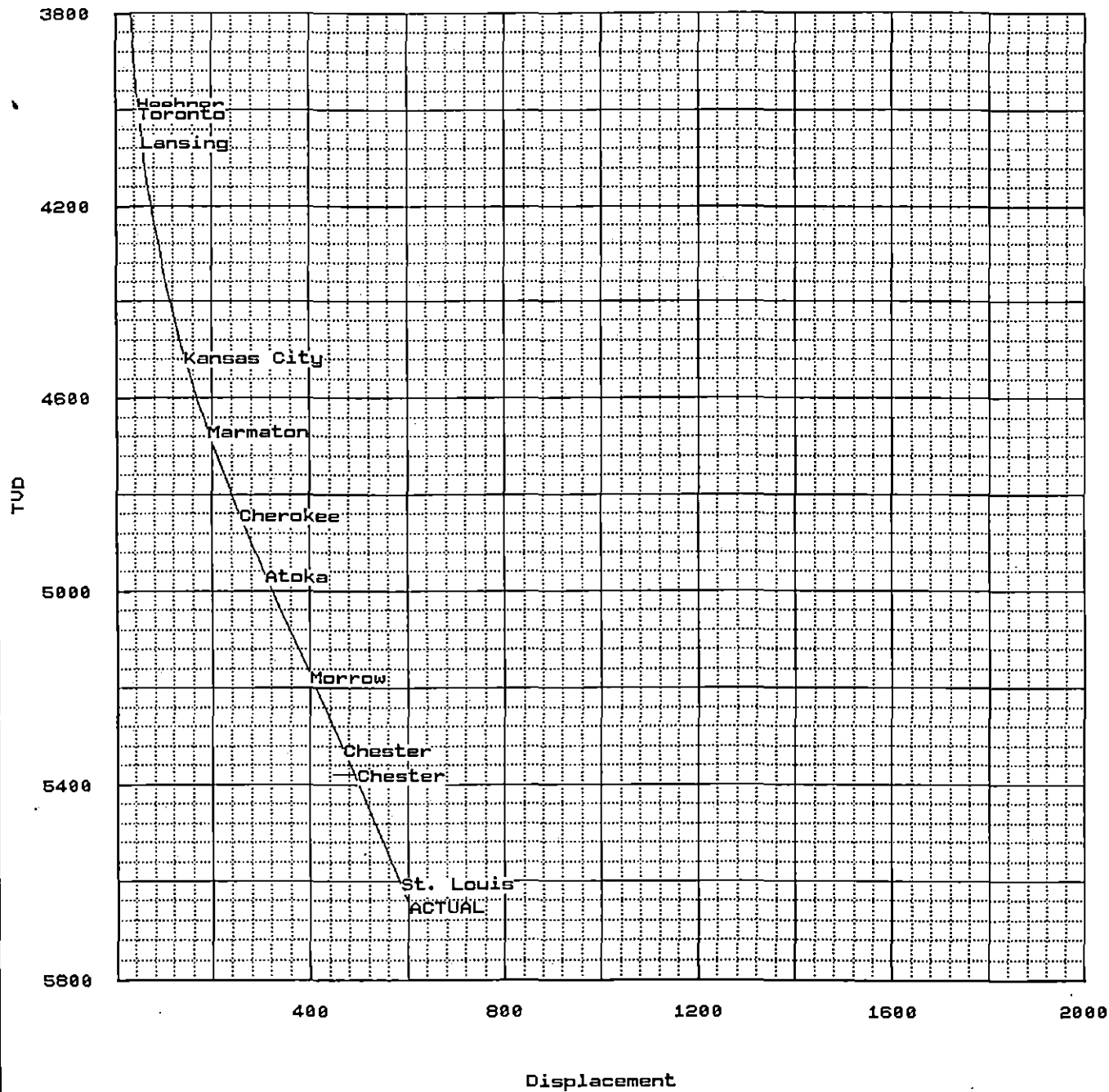

ACTUAL

CONFIDENTIAL

OWENS A-3

171 FNL & 475 FEL

Haskell County, KS

Sec 16-29S-34W

ORIGINAL

Plan View (ft)

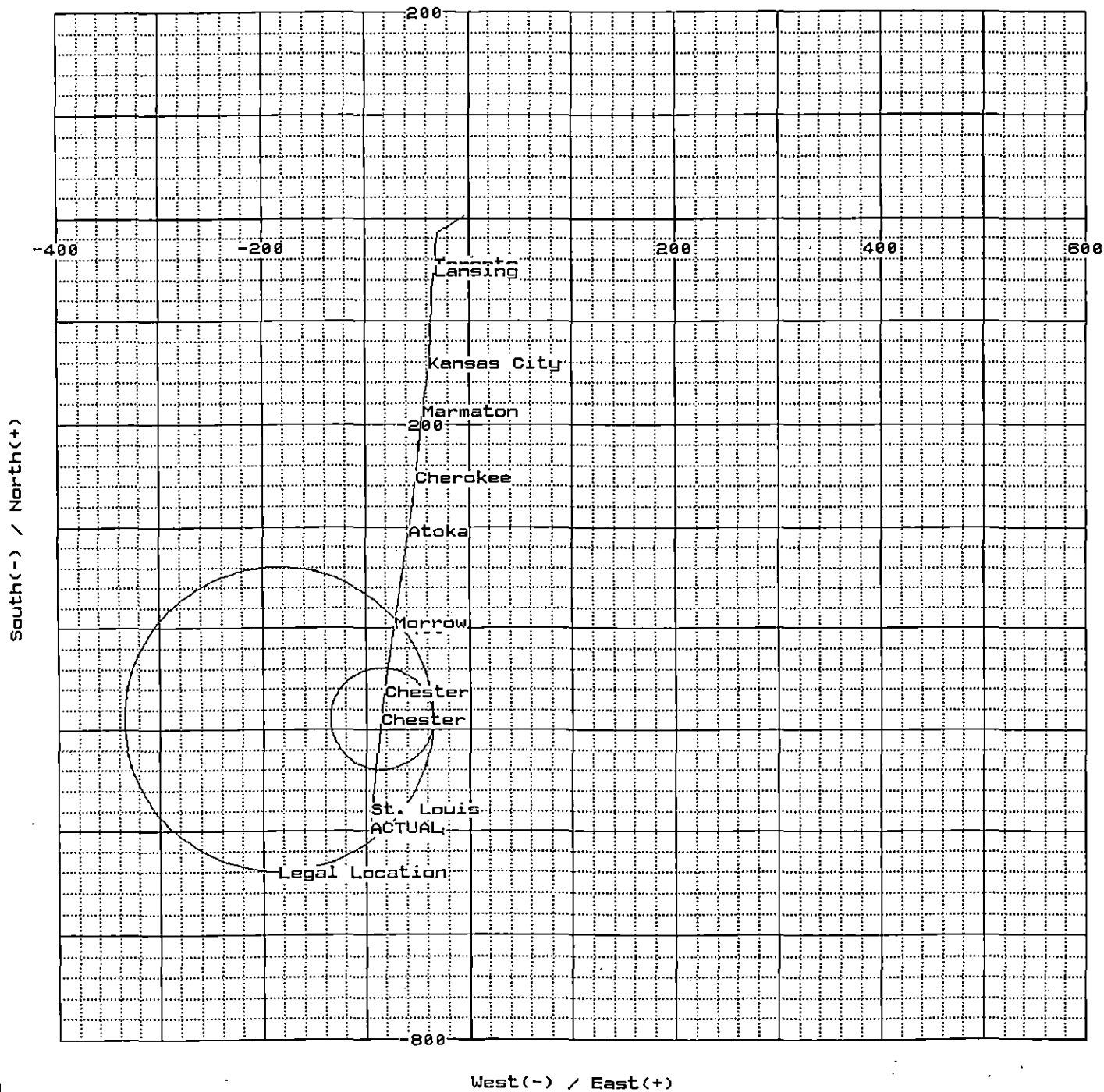

ACTUAL

Legal Location

CONFIDENTIAL

ORIGINAL

OWENS A-3

171 FNL & 475 FEL

Haskell County, KS

Sec 16-295-34W

ANADARKO PETROLEUM CORPORATION

Survey Report

ORIGINAL

Well Name: **EUBANK-OWENS-A-3** Page: **1**

Tool Usage

Starting Depth ft	Ending Depth ft	Tool Name	Side Track #
0.0	3666.0	GYROMS	0
3666.0	5423.0	MWD	1
5423.0	5752.0	MSS	1

Slot #
Latitude
Longitude
RKB - Well Head
RKB - MSL

CONFIDENTIAL

Survey

Survey Calculation Method: **MINIMUM CURVATURE**

Planned Azimuth

MD ft	Angle deg	Azimuth bearing	TVD ft	V.Sect ft	← Closure →		Total Coordinates		DLS d/100ft	Tool
					Dist ft	Azimuth bearing	(N-S) ft	(E-W) ft		
0.0	0.00	0.00	0.0	0.0	0.0	0.00	0.0	0.0	0.00	GYROMS
100.0	0.58	235.24	100.0	-0.3	0.5	235.24	-0.3	-0.4	0.58	GYROMS
200.0	0.42	253.69	200.0	-0.7	1.4	240.12	-0.7	-1.2	0.23	GYROMS
300.0	0.25	250.14	300.0	-0.9	1.9	243.78	-0.9	-1.7	0.17	GYROMS
400.0	0.25	220.47	400.0	-1.1	2.4	242.27	-1.1	-2.1	0.13	GYROMS
500.0	0.25	318.83	500.0	-1.1	2.6	245.15	-1.1	-2.4	0.38	GYROMS
600.0	0.33	297.26	600.0	-0.8	2.9	253.85	-0.8	-2.8	0.13	GYROMS
700.0	0.58	321.68	700.0	-0.3	3.4	265.32	-0.3	-3.3	0.31	GYROMS
800.0	0.67	324.99	800.0	0.6	4.0	278.58	0.6	-4.0	0.10	GYROMS
900.0	0.42	355.35	900.0	1.4	4.6	288.37	1.4	-4.4	0.37	GYROMS
1000.0	0.50	64.61	1000.0	2.0	4.5	296.60	2.0	-4.0	0.53	GYROMS
1100.0	0.42	32.79	1100.0	2.5	4.2	306.27	2.5	-3.4	0.26	GYROMS
1200.0	0.50	206.71	1200.0	2.4	4.2	305.38	2.4	-3.4	0.92	GYROMS
1300.0	0.75	28.01	1300.0	2.6	4.2	308.36	2.6	-3.3	1.25	GYROMS
1400.0	1.08	213.34	1400.0	2.4	4.2	304.37	2.4	-3.5	1.83	GYROMS
1500.0	1.58	236.80	1499.9	0.8	5.2	279.33	0.8	-5.2	0.73	GYROMS
1600.0	1.75	233.20	1599.9	-0.8	7.6	263.79	-0.8	-7.5	0.20	GYROMS
1700.0	1.92	248.52	1699.8	-2.3	10.6	257.18	-2.3	-10.3	0.52	GYROMS
1800.0	1.75	235.46	1799.8	-3.8	13.7	253.76	-3.8	-13.1	0.45	GYROMS
1900.0	1.08	234.17	1899.8	-5.2	16.0	250.92	-5.2	-15.2	0.67	GYROMS
2000.0	1.92	232.62	1999.7	-6.8	18.6	248.45	-6.8	-17.3	0.84	GYROMS
2100.0	1.00	246.07	2099.7	-8.2	21.0	247.11	-8.2	-19.4	0.98	GYROMS
2200.0	0.92	251.40	2199.7	-8.8	22.7	247.22	-8.8	-20.9	0.12	GYROMS
2300.0	0.83	240.15	2299.7	-9.4	24.2	247.15	-9.4	-22.3	0.19	GYROMS
2400.0	0.75	245.47	2399.7	-10.0	25.6	246.91	-10.0	-23.6	0.11	GYROMS
2500.0	0.75	238.95	2499.6	-10.7	26.9	246.68	-10.7	-24.7	0.09	GYROMS
2600.0	1.00	243.42	2599.6	-11.4	28.4	246.40	-11.4	-26.1	0.26	GYROMS
2700.0	1.00	214.97	2699.6	-12.5	30.1	245.45	-12.5	-27.3	0.49	GYROMS
2800.0	1.17	213.32	2799.6	-14.1	31.7	243.67	-14.1	-28.4	0.17	GYROMS
2900.0	0.92	201.58	2899.6	-15.7	33.2	241.85	-15.7	-29.3	0.33	GYROMS
3000.0	1.08	188.83	2999.6	-17.3	34.4	239.73	-17.3	-29.7	0.27	GYROMS
3100.0	0.67	203.09	3099.6	-18.8	35.5	237.98	-18.8	-30.1	0.46	GYROMS
3200.0	0.92	187.27	3199.6	-20.1	36.5	236.48	-20.1	-30.4	0.33	GYROMS
3300.0	0.83	182.59	3299.5	-21.7	37.4	234.65	-21.7	-30.5	0.11	GYROMS
3400.0	0.75	186.82	3399.5	-23.0	38.3	233.07	-23.0	-30.6	0.10	GYROMS
3500.0	0.58	202.98	3499.5	-24.1	39.2	232.01	-24.1	-30.9	0.25	GYROMS
3600.0	0.50	210.17	3599.5	-25.0	40.1	231.43	-25.0	-31.3	0.10	GYROMS
3666.0	0.25	184.30	3666.5	-25.4	40.4	231.13	-25.4	-31.5	0.45	GYROMS
3702.0	1.20	170.60	3701.5	-25.8	40.7	230.59	-25.8	-31.4	2.66	MWD
3734.0	1.80	176.40	3733.5	-26.7	41.2	229.62	-26.7	-31.3	1.93	MWD
3766.0	2.20	178.10	3765.5	-27.8	41.8	228.41	-27.8	-31.3	1.26	MWD
3797.0	2.90	180.20	3796.5	-29.2	42.8	227.01	-29.2	-31.3	2.28	MWD
3828.0	3.10	183.20	3827.4	-30.8	43.9	225.51	-30.8	-31.3	0.82	MWD
3858.0	3.30	185.20	3857.4	-32.4	45.2	224.11	-32.4	-31.5	0.76	MWD
3890.0	3.70	185.00	3889.3	-34.4	46.7	222.60	-34.4	-31.6	1.25	MWD
3922.0	4.00	185.50	3921.2	-36.5	48.5	221.06	-36.5	-31.8	0.94	MWD
3953.0	4.90	184.60	3952.1	-38.9	50.4	219.45	-38.9	-32.0	2.91	MWD
3985.0	5.50	183.20	3984.0	-41.8	52.8	217.62	-41.8	-32.2	1.92	MWD
4015.0	5.90	184.30	4013.9	-44.8	55.3	215.90	-44.8	-32.4	1.38	MWD
4045.0	6.70	185.20	4043.7	-48.1	58.1	214.22	-48.1	-32.7	2.69	MWD
4076.0	7.20	185.70	4074.4	-51.8	61.5	212.54	-51.8	-33.1	1.62	MWD
4105.0	7.50	186.00	4103.2	-55.5	64.8	211.06	-55.5	-33.4	1.04	MWD
4136.0	8.00	188.90	4133.9	-59.6	68.6	209.67	-59.6	-34.0	2.05	MWD
4166.0	8.80	188.90	4163.6	-64.0	72.8	208.45	-64.0	-34.7	2.67	MWD
4198.0	9.70	186.60	4195.2	-69.1	77.6	207.10	-69.1	-35.3	3.04	MWD
4230.0	10.00	183.60	4226.7	-74.5	82.7	205.68	-74.5	-35.8	1.86	MWD
4261.0	10.60	180.20	4257.2	-80.1	87.8	204.22	-80.1	-36.0	2.75	MWD
4293.0	11.20	179.90	4288.6	-86.1	93.3	202.70	-86.1	-36.0	1.88	MWD
4324.0	11.80	179.90	4319.0	-92.3	99.1	201.31	-92.3	-36.0	1.94	MWD

ANADARKO PETROLEUM CORPORATION

Survey Report

ORIGINAL

Well Name: EUBANK-OWENS-A-3 Page: 2

Survey

CONFIDENTIAL

Survey Calculation Method: MINIMUM CURVATURE

Planned Azimuth

MD ft	Angle deg	Azm bearing	TVD ft	V.Sect ft	← Closure →		Total Coordinates		DLS d/100ft	Tool
					Dist ft	Azm bearing	(N/S) ft	(E/W) ft		
4353.0	12.30	180.90	4347.4	-98.3	104.7	200.13	-98.3	-36.0	1.87	MWD
4385.0	12.70	181.10	4378.6	-105.3	111.3	198.96	-105.3	-36.2	1.26	MWD
4416.0	13.50	182.70	4408.8	-112.3	118.0	197.96	-112.3	-36.4	2.83	MWD
4448.0	14.20	182.90	4439.9	-119.9	125.5	197.05	-119.9	-36.8	2.19	MWD
4477.0	15.20	183.60	4467.9	-127.3	132.6	196.29	-127.3	-37.2	3.50	MWD
4508.0	15.90	184.60	4497.8	-135.6	140.7	195.58	-135.6	-37.8	2.42	MWD
4539.0	15.80	185.70	4527.6	-144.0	149.1	194.99	-144.0	-38.6	1.02	MWD
4570.0	16.20	187.30	4557.4	-152.5	157.5	194.53	-152.5	-39.5	1.92	MWD
4602.0	16.70	188.30	4588.1	-161.5	166.5	194.16	-161.5	-40.8	1.80	MWD
4631.0	17.60	188.30	4615.8	-169.9	175.0	193.88	-169.9	-42.0	3.10	MWD
4663.0	18.30	188.10	4646.3	-179.7	184.9	193.58	-179.7	-43.4	2.20	MWD
4695.0	18.80	186.70	4676.6	-189.8	195.0	193.25	-189.8	-44.7	2.09	MWD
4726.0	19.60	186.00	4705.9	-199.9	205.1	192.91	-199.9	-45.8	2.69	MWD
4758.0	20.00	185.30	4736.0	-210.7	215.9	192.55	-210.7	-46.9	1.45	MWD
4789.0	20.10	185.20	4765.1	-221.3	226.4	192.21	-221.3	-47.9	0.34	MWD
4818.0	20.70	185.30	4792.3	-231.4	236.5	191.91	-231.4	-48.8	2.07	MWD
4849.0	21.40	185.90	4821.2	-242.4	247.5	191.63	-242.4	-49.9	2.36	MWD
4881.0	22.10	186.60	4850.9	-254.2	259.3	191.38	-254.2	-51.2	2.33	MWD
4911.0	22.50	187.60	4878.7	-265.5	270.7	191.20	-265.5	-52.6	1.84	MWD
4942.0	22.90	188.10	4907.3	-277.4	282.6	191.06	-277.4	-54.2	1.43	MWD
4972.0	23.50	188.00	4934.9	-289.1	294.4	190.94	-289.1	-55.9	2.00	MWD
5003.0	23.60	188.10	4963.3	-301.3	306.8	190.82	-301.3	-57.6	0.35	MWD
5033.0	23.20	188.50	4990.8	-313.1	318.7	190.73	-313.1	-59.3	1.43	MWD
5063.0	23.60	188.30	5018.3	-324.9	330.6	190.64	-324.9	-61.1	1.36	MWD
5095.0	24.00	188.30	5047.6	-337.7	343.5	190.56	-337.7	-62.9	1.25	MWD
5126.0	23.90	188.50	5076.0	-350.1	356.1	190.48	-350.1	-64.8	0.42	MWD
5157.0	24.10	188.30	5104.3	-362.6	368.7	190.41	-362.6	-66.6	0.70	MWD
5188.0	24.40	188.90	5132.5	-375.2	381.4	190.35	-375.2	-68.5	1.25	MWD
5219.0	24.10	189.20	5160.8	-387.8	394.1	190.31	-387.8	-70.5	1.05	MWD
5250.0	23.90	189.00	5189.1	-400.2	406.7	190.27	-400.2	-72.5	0.70	MWD
5280.0	24.00	188.70	5216.5	-412.3	418.9	190.23	-412.3	-74.4	0.53	MWD
5311.0	24.40	188.30	5244.8	-424.8	431.6	190.18	-424.8	-76.3	1.39	MWD
5342.0	24.50	188.00	5273.0	-437.5	444.4	190.12	-437.5	-78.1	0.51	MWD
5372.0	24.00	188.10	5300.4	-449.7	456.8	190.06	-449.7	-79.8	1.67	MWD
5403.0	24.20	188.00	5328.7	-462.3	469.4	190.01	-462.3	-81.6	0.66	MWD
5423.0	24.20	188.70	5346.9	-470.4	477.6	189.98	-470.4	-82.8	1.43	MWD
5752.0	21.00	183.00	5650.7	-596.0	603.6	189.16	-596.0	-96.1	1.18	MSS

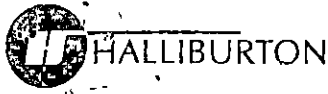

JOB SUMMARY

HALLIBURTON DIVISION
HALLIBURTON LOCATION

MidCont
Lisach Ks

BILLED ON TICKET NO. *812248*

WELL DATA

FIELD _____ SEC. *16* TWP. *29^S* RING. *31^W* COUNTY *Haskell* STATE *Ks*

FORMATION NAME _____ TYPE _____
 FORMATION THICKNESS _____ FROM _____ TO _____
 INITIAL PROD: OIL _____ BPD. WATER _____ BPD. GAS _____ MCFD
 PRESENT PROD: OIL _____ BPD. WATER _____ BPD. GAS _____ MCFD
 COMPLETION DATE _____ MUD TYPE _____ MUD WT. _____
 PACKER TYPE _____ SET AT _____
 BOTTOM HOLE TEMP. _____ PRESSURE _____
 MISC. DATA _____ TOTAL DEPTH _____

	NEW USED	WEIGHT	SIZE	FROM	TO	MAXIMUM PSI ALLOWABLE
CASING		<i>15.5</i>	<i>5 1/2</i>	<i>K13</i>	<i>5743</i>	
LINER						
TUBING						
OPEN HOLE			<i>7 1/2</i>		<i>5228</i>	SHOTS: FT.
PERFORATIONS						
PERFORATIONS						
PERFORATIONS						

ORIGINAL

JOB DATA

TOOLS AND ACCESSORIES		
TYPE AND SIZE	QTY.	MAKE
FLOAT COLLAR <i>Insert Float</i>	<i>1</i>	<i>Hercos</i>
FLOAT SHOE <i>F.L.P.</i>	<i>1</i>	
GUIDE SHOE	<i>1</i>	
CENTRALIZERS	<i>2/4</i>	
BOTTOM PLUG		
TOP PLUG	<i>1</i>	
HEAD	<i>1</i>	
PACKER		
OTHER <i>BASKET</i>	<i>1</i>	

CALLER OUT	ON LOCATION	JOB STARTED	JOB COMPLETED
DATE <i>9-6</i>	DATE <i>9-6</i>	DATE <i>9-6</i>	DATE <i>9-6</i>
TIME <i>0200</i>	TIME <i>0500</i>	TIME <i>1130</i>	TIME <i>1320</i>

PERSONNEL AND SERVICE UNITS		
NAME	UNIT NO. & TYPE	LOCATION
<i>Olson</i>	<i>59179</i>	<i>Lisach Ks</i>
<i>Alison</i>	<i>52938 D</i>	<i>"</i>
<i>D Cooper</i>	<i>7131</i> <i>50404</i> <i>5003</i>	<i>Hg Tom Ks</i>

CONFIDENTIAL

MATERIALS
 TREAT. FLUID _____ DENSITY _____ LB/GAL. °API
 DISPL. FLUID _____ DENSITY _____ LB/GAL. °API
 PROP. TYPE _____ SIZE _____ LB.
 PROP. TYPE _____ SIZE _____ LB.
 ACID TYPE _____ GAL. _____ %
 ACID TYPE _____ GAL. _____ %
 ACID TYPE _____ GAL. _____ %
 SURFACTANT TYPE _____ GAL. _____ IN
 NE AGENT TYPE _____ GAL. _____ IN
 FLUID LOSS ADD. TYPE _____ GAL.-LB. _____ IN
 GELLING AGENT TYPE _____ GAL.-LB. _____ IN
 FRIG. RED. AGENT TYPE _____ GAL.-LB. _____ IN
 BREAKER TYPE _____ GAL.-LB. _____ IN
 BLOCKING AGENT TYPE _____ GAL.-LB. _____
 PERFPAC BALLS TYPE _____ QTY. _____
 OTHER _____
 OTHER _____

DEPARTMENT *Comet* NOV 20
 DESCRIPTION OF JOB **CONFIDENTIAL**

JOB DONE THRU: TUBING CASING ANNULUS TBG./ANN.

CUSTOMER REPRESENTATIVE *X* *John Elmer*
 HALLIBURTON OPERATOR *Don Cow* COPIES REQUESTED _____

CEMENT DATA

STAGE	NUMBER OF SACKS	CEMENT	BRAND	BULK SACKED	ADDITIVES	YIELD CU.FT./5K.	MIXED LBS./GAL.
	<i>50</i>	<i>Veraset</i>	<i>Pennium</i>		<i>9% Veraset, 1% Haled 322</i>		<i>11.0</i>
	<i>160</i>	<i>"</i>	<i>"</i>		<i>5% KCL, 1/4% Flocc</i>	<i>1.41</i>	<i>14.5</i>

PRESSURES IN PSI

CIRCULATING _____ DISPLACEMENT _____
 BREAKDOWN _____ MAXIMUM _____
 AVERAGE _____ FRACTURE GRADIENT _____
 SHUT-IN: INSTANT _____ 5-MIN. _____ 15-MIN. _____
 HYDRAULIC HORSEPOWER _____
 ORDERED _____ AVAILABLE _____ USED _____
 AVERAGE RATES IN BPM _____
 TREATING _____ DISPL. _____ OVERALL _____
 CEMENT LEFT IN PIPE _____
 FEET *43* REASON *Seal bit*

SUMMARY

PRESLUSH: BBL. *20 KCL 30* VOLUMES RECEIVED
 LOAD & BKDN: BBL.-GAL. _____ PAD: BBL.-GAL. _____
 TREATMENT: BBL.-GAL. _____
 CEMENT SLURRY: BBL.-GAL. *22 BBL* *40.5* *21* *1995*
 TOTAL VOLUME: BBL.-GAL. _____

REMARKS
 CONSERVATION DIVISION
 WICHITA, KS

CUSTOMER *MidCont*
 LEASE *Olson*
 WELL NO. *3*
 JOB TYPE *5 1/2" Prod. Str.*
 DATE *9-6-95*



JOB LOG HAL-2013-C

CUSTOMER <i>Academy Petroleum</i>	WELL NO. <i>3</i>	LEASE <i>Orange A</i>	JOB TYPE <i>5 1/2 Prod Stair</i>	TICKET NO. <i>812248</i>
--------------------------------------	----------------------	--------------------------	-------------------------------------	-----------------------------

CHART NO.	TIME	RATE (BPM)	VOLUME (BBL) (GAL)	PUMPS		PRESSURE (PSI)		DESCRIPTION OF OPERATION AND MATERIALS
				T	C	TUBING	CASING	
	0700							Time Called
	0800							Time Ready
	0800							Time out.
	0845							Start Pumping casing
	1120							Casing in hole
	1120							Hook up to Casing
	1130							Circulate casing w/ Pump
	1131							Circulate Mud To Stand level 7 Can. Mud.
	1230							Hook up to Pump Truck
	1234	5	20			250		Start 2% KCl Mudsol.
	1238	/	30			250		Start Mud Flush
	1246	/	20			250		Start 2% KCl
	1250					300		Start Sore Cement w/ 50 ^{SL}
	1254	6.8	22			400		Start Tail Cement
	1258	/	40.17			450		Final Plug Cement
	1259	/	62.17 Total			450		Set Down
	1308	6.2	135.68			500		Start Displacement
	1320					500		Plug Down
								Float Held.
								Circulate Fluid
								Then out 200
								Thanks For Calling
								H. U. Houston
								Ernst
								<i>Ernst</i>

ORIGINAL

RELEASED
MAR 23 1998

FROM CONFIDENTIAL

CONFIDENTIAL

NOV 20

CONFIDENTIAL



HALLIBURTON ENERGY SERVICES

HAL-1906-N

CHARGE TO: *Anadarko Petroleum Corp*

ADDRESS: _____

CITY, STATE, ZIP CODE: _____

TICKET No. 812248 - 8

PAGE 1 OF 1

SERVICE LOCATIONS: 1 *Lybark 25540*, 2 *Hogtown 25555*

WELL/PROJECT NO. *3*

LEASE *OWENS A*

COUNTY/PARISH *Haskell*

STATE *Ks*

CITY/OFFSHORE LOCATION _____

DATE *9-6-95*

OWNER *Anadarko*

TICKET TYPE: SERVICE, SALES

NITROGEN JOB? YES, NO

CONTRACTOR _____

RIG NAME/NO. *Norseman 1#*

SHIPPED VIA *Loc*

DELIVERED TO *3*

ORDER NO. _____

WELL TYPE _____

WELL CATEGORY *01 03*

JOB PURPOSE *035 5 1/2 Prod String*

WELL PERMIT NO. _____

WELL LOCATION *NW of Satant*

REFERRAL LOCATION _____

INVOICE INSTRUCTIONS _____

NOV 20 CONFIDENTIAL

PRICE REFERENCE	SECONDARY REFERENCE/ PART NUMBER	ACCOUNTING			DESCRIPTION	QTY.		UNIT PRICE		AMOUNT
		LOC	ACCT	DF		QTY.	U/M	QTY.	U/M	
000-117		1			MILEAGE	80	Miles	2.75		220.00
001-016		1			Pump Charge	5728	FT			7000.00
030-018		1			Sub Top Pkg	1	Each	60.00		60.00
						2	Hoses	235.00	1 Unit	470.00
12A	825-205	1			Guideshoe	1	Each	121.00		121.00
24A	815-19251	1			Insect Float	1		110.00		110.00
27	815-19311	1			Fill up	1		55.00		55.00
40	806-60022	1			Centralizers	12		60.00		720.00
50	806-60122	1			Centralizers Fluid Masters	12		75.00		900.00
320	806-71430	1			Basket	1		110.00		110.00
314-163		1			Ch Fix II	4	3/4	28.00		112.00
018-315		1			Mud Flush	1260	BAR	.65		819.00

RELEASED MAR 23 1998 FROM CONFIDENTIAL

CONFIDENTIAL

ORIGINAL

LEGAL TERMS: Customer hereby acknowledges and agrees to the terms and conditions on the reverse side hereof which include, but are not limited to, PAYMENT, RELEASE, INDEMNITY, and LIMITED WARRANTY provisions.

MUST BE SIGNED BY CUSTOMER OR CUSTOMER'S AGENT PRIOR TO START OF WORK OR DELIVERY OF GOODS

John Shree

DATE SIGNED _____ TIME SIGNED _____

A.M. P.M.

do do not require IPC (Instrument Protection). Not offered

SUB SURFACE SAFETY VALVE WAS: PULLED & RETURN PULLED RUN

TYPE LOCK _____ DEPTH _____

BEAN SIZE _____ SPACERS _____

TYPE OF EQUALIZING SUB. _____ CASING PRESSURE _____

TUBING SIZE _____ TUBING PRESSURE _____ WELL DEPTH _____

TREE CONNECTION _____ TYPE VALVE _____

SURVEY

AGREE _____ UN-DECIDED _____ DIS-AGREE _____

OUR EQUIPMENT PERFORMED WITHOUT BREAKDOWN?

WE UNDERSTOOD AND MET YOUR NEEDS?

OUR SERVICE WAS PERFORMED WITHOUT DELAY?

WE OPERATED THE EQUIPMENT AND PERFORMED JOB CALCULATIONS SATISFACTORILY?

ARE YOU SATISFIED WITH OUR SERVICE? YES NO

CUSTOMER DID NOT WISH TO RESPOND

PAGE TOTAL	5642.00
FROM CONTINUATION PAGE(S)	48, 28, 35
SUB-TOTAL APPLICABLE TAXES WILL BE ADDED ON INVOICE	

CUSTOMER ACCEPTANCE OF MATERIALS AND SERVICES The customer hereby acknowledges receipt of the materials and services listed on this ticket.

CUSTOMER OR CUSTOMER'S AGENT (PLEASE PRINT) *John Shree*

CUSTOMER OR CUSTOMER'S AGENT (SIGNATURE) *John Shree*

HALLIBURTON OPERATOR/ENGINEER *David Green*

HALLIBURTON APPROVAL *59179*



HALLIBURTON

HALLIBURTON ENERGY SERVICES

FORM 1911 R-10

TICKET CONTINUATION

DUNCAN COPY

13 M.G.

TICKET No. 515749

CUSTOMER Anadarko Petroleum Corp.	WELL Owens "A" #3	DATE 09-06-95	PAGE OF
--------------------------------------	----------------------	------------------	------------

PRICE REFERENCE	SECONDARY REFERENCE/ PART NUMBER	ACCOUNTING			DESCRIPTION	QTY.		U/M		UNIT PRICE	AMOUNT			
		LOC	ACCT	DF										
504-043	516.00272				Premium Cement	210	sk			11.55	2425	50		
507-210	890.50071				Flocele 1/2"W/ 210	53	lb			1.65	87	145		
507-775	516.00144				Halad-322 .6%W/ 210	118	lb			7.00	826	00		
508-095	516.00789				Versaset .9%W/ 210	178	lb			3.90	694	20		
508-002	70.15302				Potassium Chloride 5%W/ 210	600	lb			.27	162	00		
<p>CONFIDENTIAL ORIGINAL NOV 210 CONFIDENTIAL</p> <p>RELEASED MAR 23 1998 FROM CONFIDENTIAL</p>														
500-207					SERVICE CHARGE	CUBIC FEET		214		1.35	288	90		
500-306					MILEAGE CHARGE	TOTAL WEIGHT	20,689	LOADED MILES	33	TON MILES	341.3685	95	324	30

No. B 209778

CONTINUATION TOTAL

11908 35

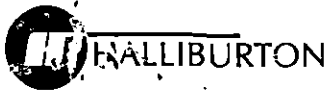

JOB SUMMARY

HALLIBURTON DIVISION Mid CONTINENT
 HALLIBURTON LOCATION Liberal, Ks

BILLED ON TICKET NO. 811460

WELL DATA

FIELD _____ SEC. 16 TWP. 29S RNG. 34W COUNTY HASKELL STATE KS

FORMATION NAME _____ TYPE _____
 FORMATION THICKNESS _____ FROM _____ TO _____
 INITIAL PROD: OIL _____ BPD. WATER _____ BPD. GAS _____ MCFD
 PRESENT PROD: OIL _____ BPD. WATER _____ BPD. GAS _____ MCFD
 COMPLETION DATE _____ MUD TYPE _____ MUD WT. _____
 PACKER TYPE _____ SET AT _____
 BOTTOM HOLE TEMP. _____ PRESSURE _____
 MISC. DATA _____ TOTAL DEPTH _____

	NEW USED	WEIGHT	SIZE	FROM	TO	MAXIMUM PSI ALLOWABLE
CASING	N	15.5	5 1/2			
LINER						
TUBING	N	4.7	2 3/8	KB	3163	
OPEN HOLE						SHOTS/FT.
PERFORATIONS						
PERFORATIONS						
PERFORATIONS						

JOB DATA

TOOLS AND ACCESSORIES		
TYPE AND SIZE	QTY.	MAKE
FLOAT COLLAR		
FLOAT SHOE		
GUIDE SHOE		RELEASED
CENTRALIZERS		
BOTTOM PLUG		MAR 23 1998
TOP PLUG		
HEAD		
PACKER		FROM CONFIDENTIAL
OTHER		

CALLED OUT	ON LOCATION	JOB STARTED	JOB COMPLETED
DATE <u>9-12-95</u>	DATE <u>9-12-95</u>	DATE <u>9-12-95</u>	DATE <u>9-12-95</u>
TIME <u>0500</u>	TIME <u>0830</u>	TIME <u>0932</u>	TIME <u>1220</u>

PERSONNEL AND SERVICE UNITS

NAME	UNIT NO. & TYPE	LOCATION
<u>J. Woodrow 62573</u>	<u>420044 P/L</u>	<u>LIBERAL KS</u>
<u>R. Flwood 04360</u>	<u>53554/75104</u>	
<u>S BOECK H 2345</u>	<u>74200 5068/ACID TRAMPOL</u>	
<u>D. CORPUS G2728</u>	<u>178067 3625/BULK</u>	<u>HUGOTON KS</u>

MATERIALS

TREAT. FLUID _____ DENSITY _____ LB./GAL. °API
 DISPL. FLUID _____ DENSITY _____ LB./GAL. °API
 PROP. TYPE _____ SIZE _____ LB.
 PROP. TYPE _____ SIZE _____ LB.
 ACID TYPE FF GAL. 200 % 15
 ACID TYPE _____ GAL. _____ %
 ACID TYPE _____ GAL. _____ %
 SURFACTANT TYPE _____ GAL. _____ IN.
 NE AGENT TYPE _____ GAL. _____ IN.
 FLUID LOSS ADD. TYPE _____ GAL.-LB. _____ IN.
 GELLING AGENT TYPE _____ GAL.-LB. _____ IN.
 FRIC. RED. AGENT TYPE _____ GAL.-LB. _____ IN.
 BREAKER TYPE _____ GAL.-LB. _____ IN.
 BLOCKING AGENT TYPE _____ GAL.-LB. _____
 PERFPAC BALLS TYPE _____ QTY. _____
 OTHER HAI-81M INHIBITOR 1 GAL
 OTHER _____

ORIGINAL **CONFIDENTIAL**

DEPARTMENT CEMENT
 DESCRIPTION OF JOB RECEMENT THROUGH TO TOOL - ACIDIZE TBS
 JOB DONE THRU: TUBING CASING ANNULUS TBG/ANN.

CUSTOMER REPRESENTATIVE X Joe Shree
 HALLIBURTON OPERATOR J Woodrow COPIES REQUESTED _____

CEMENT DATA

STAGE	NUMBER OF SACKS	CEMENT	BRAND	BULK SACKED	ADDITIVES	YIELD CU.FT./SK.	MIXED LBS./GAL.
	<u>60</u>	<u>mid con 2</u>	<u>HALCO</u>		<u>28 CG 1/4" FLOCC</u>	<u>3.22</u>	<u>11.1</u>

PRESSURES IN PSI

SUMMARY

VOLUMES

CIRCULATING _____ DISPLACEMENT _____ PRESURUSH: BBL.-GAL. _____ TYPE _____
 BREAKDOWN _____ MAXIMUM _____ LOAD & BKDN: BBL.-GAL. _____ PAD: BBL.-GAL. _____
 AVERAGE _____ FRACTURE GRADIENT _____ TREATMENT: BBL.-GAL. _____ DISPL: BBL.-GAL. 12.5
 SHUT-IN: INSTANT _____ 5-MIN _____ 15-MIN. _____ CEMENT SLURRY: BBL.-GAL. 35.0
 HYDRAULIC HORSEPOWER _____ TOTAL VOLUME: BBL.-GAL. _____
 ORDERED _____ AVAILABLE _____ USED _____ REMARKS LEFT MSDS SHEETS ON RIG
 AVERAGE RATES IN BPM _____
 TREATING _____ DISPL. _____ OVERALL _____
 CEMENT LEFT IN PIPE _____
 FEET _____ REASON _____

CUSTOMER Andlers Petroleum
 LEASE Quinn
 WELL NO. A-3
 JOB TYPE Reacement
 DATE 9-12-95

JOB LOG HWL-2013-C

CUSTOMER		WELL NO.		LEASE		JOB TYPE		TICKET NO.	
APC		A-3		OWENS		RECEMENT /		21460	
CHART NO.	TIME	RATE (BPM)	VOLUME (BBL) (GAL)	PUMPS		PRESSURE (PSI)		DESCRIPTION OF OPERATION AND MATERIALS	
				T	C	TUBING	CASING		
	0900							JOB READY	
	0830							CALLED OUT FOR JOB PUMP TRUCK ON LOCATION - RIG RUNNING IN 2 3/8 TBG - SET UP PUMP TRUCK BUNK TRUCK ON LOCATION - TBG IN HOLE 3193' HOOK UP TO 2 7/8 TBG -	
	0900							TEST - HOLDING OPEN FO TOOL PUMP INTO & ESTABLISH CIRCULATION PUMP 20 BBL 2% KCL WATER START MIXING 60 SKS MID CON 2 THROUGH MIXING CMT START DISPLACING PUMP 12 BBLs SHUT DOWN - CLOSE FO TOOL PRESSURE TEST - HOLDING RUN 2 STS TBG IN REVERSE OUT -	
	0932					1000'	1000'	CONFIDENTIAL PUMP 20 BBLs SHUT DOWN REVERSE OUT 1/2 BBLs FINISH RUNNING TBG TO BOTTOM 5693' HOOK UP TO 2 7/8 TBG PUMP 200 GAL ACID DOWN TBG AT 1 BPM PUMP 17 BBLs WATER BEHIND HOOK UP TO ANNULUS PUMP ACID BACK OUT TBG JOB COMPLETE	
	0935	2.5	20.0	✓		350'			
	0945	3.0				0'380			
	0950	3.0	35.0	✓		0'380			
	0950	3.0							
	0957		12.0	✓		1500'			
	1015	3.5	20.0	✓	✓	800'			
	1145	1.0	5.0	✓		0'200			
	1205	1.0	18.0	✓		0'200			
	1206	1.0	25.0	✓		0'200		RELEASED MAR 23 1998 FROM CONFIDENTIAL	
	1226							THANK YOU! WOODY, ROBERT CALL AGAIN! PUMP TIME - 1 HR 2 min ON LOCATION TIME - 3 HR 18 min	

NOV 27 0
 CONFIDENTIAL



HALLIBURTON ENERGY SERVICES

HAL-1906-N

CHARGE TO

ADDRESS *AMADARKO PETROLEUM*

CITY STATE ZIP CODE

DUPLICATE COPY

TICKET

No.

811460 - 1

PAGE 1 OF 3

SERVICE LOCATIONS 1. <i>025540 LIBERAL</i>	WELL/PROJECT NO. <i>A-3</i>	LEASE <i>CONURS</i>	COUNTY/PARISH <i>HALLIBURTON</i>	STATE <i>TX</i>	CITY/OFFSHORE LOCATION <i>LIBERAL</i>	DATE <i>7-12-95</i>	OWNER <i>AMADARKO</i>
2. <i>025540 HUGSTON</i>	TICKET TYPE <input type="checkbox"/> SERVICE <input type="checkbox"/> SALES	NITROGEN JOB? <input type="checkbox"/> YES <input type="checkbox"/> NO	CONTRACTOR	RIG NAME/NO.	SHIPPED VIA <i>TRUCK</i>	DELIVERED TO	ORDER NO.
3.	WELL TYPE	WELL CATEGORY	JOB PURPOSE	WELL PERMIT NO.	WELL LOCATION		
4. REFERRAL LOCATION	INVOICE INSTRUCTIONS <i>01 OIL 01 DELIVERY POINT 05 RIGMENT</i>						

PRICE REFERENCE	SECONDARY REFERENCE/ PART NUMBER	ACCOUNTING			DESCRIPTION	QTY.	U/M	QTY.	U/M	UNIT PRICE	AMOUNT
		LOC	ACCT	DF							
000-117		1			MILEAGE	40	mi	2	EA	2.05	220.00
009-017		1			Pump CHARGE	3173	FT	6	HR	15.70	13700.00
207-001	201-064	1			FE ACID	200	gal	15	EA	1.33	266.00
210-017		1			HAIR	1	EA			37.00	37.00
000-130		1			Dump TRUCK	40	mi	2	EA	1.45	118.00

ORIGINAL

CONFIDENTIAL

RELEASED

MAR 23 1996

NOV 20

FROM CONFIDENTIAL CONFIDENTIAL

LEGAL TERMS: Customer hereby acknowledges and agrees to the terms and conditions on the reverse side hereof which include, but are not limited to, PAYMENT, RELEASE, INDEMNITY, and LIMITED WARRANTY provisions. MUST BE SIGNED BY CUSTOMER OR CUSTOMER'S AGENT PRIOR TO START OF WORK OR DELIVERY OF GOODS	SUB SURFACE SAFETY VALVE WAS: <input type="checkbox"/> PULLED & RETURN <input type="checkbox"/> PULLED <input type="checkbox"/> RUN		SURVEY		AGREE	UN-DECIDED	DIS-AGREE	PAGE TOTAL <i>223.00</i> FROM CONTINUATION PAGE(S) <i>1247.75</i> <i>3490.45</i>
	TYPE LOCK	DEPTH	OUR EQUIPMENT PERFORMED WITHOUT BREAKDOWN?		/			
	BEAN SIZE	SPACERS	WE UNDERSTOOD AND MET YOUR NEEDS?		/			
	TYPE OF EQUALIZING SUB.	CASING PRESSURE	OUR SERVICE WAS PERFORMED WITHOUT DELAY?		/			
DATE SIGNED <i>7-12-95</i>	TIME SIGNED <i>5:00</i>	TUBING SIZE	TUBING PRESSURE	WELL DEPTH	WE OPERATED THE EQUIPMENT AND PERFORMED JOB CALCULATIONS SATISFACTORILY?		/	
<input type="checkbox"/> do <input type="checkbox"/> do not require IPC (Instrument Protection) <input type="checkbox"/> Not offered		TREE CONNECTION	TYPE VALVE		ARE YOU SATISFIED WITH OUR SERVICE? <input type="checkbox"/> YES <input type="checkbox"/> NO		SUB-TOTAL APPLICABLE TAXES WILL BE ADDED ON INVOICE	
				<input type="checkbox"/> CUSTOMER DID NOT WISH TO RESPOND				

CUSTOMER ACCEPTANCE OF MATERIALS AND SERVICES The customer hereby acknowledges receipt of the materials and services listed on this ticket.

CUSTOMER OR CUSTOMER'S AGENT (PLEASE PRINT)	CUSTOMER OR CUSTOMER'S AGENT (SIGNATURE) <i>X [Signature]</i>	HALLIBURTON OPERATOR/ENGINEER <i>[Signature]</i>	EMP #	HALLIBURTON APPROVAL
---	--	---	-------	----------------------



HALLIBURTON JOB SUMMARY

HALLIBURTON DIVISION
HALLIBURTON LOCATION

Mid Cont.
Liberal, Ks

BILLED ON TICKET NO. 812240

WELL DATA

FIELD _____ SEC 16 TWP. 29S RING. 34W COUNTY Haskell STATE Ks

FORMATION NAME _____ TYPE _____

FORMATION THICKNESS _____ FROM _____ TO _____

INITIAL PROD: OIL _____ BPD. WATER _____ BPD. GAS _____ MCFD

PRESENT PROD: OIL _____ BPD. WATER _____ BPD. GAS _____ MCFD

COMPLETION DATE _____ MUD TYPE _____ MUD WT. _____

PACKER TYPE _____ SET AT _____

BOTTOM HOLE TEMP. _____ PRESSURE _____

MISC. DATA _____ TOTAL DEPTH _____

	NEW USED	WEIGHT	SIZE	FROM	TO	MAXIMUM PSI ALLOWABLE
CASING		24	8 3/4	KB	1810	
LINER						
TUBING						
OPEN HOLE			12 1/4	GL	1810	SHOTS/FT
PERFORATIONS						
PERFORATIONS						
PERFORATIONS						

JOB DATA

CALLED OUT	ON LOCATION	JOB STARTED	JOB COMPLETED
DATE 8-22	DATE 8-22	DATE 8-22	DATE 8-22
TIME 1750	TIME 1500	TIME 2050	TIME 2215

PERSONNEL AND SERVICE UNITS

NAME	UNIT NO. & TYPE	LOCATION
D. G. ...	420041	Liberal, Ks
H. ...	59179	"
N. ...	52932 A	"
J. ...	56673	"
J. ...	4037	Horton, Ks
J. ...	75817	"
D. ...	3625 / 5363	"

TOOLS AND ACCESSORIES

TYPE AND SIZE	QTY.	MAKE
Float	1	Howco
Float Shoe	1	
Guide Shoe	1	
Centralizers	5	
Bottom Plug		
Top Plug	1	
Head	1	
Packer		
Other	1 CB	

MATERIALS

TREAT. FLUID _____ DENSITY _____ LB/GAL. °API

DISPL. FLUID _____ DENSITY _____ LB/GAL. °API

PROP. TYPE _____ SIZE _____ LB.

ACID TYPE _____ GAL. _____ %

SURFACTANT TYPE _____ GAL. _____ IN _____

NE AGENT TYPE _____ GAL. _____ IN _____

FLUID LOSS ADD. TYPE _____ GAL.-LB. _____

GELLING AGENT TYPE _____ GAL.-LB. _____

FRIC. RED. AGENT TYPE _____ GAL.-LB. _____

BREAKER TYPE _____ GAL.-LB. _____

BLOCKING AGENT TYPE _____ GAL.-LB. _____

PERFPAC BALLS TYPE _____ QTY. _____

OTHER _____

OTHER _____

ORIGINAL - CONFIDENTIAL

DEPARTMENT: Center

DESCRIPTION OF JOB: 8 3/4 SUEX

JOB DONE THRU: TUBING CASING ANNULUS TBG ANN

CUSTOMER REPRESENTATIVE: X. ...

HALLIBURTON OPERATOR: D. ...

COPIES REQUESTED: _____

CEMENT DATA

STAGE	NUMBER OF SACKS	CEMENT	BRAND	BULK SACKED	ADDITIVES	YIELD CU FT SK	MIXED LBS GAL
	340	MudCem	D+	290 lb	1/4 # Flocc	3.22	11.1
	160	Rem Plus		290 lb	1/4 # Flocc	1.32	14.8

RELEASED
MAR 23 1998

PRESSURES IN PSI

SUMMARY

FROM CONFIDENTIAL

CIRCULATING _____ DISPLACEMENT _____ PRESLUSH: BBL.-GAL. _____ TYPE _____

BREAKDOWN _____ MAXIMUM _____ LOAD & BKDN BBL.-GAL. _____ PAD BBL.-GAL. _____

AVERAGE _____ FRACTURE GRADIENT _____ TREATMENT: BBL.-GAL. _____ DISPL BBL.-GAL. 112.62

SHUT-IN INSTANT _____ 5-MIN _____ 15-MIN _____ CEMENT SLURRY, BBL.-GAL. 232.59

HYDRAULIC HORSEPOWER _____ TOTAL VOLUME, BBL.-GAL. _____

ORDERED _____ AVAILABLE _____ USED _____ REMARKS _____

AVERAGE RATES IN BPM _____

TREATING _____ DISPL _____ OVERALL _____

CEMENT LEFT IN PIPE _____

FEET 112 REASON Stop Job

CUSTOMER

CUSTOMER: 1. ...
JOB TYPE: ...
WELL NO.: ...
DATE: ...

JOB LOG HAL-2013-C

 CUSTOMER **Landmark Ptes** WELL NO. **3#** LEASE **Owens A** JOB TYPE **2 1/2" COFACE** TICKET NO. **3122410**

CHART NO.	TIME	RATE (BPM)	VOLUME (BBL) (GAL)	PUMPS		PRESSURE (PSI)		DESCRIPTION OF OPERATION AND MATERIALS
				T	C	TUBING	CASING	
	11250							Time Called
	11630							Time Ready
	1500							Time out of
	1950							Start Pumping Casing
	2050							Casing in Hole
	2051							Hook Up To Circulate Casing
	2057							Circulate Casing ¹⁰ Pump
	2059							Circulate Ahd To Ground Level
	2109							Hook Up To Pump Truck
	2112							Start Mix Cement
	2141		194.94					Start Tail Cement
	2146		37.61					Finish Mix Cement
	2147		232.55					Shut Down Drop Plug
	2148							Start Displacement
								wash Pipes Lines
	2215		112.62					Plug Down
								Float Held
								Circulate Cement To The P.T
								Thanks For Calling Halliburton Energy

ORIGINAL
CONFIDENTIAL
RELEASED
MAR 23 1998
FROM CONFIDENTIAL

RUC

NOV 2 0

CONFIDENTIAL



HALLIBURTON

HALLIBURTON ENERGY SERVICES

HAL-1906-N

CHANGE TO

ADDRESS

CITY STATE ZIP CODE

Anadarko Petros. Corp.

TICKET

812240 - 0

PAGE 1 OF 1

RELEASED

MAR 23 1996

FROM CONFIDENTIAL

SERVICE LOCATIONS 125540 <i>Lisual Ks</i> 225535 <i>Hogton Ks</i>	WELL/PROJECT NO. 3#	LEASE <i>Owens A</i>	COUNTY/PARISH <i>Haskell</i>	STATE <i>Ks</i>	CITY/OFFSHORE LOCATION	DATE <i>8-22-95</i>	OWNER <i>Anadarko</i>	
TICKET TYPE <input checked="" type="checkbox"/> SERVICE <input type="checkbox"/> SALES	NITROGEN JOB? <input type="checkbox"/> YES <input checked="" type="checkbox"/> NO	CONTRACTOR	RIG NAME/NO. <i>Norseman Del 1</i>	SHIPPED VIA	DELIVERED TO <i>Loc</i>	ORDER NO.		
3.	WELL TYPE	WELL CATEGORY <i>01 03</i>	JOB PURPOSE <i>010 8 1/2 SURFACE</i>	WELL PERMIT NO.	WELL LOCATION <i>NW OF SATANTA</i>			
4.	REFERRAL LOCATION	INVOICE INSTRUCTIONS						

PRICE REFERENCE	SECONDARY REFERENCE/ PART NUMBER	ACCOUNTING			DESCRIPTION	QTY.	U/M	QTY.	U/M	UNIT PRICE	AMOUNT
		LOC	ACCT	DF							
000-117		1			MILEAGE	84	miles			2.75	231.00
001-016		1			Pump charge	1810	FI				1320.00
030-018		1			Sub Top P/S	1	Eq	84	8/8	130.00	130.00
12A	825-217				Guide shoe	1	Foot		8 5/8	216.00	216.00
24A	815-19502				Insert Float	1				171.00	171.00
27	815-19415				Fillup	1				55.00	55.00
40	806-61048				Centrifizers	5				65.00	325.00
320	806-71460				Basket	1				110.00	110.00
350	890-10802				Hewco weld A	1	lbs			14.50	14.50

CONFIDENTIAL NOV 20 1995

LEGAL TERMS: Customer hereby acknowledges and agrees to the terms and conditions on the reverse side hereof which include, but are not limited to, PAYMENT, RELEASE, INDEMNITY, and LIMITED WARRANTY provisions.

MUST BE SIGNED BY CUSTOMER OR CUSTOMER'S AGENT PRIOR TO START OF WORK OR DELIVERY OF GOODS

Jim Barlow

DATE SIGNED: *8-22-95* TIME SIGNED: *1800*

A.M. P.M.

do do not require IPC (Instrument Protection). Not offered

SUB SURFACE SAFETY VALVE WAS:
 PULLED & RETURN PULLED RUN

TYPE LOCK DEPTH

BEAN SIZE SPACERS

TYPE OF EQUALIZING SUB. CASING PRESSURE

TUBING SIZE TUBING PRESSURE WELL DEPTH

TREE CONNECTION TYPE VALVE

SURVEY

OUR EQUIPMENT PERFORMED WITHOUT BREAKDOWN?

WE UNDERSTOOD AND MET YOUR NEEDS?

OUR SERVICE WAS PERFORMED WITHOUT DELAY?

WE OPERATED THE EQUIPMENT AND PERFORMED JOB CALCULATIONS SATISFACTORILY?

ARE YOU SATISFIED WITH OUR SERVICE?
 YES NO

CUSTOMER DID NOT WISH TO RESPOND

PAGE TOTAL	2572.00
FROM CONTINUATION PAGE(S)	9675.15
Fe. to TOTAL	12247.15
SUB-TOTAL APPLICABLE TAXES WILL BE ADDED ON INVOICE	

CUSTOMER ACCEPTANCE OF MATERIALS AND SERVICES

The customer hereby acknowledges receipt of the materials and services listed on this ticket.

CUSTOMER OR CUSTOMER'S AGENT (PLEASE PRINT) <i>Jim Barlow</i>	CUSTOMER OR CUSTOMER'S AGENT (SIGNATURE) <i>Jim Barlow</i>	HALLIBURTON OPERATOR/ENGINEER <i>[Signature]</i>	EMP # 59174	HALLIBURTON APPROVAL
--	---	---	----------------	----------------------

