

FOR KCC USE:

FORM MUST BE TYPED

EFFECTIVE DATE: 9-6-93

FORM MUST BE SIGNED

DISTRICT # 2

NOTICE OF INTENTION TO DRILL

ALL BLANKS MUST BE FILLED

SEAT Yes No

Must be approved by the K.C.C. five (5) days prior to commencing well

Expected Spud Date September 4, 1993

Spot 50's of Neadsuff Sec 20 Twp 25 S. Rg 9W West

OPERATOR: License # 31160 PHILLIPS EXPLORATION CO. Name: PHILLIPS EXPLORATION CO. Address: 100 South Main, Suite #510 City/State/Zip: Wichita, Kansas 67202 Contact Person: James B. Phillips Phone: (316) 265-2857

2010 1930 feet from South / North Line of Section 2070 1780 feet from East / West Line of Section IS SECTION X REGULAR IRREGULAR?

CONTRACTOR: License #: 5140 Sterling Drilling Company

(NOTE: Locate well on the Section Plat on Reverse Side) County: Reno Lease Name: Conkling Well #: 1-20A Field Name: Langdon

Table with columns: Well Drilled For, Well Class, Type Equipment. Rows include Oil, Gas, OWMO, Seismic, etc.

Is this a Prorated/Spaced Field? Target Formation(s): Nearest lease or unit boundary: Ground Surface Elevation: Water well within one-quarter mile: Public water supply well within one mile: Depth to bottom of fresh water: Depth to bottom of usable water: Surface Pipe by Alternate: Length of Surface Pipe Planned to be set: Length of Conductor pipe required: Projected Total Depth: Formation at Total Depth: Water Source for Drilling Operations:

If OWMO: old well information as follows: Operator: Well Name: Comp. Date: Old Total Depth

Directional, Deviated or Horizontal wellbore? If yes, true vertical depth: Bottom Hole Location

DWR Permit #: Will Cores Be Taken?: If yes, proposed zone:

AFFIDAVIT

The undersigned hereby affirms that the drilling, completion and eventual plugging of this well will comply with K.S.A. 55-101, et. seq. It is agreed that the following minimum requirements will be met:

- 1. Notify the appropriate district office prior to spudding of well;
2. A copy of the approved notice of intent to drill shall be posted on each drilling rig;
3. The minimum amount of surface pipe as specified below shall be set by circulating cement to the top;
4. If the well is dry hole, an agreement between the operator and the district office on plug length and placement is necessary prior to plugging;
5. The appropriate district office will be notified before well is either plugged or production casing is cemented in;
6. IF AN ALTERNATE II COMPLETION, PRODUCTION PIPE SHALL BE CEMENTED FROM BELOW ANY USABLE WATER TO SURFACE WITHIN 120 DAYS OF SPUD DATE.

I hereby certify that the statements made herein are true and to the best of my knowledge and belief. Date: August 26, 1993 Signature of Operator or Agent: Richard L. Mead Title: Agent

FOR KCC USE: API # 15-155-21286-0000 Conductor pipe required None feet Minimum surface pipe required 150 feet per Alt. Approved by: CB 8-1-93 This authorization expires: 3-1-94 (This authorization void if drilling not started within 6 months of effective date.) Spud date: Agent:

RECEIVED STATE CORPORATION COMMISSION 8-27-93 AUG 27 1993

REMEMBER TO:

- File Drill Pit Application (form CDP-1) with Intent to Drill;
- File Completion Form ACO-1 within 120 days of spud date;
- File acreage attribution plat according to field proration orders;
- Notify appropriate district office 48 hours prior to workover or re-entry;
- Submit plugging report (CP-4) after plugging is completed;
- Obtain written approval before disposing or injecting salt water.

CONSERVATION DIVISION Wichita, Kansas

Mail to: Conservation Division, 200 Colorado Derby Building, 202 W. First St., Wichita, Kansas 67202-1286.

Handwritten numbers: 20, 25, 9

**IN ALL CASES PLOT THE INTENDED WELL ON THE PLAT BELOW**

**PLAT OF ACREAGE ATTRIBUTABLE TO A WELL IN A PRORATED OR SPACED FIELD**

If the intended well is in a prorated or spaced field, please fully complete this side of the form. If the intended well is in a prorated or spaced field complete the plat below showing that the well will be properly located in relationship to other wells producing from the common source of supply. Please show all the wells within 1 mile of the boundaries of the proposed acreage attribution unit for gas wells and within 1/2 mile of the boundaries of the proposed acreage attribution unit for oil wells.

API NO. 15. \_\_\_\_\_  
 OPERATOR \_\_\_\_\_  
 LEASE \_\_\_\_\_  
 WELL NUMBER \_\_\_\_\_  
 FIELD \_\_\_\_\_

LOCATION OF WELL: COUNTY Reno  
 \_\_\_\_\_ feet from south/north line of section  
 \_\_\_\_\_ feet from east/west line of section  
 SECTION 20 TWP 25S RG 9W

NUMBER OF ACRES ATTRIBUTABLE TO WELL 160  
 QTR/QTR/QTR OF ACREAGE \_\_\_\_\_ SW/4

IS SECTION X REGULAR or \_\_\_\_\_ IRREGULAR  
IF SECTION IS IRREGULAR, LOCATE WELL FROM NEAREST CORNER BOUNDARY.

Section corner used: \_\_\_\_\_ NE \_\_\_\_\_ NW \_\_\_\_\_ SE \_\_\_\_\_ SW

**PLAT**

(Show location of the well and shade attributable acreage for prorated or spaced wells.)  
 (Show footage to the nearest lease or unit boundary line.)

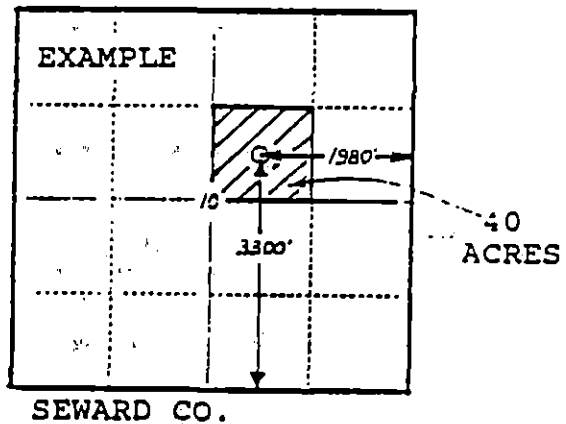
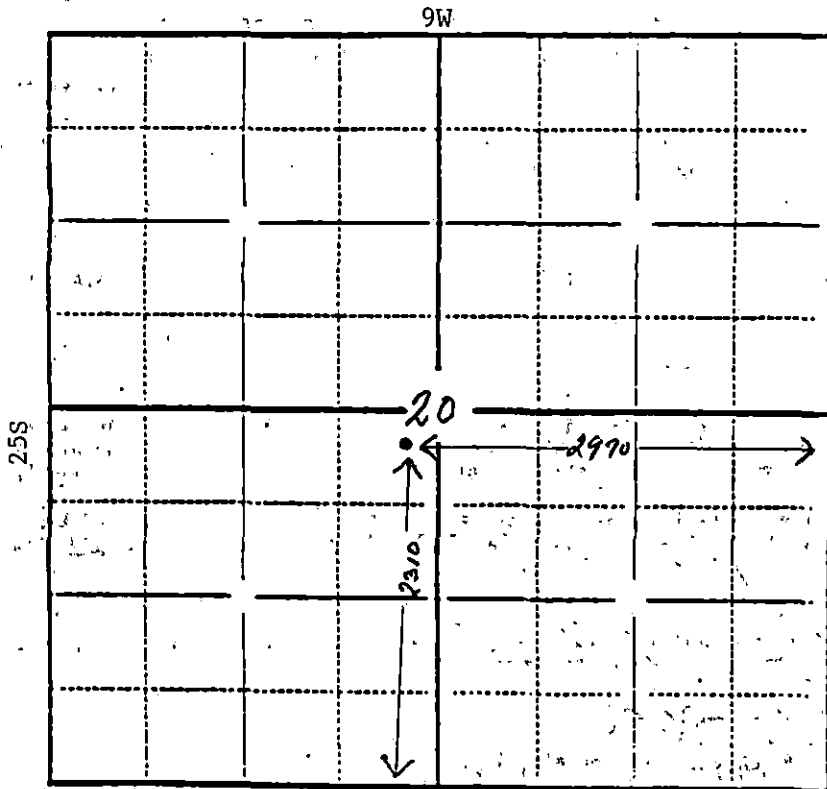

**In plotting the proposed location of the well, you must show:**

- 1) The manner in which you are using the depicted plat by identifying section lines, i.e. 1 section, 1 section with 8 surrounding sections, 4 sections, etc.;
- 2) the distance of the proposed drilling location from the section's south/north and east/west lines; and
- 3) the distance to the nearest lease or unit boundary line.