

FOR KCC USE:

FORM C-1 7/91

EFFECTIVE DATE: 12-8-92

FORM MUST BE TYPED

DISTRICT: 2

State of Kansas

FORM MUST BE SIGNED

SRAC: Yes...No

NOTICE OF INTENTION TO DRILL

ALL BLANKS MUST BE FILLED

Must be approved by the K.C.C. five (5) days prior to commencing well

Expected Spud Date 12 month 15 day 92 year

Spot SW SW SW Sec 9 Twp 25 S, Rg 9 East West

OPERATOR: License # 5011 Name: Viking Resources, Inc. Address: 105 S. Broadway, Suite 1040 City/State/Zip: Wichita, KS. 67202 Contact Person: James B. Devlin Phone: (316). 262-2502 262-2548

330 feet from South / North line of Section 330 feet from East / West line of Section IS SECTION X REGULAR IRREGULAR?

CONTRACTOR: License #: 5142 Name: Sterling Drilling Co.

(NOTE: Locate well on the Section Plat on Reverse Side) County: Reno

Well Drilled For: Well Class: Type Equipment: X Oil Enh Rec Infield X Mud Rotary X Gas Storage X Pool Ext. Air Rotary OWDG Disposal Wildcat Cable Seismic: # of Holes Other

Lease Name: Borth Well # 1 Field Name: Wildcat

If OWDG: old well information as follows: Operator: Well Name: Comp. Date: Old Total Depth

Is this a Prorated/Spaced Field? yes X no Target Formation(s): Mississippi

Directional, Deviated or Horizontal wellbore? yes X no If yes, true vertical depth: Bottom Hole Location

Nearest lease or unit boundary: 330 Ground Surface Elevation: unknown feet MSL

AFFIDAVIT

The undersigned hereby affirms that the drilling, completion and eventual plugging of this well will comply with K.S.A. 55-101, et. seq. It is agreed that the following minimum requirements will be met:

- 1. Notify the appropriate district office prior to spudding of well; 2. A copy of the approved notice of intent to drill shall be posted on each drilling rig; 3. The minimum amount of surface pipe as specified below shall be set by circulating cement to the top; in all cases surface pipe shall be set through all unconsolidated materials plus a minimum of 20 feet into the underlying formation; 4. If the well is dry hole, an agreement between the operator and the district office on plug length and placement is necessary prior to plugging; 5. The appropriate district office will be notified before well is either plugged or production casing is cemented in; 6. IF AN ALTERNATE II COMPLETION, PRODUCTION PIPE SHALL BE CEMENTED FROM BELOW ANY USABLE WATER TO SURFACE WITHIN 120 DAYS OF SPUD DATE. IN ALL CASES, NOTIFY DISTRICT OFFICE PRIOR TO ANY CEMENTING.

I hereby certify that the statements made herein are true and to the best of my knowledge and belief. Date: 11-30-92 Signature of Operator or Agent: James B. Devlin Title: President

FOR KCC USE: API # 15- 155- 21, 237-0000 Conductor pipe required None feet Minimum surface pipe required 125 feet per Alt. X Approved by: CB 12-3-92 This authorization expires: 5-3-93 (This authorization void if drilling not started within 6 months of effective date.) Spud date: Agent:

REMEMBER TO:

- File Drill Pit Application (form CDP-1) with Intent to Drill; - File Completion Form ACO-1 within 120 days of spud date; - File acreage attribution plat according to field proration orders; - Notify appropriate district office 48 hours prior to workover or re-entry; - Submit plugging report (GP-4) after plugging is completed; - Obtain written approval before disposing or injecting salt water.

Mail to: Conservation Division, 200 Colorado Derby Building, 202 W. First St., Wichita, Kansas 67202-1286.

RECEIVED STATE CORPORATION COMMISSION NOV 27 1992 11-23-92 Kansas

IN ALL CASES PLOT THE INTENDED WELL ON THE PLAT BELOW

PLAT OF ACREAGE ATTRIBUTABLE TO A WELL IN A PRORATED OR SPACED FIELD

If the intended well is in a prorated or spaced field, please fully complete this side of the form. If the intended well is in a prorated or spaced field complete the plat below showing that the well will be properly located in relationship to other wells producing from the common source of supply. Please show all the wells within 1 mile of the boundaries of the proposed acreage attribution unit for gas wells and within 1/2 mile of the boundaries of the proposed acreage attribution unit for oil wells.

API NO. 15- _____
 OPERATOR Viking Resources, Inc.
 LEASE Borth
 WELL NUMBER 1
 FIELD Langdon

LOCATION OF WELL: COUNTY Reno
 _____ feet from south/~~north~~ line of section
330 feet from east/~~west~~ line of section
 SECTION 9 TWP 25 RG 9

NUMBER OF ACRES ATTRIBUTABLE TO WELL _____
 QTR/QTR/QTR OF ACREAGE SW SW SW

IS SECTION x REGULAR or _____ IRREGULAR
IF SECTION IS IRREGULAR, LOCATE WELL FROM NEAREST CORNER BOUNDARY.

Section corner used: _____ NE _____ NW _____ SE _____ SW
PLAT

(Show location of the well and shade attributable acreage for prorated or spaced wells.)
 (Show footage to the nearest lease or unit boundary line.)

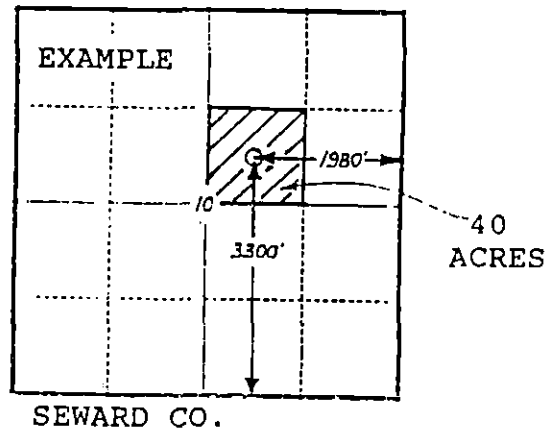
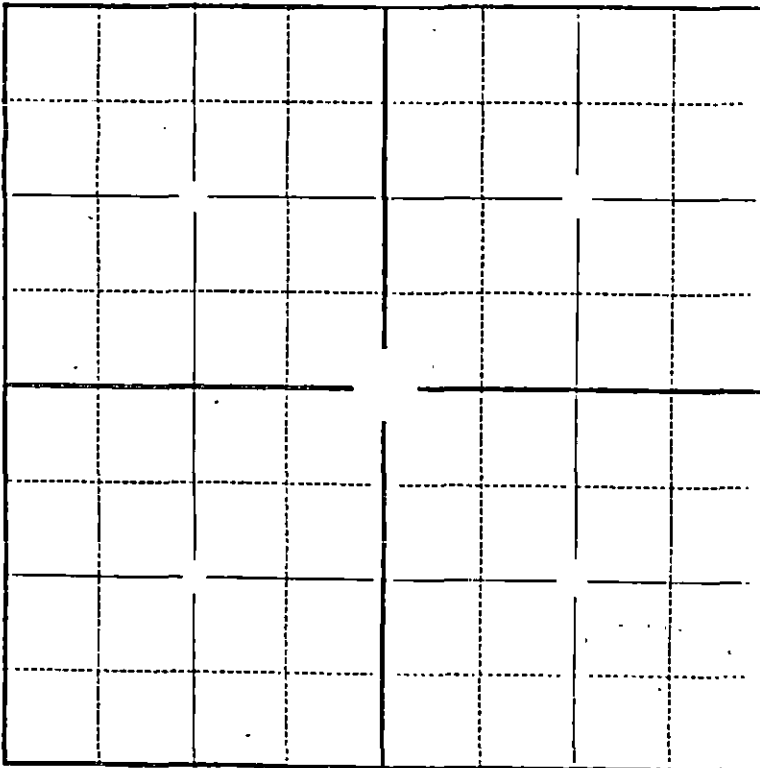

In plotting the proposed location of the well, you must show:

- 1) The manner in which you are using the depicted plat by identifying section lines, i.e. 1 section, 1 section with 8 surrounding sections, 4 sections, etc.;
- 2) the distance of the proposed drilling location from the section's south/north and east/west lines; and
- 3) the distance to the nearest lease or unit boundary line.