

STATE OF KANSAS
STATE CORPORATION COMMISSION

WELL PLUGGING RECORD

Give All Information Completely
Make Required Affidavit
Mail or Deliver Report to
Conservation Division
State Corporation Comm.
245 North Water
Wichita, KS 67202

Kingman County, Sec. 20 Twp. 27S Rge. 10 E/W
Location as "NE/CNW/SW" or footage from lines
1320' ESL 990' FEL
Lease Owner CACTUS CORPORATION
Lease Name SWANDER ET AL Well No. 1
Office Address Box 85 CUNNINGHAM KS
Character of Well (Completed as Oil, Gas or Dry Hole) DRY HOLE

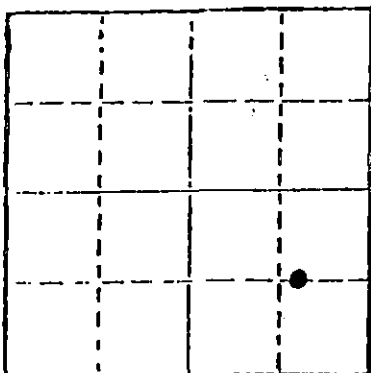

Locate well correctly on above
Section Plot

Date Well completed 8/20/79 19
Application for plugging filed 8/19/79 19
Application for plugging approved 8/29/79 19
Plugging commenced 8/19/79 19
Plugging completed 8/20/79 19
Reason for abandonment of well or producing formation
DRY HOLE - NO SHOWS - NON COMMERCIAL
If a producing well is abandoned, date of last production
N/A 19

Was permission obtained from the Conservation Division or
its agents before plugging was commenced? YES

Name of Conservation Agent who supervised plugging of this well BILL OWEN
Producing formation _____ Depth to top _____ Bottom _____ Total Depth of Well 4011
Show depth and thickness of all water, oil and gas formations.

OIL, GAS OR WATER RECORDS

CASING RECORD

FORMATION	CONTENT	FROM	TO	SIZE	PUT IN	PULLED OUT
<u>MISS</u>	<u>GAS</u>	<u>3973</u>	<u>3011</u>	<u>FEET</u>	<u>300</u>	<u>0</u>

Describe in detail the manner in which the well was plugged, indicating where the mud fluid
was placed and the method or methods used in introducing it into the hold. If cement or other
plugs were used, state the character of same and depth placed, from _____ feet to
_____ feet for each plug set.

Filled hole w/ mud to bottom surface pipe.
Placed 10-sx plug at base of surface, filled 150'
surface pipe with mud prepared + placed
hole with 25 bag of common cement.

(If additional description is necessary, use BACK of this sheet)

Name of Plugging Contractor Husky Drilling Co.

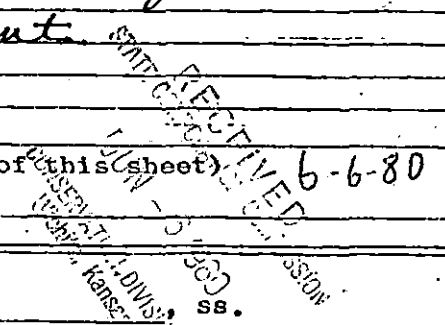

STATE OF _____ COUNTY OF _____
(employee of owner) or (owner or operator)
of the above-described well, being first duly sworn on oath, says: That I have knowledge of
the facts, statements, and matters herein contained and the log of the above-described well
as filed and that the same are true and correct. So help me God.

(Signature) Edmund Zita
Box 85, Cunningham KS 67035
(Address)

SUBSCRIBED AND SWORN TO before me this _____ day of _____, 19 _____

Larry W. Lemaster
Notary Public.

My commission expires 11-18-81

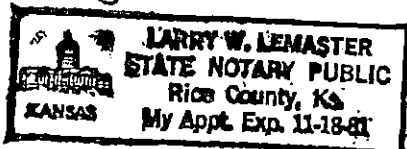

WELL COMPLETION REPORT AND
DRILLER'S LOG

S. 20 T. 27 R. 10 W

Loc. SW NE SE

County Kingman

API No. 15 — 095 — 20,864
County Number

Operator
Cactus Corp.

Address P. O. Box 85 Cunningham, Kansas

Well No. #1 Lease Name Swander Et Al

Footage Location
1320 feet from (S) line 990 feet from (E) line

Principal Contractor
HUSKY DRILLING

Geologist

Spud Date Aug 14 1979 Date Completed Sept 11, 1979 Total Depth 4011 P.B.T.D. 3997

Directional Deviation Oil and/or Gas Purchaser KANSAS GAS SUPPLY

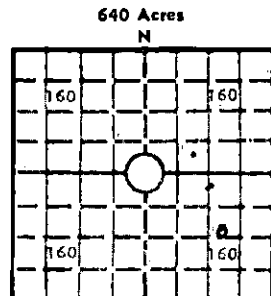

Elev.: Gr. 1714

DF 1718 KB 1719

CASING RECORD

Report of all strings set — surface, intermediate, production, etc.

Purpose of string	Size hole drilled	Size casing set (in O.D.)	Weight lbs/ft.	Setting depth	Type cement	Sacks	Type and percent additives
SURFACE	12 1/4	8 5/8	23	292	Common	175	
PRODUCTION	7 7/8	4 1/2	9.5	4010	50-50 P02	100	18% SALT

LINER RECORD

PERFORATION RECORD

Top, ft.	Bottom, ft.	Sacks cement	Shots per ft.	Size & type	Depth interval
			4	1/2" DP	3978-86

TUBING RECORD

Size	Setting depth	Packer set at
2 3/8" O.D.	3978	

ACID, FRACTURE, SHOT, CEMENT SQUEEZE RECORD

Amount and kind of material used	Depth interval treated
500 gal 15% MCLA, TREATED AT 3 BBL/MIN @ 600#	3978-86

INITIAL PRODUCTION

Date of first production	Producing method (flowing, pumping, gas lift, etc.)
RATE OF PRODUCTION PER 24 HOURS	Oil bbls. Gas bbls. Water MCF Gas-oil ratio CFPB
Disposition of gas (vented, used on lease or sold)	Producing interval (s)
	3978-3986

INSTRUCTIONS: As provided in KCC Rule 82-2-125, within 90 days after completion of a well, one completed copy of this Drillers Log shall be transmitted to the State Geological Survey of Kansas, 4150 Monroe Street, Wichita, Kansas 67209. Copies of this form are available from the Conservation Division, State Corporation Commission, 245 No. Water, Wichita, Kansas 67202. Phone AC 316-522-2206. If confidential custody is desired, please note Rule 82-2-125. Drillers Logs will be on open file in the Oil and Gas Division, State Geological Survey of Kansas, Lawrence, Kansas 66044.

Operator **CACTUS CORPORATION** DESIGNATE TYPE OF COMP.: OIL, GAS, DRY HOLE, SWDW, ETC.:

Well No. **1** Lease Name **SWANDER et A1** **GAS**

S20 T27 R10 E W

WELL LOG

Show all important zones of porosity and contents thereof; cored intervals, and all drill-stem tests, including depth interval tested, cushion used, time tool open, flowing and shut-in pressures, and recoveries.

SHOW GEOLOGICAL MARKERS, LOGS RUN, OR OTHER DESCRIPTIVE INFORMATION.

FORMATION DESCRIPTION, CONTENTS, ETC.	TOP	BOTTOM	NAME	DEPTH
HERINGTON	1580		GAMMA-NEUTRON	
RED EAGLE	2230		3976 3000	
HOWARD	2813			
DOUGLAS	3350			
MISSISSIPPIAN CHERT 3945-3991	3973			
DST #1 45-45-60-60 400-233				
BTS 3 MIN. FARD 100 MCF				
RECOVERED 70' GCM				
IHP 1870				
IFD 233-84				
FFP 136-48				
FSIP 1206				
FHP 1843				
DST #2 3942-4011 45-45-60-60				
IHP 1956				
ISIP 1313				
IFP 213-48 GAS FLOW RATE				
FFP 179-78 OF 207 MCF/D				
FSIP 1242				
FHP 1882 RECOVERED 115' GCM				

USE ADDITIONAL SHEETS, IF NECESSARY, TO COMPLETE WELL RECORD.

Date Received _____

Signature E.H. Bittner

Title _____

Date 10/18/79