

15-097-20573-0000

KANSAS DRILLERS LOG

G E O L .

S. 8 T. 27S R. 20 E
 Loc. A C N / E N E
 County K I O W A

API No. 15 — 097 — 20,573
 County Number

Operator
 Texas Oil & Gas Corp.

Address
 200 West Douglas, Suite 300, Wichita, KS 67202

Well No. #1 Lease Name Einsel "G"

Footage Location
 510' feet from (IN) (S) line 2030 feet from (IE) (W) line

Principal Contractor H-30 Drilling Geologist Core Laboratories

Spud Date 10-12-79 Total Depth 4925' P.B.T.D. 4890'

Date Completed 10-31-79 Oil Purchaser N/A

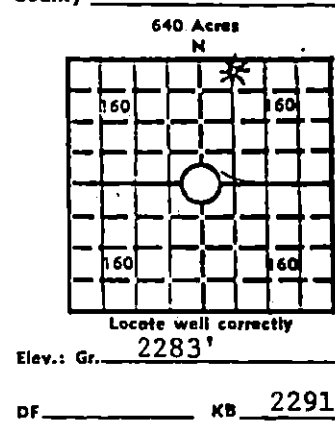

CASING RECORD

Report of all strings set— surface, intermediate, production, etc.

Purpose of string	Size hole drilled	Size casing set (in O.D.)	Weight lbs/ft.	Setting depth	Type cement	Sacks	Type and percent additives
Surface		8-5/8"	24#	584'		425	
Production		4-1/2"		4900'		175	

LINER RECORD

PERFORATION RECORD

Top, ft.	Bottom, ft.	Sacks cement	Shots per ft.	Size & type	Depth interval
N/A	N/A	N/A	2 JSPF	4-1/2"	4840-44'
TUBING RECORD			2 JSPF	4-1/2"	4858-62'
Size	Setting depth	Packer set at			
2-3/8"	4800'				

ACID, FRACTURE, SHOT, CEMENT SQUEEZE RECORD

Amount and kind of material used	Depth interval treated
Acidized w/300 gals 15% HCl	4840-44'
Acidized w/300 gals 15% HCl	4858-62'

INITIAL PRODUCTION

Date of first production Shut-in Producing method (flowing, pumping, gas lift, etc.) flowing

2-11-1993

RATE OF PRODUCTION PER 24 HOURS	Oil	Gas	Water	Gas-oil ratio
	trace	5280 bbls.	mist MCF	N/A

Disposition of gas (vented, used on lease or sold) Shut-in Producing interval(s) 4840-44' and 4858-62'

INSTRUCTIONS: As provided in KCC Rule 82-2-125, within 90 days after completion of a well, one completed copy of this Drillers Log shall be transmitted to the State Geological Survey of Kansas, 4150 Monroe Street, Wichita, Kansas 67209. Copies of this form are available from the Conservation Division, State Corporation Commission, 3830 So. Meridian (P.O. Box 17027), Wichita, Kansas 66217. Phone AC 316-522-2206. If confidential status is desired, please note Rule 82-2-125. Drillers Logs will be on open file in the Oil and Gas Division, State Geological Survey of Kansas, Lawrence, Kansas 66044.

RECEIVED
 STATE CORPORATION COMMISSION
 OIL AND GAS DIVISION
 Wichita, Kansas
 2-10-1972

Well No. #1	Lease Name Einsel "G"	SIGW
----------------	--------------------------	------

S 8 T 27 R 20 W

WELL LOG

Show all important zones of porosity and contents thereof; cored intervals, and all drill-stem tests, including depth interval tested, cushion used, time tool open, flowing and shut-in pressures, and recoveries.

SHOW GEOLOGICAL MARKERS, LOGS RUN, OR OTHER DESCRIPTIVE INFORMATION.

FORMATION DESCRIPTION, CONTENTS, ETC.	TOP	BOTTOM	NAME	DEPTH
Herington	2506	-215		
Cottonwood	3043	-752		
Onaga	3292	-1001		
Stotler	3441	-1150		
Heebner	4072	-1781		
Douglas Grp.	4106	-1815		
Lansing/Kansas City	4213	-1922		
Stalnaker	4538	-2247		
B/Kansas City	4618	-2327		
Cherokee	4749	-2458		
Mississippian	4838	-2547		
TD	4925			
PBTD	4890			
<p>DST #1, 4843-67' (Miss.), w/results as follows: IFP/30": 997-1051#, GTS/1" gauge 4946 MCFD ISIP/60": 1281# FFP/45": 969-997#, gauge 6439 MCFD FSIP/90": 1267# Rec. 30' MCW</p>				

USE ADDITIONAL SHEETS, IF NECESSARY, TO COMPLETE WELL RECORD.

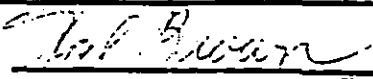
Date Received	 _____ HAL BROWN Signature _____ District Exploration Manager Title _____ March 18, 1980 Date _____
---------------	---