

STATE OF KANSAS
STATE CORPORATION COMMISSION

WELL PLUGGING RECORD

OR

FORMATION PLUGGING RECORD

Strike out upper line when reporting plugging of formations.

Give All Information Completely
Make Required Affidavit
Mail or Deliver Report to:
Conservation Division
State Corporation Commission
800 Bittling Building
Wichita, Kansas

Kingman County, Sec. 29, Twp 27, Rge (E) 10 (W)

Location as "NE $\frac{1}{4}$ NW $\frac{1}{4}$ SW $\frac{1}{4}$ " or footage from lines NW $\frac{1}{4}$ NW $\frac{1}{4}$ SW $\frac{1}{4}$
Lease Owner Skelly Oil Company
Lease Name W. Leisman Well No. 3
Office Address Box 391, Hutchinson, Kansas
Character of Well (completed as Oil, Gas or Dry Hole) Oil
Date well completed December 28 19 32
Application for plugging filed May 18 19 43
Application for plugging approved May 19 19 43
Plugging commenced May 17 19 43
Plugging completed May 17 19 43
Reason for abandonment of well or producing formation Depleted oil well

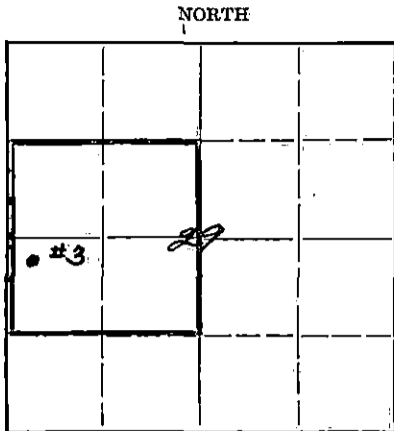

Locate well correctly on above Section Plat

If a producing well is abandoned, date of last production August 19 42
Was permission obtained from the Conservation Division or its agents before plugging was commenced? Yes, verbally

Name of Conservation Agent who supervised plugging of this well Ruel Durkee
Producing formation Lansing Lime Depth to top 3370' Bottom 3436' Total Depth of Well 3489' Feet

Show depth and thickness of all water, oil and gas formations.

OIL, GAS OR WATER RECORDS

CASING RECORD

Formation	Content	From	To	Size	Put In	Pulled Out
Lansing Lime	Gas	3370'	3436'	12 $\frac{1}{2}$ " OD	244' 8"	None
" "	Oil	3385'	3436'	5-3/16" OD	339' 2" IW	None
				"	3047' 6" SS	1245' 7"

Describe in detail the manner in which the well was plugged, indicating where the mud fluid was placed and the method or methods used in introducing it into the hold. If cement or other plugs were used, state the character of same and depth placed, from _____ feet to _____ feet for each plug set.

Plugged back with tools lost in hole and
20 sacks of cement from 3489' to 3280'
Mud laden fluid from 3280' to 275'
80 sacks cement from 275' to 4'
Surface soil from 4' to 0.

PLUGGING
FILE NO. 29 27 21021
BOOK PAGE 75 LINE 6

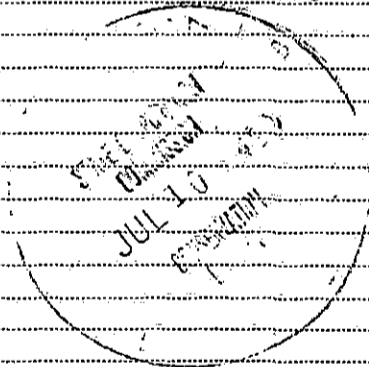

7-10-1943

(If additional description is necessary, use BACK of this sheet)

Correspondence regarding this well should be addressed to Skelly Oil Company
Address Box 391, Hutchinson, Kansas

STATE OF KANSAS, COUNTY OF RENO, ss.

(employee of owner) of (owner or operator) of the above-described well, being first duly sworn on oath, says: That I have knowledge of the facts, statements, and matters herein contained and the log of the above-described well as filed and that the same are true and correct. So help me God.

(Signature)

Box 391, Hutchinson, Kansas
(Address)

SUBSCRIBED AND SWORN to before me this 8th day of July, 19 43.

Notary Public

My commission expires August 4, 1945.



MATERIAL REPORT

AND

PLUGGING RECORD

Mail To: STATE CORPORATION COMMISSION

Conservation Division

800 Bitting Building

Wichita, Kansas

NOTICE: All questions on this form must be answered.

Company Operating Skelly Oil Company

Office Address 210 Wolcott Building, Hutchinson, Kansas

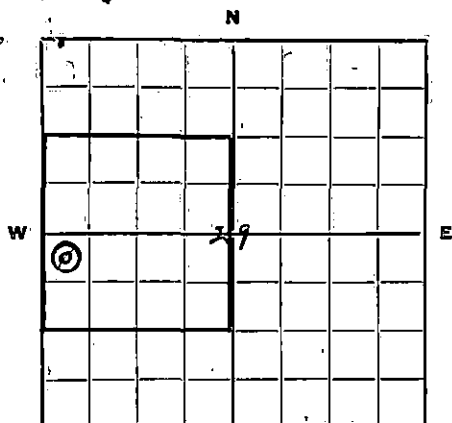

Locate well correctly.

County Kingman Sec. 29 Twp. 27S Rge. 10W

Farm Name Wen. Leisman Well No. 3 Field Cunningham

Well Location NW/4 NW/4 SW/4

Name of Producing Sand Larsing Lime Total Depth 3489'

Commenced Plugging May 17, 1943 Finished May 17, 1943

DAILY AVERAGE PRODUCTION:

Initial Production: Oil 122 1/2 bbls./day Gas 2,890,000 cu.ft. Water None

Production when Plugged: Oil None Gas None Water 100%

Estimated Total Remaining Reserves Attributable to Well at Time Abandoned None

INFORMATION ON MATERIALS RECLAIMED FROM WELL

CASING, TUBING AND ROD DATA

Description	Size	Recovered		Junk		Reusable		Disposition Made Or To Be Made Of Usable Material
		Ft.	Tons	Ft.	Tons	Ft.	Tons	
Casing	5-3/16"	1246'	10 1/2	-	-	1246'	10 1/2	Will be rerun in new well

SURFACE EQUIPMENT

Quantity	Description	*Condition	Est. Tons	Disposition Made Or To Be Made Of Reclaimed Material
				(No surface equipment at well)

* Usable, Usable with minor repairs, or junk.

Date: August 17, 1943

Signed: [Signature] Superintendent

(For Operating Co. Title)

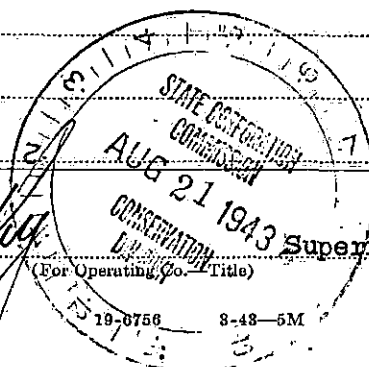

Form—FP-1

PLUGGING
 FILE NO 29 27R10A
 BOOK PAGE 75 LINE 6

(See note on reverse side)

19-3756 8-48-5M

It is very important that all questions on this form be answered, as this Department has been asked by the Petroleum Administration for War to supply data on well abandonments undertaken during the war.

This information is very essential in aiding the war effort; therefore, this Department is requiring this report to be mailed within 5 days after the abandonment of your well.

19-6756

WELL RECORD

Lease name and description: Wendel Leisman - covering S/2 SW/4 Sec. 20, and N/2 NW/4 Sec. 29-27S-10W, Kingman County, Kansas.
 Well number and location: No. 3 - located 330' from north and west lines of Sec. 29.
 Operating Company: Skelly Oil Company - Tulsa, Oklahoma.
 Drilling commenced: Nov. 6, 1932.
 Drilling completed: Dec. 30, 1932.
 Rotary tools used: Top to 3370'.
 Cable tools used: 3370' to 3489'.
 Total depth: 3489'.
 Elevation: 1666' derrick floor.
 Producing horizon: 3370' to 3436'.
 Initial production: 122 1/2 bbls.

CASING RECORD

12-1/2" 250' Cemented w/ 180 sacks.
 5-3/16" 3360' " " 450 sacks.

FORMATION RECORD

Sand	0	75	
Red rock	75	257	Drilled to 257' and ran and cemented 12 1/2" csg. at 250' w/ 180 sacks.
Red rock and shale	257	740	
Slate, shale and shells	740	852	
Shale and slate	852	1021	
Shale	1021	1046	
Salt	1046	1445	
Shale and lime shells	1445	1523	
Lime	1523	1736	
Broken lime	1736	1815	
Shale	1815	1869	
Shale and lime	1869	1960	
Slate and shale	1960	2015	
Slate and shale w/ lime shells	2015	2115	
Shale	2115	2200	
Shale and slate	2200	2240	
Broken lime	2240	2260	
Shale	2260	2300	
Lime	2300	2355	
Broken lime	2355	2843	
Lime	2843	2995	
Sandy lime	2995	3000	
Broken lime	3000	3035	
Shale	3035	3055	
Lime	3055	3060	
Shale	3060	3130	
Lime shells	3130	3161	
Broken lime	3161	3184	
Lime	3184	3230	
Broken lime and shale	3230	3279	
Lime	3279	3304	
Lime and shale	3304	3347	
Broken lime	3347	3353	
Lime and shale	3353	3367	
Lime	3367	3367	Drilled to 3367' and ran and cemented 5-3/16" casing at 3360' w/ 450 sacks.
Steel line correction	3367	3370	Standardized rig.
Lime	3370	3372	First gas at 3370'.
Light brown and gray lime	3372	3378	
Med. soft brown lime	3378	3385	
Brown lime w/ little chert	3385	3390	First oil at 3385'.
Soft brown lime	3390	3396	
" " "	3396	3406	
Brown and gray lime	3406	3412	
Porous brown lime	3412	3416	
Slightly porous brown and gray lime	3416	3422	
Porous brown lime	3422	3425	

JUL 1 1933
 PUBLIC SERVICE COMMISSION
 STATE OF KANSAS

FILED 29. 27. 10W
 BOOK PAGE-75-6

Slightly porous brown and gray lime	3425	3430
No sample (Lime)	3430	3436
" " (Med. hard lime)	3436	3464
" " (Med. soft lime)	3464	3480
" " (Hard lime)	3480	3489

Completed well Dec. 30, 1932.
Initial production 122½ bbls. oil
first 24 hours.

TOTAL DEPTH 3489'

I, the undersigned, being first duly sworn upon oath, state that this well record is true and correct according to the records of this office and to the best of my knowledge and belief.



Representative of Company.

Subscribed and sworn to before me this _____ day of _____ 1932.

My Commission expires _____.

Notary Public.

29927 10W
75 6