

STATE OF KANSAS  
STATE CORPORATION COMMISSION

Form CP-4

Give All Information Completely  
Make Required Affidavit  
Mail or Deliver Report to:  
Conservation Division  
State Corporation Commission  
212 No. Market  
Wichita, Kansas 67202

WELL PLUGGING RECORD

KIOWA County, Sec 27 Twp. 27 S Rge. 20 (E) (W)

Location as "NE/CNW/SW" or footage from lines APP. G NW SW

Lease Owner PETROLEUM, INC.,

Lease Name HARGADINE Well No. 1

Office Address R.R. #2, GREAT BEND, KANSAS

Character of Well (completed as Oil, Gas or Dry Hole) DRY HOLE

Date well completed NOVEMBER 10 19 71

Application for plugging filed NOVEMBER 10 19 71

Application for plugging approved NOVEMBER 10 19 71

Plugging commenced NOVEMBER 10 19 71

Plugging completed NOVEMBER 10 19 71

Reason for abandonment of well or producing formation NO COMMERCIAL ZONE

If a producing well is abandoned, date of last production NONE 19

Was permission obtained from the Conservation Division or its agents before plugging was commenced? YES

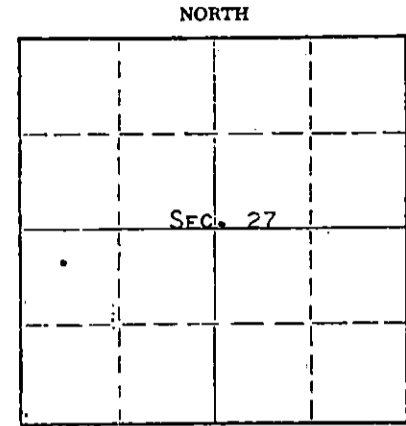

Locate well correctly on above  
Section Plat

Name of Conservation Agent who supervised plugging of this well G. R. BIBERSTEIN

Producing formation \_\_\_\_\_ Depth to top \_\_\_\_\_ Bottom \_\_\_\_\_ Total Depth of Well 4945 Feet

Show depth and thickness of all water, oil and gas formations.

OIL, GAS OR WATER RECORDS

CASING RECORD

FORMATION	CONTENT	FROM	TO	SIZE	PUT IN	PULLED OUT
				8-5/8"	563'	NONE

Describe in detail the manner in which the well was plugged, indicating where the mud fluid was placed and the method or methods used in introducing it into the hole. If cement or other plugs were used, state the character of same and depth placed, from \_\_\_\_\_ feet to \_\_\_\_\_ feet for each plug set.

HEAVY MUD TO 500', FOLLOWED WITH 50 SACKS CEMENT. HEAVY MUD TO 40', FOLLOWED WITH 10 SACKS CEMENT TO BASE OF WELL CELLAR.

RECEIVED  
STATE CORPORATION COMMISSION  
NOV 15 1971  
CONSERVATION DIVISION  
Wichita, Kansas

(If additional description is necessary, use BACK of this sheet)  
Name of Plugging Contractor GARVEY DRILLING COMPANY  
Address R.R. #2, GREAT BEND, KANSAS

STATE OF KANSAS, COUNTY OF BARTON, ss.  
MONTY CHADD (employee of owner) or (owner or operator) of the above-described well, being first duly sworn on oath, says: That I have knowledge of the facts, statements, and matters herein contained and the log of the above-described well as filed and that the same are true and correct. So help me God. MONTY CHADD, DIST. PROD. SUPT.

(Signature) *Monty Chadd*  
R.R. #2, GREAT BEND, KANSAS  
(Address)

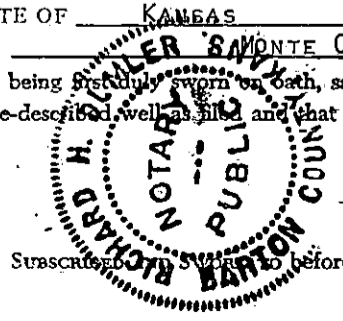

Subscribed and sworn to before me this 12 day of NOVEMBER, 1971

*Richard H. Quinlan*  
Notary Public.

My commission expires MAY 28, 1973

# WELL LOG

COMPANY Petroleum, Inc.

SEC. 27 T. 27S R. 20W

FARM Hargadine

NO. 1

LOC. App. C NW SW

TOTAL DEPTH 4945'

RECEIVED  
STATE CORPORATION COMMISSION  
NOV 15 1971  
CONSERVATION DIVISION  
Wichita, Kansas

COUNTY Kiowa, Kansas

COMM. 10-26-71

COMP. 11-9-71

CONTRACTOR Garvey Drilling Company

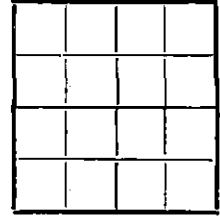

CASING

8 5/8" @ 563' w/350sx

ELEVATION 2293 DF

PRODUCTION D & A

FIGURES INDICATE BOTTOM OF FORMATIONS

160' Sand  
235' Shale, Shells, & Sand  
564' Shale  
723' Shale & Red Bed  
737' Anhydrite  
825' Red Bed & Shell  
1282' Red Bed  
1323' Anhydrite  
1330' Shale  
2050' Shale & Shells  
2505' Shale & Lime  
2745' Lime & Shale  
3940' Lime  
4245' Lime & Shale  
4300' Lime  
4510' Lime & Shale  
4560' Lime  
4910' Lime, Shale, & Chert  
4945' Lime & Chert  
4945' RTD

State of Kansas }  
County of Barton } ss

I, Charlene Marker of Garvey Drilling Company

upon oath state the above and foregoing is a true and correct copy of the log of the Hargadine #1 well.

Subscribed and sworn to before me this 10th day of November 19 71

My Commission Expires: July 8, 1974

Charlene Marker  
Jenna A. Morris  
NOTARY PUBLIC