

STATE CORPORATION COMMISSION OF KANSAS
OIL & GAS CONSERVATION DIVISION
WELL COMPLETION OR RECOMPLETION FORM
ACO-1 WELL HISTORY
DESCRIPTION OF WELL AND LEASE

S

API NO. 15-151-21-820-00-00
County Pratt
SE
S42 NE NE Sec 33 Twp 26 Rge 11 East
West

Operator: License # 4058
Name American Warrior, Inc
Address P.O. Box 399
City/State/Zip Garden City, KS 67846

4290 Ft North from Southeast Corner of Section
660 Ft West from Southeast Corner of Section
(Note: Locate well in section plat below)

Purchaser

Lease Name Trinkle Well # 1-1A

Operator Contact Person John Paluga
Phone 316-275-7461

Field Name Wilscat

Contractor: License # 5864
Name Lobo Drilling Company

Producing Formation

Wellsite Geologist
Phone

Elevation: Ground 1807 KB 1812

Designate Type of Completion
XX New Well Re-Entry Workover
Oil SWD Temp Abd
Gas Inj Delayed Comp.
XX Dry Other (Core, Water Supply etc.)

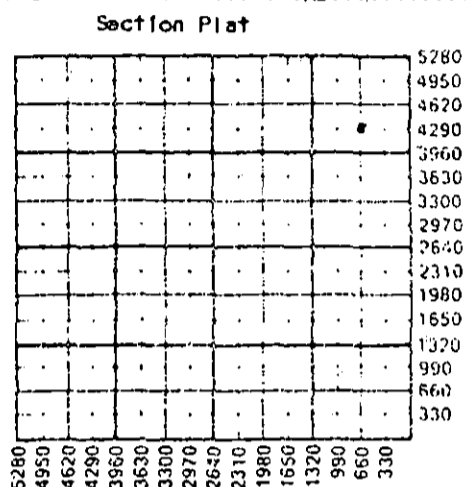

If ONWO: old well into as follows:
Operator
Well Name
Comp. Date Old Total Depth

WATER SUPPLY INFORMATION

Disposition of Produced Water: Disposal
Docket # Repressuring

WELL HISTORY

Drilling Method: XX Mud Rotary Air Rotary Cable
1-3-87 1-10-87 1-10-87
Spud Date Date Reached TD Completion Date
4500'
Total Depth PBTD
Amount of Surface Pipe Set and Cemented at 409 feet
Multiple Stage Cementing Collar Used? Yes No
If yes, show depth set feet
If alternate 2 completion, cement circulated from feet depth to w/SX cmt
Cement Company Name
Invoice #

Questions on this portion of the ACO-1 call:

Water Resources Board (913) 296-3717

Source of Water:
Division of Water Resources Permit #
X Groundwater 4290 Ft North from Southeast Corner
(Well) 660 Ft West from Southeast Corner of
Sac 33 Twp 26 Rge 11 East X West
Surface Water Ft North from Southeast Corner
(Stream, pond etc) Ft West from Southeast Corner
Sac Twp Rge East West
Other (explain)
(purchased from city, R.W.D. #)

INSTRUCTIONS: This form shall be completed in triplicate and filed with the Kansas Corporation Commission, 200 Colorado Derby Building, Wichita, Kansas 67202, within 120 days of the spud date of any well. Rule 82-3-130, 82-3-107 and 82-3-106 apply. Information on side two of this form will be held confidential for a period of 12 months if requested in writing and submitted with the form. See rule 82-3-107 for confidentiality in excess of 12 months. One copy of all wireline logs and drillers time log shall be attached with this form. Submit CP-4 form with all plugged wells. Submit CP-111 form with all temporarily abandoned wells.

All requirements of the statutes, rules and regulations promulgated to regulate the oil and gas industry have been fully complied with and the statements herein are complete and correct to the best of my knowledge.

Signature Jim C. Subiza

Title Date 2/27/87

Subscribed and sworn to before me this 24th day of February 1987

Notary Public Debra J. Purcell
Date Commission Expires 11-4-87

K.C.C. OFFICE USE ONLY
F Letter of Confidentiality Attached
C Wireline Log Received
C Drillers Timelog Received
Distribution
KCC SWD/Rep NGPA
KGS Plug Other
(Specify)

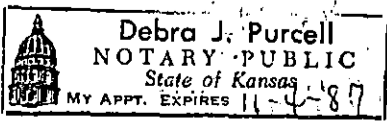

Rec. 2-26-87

Sec 33 Twp 26 Rge 11 W

Operator Name American Warrior, Inc. Lease Name Trinkle Well # 1-1A

Sec. 33 Twp. 26 Rge. 11 East West County Pratt

WELL LOG

INSTRUCTIONS: Show important tops and base of formations penetrated. Detail all cores. Report all drill stem tests giving interval tested, time tool open and closed, flowing and shut-in pressures, whether shut-in pressure reached static level, hydrostatic pressures, bottom hole temperature, fluid recovery, and flow rates if gas to surface during test. Attach extra sheet if more space is needed. Attach copy of log.

Drill Stem Tests Taken Yes No
 Samples Sent to Geological Survey Yes No
 Cores Taken Yes No

Formation Description Log Sample

DST No 1
 4656 to 4696
 IFF 44-48 30
 ISIP 1374 45
 EFP 66-77 45
 FSIP 1341 45
 First Open: Strong Blow
 2nd Open: Strong Blow
 Run 125' DRILLING MUD

Name	Top	Bottom
Mud	3419 (-1601)	
DOUGLAS Sh	3452 (-1646)	
LANSING	3622 (-1810)	
B/KC	3970 (-2158)	
MISS	4061 (-2249)	
U/LA	4262 (-2450)	
SIMPSON Sh	4366 (-2554)	
SIMPSON SAND	4380 (-2568)	
Re-worked ARB.	4446 (-2634)	
ARBUCKLE	4458 (-2646)	

CASING RECORD <input type="checkbox"/> New <input checked="" type="checkbox"/> Used							
Report all strings set-conductor, surface, intermediate, production, etc.							
Purpose of String	Size Hole Drilled	Size Casing Set (in O.D.)	Weight Lbs/Ft.	Setting Depth	Type of Cement	#Sacks Used	Type and Percent Additives
Surface	12 1/2"	8-5/8"	20#	409'	60/40 PZ	300	2% gel 3% cc
PERFORATION RECORD				Acid, Fracture, Shot, Cement Squeeze Record			
Shots Per Foot	Specify Footage of Each Interval Perforated			(Amount and Kind of Material Used)		Depth	
TUBING RECORD				Liner Run <input type="checkbox"/> Yes <input type="checkbox"/> No			
Date of First Production	Producing Method <input type="checkbox"/> Flowing <input type="checkbox"/> Pumping <input type="checkbox"/> Gas Lift <input type="checkbox"/> Other (explain)						
Estimated Production Per 24 Hours	Oil Bbls	Gas MCF	Water Bbls	Gas-Oil Ratio	Gravity		

METHOD OF COMPLETION Production Interval

Disposition of gas: Vented Open Hole Perforation
 Sold Other (Specify)
 Used on Lease Dually Completed Commingled

RECEIVED
 STATE CORPORATION COMMISSION
 FEB 9 1977
 OIL AND GAS DIVISION